

Assembly Instructions, #20028PC Double Hall Stand/ Sofa Table with Display Shelf

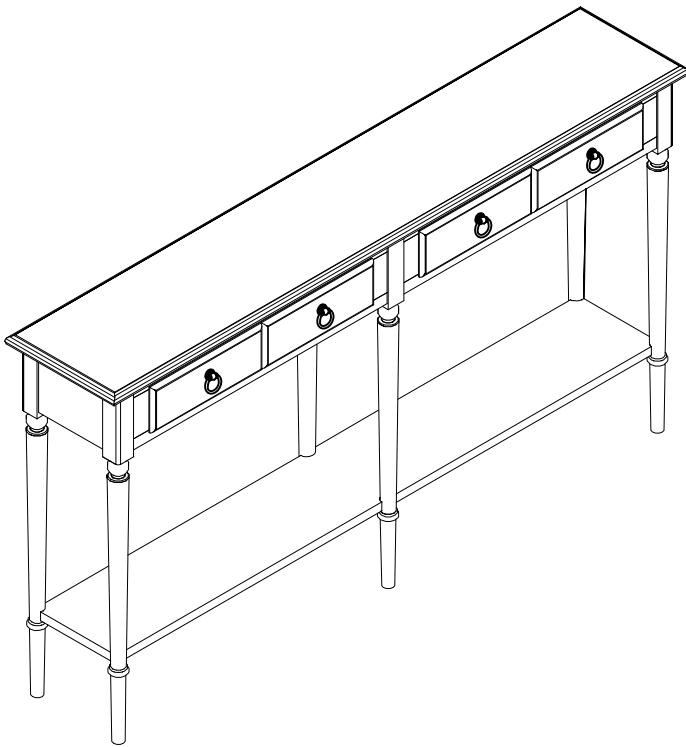

A: Top Assembly	
B: (4) Side Legs	
C: (2) Center Legs	
D: Shelf	
E: (12) Flat Washers	
F: (12) Lock Washers	
G: (12) Bolts	
H: Allen Wrench	
I: (6) Screws	
J: (4) Extra Drawer Glides	

Assembly Steps

Step 1

Put the table top upside down on a soft surface and remove drawers. Fasten two side legs and one center leg with parts (E & F & G) on the back of table side.

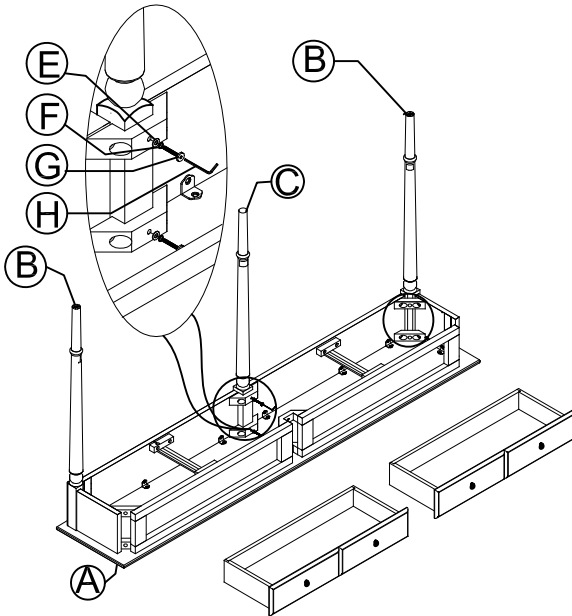

Step 2

- 2.1 Lay the table on its back, insert the shelf on the leg notches, hold the shelf and fasten the center leg.
- 2.2 Fasten the remaining two side legs.

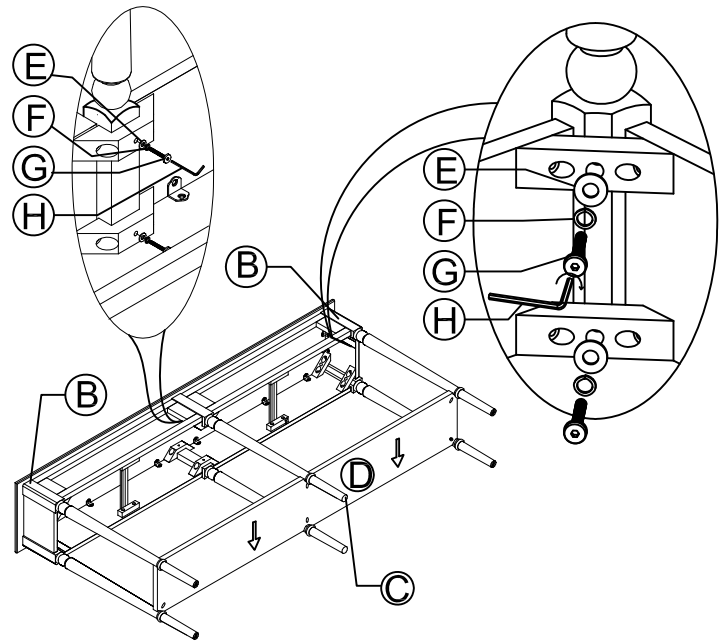

Step 3

Put the table upside down, push the legs into the shelf and fasten shelf with six screws.

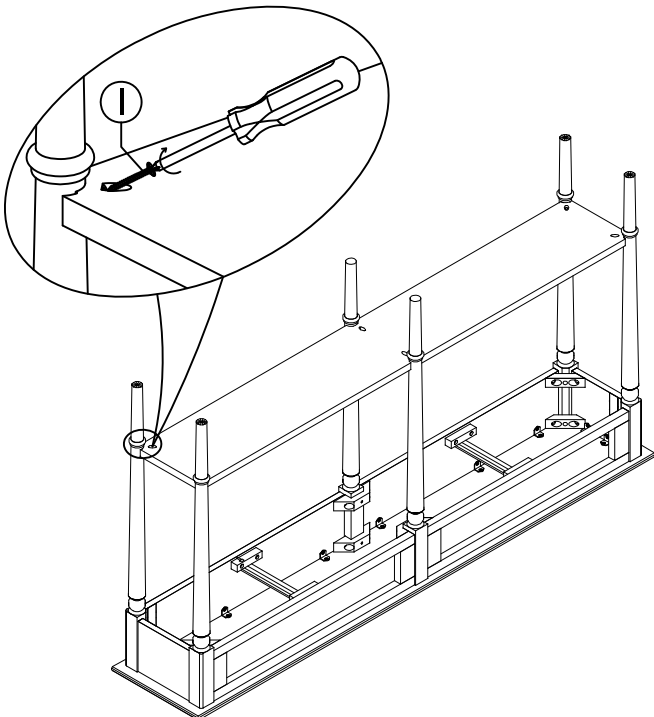

Step 4

- 4.1 Place the table right side up and insert the drawer.
- 4.2 Fasten the anti-tipping hardware on the back of table into pre-drilled holes on the wall.
- 4.3 Adjust levelers on side legs if needed.

