

Hutch

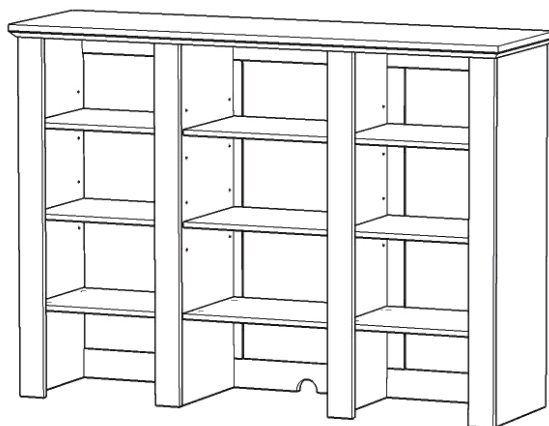

IMPORTANT

Carefully remove all the parts from the carton and place them individually on a soft cloth to prevent scratches or other damage.

Carefully and strictly follow these assembly instructions to ensure a completed product as designed.

Do not use power tools above 8 volts to assemble.

Part List



A.
Top
1 pc.



F.
Back Rail
1 pc.

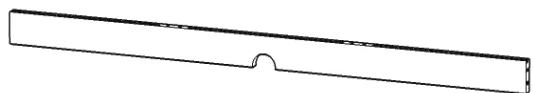

G.
Back Rail
1 pc.



H.
Shelf
3 pcs.



I.
Shelf
6 pcs.



B.
Side Panel
1 pc.



C.
Middle Panel
1 pc.



D.
Middle Panel
1 pc.



E.
Side Panel
1 pc.



J.
Front Upright
2 pcs.



K.
Front Upright
2 pcs.



L.
Back Upright
2 pcs.

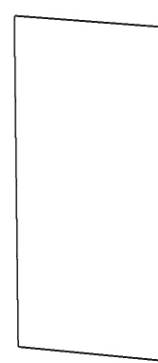

M.
Back Panel
3 pcs.

Hardware List



Cam Lock Screw
52 pcs. (+1 extra)

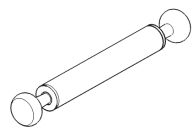

Cam Lock Screw (long)
4 pcs. (+1 extra)

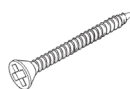

M3.5x38
Flat Head Screw
6 pcs. (+1 extra)



M3.5x15
Wood Screw for Bracket
10 pcs. (+1 extra)



Bracket
2 pcs.



Cam Lock
60 pcs. (+6 extra)



Cover
24 pcs. (+1 extra)



Dowel
24 pcs. (+1 extra)

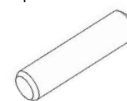

Dowel (long)
4 pcs. (+1 extra)



Adjustable Pin
24 pcs. (+1 extra)

Tool(s) required for assembly: Phillips screwdriver, Drill (8 volts or less), 3/8" Drill Bit

Home Styles Customer Service: www.homestyles-furniture.com,
servicedesk@homestyles-furniture.com, 888-680-7460, 877-831-0319

Assembly Instructions 2/8

IMPORTANT

- Use a soft cloth between these parts and the floor.
- Do not use power tools above 8 volts to assemble.
- Do not tighten all the screws until each part is properly assembled.

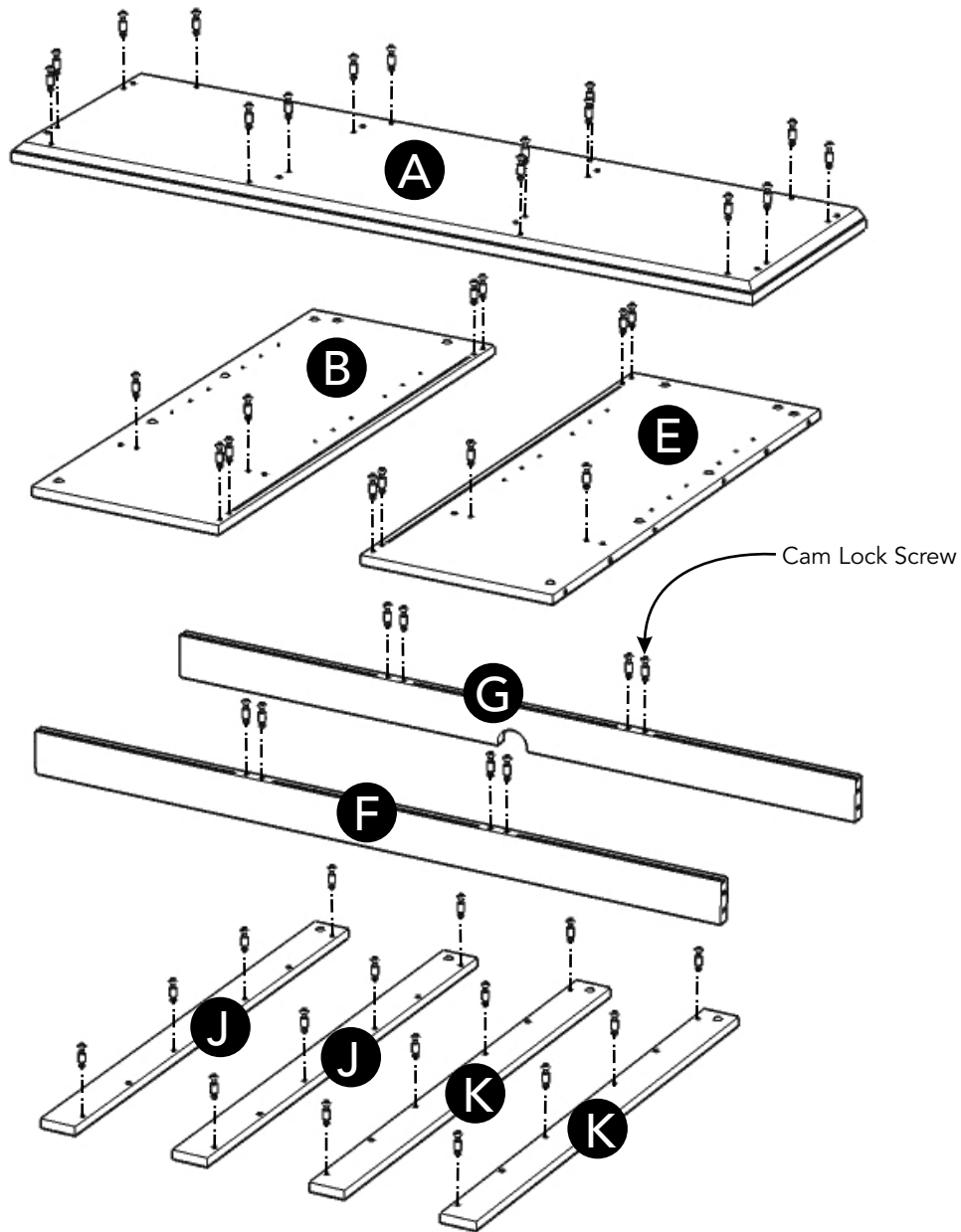

STEP 1

Place Top (A), Side Panels (B), (E), Back Rails (F), (G) and Front Uprights (J), (K) on a soft cloth.

Insert Cam Lock Screws into pre-drilled holes in Top (A), Side Panels (B), (E), Back Rails (F), (G) and Front Uprights (J), (K), then tighten. (See Figure 1)

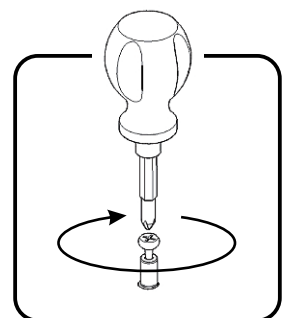

Figure 1

STEP 2

Insert Dowels into pre-drilled holes in Middle Panels (C) and (D). (See Figure 2)

Attach Front Upright (K) to Middle Panel (C) and Front Upright (J) to Middle Panel (D) with Cam Locks. (See Figure 3)

Cover Cam Locks with Covers. (See Figure 4)

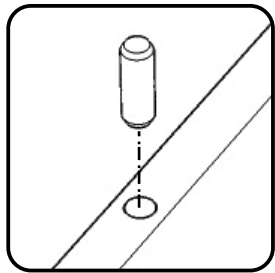

Figure 2

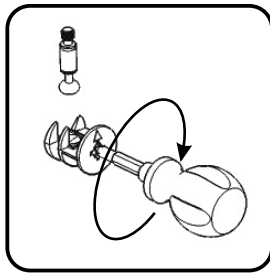

Figure 3

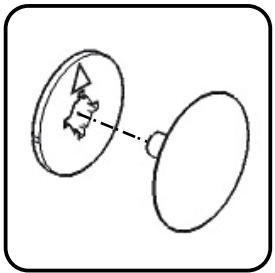

Figure 4

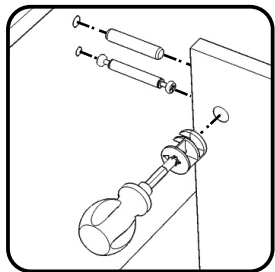
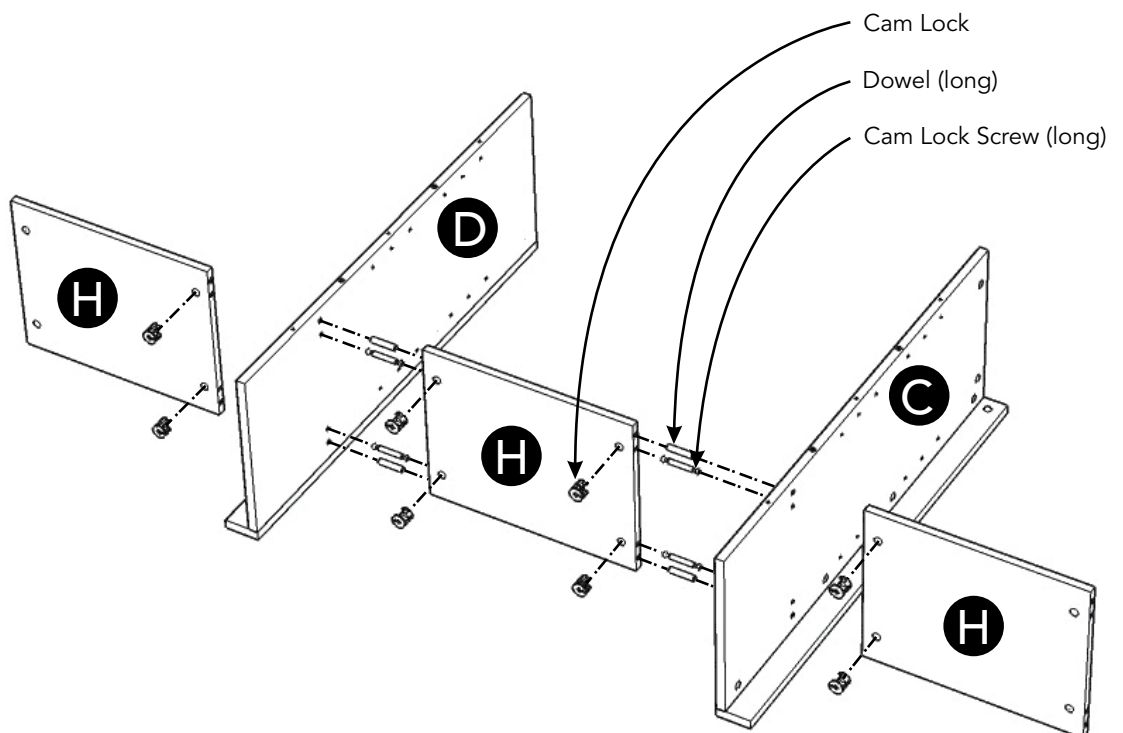
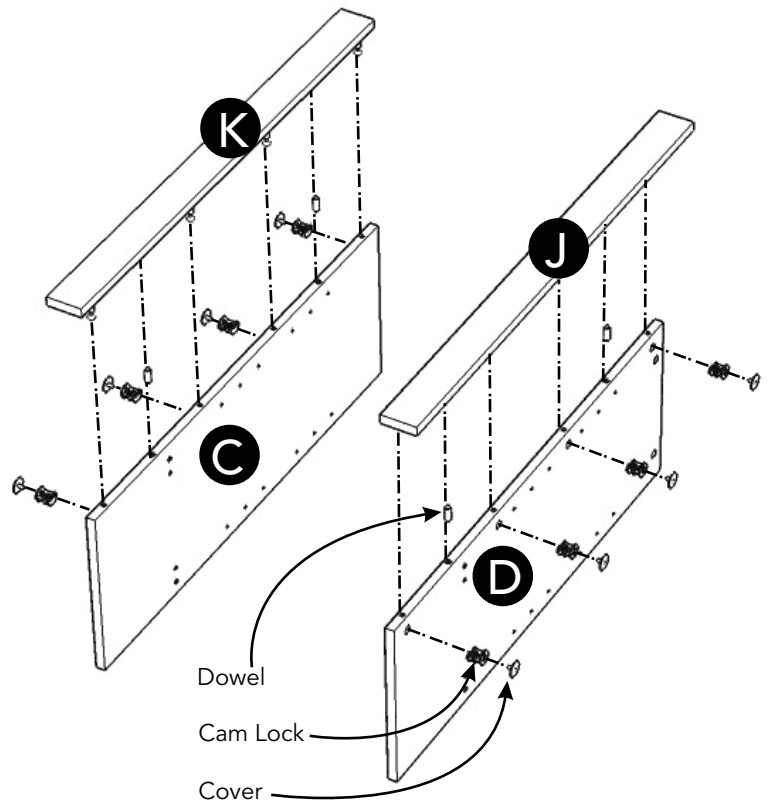

Figure 5



STEP 3

Place Middle Panels (C) and (D) face down on a soft cloth.

Insert Dowels (long) and Cam Lock Screws (long) into pre-drilled holes in Middle Panels (C) and (D).

Attach Shelves (H) to Middle Panels (C) and (D) with Cam Locks. (See Figure 5)

Assembly Instructions 4/8

STEP 4

Attach Back Uprights (L) to Back Rail (F) with Cam Locks.

Note: Assemble so Arrow labels on Back Uprights (L) point to each other.

Slide Back Panel (M) into position.

Attach Back Rail (G) to unit with Cam Locks.

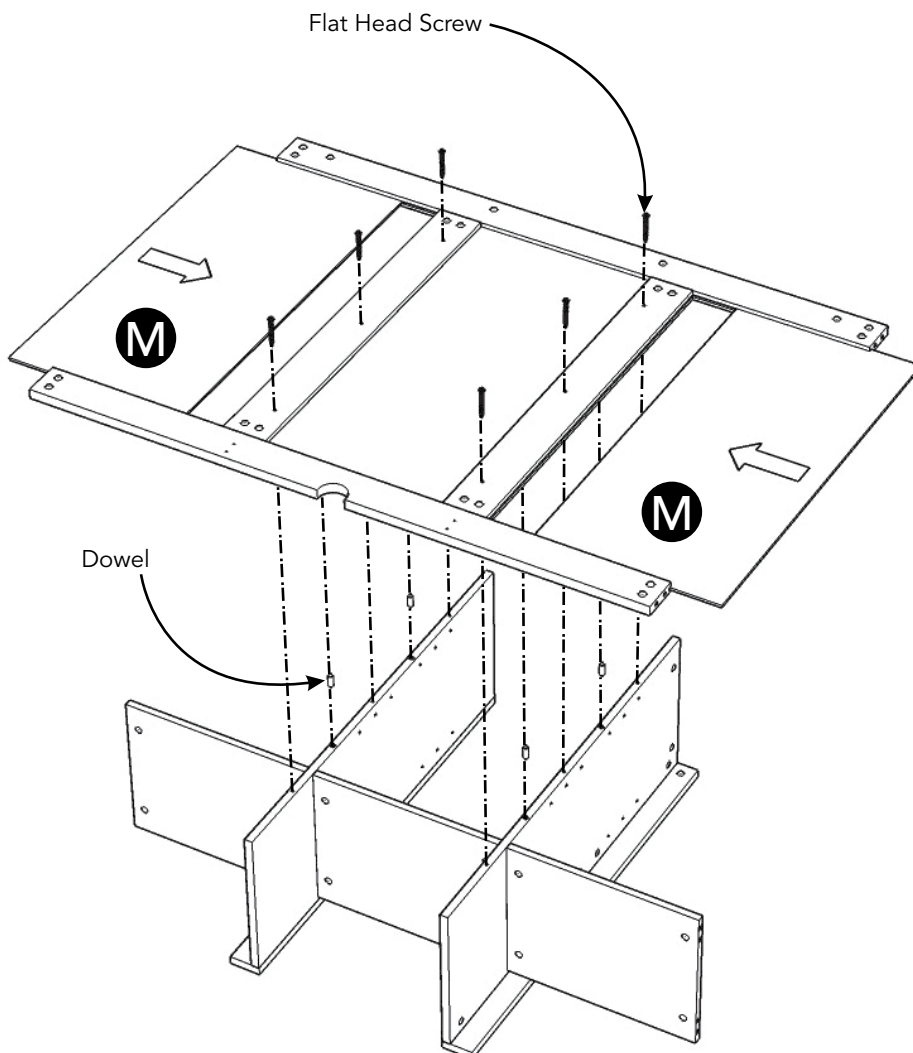
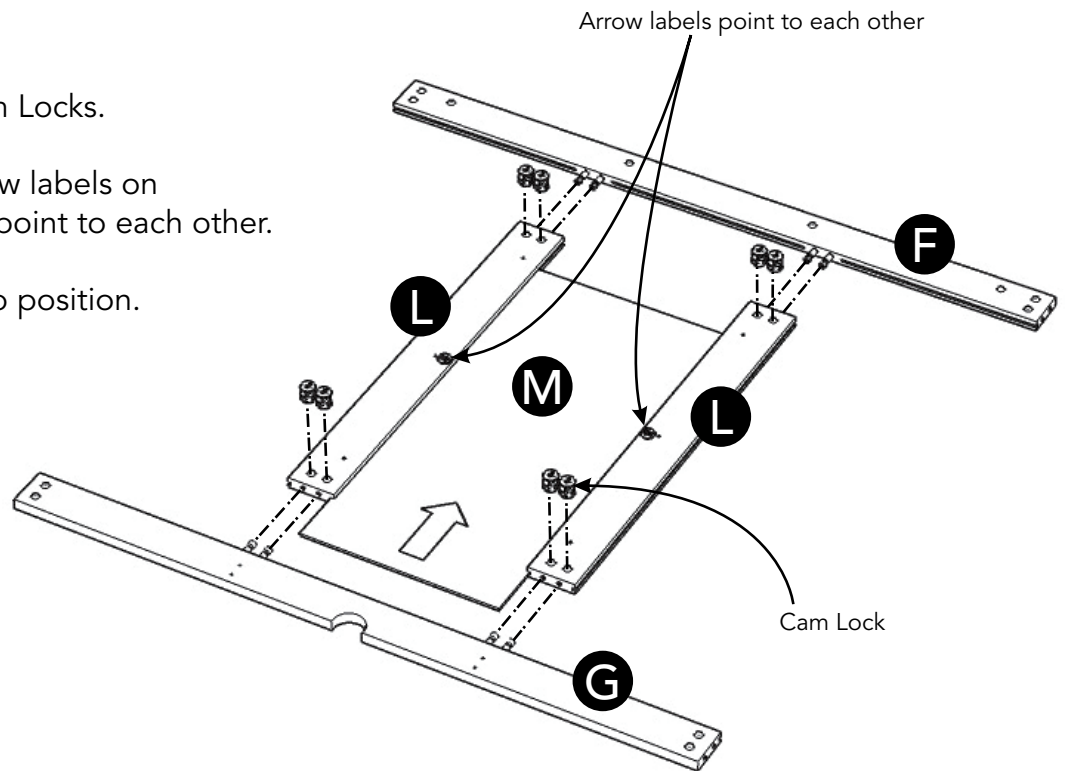

STEP 5

Insert Dowels into pre-drilled holes in unit from Step 3.

Attach unit to unit from Step 3 with Flat Head Screws. (See Figure 6)

Slide Back Panels (M) into position.

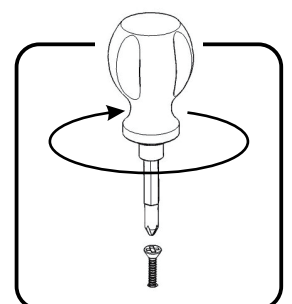

Figure 6

STEP 6

Insert Dowels into pre-drilled holes in Side Panels (B) and (E).

Attach Front Upright (J) to Side Panel (B) and Front Upright (K) to Side Panel (E) with Cam Locks.

Cover Cam Locks with Covers.

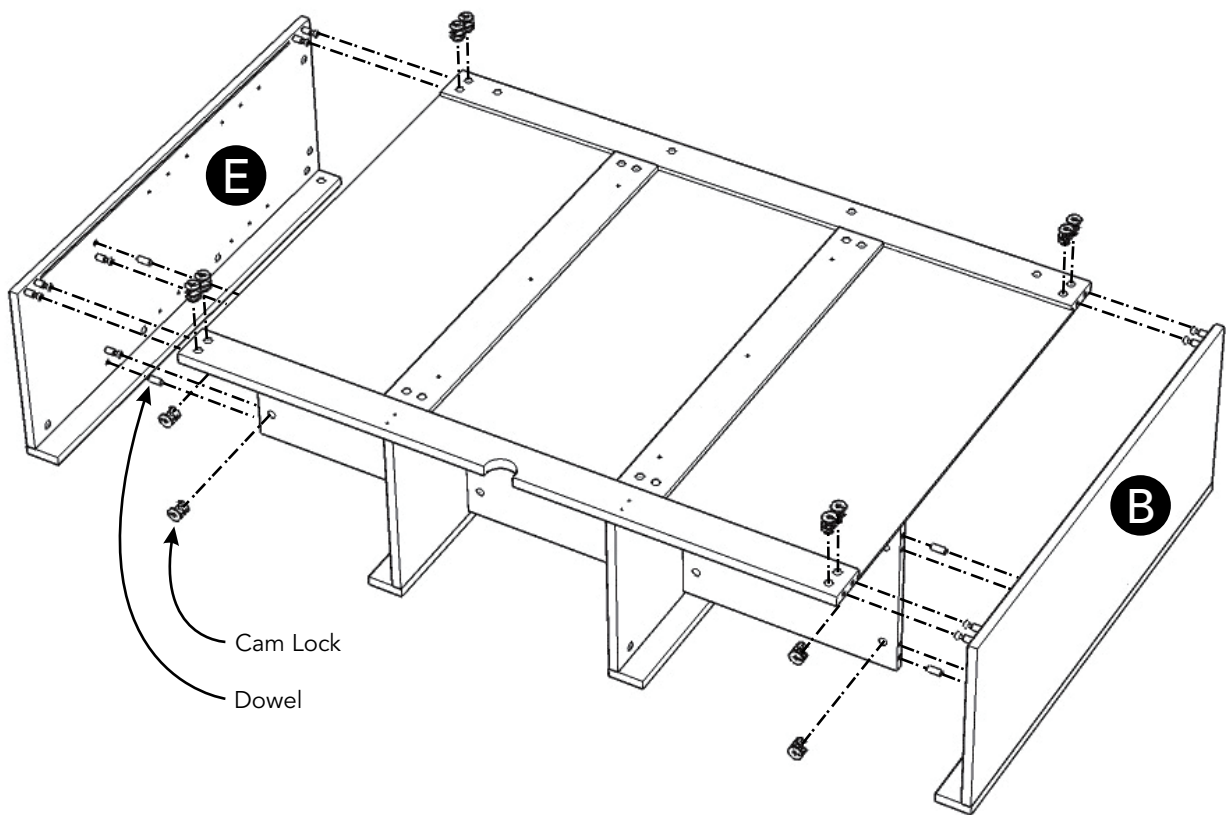
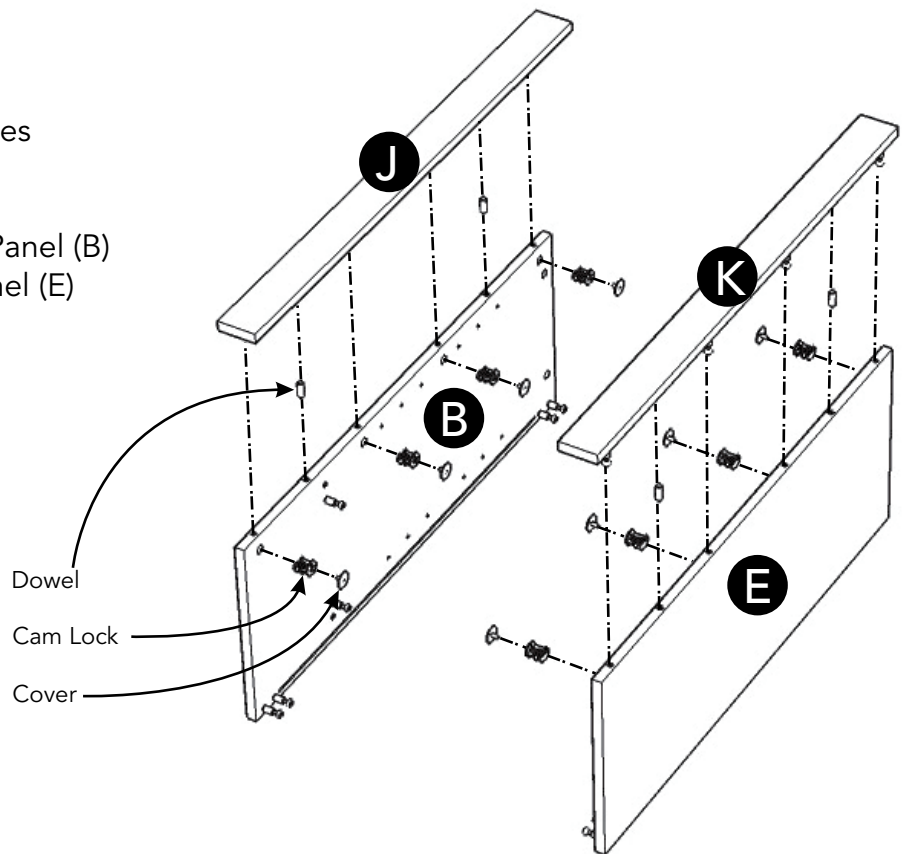

STEP 7

Insert Dowels into pre-drilled holes in unit from Step 5.

Attach Side Panels (B) and (E) to unit with Cam Locks.

STEP 8

Turn unit to its' upright position.

Insert Dowels into pre-drilled holes in unit.

Attach Top (A) to unit with Cam Locks.

Cover Cam Locks with Covers.

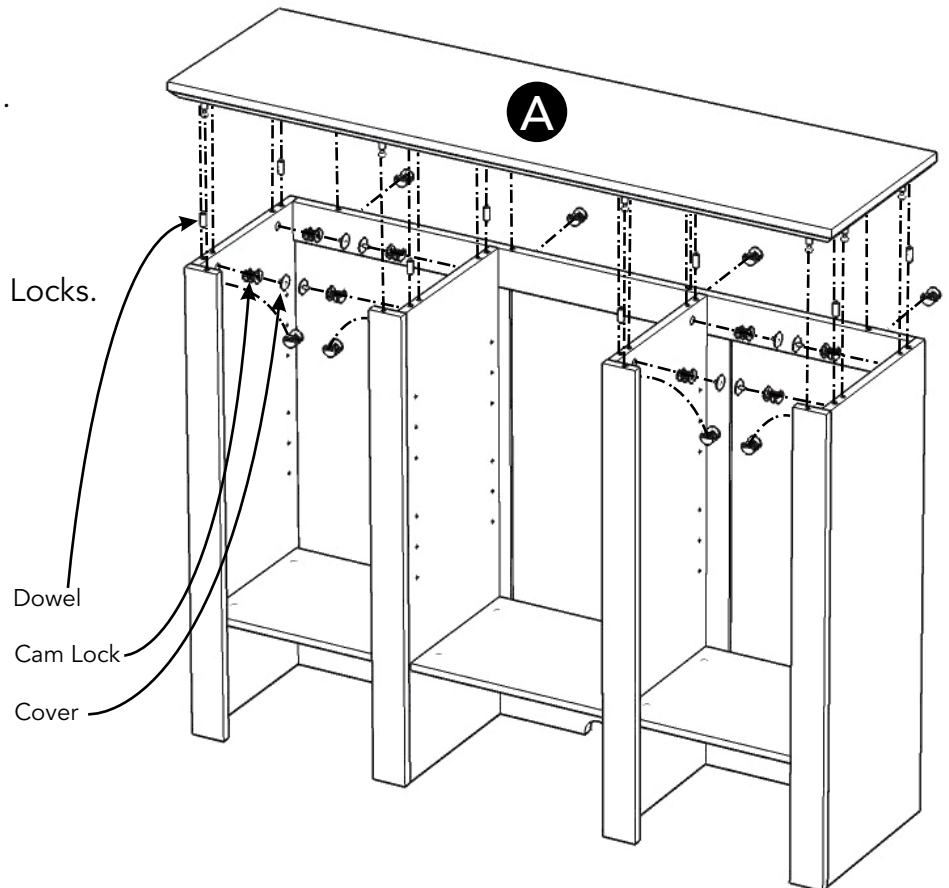

STEP 9

Insert Adjustable Pins into pre-drilled holes in side panels and middle panels at desired level. (See Figure 7)

Place Shelves (I) into position.

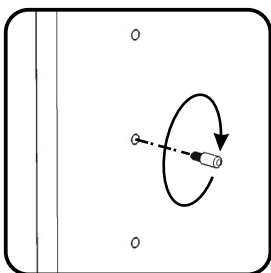
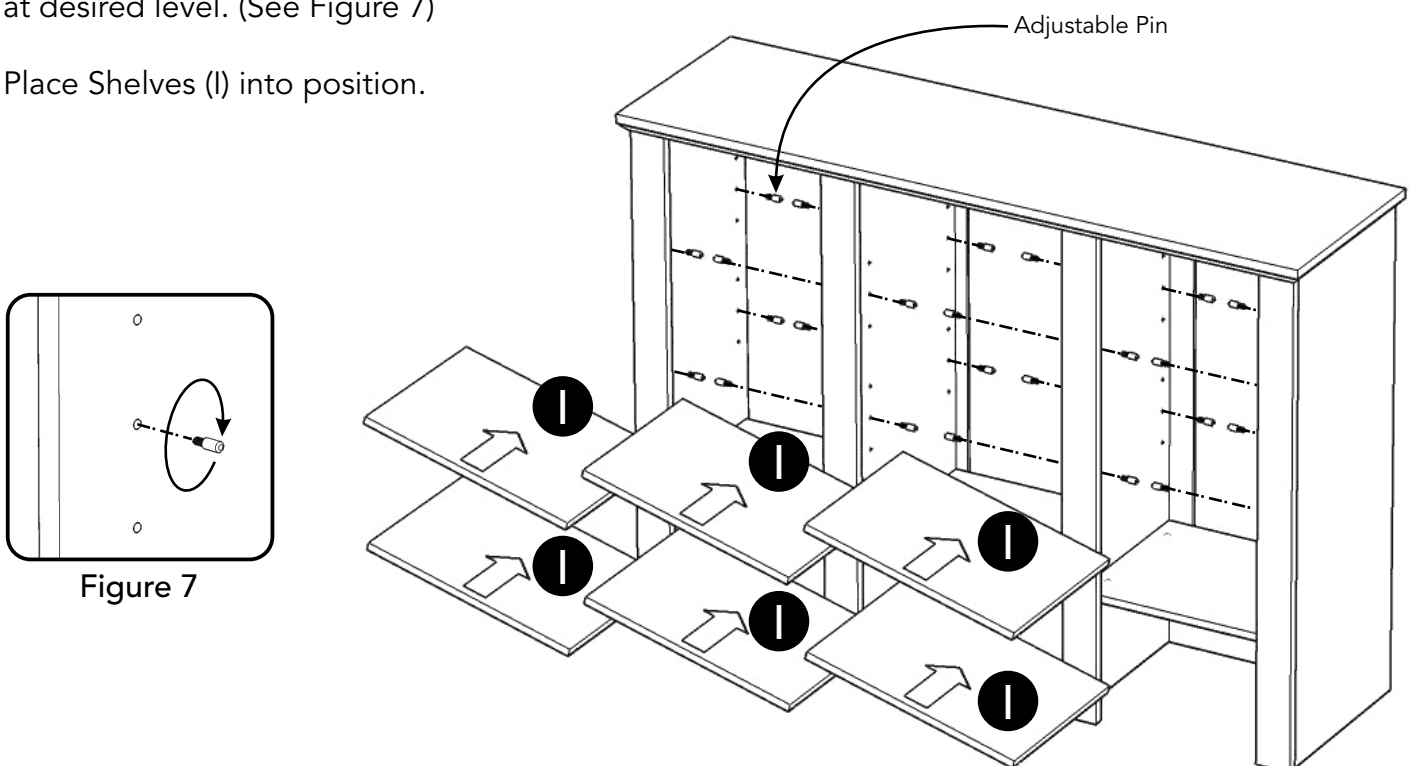

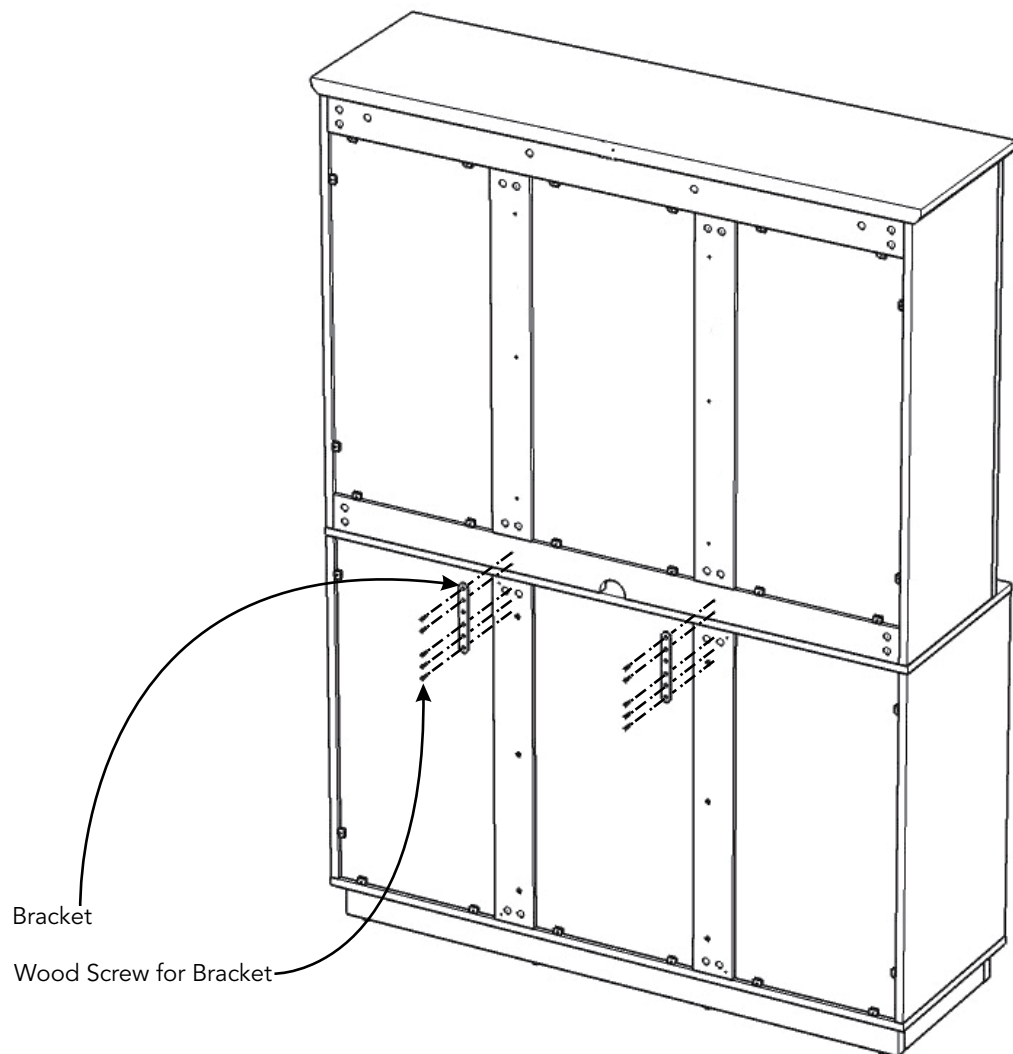

STEP 10

Attach Hutch to Buffet with Brackets by inserting Wood Screws for Bracket into pre-drilled holes. (See Figure 8)

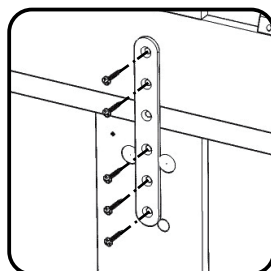

Figure 8

Assembly Instructions 8/8

IMPORTANT

- To help reduce the risk of the unit tipping over, the Tip-over Restraint must be installed following these instructions exactly.

STEP 11

Place unit at desired location.

Drill a 3/8" hole in wall in-line with pre-drilled hole at top of unit.

Move unit.

Insert Anchor into the wall hole and attach Bracket with Wall Screw.

Attach Bracket at pre-drilled hole at top of unit with Wood Screw.

Move unit back into place.

Slide Tip-over Restraint through Bracket on wall and Bracket on unit.
(See Figure 9)

Put tie end of Tip-over Restraint into lock end of Tip-over Restraint and pull until tight.

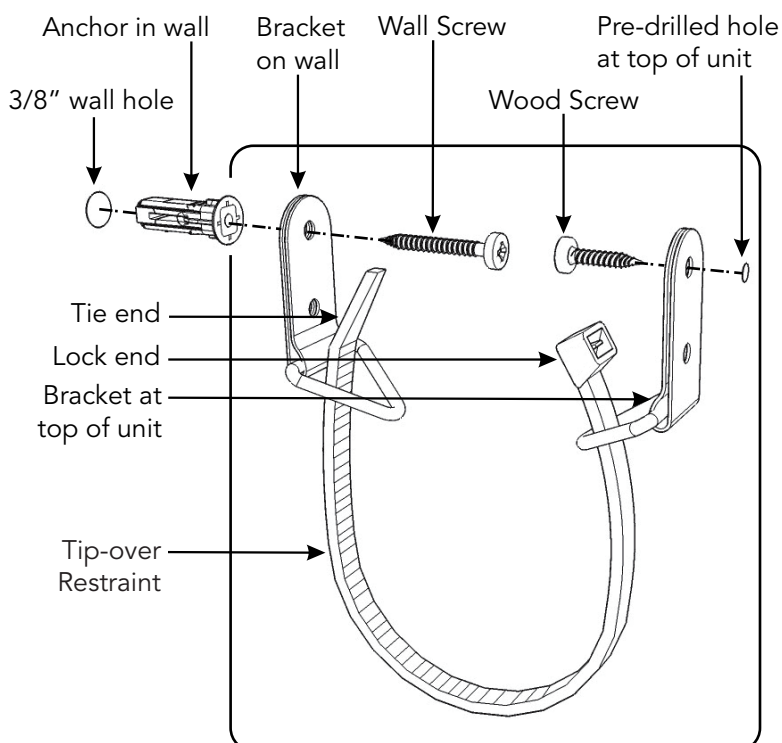
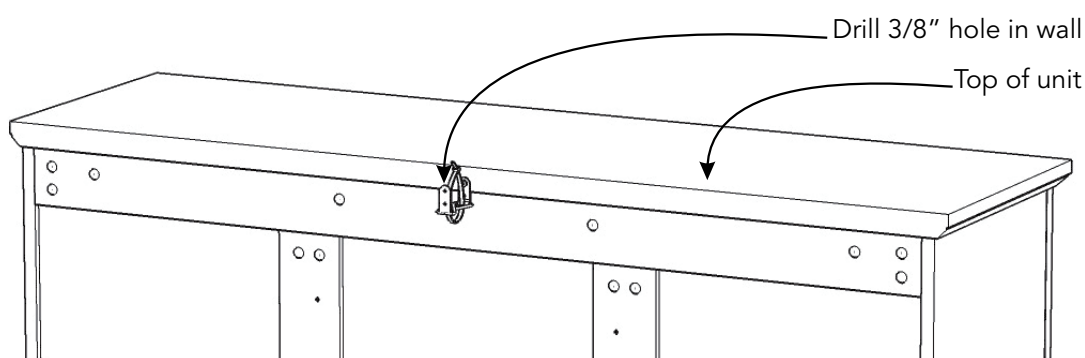
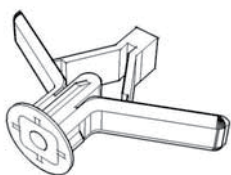

Figure 9



Hardware List



Anchor
1 pc. (+1 extra)

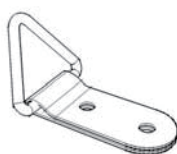

Bracket
2 pcs. (+1 extra)

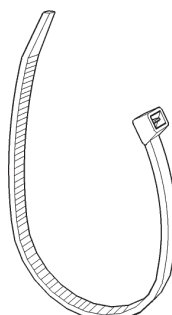

Tip-over Restraint
1 pc. (+1 extra)

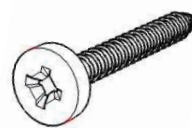

M3.5x38
Wall Screw
1 pc. (+1 extra)

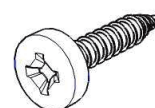

M3x16
Wood Screw
1 pc. (+1 extra)

CARE INSTRUCTIONS

NEVER

allow liquids to remain on furniture.
Absorption causes parts to warp
and split and finishes to delaminate.

NEVER

use glass cleaners on
finished furniture. Ammonia
chemically attacks the finish.



Do not use power tools
above 8 volts to assemble.
**PREVENT
CRACKING**



Do not place
in direct sunlight.
**PREVENT
FADING**



Do not write
directly on surface.
**PREVENT
MARKING**



Do not place hot
objects on surface.
**PREVENT
FINISH DAMAGE**

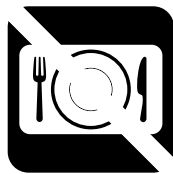

Do not use rubber
based placemats.
**PREVENT
DISCOLORING**



Do not use commercial
waxes and polishes.
**PREVENT
YELLOWING**

CLEAN

with a soft cloth moistened
in lukewarm soap and water.
Buff with a dry clean cloth.



Home Styles will provide replacements free of charge for missing or damaged hardware or parts within 30 days of purchase. Digital images of the defective parts may be required. If the product was not purchased from an authorized retail affiliate, Home Styles is under no obligation to provide replacement parts. Parts are not available for fully assembled items nor are parts available for sale. Replacements for missing or damaged hardware or parts may be requested at:

www.homestyles-furniture.com/customer-service/replacement-parts

Home Styles Customer Service: www.homestyles-furniture.com,
servicedesk@homestyles-furniture.com, 888-680-7460, 877-831-0319