

DWG. NO.		451-500-0850H	
REV	DESCRIPTION	BY DATE	APPD
A	ECR 7416	JHT 1/22/02	JHT

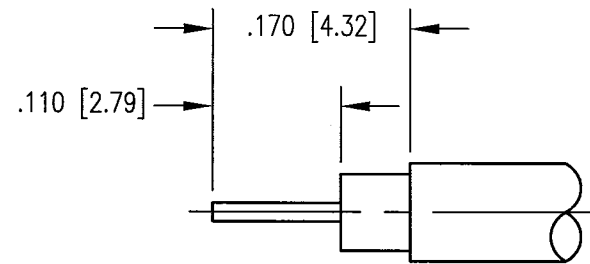
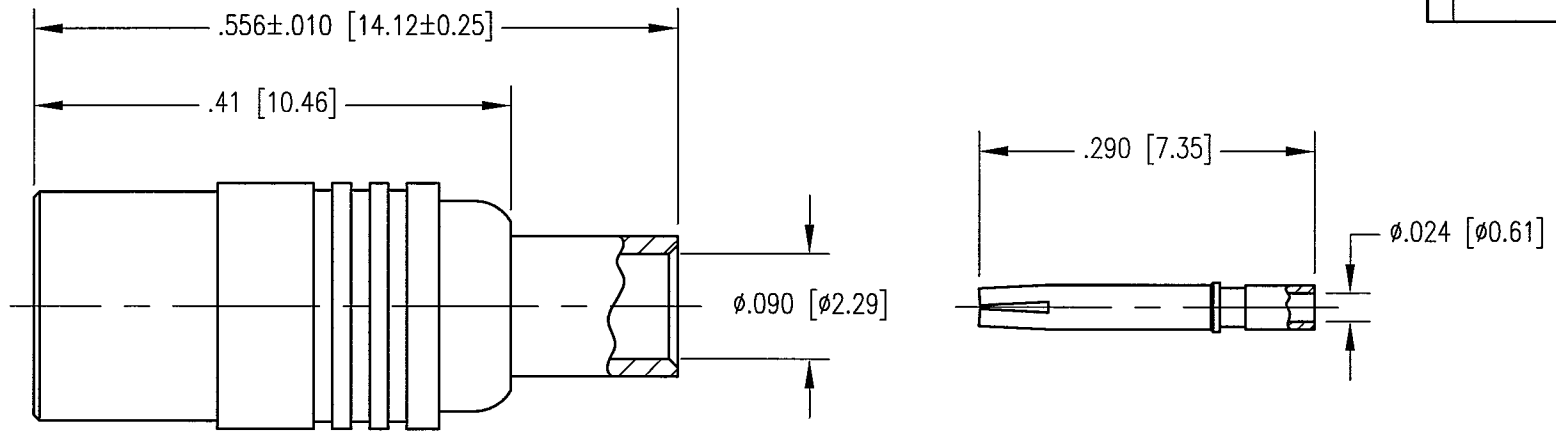

CABLE TRIMMING DIMENSIONS

NOTES:

- MATERIALS:  
 BODIES: BRASS PER ASTM B16  
 CENTER CONTACT: COPPER ALLOY  
 INSULATORS: TEFLON PER ASTM D1710
- FINISHES:  
 BODIES: .000015 MIN. GOLD PER MIL-G-45204 OVER  
 .000050 MIN. NICKEL PER QQ-N-290  
 CENTER CONTACT: .000030 MIN. GOLD PER MIL-G-45204 OVER  
 .000050 MIN. NICKEL PER QQ-N-290
- FOR USE WITH .085 DIA. SEMI-RIGID CABLE OR EQUIVALENT.
- FOR CABLING PROCEDURES USE CAP 5-11 WITH TRIMMING DIMENSIONS SHOWN.

PER ASME Y14.5M-1994 UNLESS OTHERWISE SPECIFIED: DIMENSIONS ARE IN INCHES [MM]		<b>NORTHROP GRUMMAN</b>	
TOLERANCES: DECIMALS .XX ± .01 [0.254] XXX ± .005 [0.127] ANGLES ± 2°		Winchester Electronics 400 Park Road Watertown, CT 06795	
SCALE: 5:1		TITLE	
<b>CUSTOMER DRAWING</b>		<b>MCX STRAIGHT JACK</b>	
DRAWN JED	DATE 12/26/97	CHECKED PAT	DATE 12/26/97
APPROVED KJT	DATE 12/26/97	APPROVED KJT	DATE 12/26/97
A		451-500-0850H	SHT. 1 OF 1 REV. A