

# Assembly Guide



**Bush**  
FURNITURE



If you're having any difficulty during assembly of this product, don't hesitate to call us at **1-800-950-4782.**

Our customer service experts are trained to provide step-by-step instruction and can easily replace any missing or damaged parts.

**Representatives are available Monday-Friday from 8:30 a.m. to 7:30 p.m. (ET)**

## 48W Lift Top Coffee Table

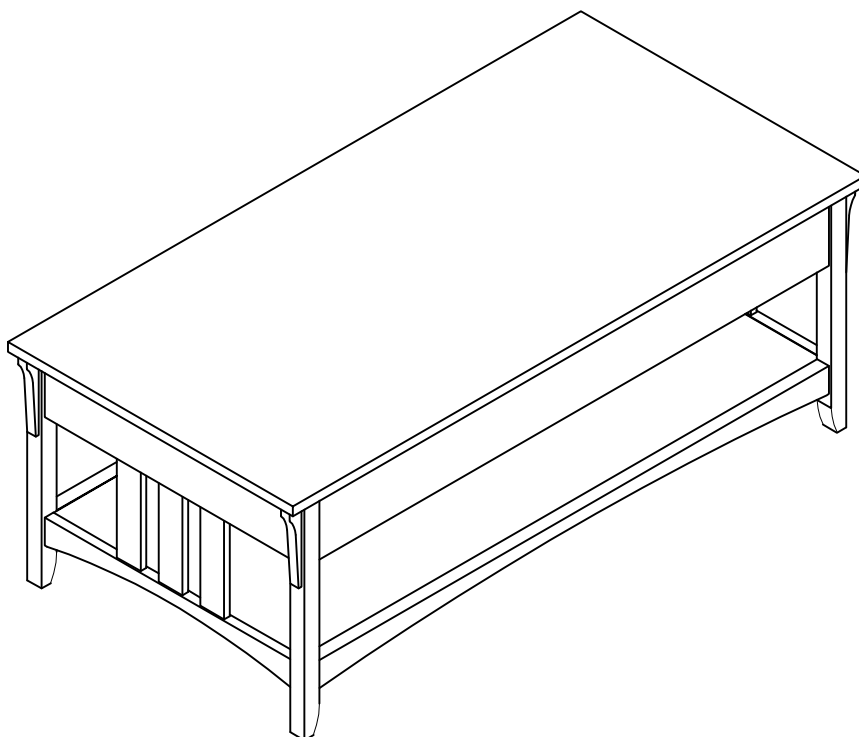

Lot Code #

Part Number A198529

Keep manual for future reference.

**For best results, keep these tips in mind:**

- ① We know you want to finish this assembly as quickly as possible, but trust us: you'll have a better experience if you take it one step at a time.
- ② Give yourself some room to work near where you want the fully assembled product.
- ③ If your floor isn't carpeted, assemble this product on the empty carton to avoid scratching.
- ④ Do you have a friend who owes you a favor? Some steps may go a little easier with a second set of hands.

**DOs**

- ✔ Use a #2 Phillips head screwdriver (or other handheld tools as indicated)
- ✔ Wear safety glasses at all times during assembly
- ✔ Carefully follow the instructions in this guide and complete all steps in order
- ✔ Give us a call if you're having trouble with a particularly tricky step

**DON'Ts**

- ✘ We know power tools are quick and easy, but you shouldn't use them when assembling this product (unless otherwise specified)
- ✘ Never move your furniture with items inside or resting on the surface
- ✘ Do not attempt to use this product before all steps have been completed

**Watch assembly videos right on your phone or computer!**

Some steps include QR codes that link to helpful videos. Watch out for the icon on the left! Simply open up your smartphone camera to scan the code.

*(Users of older smartphones may need to install a QR Reader.)*

**SCAN HERE****FOR VIDEOS**

Or visit <https://www.bushfurniture.com/CustomerService/HowtoAssemble.aspx>

# IMPORTANT SAFETY INFORMATION



## PLEASE READ WARNINGS

Improper use can cause safety hazards, or damage to your furniture and household items.

Warning	Do	Don't	Why it's important
<b>Serious injury may occur.</b>	Assemble following all instructions using all indicated parts and hardware provided.	<ul style="list-style-type: none"> <li>Do not move unit when loaded.</li> <li>Do not load with a television or other heavy equipment.</li> <li>Do not exceed the maximum load limits stated in the instructions.</li> <li>Do not sit or stand on adjustable height surface.</li> </ul>	Improper assembly, use or loading can lead to product instability, tip-over or collapse.
<b>Serious injury may occur.</b>	Maintain 1 inch (25mm) clearance between unit and all other furniture at all times.	<ul style="list-style-type: none"> <li>Do not place hands close to the mechanism when lifting or lowering the adjustable height surface.</li> </ul>	Pinch points exist in the mechanism and may be created by placing the unit too close to other furniture and objects.
<b>Death or serious injury may occur.</b>		<ul style="list-style-type: none"> <li>Do not allow children to operate the adjustable height mechanism.</li> </ul>	Unattended or improper use by children may lead to product instability or entrapment.

Advertencia	Hacer	No	Por qué es importante
<b>Se pueden producir lesiones graves.</b>	Ensamble siguiendo todas las instrucciones utilizando todas las piezas y ferretería indicados provistos.	<ul style="list-style-type: none"> <li>No mueva la unidad cuando esté cargada.</li> <li>No cargue con un televisor u otro equipo pesado.</li> <li>No exceda los límites máximos de carga establecidos en las instrucciones.</li> <li>No se sienta ni se pare sobre una superficie de altura ajustable.</li> </ul>	El ensamblaje, uso o carga inadecuados pueden provocar inestabilidad del producto, vuelco o colapso.
<b>Se pueden producir lesiones graves.</b>	Mantenga 1 pulgada (25 mm) espacio libre entre la unidad y todos los demás muebles en absoluto veces.	<ul style="list-style-type: none"> <li>No coloque las manos cerca del mecanismo al levantar o bajar la superficie de altura ajustable.</li> </ul>	Los puntos de pellizco existen en el mecanismo y pueden crearse colocando la unidad demasiado cerca de otros muebles y objetos.
<b>Se pueden producir lesiones graves o la muerte.</b>		<ul style="list-style-type: none"> <li>No permita que los niños operen el mecanismo de altura ajustable.</li> </ul>	El uso inadecuado o desatendido por parte de los niños puede provocar inestabilidad o atrapamiento del producto.

# IMPORTANT SAFETY INFORMATION



## PLEASE READ WARNINGS

Improper use can cause safety hazards, or damage to your furniture and household items.

Avertissement	Faire	Ne le fais pas	Pourquoi c'est important
<b>Des blessures graves peuvent survenir.</b>	Assemblez en suivant toutes les instructions en utilisant toutes les pièces et le matériel indiqués fournis.	<ul style="list-style-type: none"><li>• Ne déplacez pas l'unité lorsqu'elle est chargée.</li><li>• Ne chargez pas avec un téléviseur ou un autre équipement lourd.</li><li>• Ne dépassez pas les limites de charge maximale indiquées dans les instructions.</li><li>• Ne vous asseyez pas et ne vous tenez pas debout sur une surface à hauteur réglable.</li></ul>	Un assemblage, une utilisation ou un chargement incorrects peuvent entraîner une instabilité du produit, un renversement ou un effondrement.
<b>Des blessures graves peuvent survenir.</b>	Maintenir 1 pouce (25 mm) jeu entre les unités et tous les autres meubles du tout fois.	<ul style="list-style-type: none"><li>• Ne placez pas les mains à proximité du mécanisme lorsque vous soulevez ou abaissez la surface réglable en hauteur.</li></ul>	Des points de pincement existent dans le mécanisme et peuvent être créés en plaçant l'appareil trop près d'autres meubles et objets.
<b>Des blessures graves ou la mort peuvent survenir.</b>		<ul style="list-style-type: none"><li>• Ne laissez pas les enfants utiliser le mécanisme réglable en hauteur.</li></ul>	Une utilisation sans surveillance ou inappropriée par des enfants peut entraîner une instabilité ou un piégeage du produit.

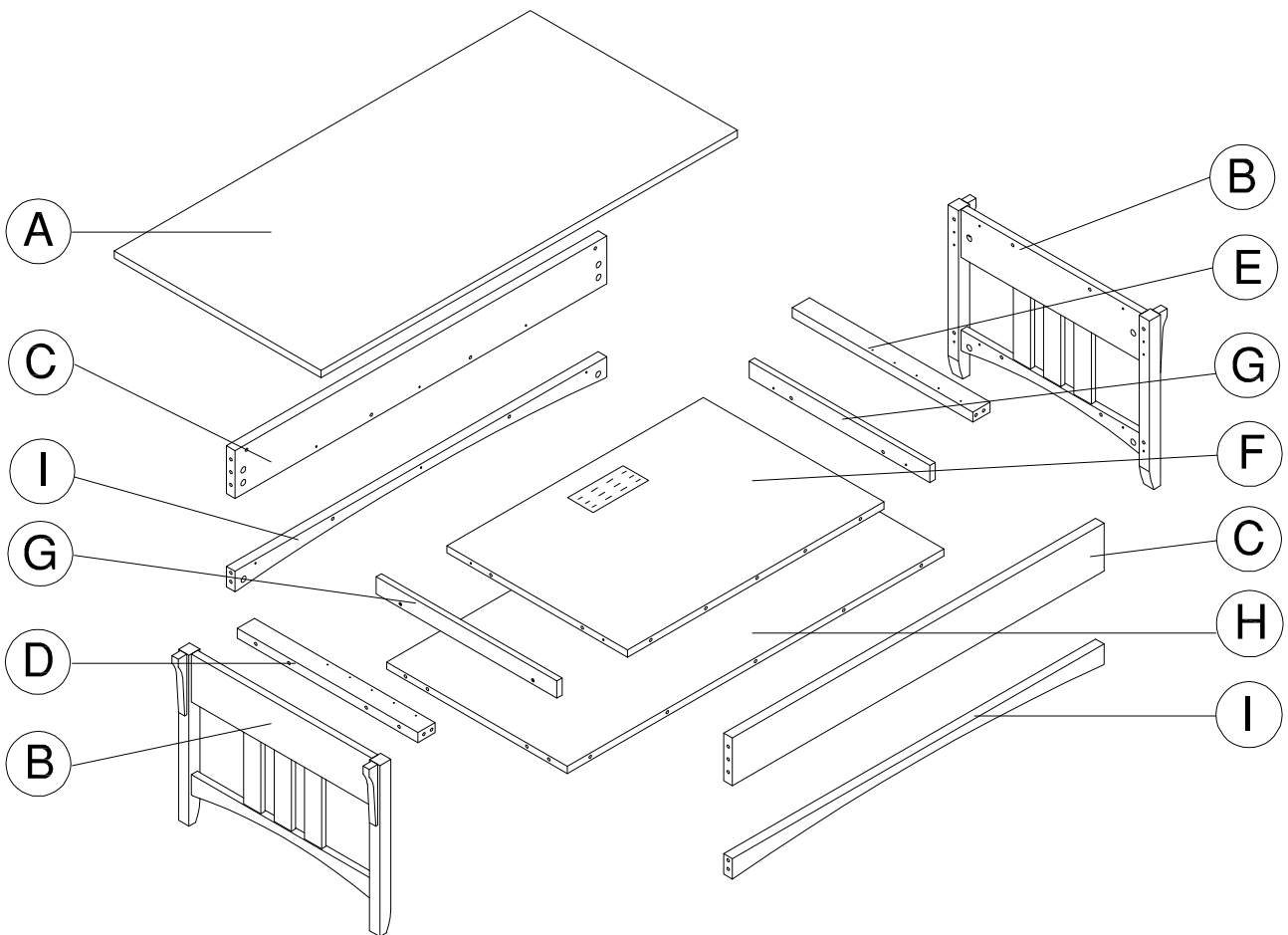
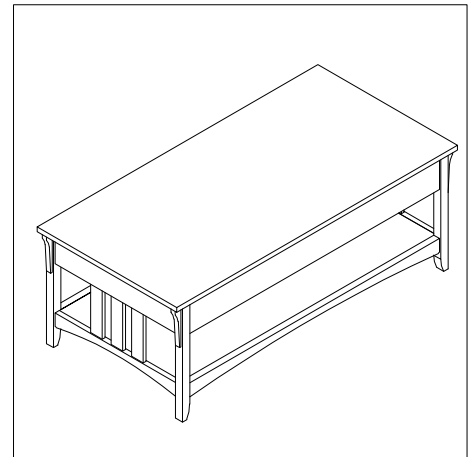

Have an assembly question or need a replacement part? Just call  
**1-800-950-4782**, we are here to help.

Fasteners are shown actual size.

H181468

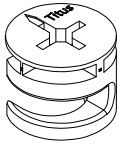

KD Cam

[ 32 ]

H180604

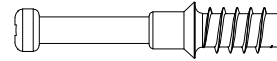

KD Bolt

[ 32 ]

H38169



Wood Dowel  
8 x 30mm

[ 32 ]

H26053

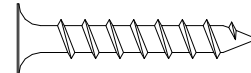

#10 x 1-1/4"

[ 4 ]

H204610

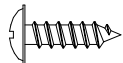

#6 x 1/2"

[ 14 ]

Have an assembly question or need a replacement part? Just call  
**1-800-950-4782**, we are here to help.

Hardware not to scale.

H200016

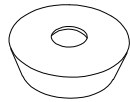

[ 6 ]

Bumper-Clear

H204630



[ 4 ]

Bracket

H189068



[ 2 ]

Connecting bar 891mm



[ 8 ]

Cover Cap

Have an assembly question or need a replacement part? Just call  
**1-800-950-4782**, we are here to help.

Hardware not to scale.

## Q184665

Z184666

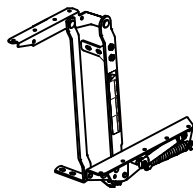

[ 1 ]

RT Side Assembly

Z184667

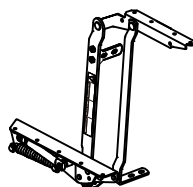

[ 1 ]

LT Side Assembly

Z184669



[ 8 ]

M6 x 28mm

Z184671



[ 8 ]

1/4-20 Nut

H23119

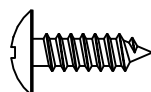

[ 18 ]

#10 x 5/8"

Have an assembly question or need a replacement part? Just call  
**1-800-950-4782**, we are here to help.



# STEP 1

# Prepare Panels

A198529

H180604

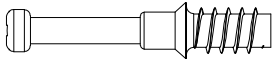

[ 6 ]

KD Bolt

H38169

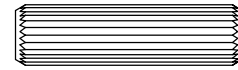

[ 4 ]

Wood Dowel  
8 x 30mm

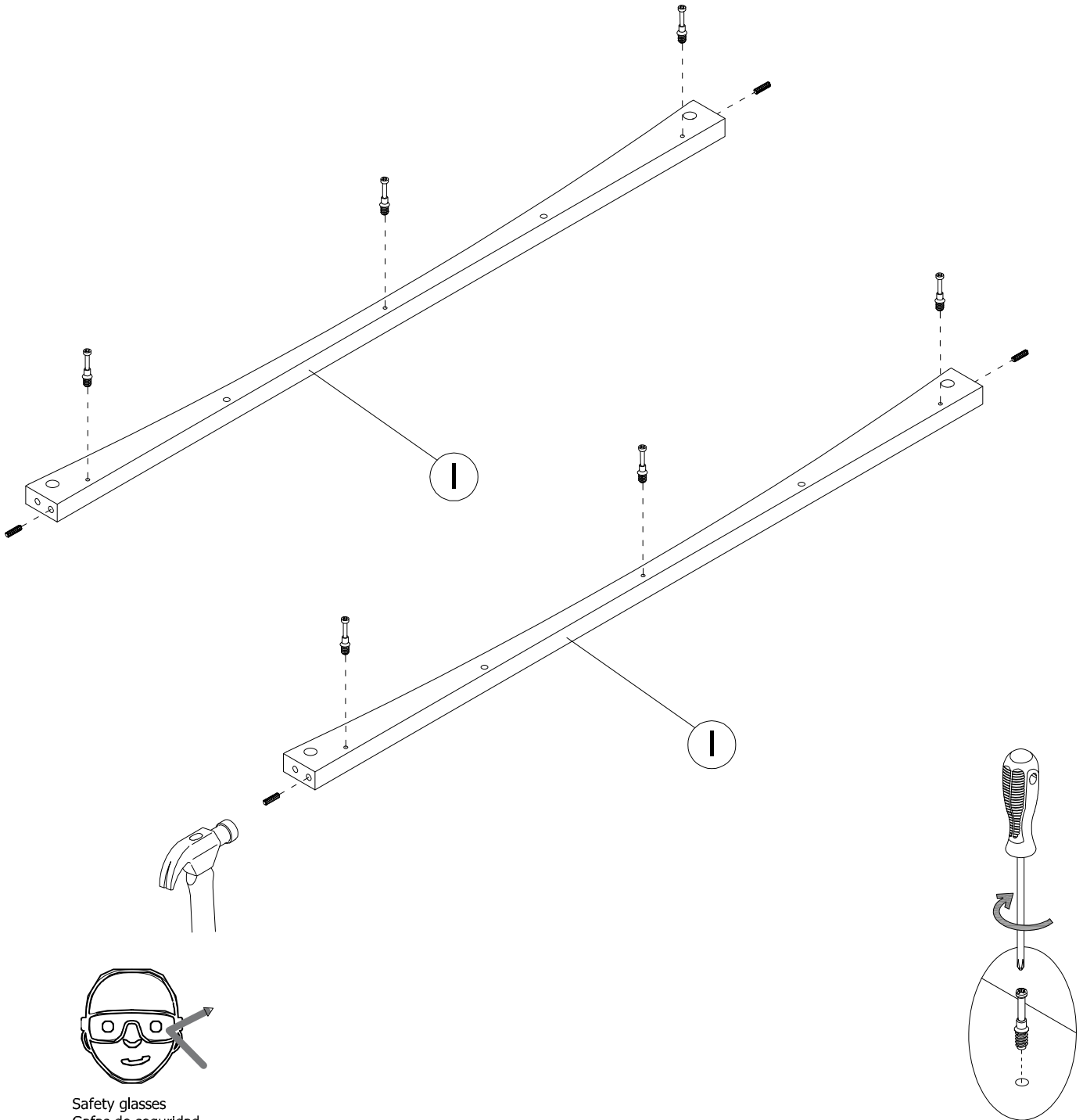

Safety glasses  
Gafas de seguridad  
Lunettes de protection

Have an assembly question or need a replacement part? Just call  
**1-800-950-4782**, we are here to help.

# STEP 2

# Prepare Panels

A198529

H38169

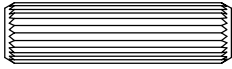

[ 16 ]

Wood Dowel  
8 x 30mm

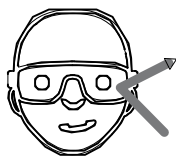
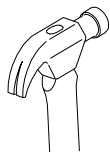
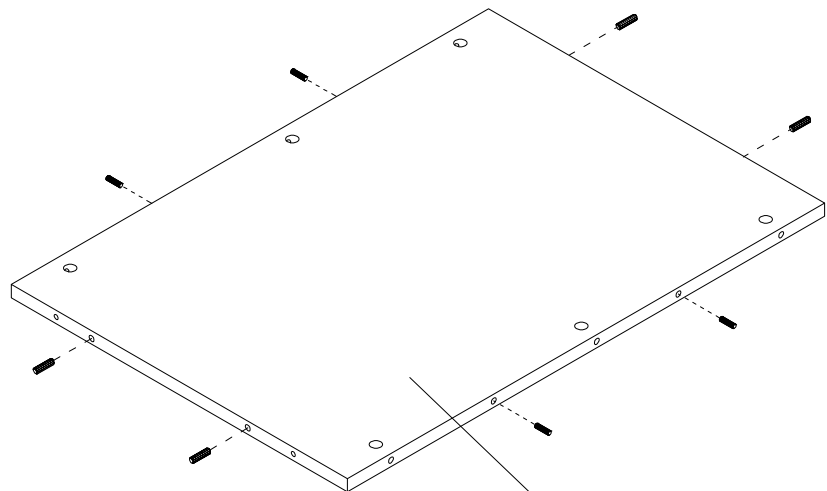
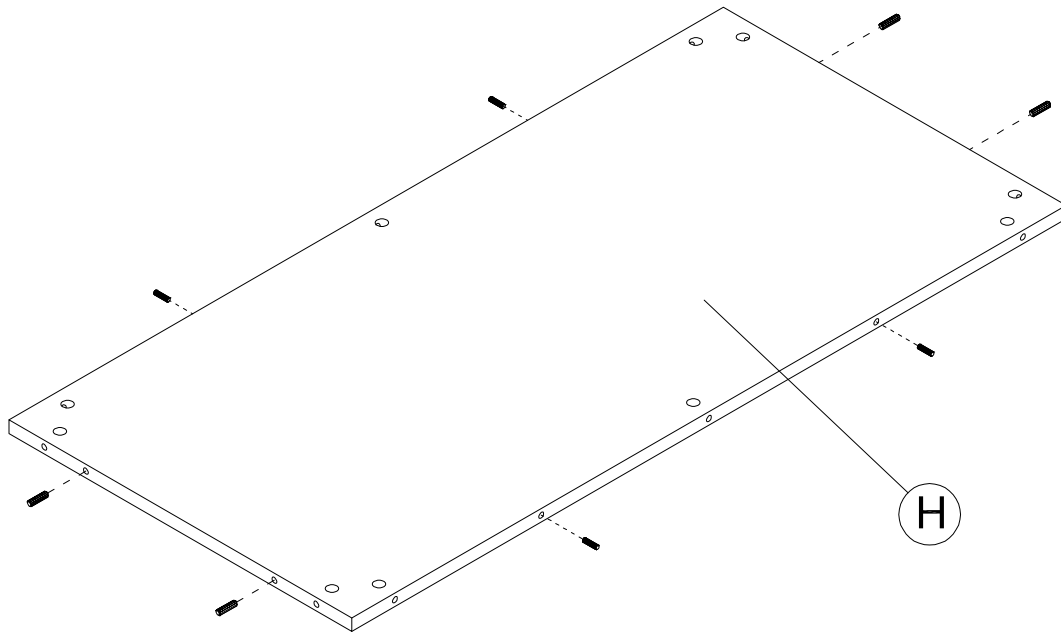

Safety glasses  
Gafas de seguridad  
Lunettes de protection

Have an assembly question or need a replacement part? Just call  
**1-800-950-4782**, we are here to help.

# STEP 3

# Assemble Panels

A198529

Scan QR Code to Watch Video on:



How to Tighten KD Cams

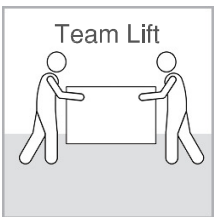

H181468

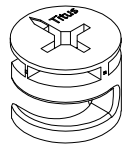

KD Cam

[ 6 ]

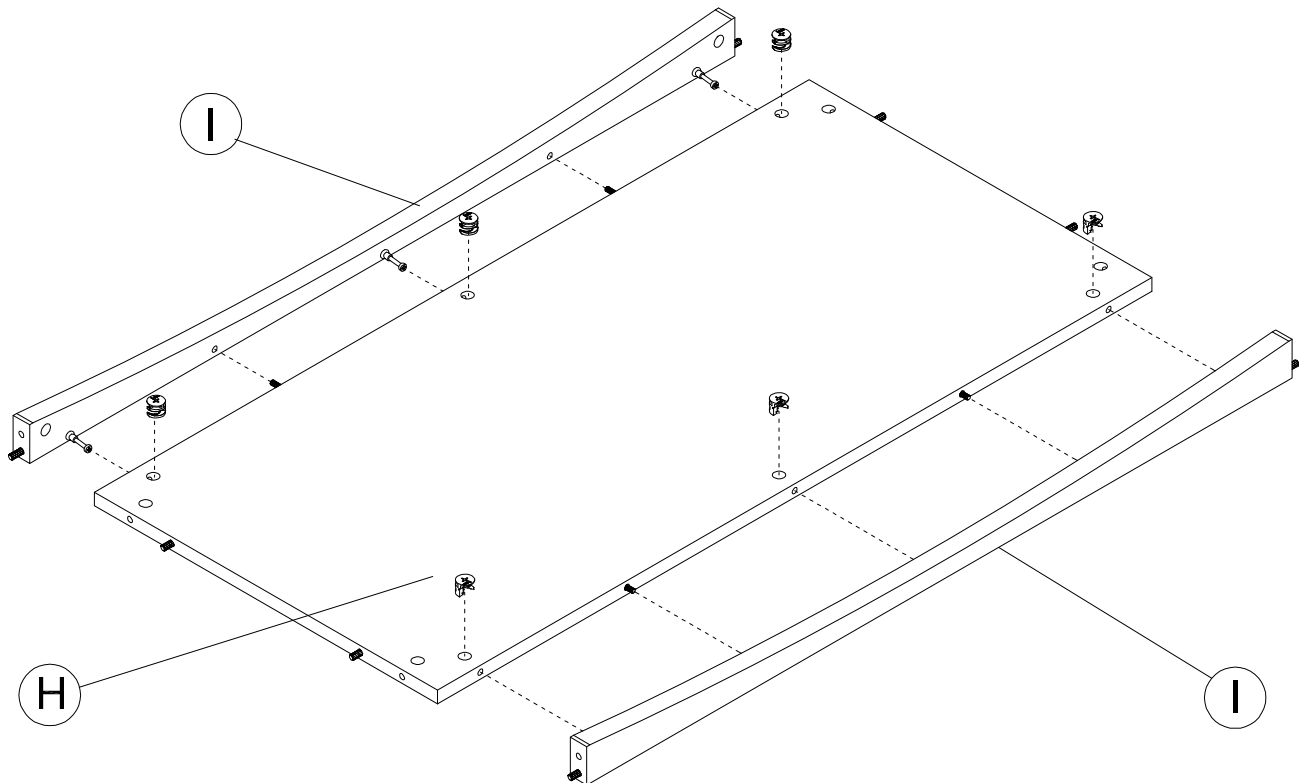
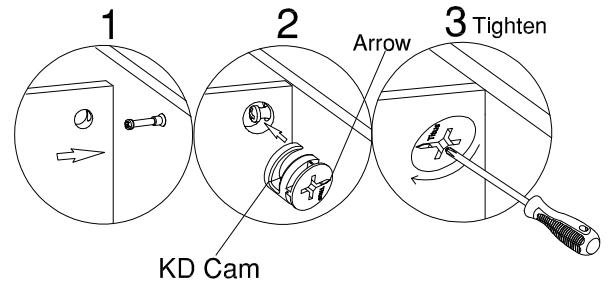

Have an assembly question or need a replacement part? Just call **1-800-950-4782**, we are here to help.

# STEP 4

# Assemble Panels

A198529

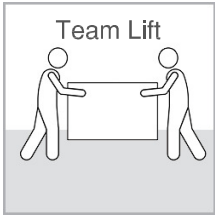

H26053

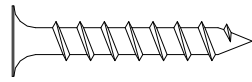

[ 4 ]

#10 x 1-1/4"

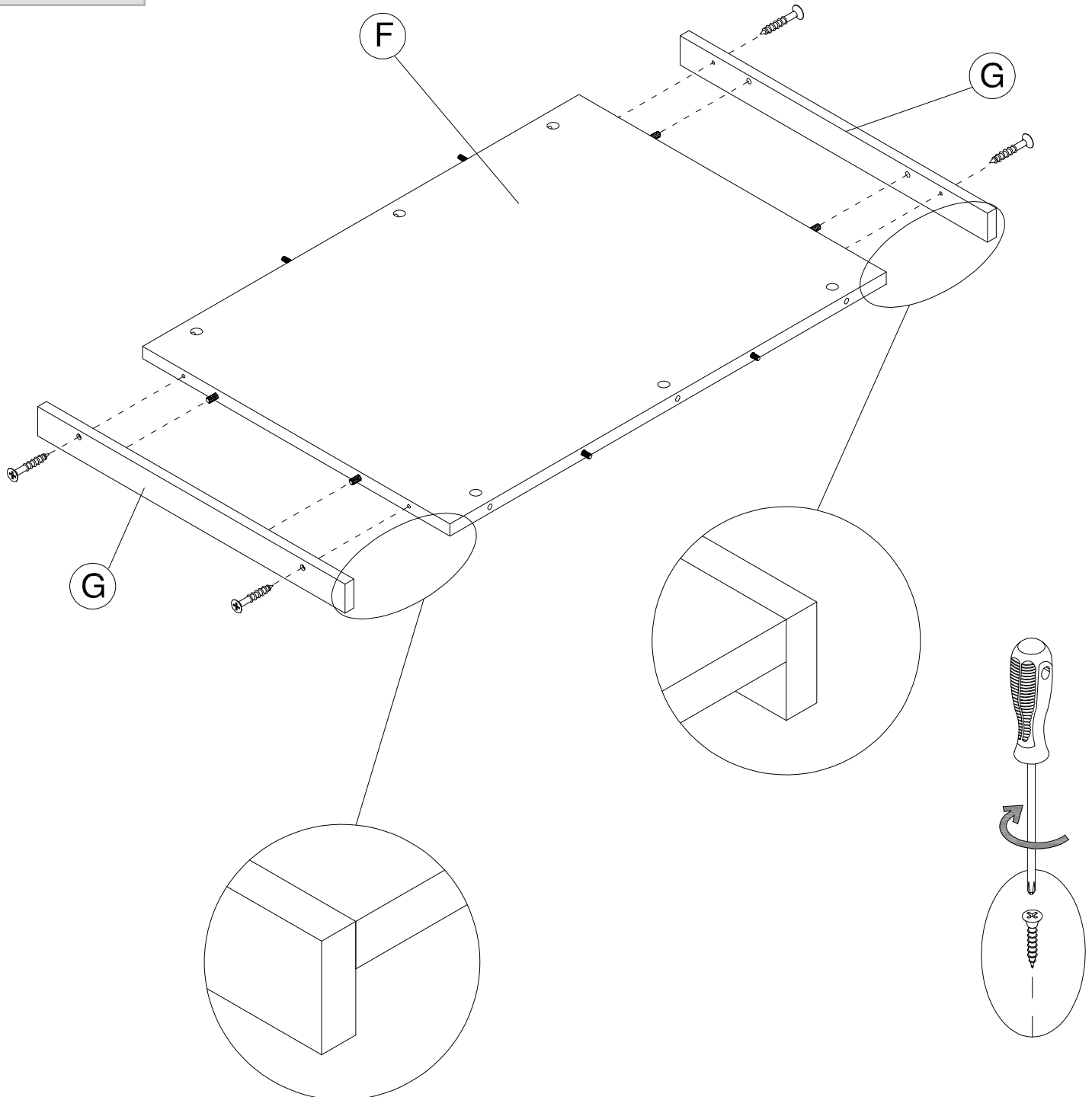

Have an assembly question or need a replacement part? Just call  
**1-800-950-4782**, we are here to help.

# STEP 5

# Prepare Panels

A198529

H180604

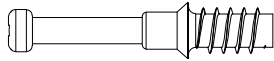

[ 6 ]

KD Bolt

H38169

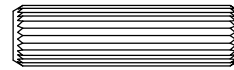

[ 12 ]

Wood Dowel  
8 x 30mm

H204610

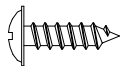

[ 4 ]

#6 x 1/2"

H204630

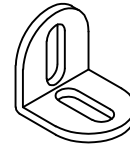

[ 4 ]

Bracket

Do not fully tighten.  
No apriete completamente.  
Ne pas viser a fond.

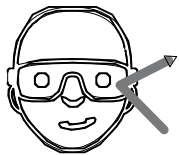

Safety glasses  
Gafas de seguridad  
Lunettes de protection

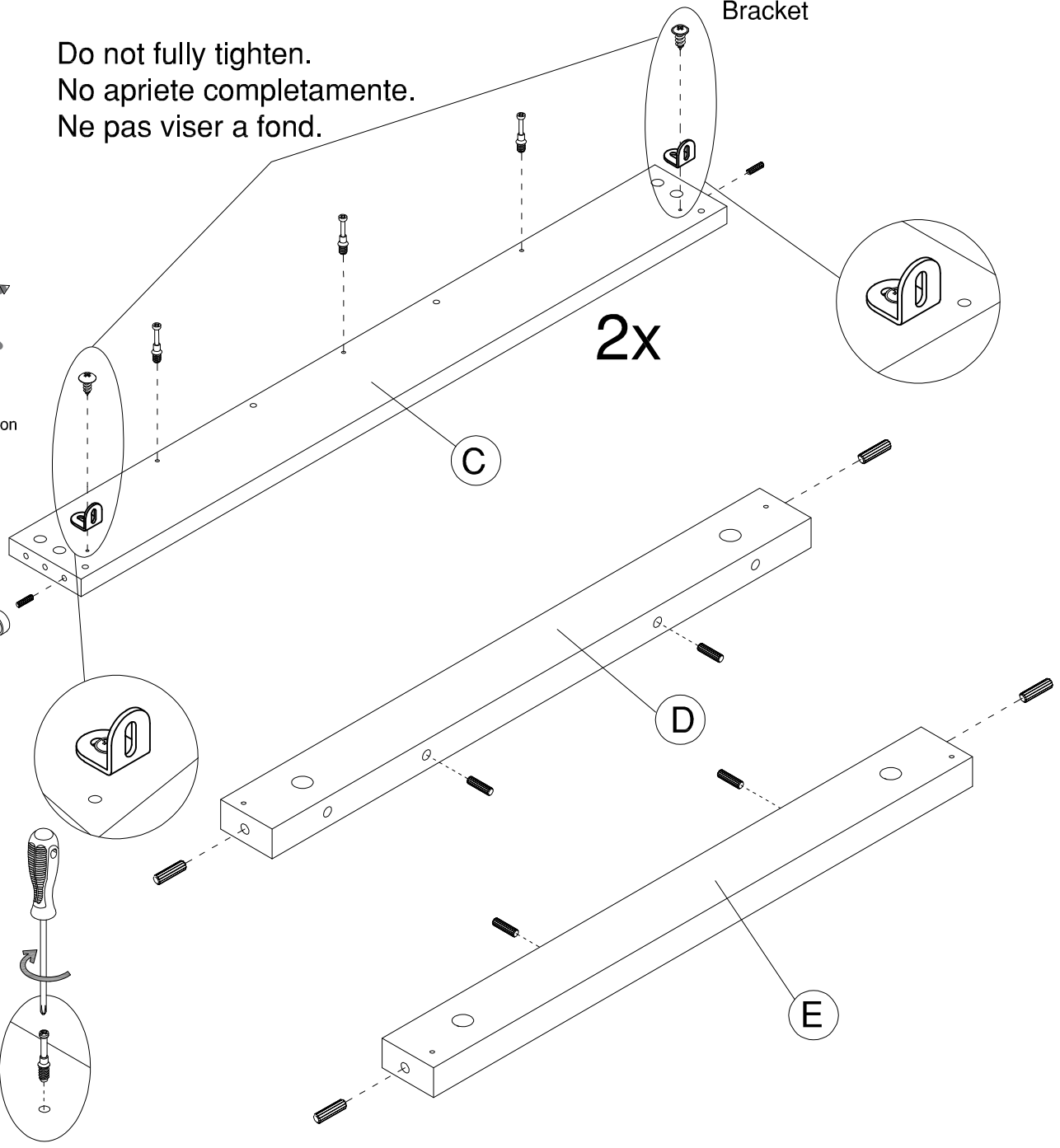

Have an assembly question or need a replacement part? Just call  
**1-800-950-4782**, we are here to help.

# STEP 6

# Assemble Panels

A198529

Scan QR Code to Watch Video on:



How to Tighten KD Cams

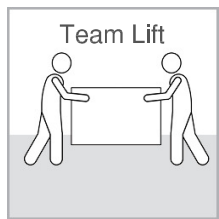

H181468

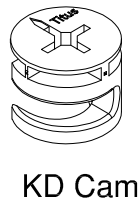

[ 3 ]

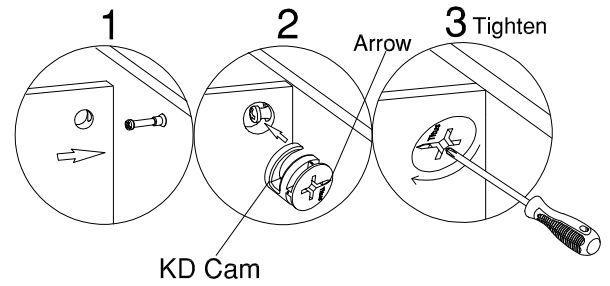

**CAUTION**

Do not sit on adjustable height work surface. Maximum load 20 lbs (9 kg). For use with computer monitor, keyboard, and light work.

**DO NOT REMOVE LABEL**

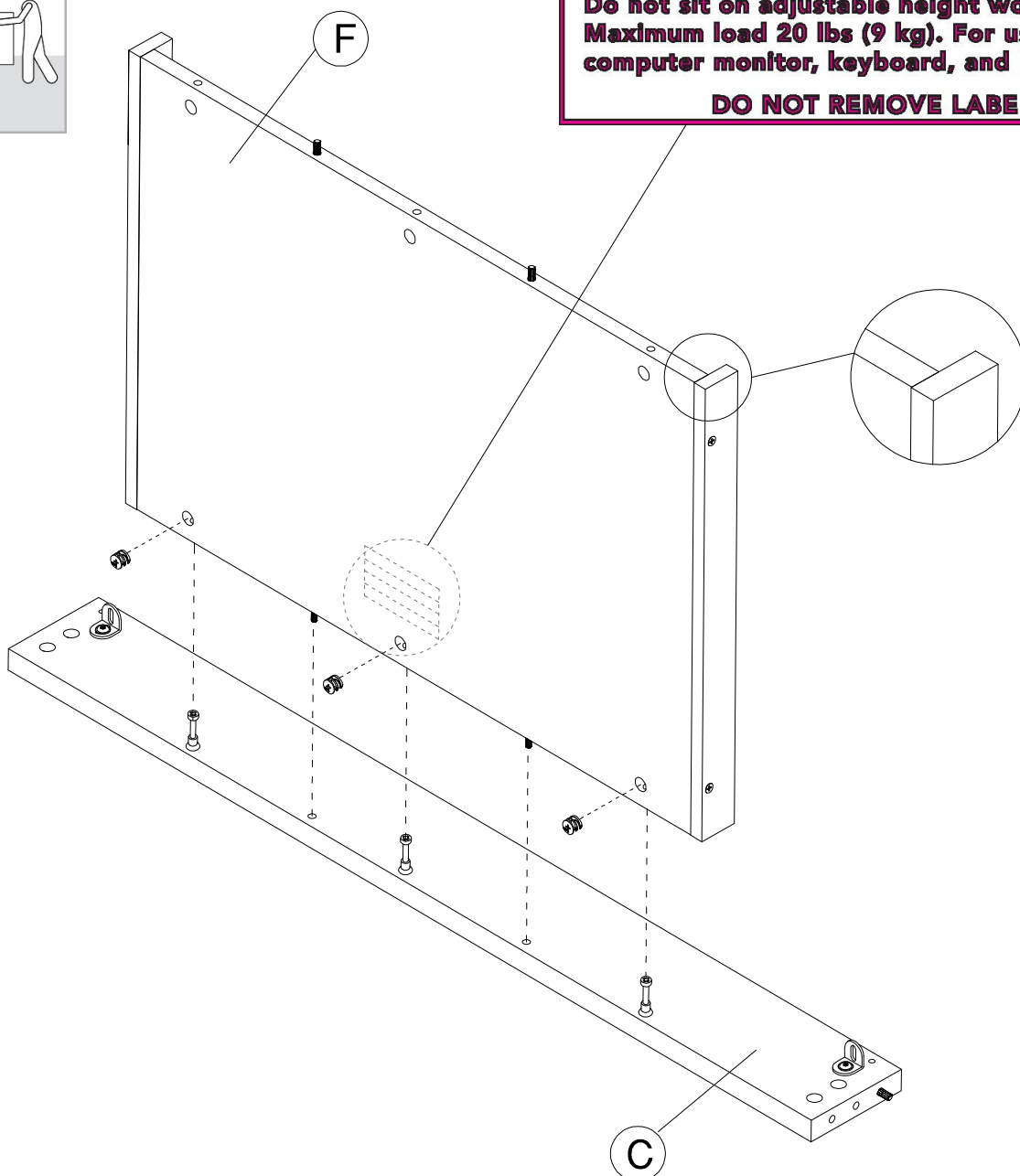

Have an assembly question or need a replacement part? Just call **1-800-950-4782**, we are here to help.

# STEP 7

## Assemble Panels

A198529

Scan QR Code to Watch Video on:



How to Tighten KD Cams



H181468

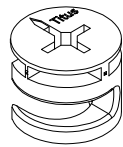

KD Cam

[ 3 ]

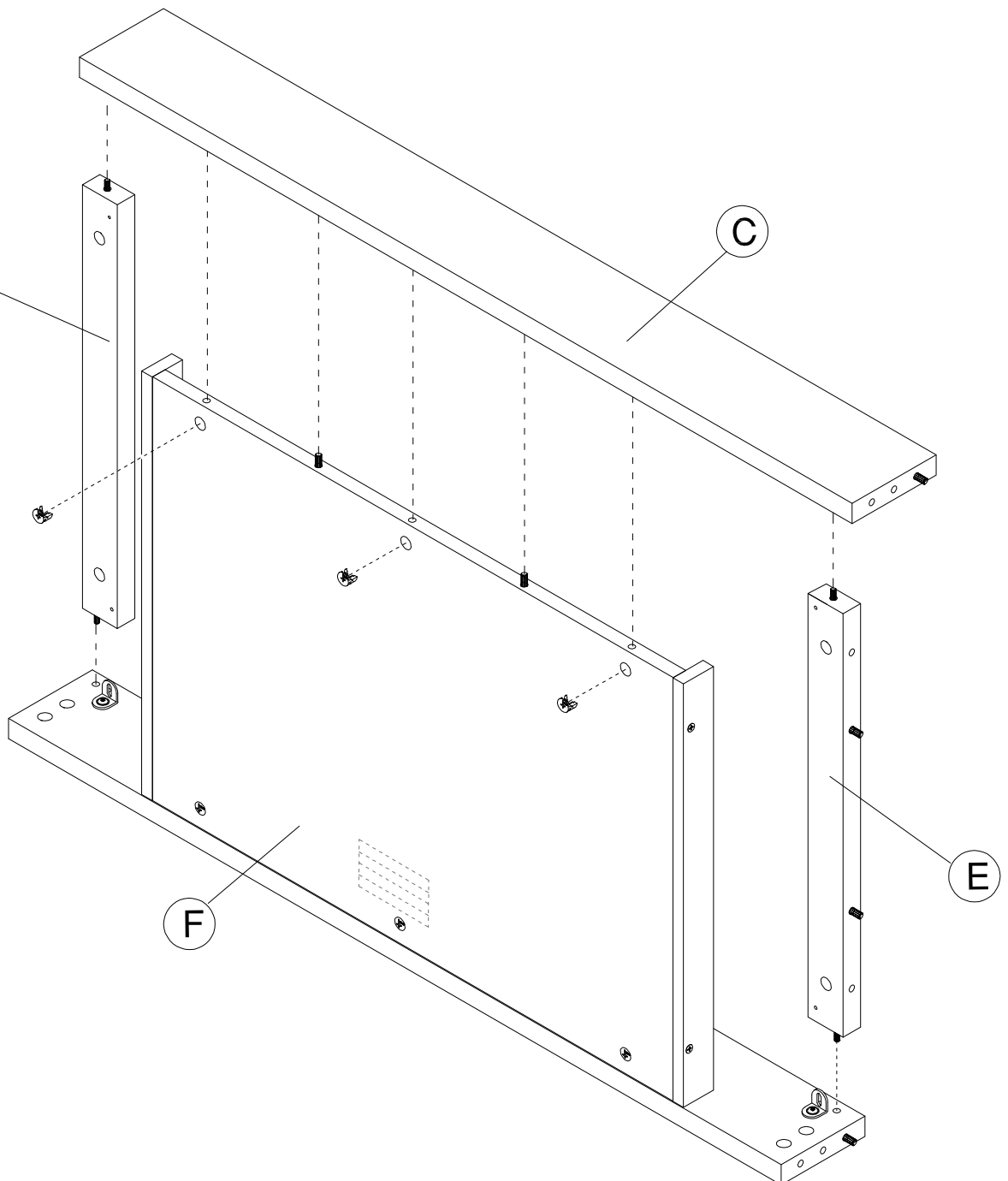
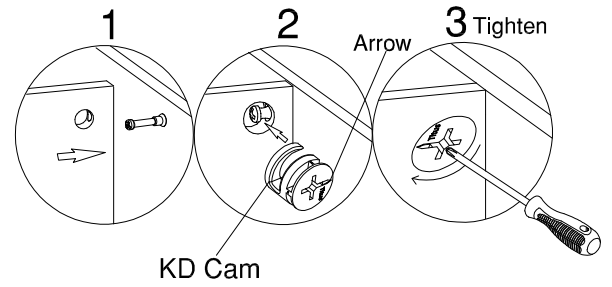

Have an assembly question or need a replacement part? Just call **1-800-950-4782**, we are here to help.

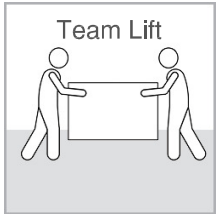

H204610

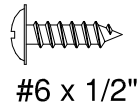

[ 4 ]

Tighten all screws.  
Apriete todos los tornillos.  
Serrez toutes les vis.

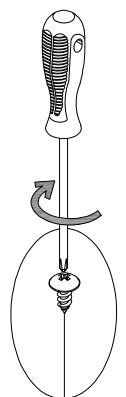
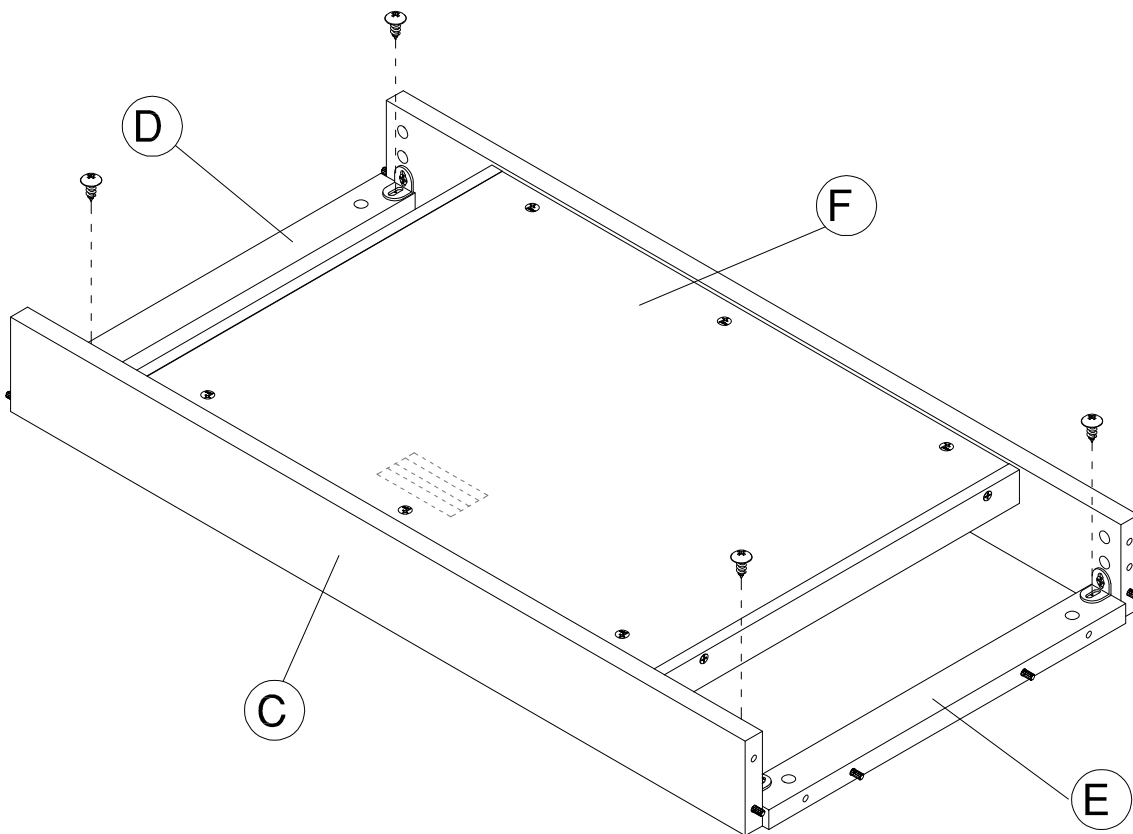

Have an assembly question or need a replacement part? Just call  
**1-800-950-4782**, we are here to help.



# STEP 9

# Prepare Panels

A198529

H180604

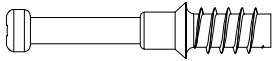

[ 20 ]

KD Bolt

2x

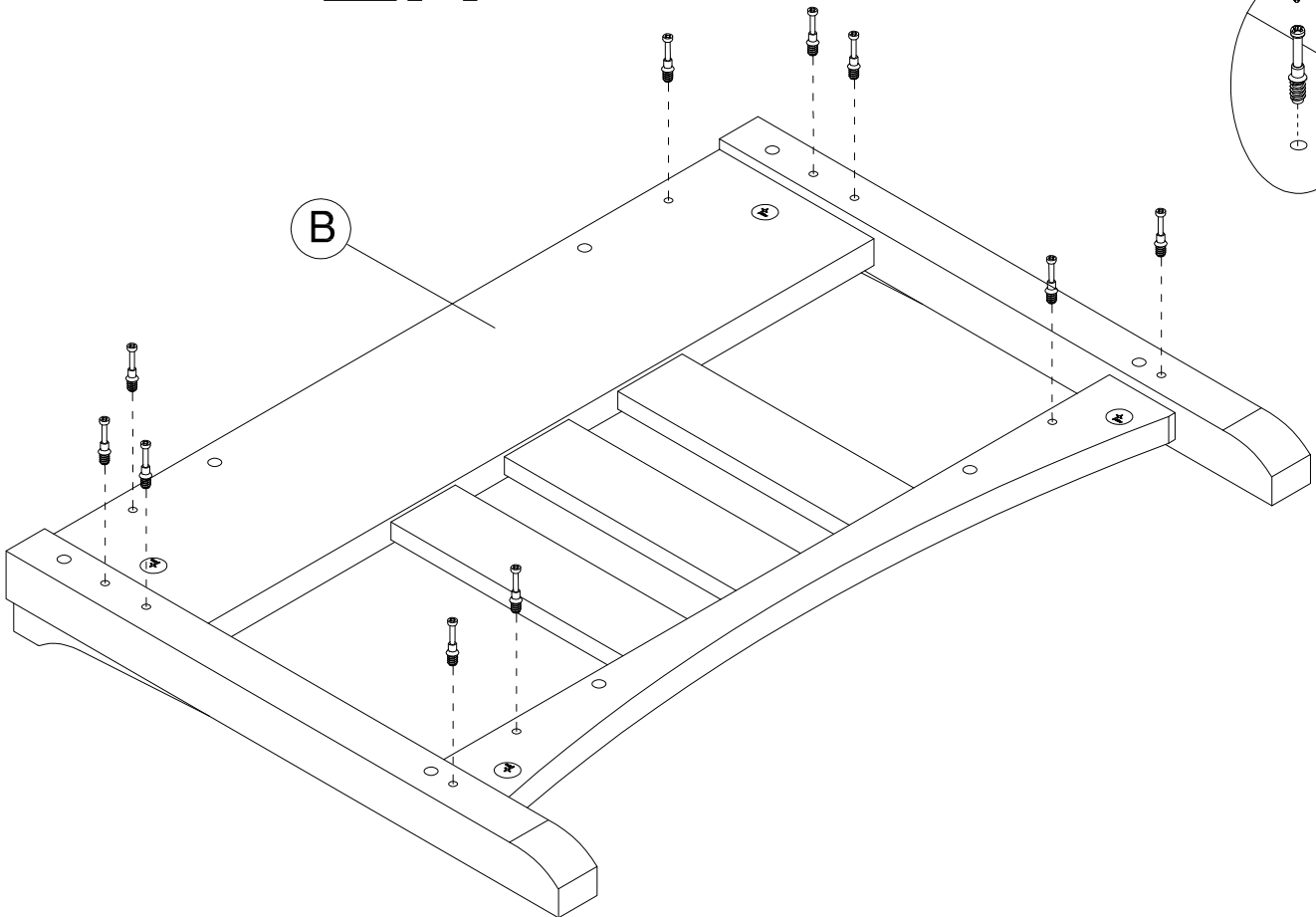
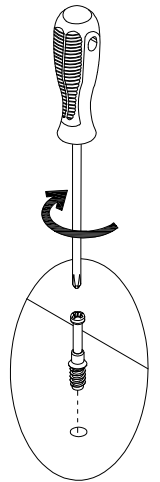

Have an assembly question or need a replacement part? Just call  
**1-800-950-4782**, we are here to help.

# STEP 10

# Assemble Panels

A198529

Scan QR Code to Watch Video on:



How to Tighten KD Cams

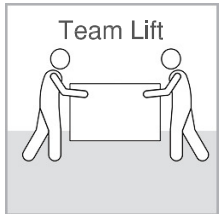

H181468

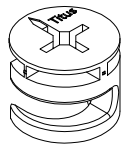

KD Cam

[ 6 ]

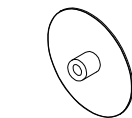
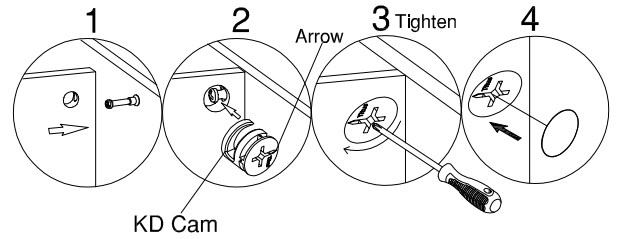

Cover Cap

[ 4 ]

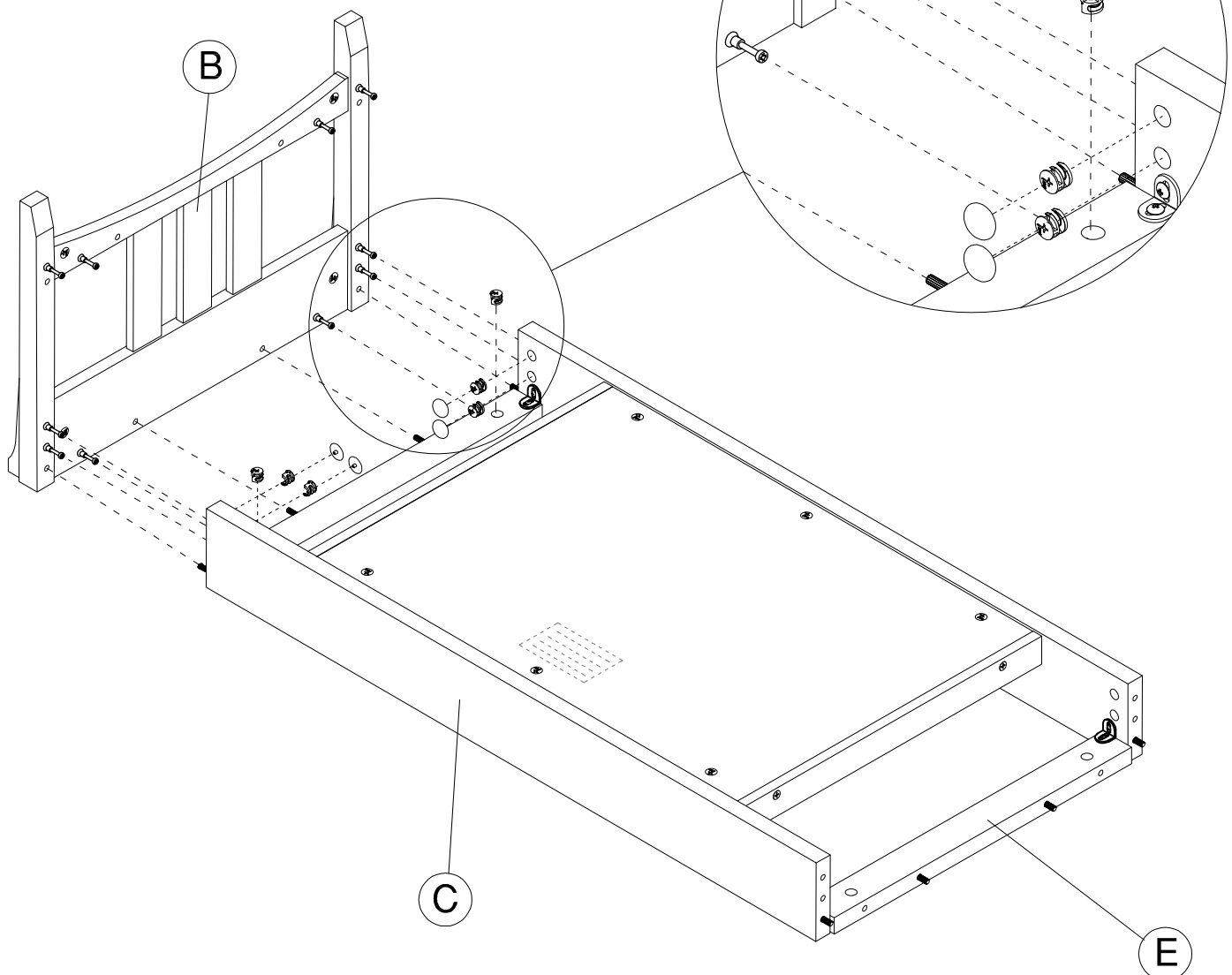

Have an assembly question or need a replacement part? Just call **1-800-950-4782**, we are here to help.

Scan QR Code to Watch Video on:



How to Tighten KD Cams



H181468

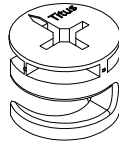

KD Cam

[ 4 ]

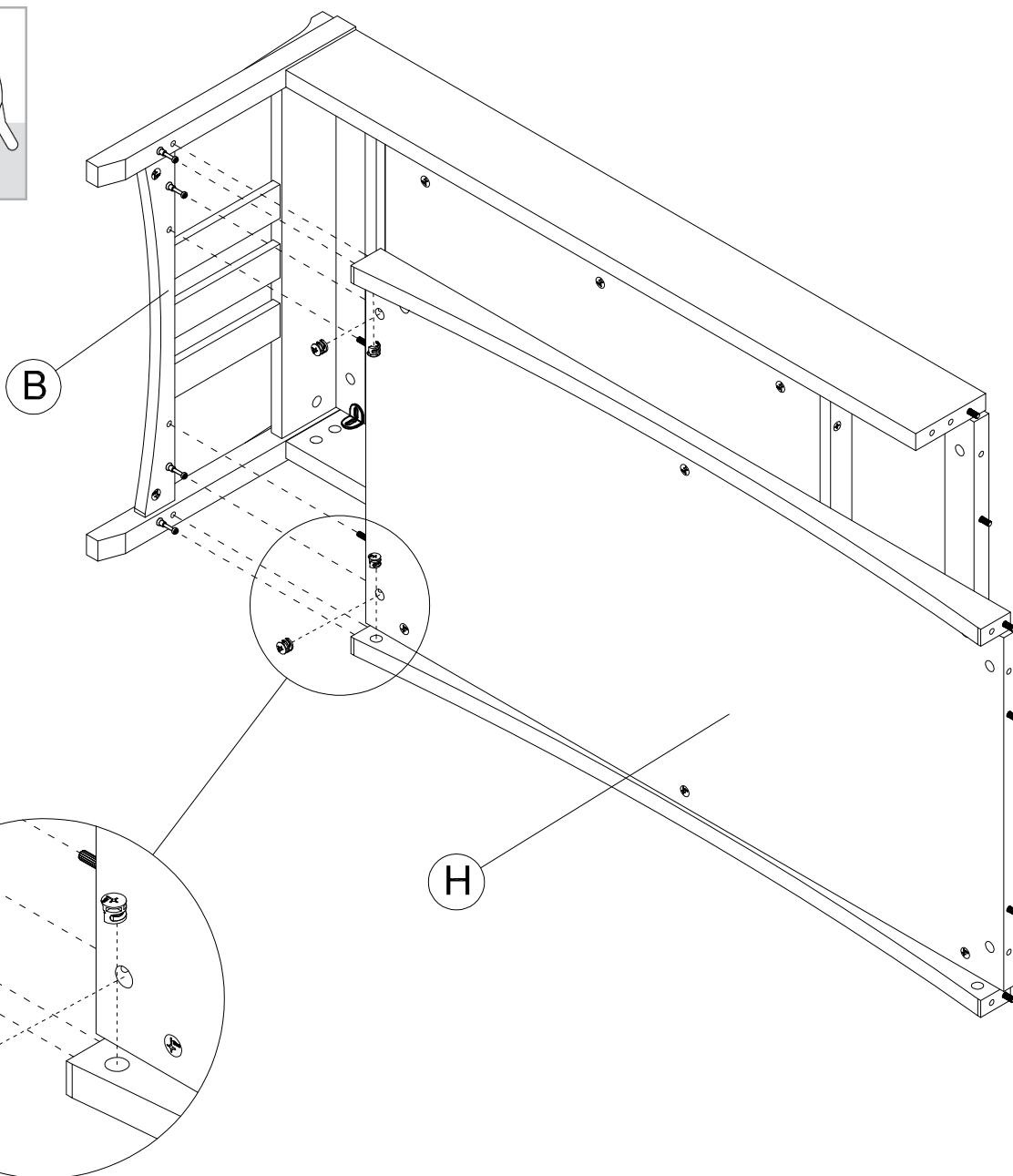
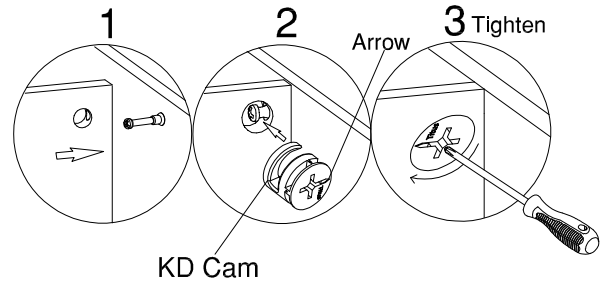

Have an assembly question or need a replacement part? Just call **1-800-950-4782**, we are here to help.

# STEP 12

# Assemble Panels

A198529

Scan QR Code to Watch Video on:



How to Tighten KD Cams

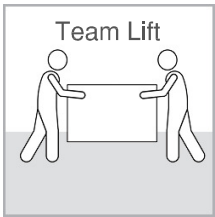

H181468

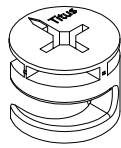

KD Cam

[ 10 ]

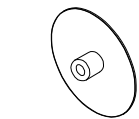
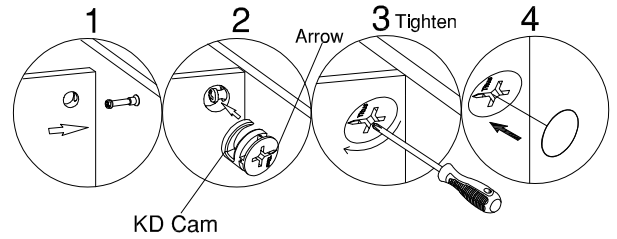

Cover Cap

[ 4 ]

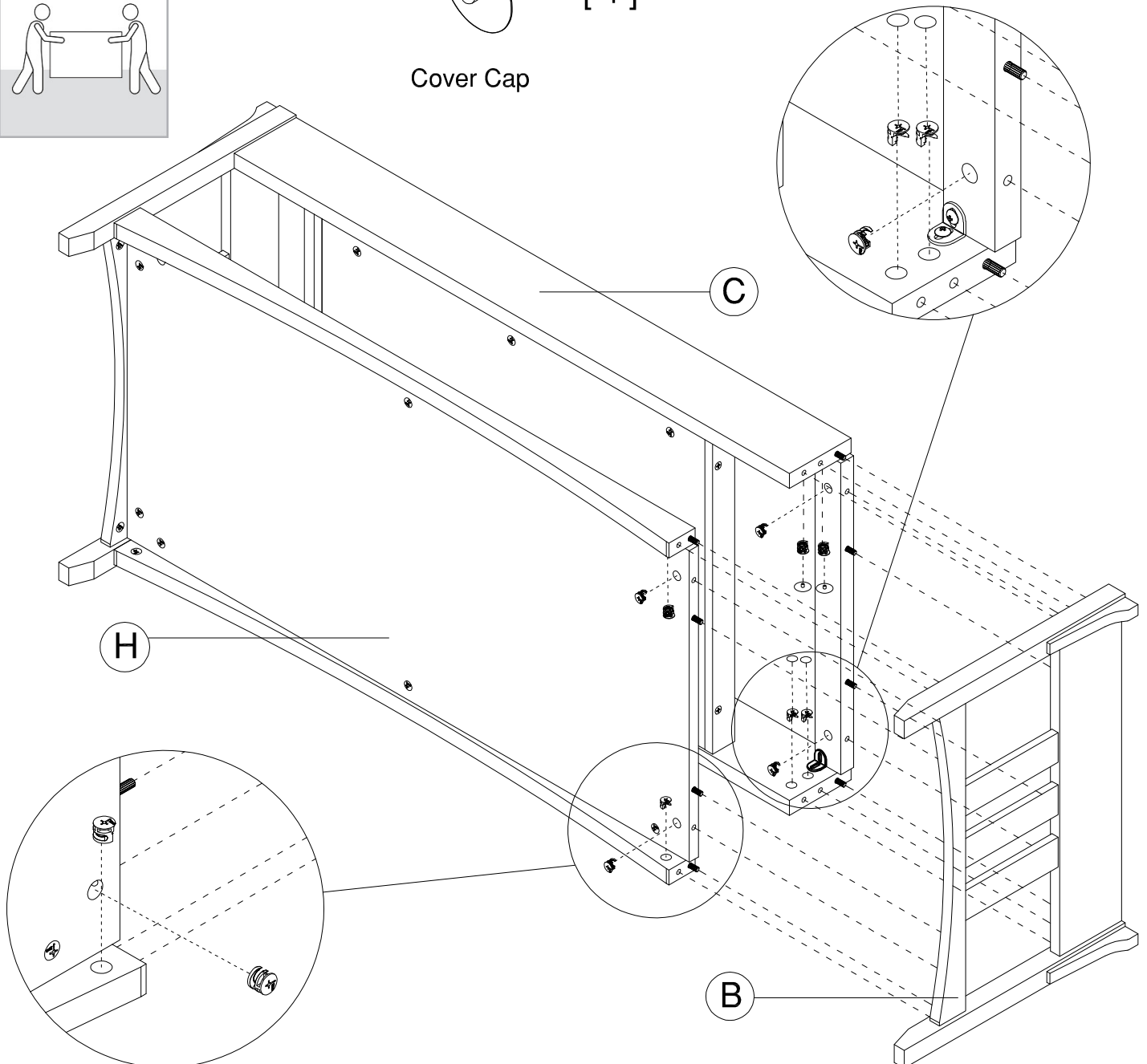

Have an assembly question or need a replacement part? Just call **1-800-950-4782**, we are here to help.

# STEP 13

# Prepare Panel

A198529

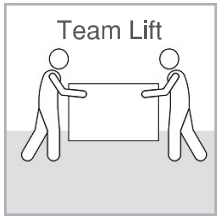

H23119 [ 8 ]  
#10 x 5/8"

H200016 [ 6 ]  
Bumper-Clear

H204610 [ 6 ]  
#6 x 1/2"

Z184666

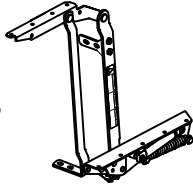

[ 1 ]

RT Side Assembly

Z184667

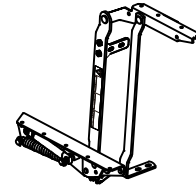

[ 1 ]

LT Side Assembly

	<b>WARNING</b> Avoid pinching! DO NOT put hands close to the structure when lifting or lowering the desktop.	<b>ADVERTISSEMENT</b> Évitez de vous pincer! NE pas mettre les mains à proximité de la structure lorsque élever ou abaisser sur le bureau.	<b>ADVETENCIA</b> ¡Evitar que se pellizque! No ponga las manos cerca de la estructura al levantar o bajar el escritorio.
--	--	--	--

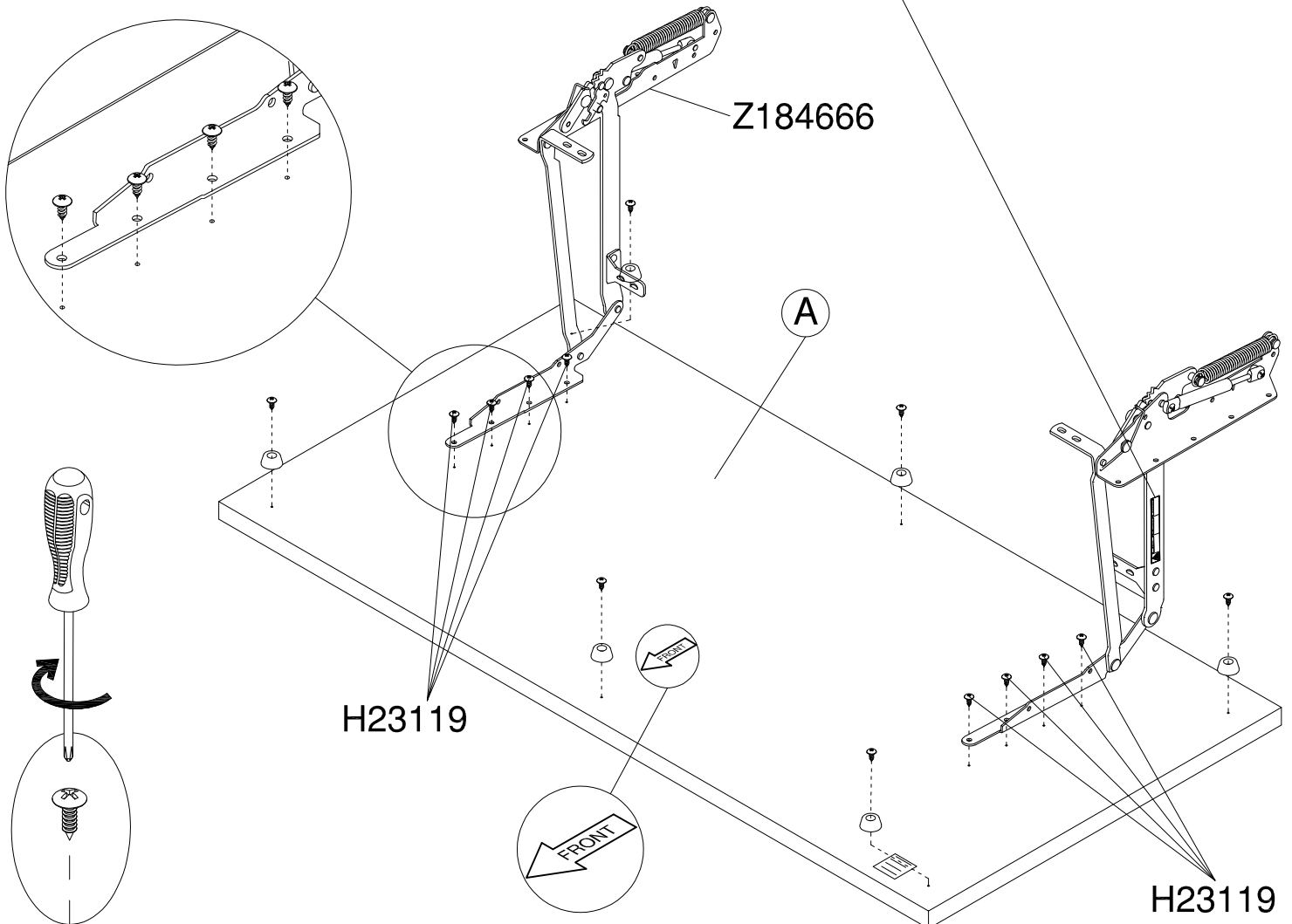

Have an assembly question or need a replacement part? Just call  
**1-800-950-4782**, we are here to help.

# STEP 14

# Assemble Panel

A198529

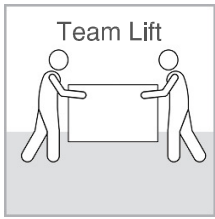

H23119 [ 10 ]  
#10 x 5/8"

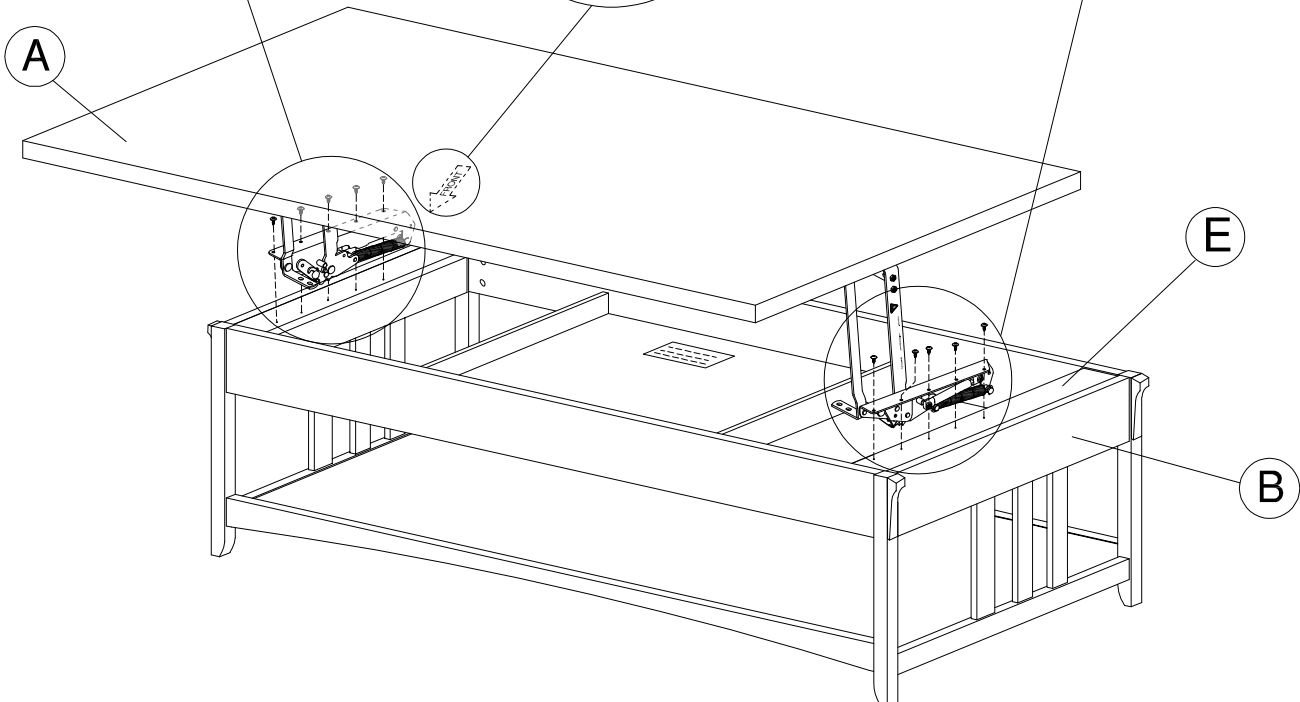
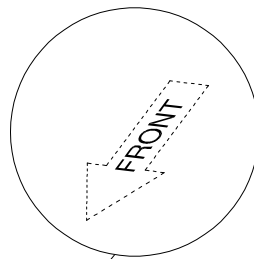
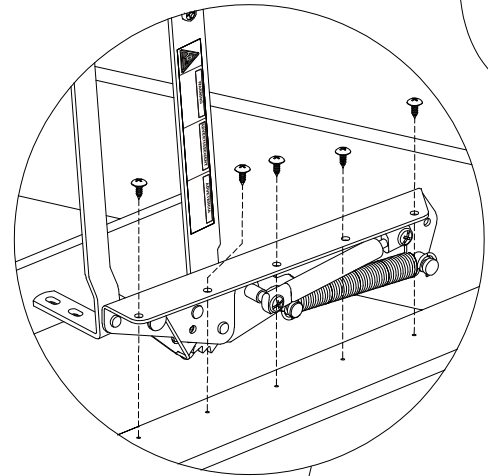
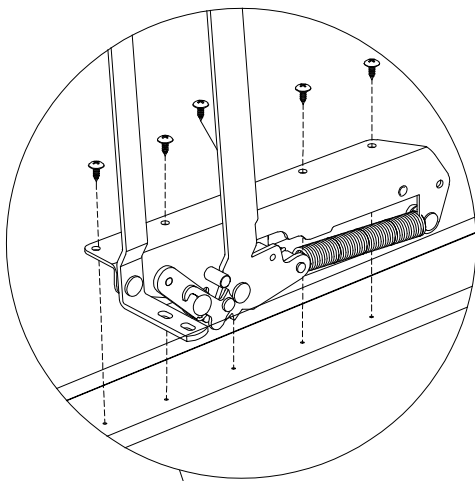
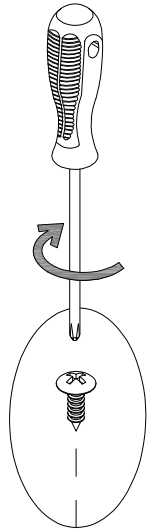

Have an assembly question or need a replacement part? Just call  
**1-800-950-4782**, we are here to help.

# STEP 15

# Attach Hardware

A198529

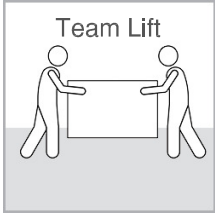

Z184669

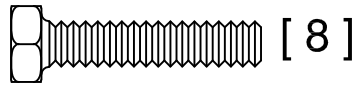

M6 x 28mm

Z184671



1/4-20 NUT

H189068



[ 2 ]

Connecting bar 891mm

Z184669

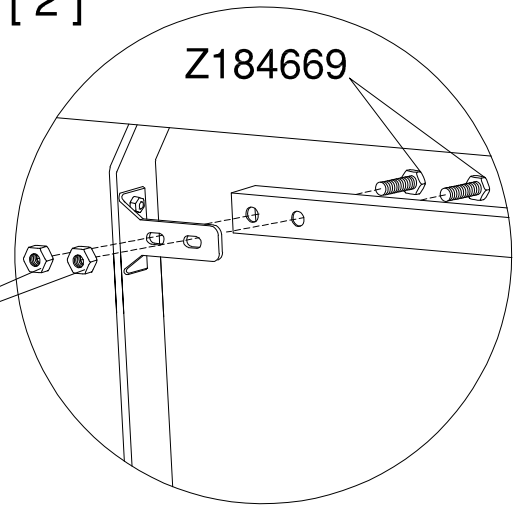

A

Z184671

H189068

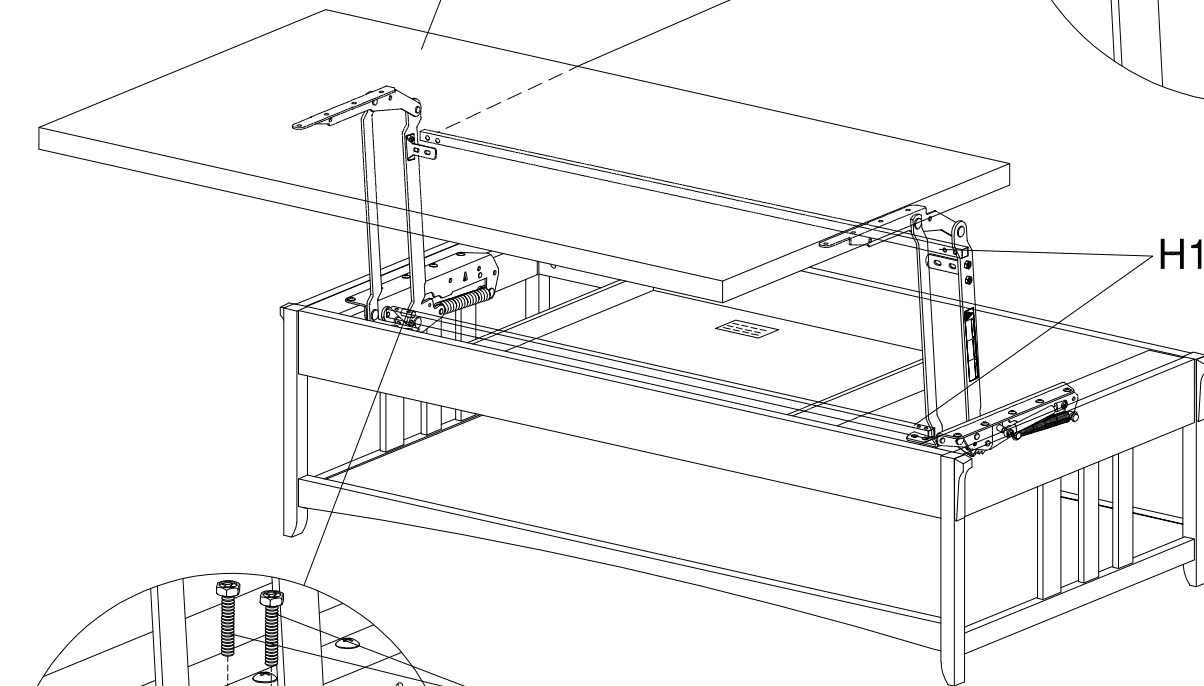

Z184669

Z184671

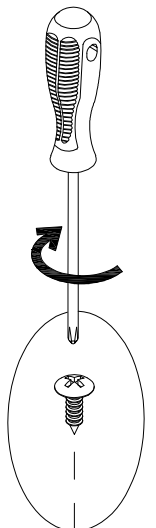
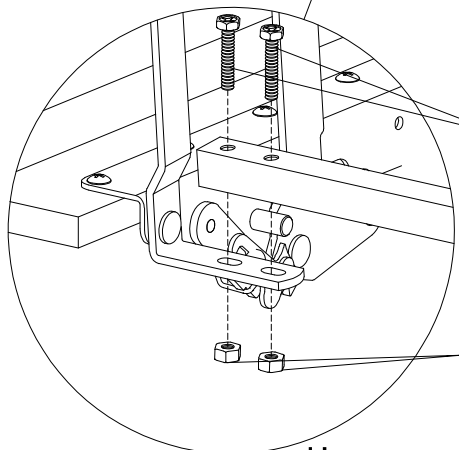

Have an assembly question or need a replacement part? Just call  
**1-800-950-4782**, we are here to help.

## Seated Position

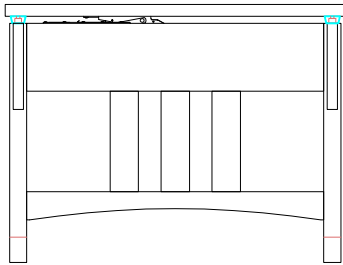

## Position#1

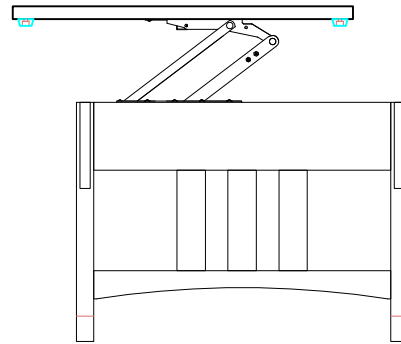

## Position#2

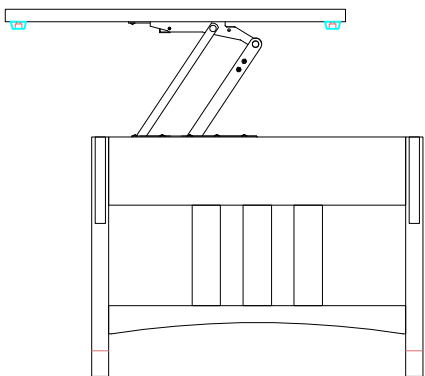

## Position#3

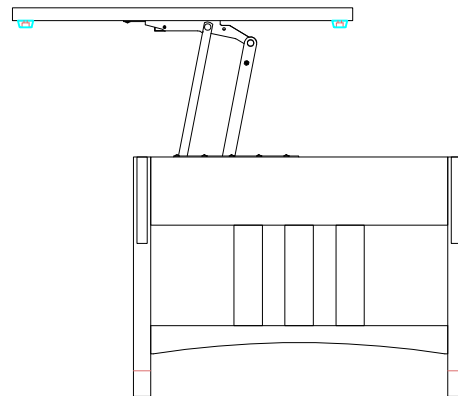

## UNLOCK POSITION

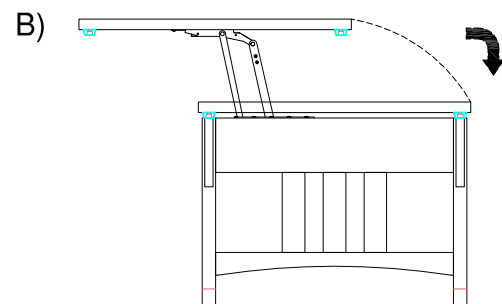
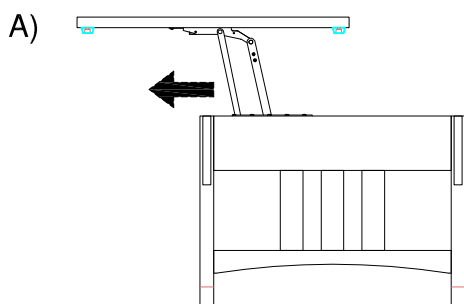

Do NOT use table top in UNLOCK position.  
 NO use el mesa en la posición DESBLOQUEADA.  
 N'utilisez PAS le tableau en position UNLOCK

## To return table to Seated Position:

- (A) pull table top slowly forward until stop,  
 (A) tire de la parte superior del mesa lentamente hacia adelante hasta que se detenga,  
 (A) tirer lentement le tableau vers l'avant jusqu'à l'arrêt,

- (B) slowly push table top down to seated position  
 (B) empuje lentamente la parte superior del mesa hacia abajo hasta la posición sentada  
 (B) Poussez lentement le tableau vers le bas en position assise

Have an assembly question or need a replacement part? Just call  
**1-800-950-4782**, we are here to help.



Scan QR Code to Watch Video on:



How to Clean the Surface

Gently clean surfaces with a damp sponge eraser.

**MAXIMUM WEIGHT: 20 LBS (9.07 KG)**  
**PESO MÁXIMO: 20 LIBRAS (9.07 KILOGRAMO)**  
**POIDS MAXIMUM: 20 LIVRES (9.07 KILOGRAMME)**

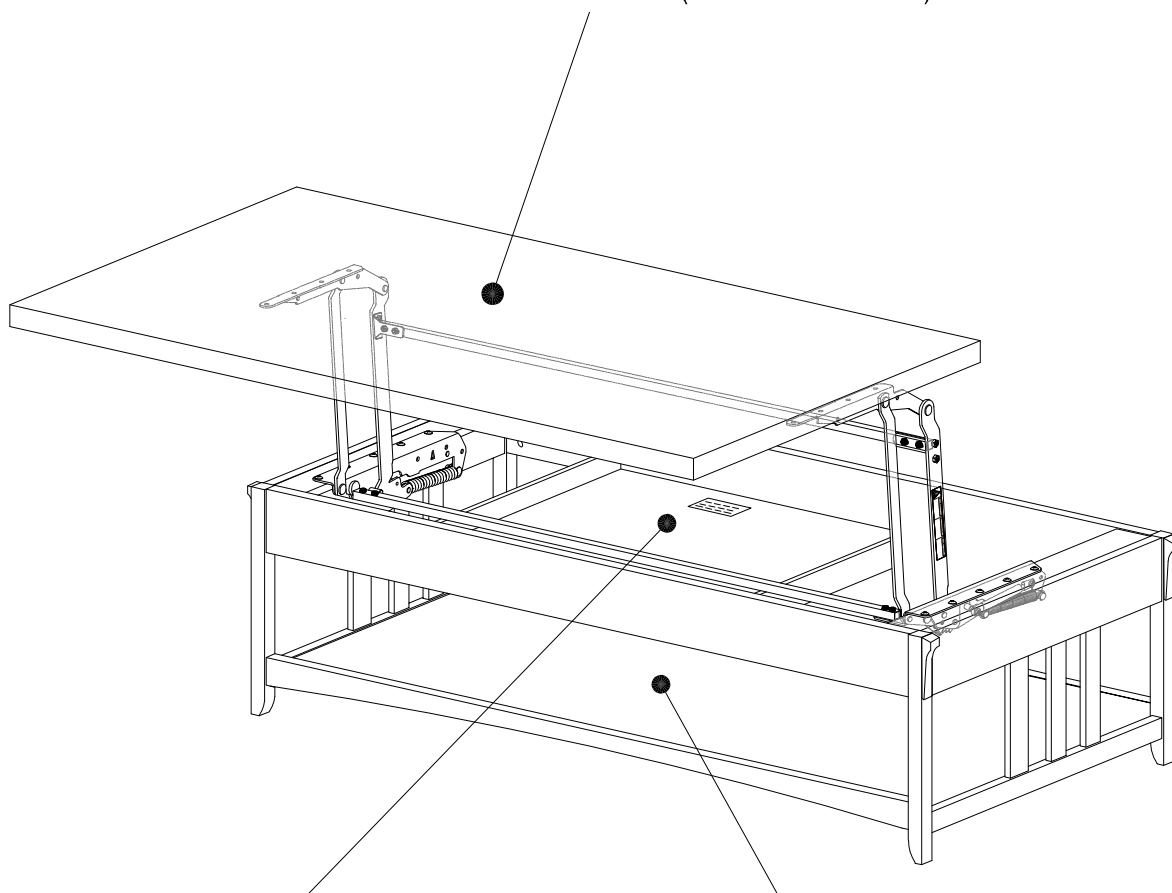

**MAXIMUM WEIGHT: 15 LBS (6.8KG)**  
**PESO MÁXIMO: 15 LIBRAS (6.8KILOGRAMO)**  
**POIDS MAXIMUM: 15 LIVRES (6.8 KILOGRAMME)**

**MAXIMUM WEIGHT: 25 LBS (11.34KG)**  
**PESO MÁXIMO: 25 LIBRAS (11.34 KILOGRAMO)**  
**POIDS MAXIMUM: 25 LIVRES (11.34 KILOGRAMME)**

**Congratulations! You are all done. If you have any questions or concerns, please call.**

Have an assembly question or need a replacement part? Just call **1-800-950-4782**, we are here to help.

**SAT348AW**

A	[1]	W204670	F	[1]	W204675
B	[2]	S204671	G	[2]	W204676
C	[2]	W204672	H	[1]	W204677
D	[1]	W204673	I	[2]	W204678
E	[1]	W204674			

H174677

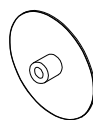

[ 8 ]

Cover Cap

**SAT348VB**

A	[1]	W204679	F	[1]	W204684
B	[2]	S204680	G	[2]	W204685
C	[2]	W204681	H	[1]	W204686
D	[1]	W204682	I	[2]	W204687
E	[1]	W204683			

H160399



[ 8 ]

Cover Cap

Have an assembly question or need a replacement part? Just call  
**1-800-950-4782**, we are here to help.

**SAT348CG**

A	[1]	W204688	F	[1]	W204693
B	[2]	S204689	G	[2]	W204694
C	[2]	W204690	H	[1]	W204695
D	[1]	W204691	I	[2]	W204696
E	[1]	W204692			

H186180

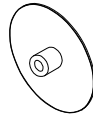

[ 8 ]

Cover Cap

# WARRANTY INFORMATION/INFORMATIONS POUR LA GARANTIE/INFORMACIÓN DE GARANTÍA

## BUSH FURNITURE'S WRITTEN WARRANTY TO YOU

In order to provide you with timely assistance, please thoroughly inspect your furniture for missing or defective parts immediately after opening the carton. To receive replacement or missing parts under this warranty, call our Consumer Service Department TOLL-FREE at 1-800-950-4782. Please have the Model, Part, and Lot Numbers found in the instruction manual available for your reference. You will also need your sales receipt or other proof of purchase. Replacement part(s) will be shipped to you at no charge with Bush Industries assuming all shipping and handling charges.

This Bush Furniture product is warranted to the original purchaser at the time of purchase and for a period of one year thereafter.

We warrant to you, the original purchaser, that our furniture and all its parts and components are free of defects in material or workmanship. "Defects," as used in this warranty, is defined as any imperfection which impairs the use of the furniture product.

Our warranty is expressly limited to the replacement of furniture parts and components. For one year after the date of purchase, Bush will replace any parts that are defective in material or workmanship.

This warranty applies under conditions of normal use. Our Bush Furniture products are not intended for outdoor use. This warranty does not cover: 1) defects caused by improper assembly or disassembly; 2) defects occurring after purchase due to product modification, intentional damage, accident, misuse, abuse, negligence or exposure to the elements; and 3) labor or assembly costs. Batteries not included in warranty

IMPLIED WARRANTIES, INCLUDING THE WARRANTY OF MERCHANTABILITY, SHALL NOT EXTEND BEYOND THE DURATION OF THE WRITTEN WARRANTY STATED ABOVE, AND IN NO EVENT SHALL BUSH BE LIABLE FOR INCIDENTAL OR CONSEQUENTIAL DAMAGES RESULTING FROM USE OF THE PRODUCT. Some states do not allow a limitation on how long an implied warranty lasts or the exclusion or limitation of incidental or consequential damages, so the above limitation and exclusion may not apply to you.

This warranty gives you specific legal rights. You may also have other rights that may vary from state to state.

## VOTRE GARANTIE BUSH FURNITURE

Afin de vous assister rapidement, veuillez inspecter votre mobilier en détail immédiatement après l'ouverture du carton en cas de pièces manquantes ou défectueuses. Pour recevoir une pièce de rechange ou manquante couverte par cette garantie, appelez notre département de service clientèle GRATUITEMENT au 1-800-950-4782. Veuillez tenir à disposition les numéros de modèle, de pièce et de lot qui se trouvent dans le manuel d'instruction pour votre référence. Vous aurez également besoin de votre reçu ou d'une autre preuve d'achat. La (les) pièce(s) de rechange vous sera (seront) envoyée(s) sans frais, Bush Industries se chargeant de tous les frais d'expédition.

Tout le produit Bush Furniture est garanti à l'acheteur original à partir de la date d'achat pour une période d'un an.

Nous vous garantissons, à vous l'acheteur original, que notre mobilier et toutes ses pièces et composants sont sans défaut de matériau ou de fabrication. Le terme "défauts" utilisé dans cette garantie, est défini comme étant toutes les imperfections qui compromettent l'utilisation du meuble.

Notre garantie est expressément limitée au remplacement des pièces et des composants du mobilier. Pendant un an après la date d'achat, Bush remplacera toute pièce défectueuse dans le matériau ou sa fabrication.

Cette garantie d'applique sous des conditions d'utilisation normale. Nos produits ne sont pas destinés à être utilisés en plein air. Cette garantie ne couvre pas: 1) les défauts causés par un mauvais assemblage ou démontage, 2) les défauts ayant lieu après l'achat et dus à la modification du produit, des dommages intentionnels, des accidents, une mauvaise utilisation, un mauvais traitement, la négligence ou l'exposition aux éléments, et 3) les frais de main d'œuvre ou d'assemblage. Piles non incluses dans la garantie.

LES GARANTIES TACITES, Y COMPRIS LA GARANTIE DE QUALITE MARCHANDE, NE S'ETENDRONT PAS AU-DELA DE LA DUREE ECRITE CITEE CI-DESSUS, ET BUSH NE SERA EN AUCUN CAS RESPONSABLE DES DOMMAGES ACCESSOIRES OU INDIRECTS RESULTANT DE L'UTILISATION DU PRODUIT. Certains états ne permettent pas d'appliquer une limite à la durée de la garantie tacite, ni une exclusion ou limitation des dommages accessoires ou indirects; dans ce cas les limitations ou exclusion ci-dessus peuvent ne pas s'appliquer à vous.

Cette garantie vous donne des droits légaux spécifiques. Il se peut que vous ayez également d'autres droits qui peuvent varier d'un état à l'autre.

## GARANTIA ESCRITA DE BUSH FURNITURE PARA USTED

Para brindarle asistencia oportuna, por favor, verifique detalladamente que a su mueble no le falte o tenga piezas defectuosas inmediatamente después de abrir la caja. Para recibir un reemplazo o la parte faltante bajo esta garantía, llame a nuestro Departamento de Servicio al Consumidor GRATIS al 1-800-950-4782. Sírvase traer los números de modelo, parte y lote que se encuentran en el manual de instrucciones disponible para su referencia. Además, necesitará el recibo de su compra u otra prueba de compra. La(s) pieza(s) de reemplazo le será(n) enviada(s) sin recargo por Bush Industries asumiendo los gastos de envío y manipuleo.

Todo mueble de Bush Furniture es garantizado al comprador original al momento de la compra y por un periodo de uno año en adelante.

Le garantizamos a usted, el comprador original, que nuestros muebles sus partes y componentes están libres de defectos en materiales o trabajo. "Defectos", según se usa en esta garantía, se define como una imperfección que perjudica el uso del producto mobiliario.

Nuestra garantía se limita expresamente al reemplazo de partes y componentes mobiliarios. Durante uno año después de la fecha de compra, Bush reemplazará cualquier parte defectuosa en material o trabajo.

Esta garantía se aplica bajo condiciones de uso normal. Nuestros productos de Bush Furniture no son para uso en exteriores. Esta garantía no cubre: 1) defectos causados por un ensamblaje o desensamblaje inadecuado; 2) defectos que ocurran después de la compra debido a modificación del producto, daño intencional, accidente, mal uso, abuso, negligencia o exposición a los elementos; y 3) costos de trabajo o ensamblaje. Baterías no incluidas en la garantía.

LAS GARANTÍAS IMPLICADAS, INCLUYENDO LA GARANTÍA DE COMERCIABILIDAD, NO SE EXTENDERÁN MÁS ALLÁ DE LA DURACIÓN DE LA GARANTÍA ESCRITA MENCIONADA, Y EN NINGÚN CASO BUSH SERÁ RESPONSABLE POR DAÑOS INCIDENTALES O CONSIGUIENTES COMO RESULTADO DEL USO DEL PRODUCTO. Algunos estados no permiten una limitación sobre el tiempo de duración de la garantía implicada o la exclusión o limitación de daños incidentales o consiguientes, de manera que la limitación y exclusión mencionadas pueden no aplicarse para usted.

Esta garantía le otorga derechos legales específicos. Puede también tener otros derechos que pueden variar según los estados.

**1-Year**  
Manufacturer's  
Warranty

## Register your product online at

Scan the QR Code or go to  
<http://www.bushfurniture.com/ProductRegistration.aspx>



## Assembly tips & how to videos

Scan the QR Code to access our video guides  
<https://www.bushfurniture.com/CustomerService/HowToAssemble.aspx>

