

SHIMANO

CITICA

CI-200I

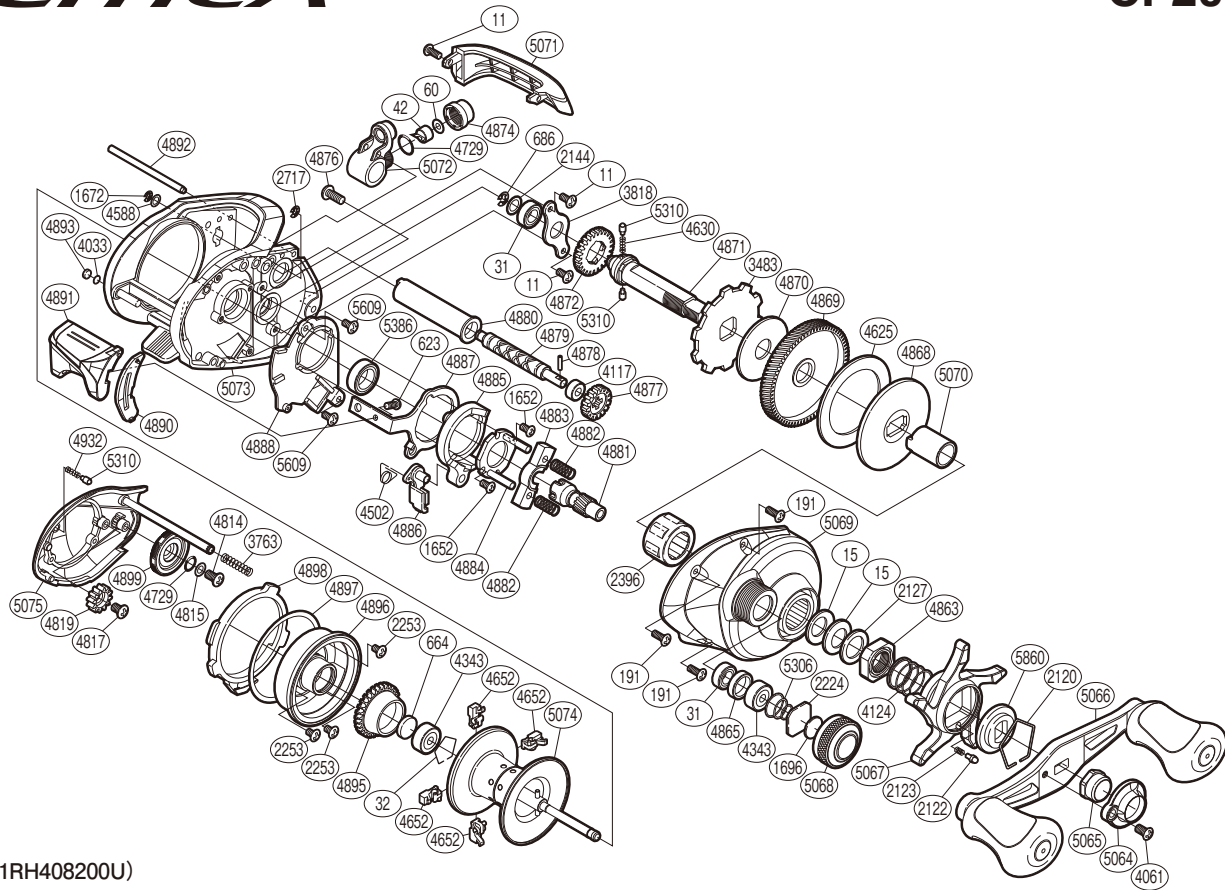

(51RH408200U)

| # | Part No. | Description | # | Part No. | Description | # | Part No. | Description |
|------|----------|-----------------------|------|----------|---------------------|------|----------|--------------------------|
| 11 | 10MT0 | Screw | 4588 | 10FJZ | Washer | 4891 | 10CDL | Quick-Fire II Clutch Bar |
| 15 | 10D60 | Drag Spring Washer | 4625 | 106XT | Drag Washer | 4892 | 10QSE | Stabilizer Bar |
| 31 | 105BL | Ball Bearing | 4630 | 10JDJX | Idle Gear Spring | 4893 | 108PY | Anti-Thrust Washer |
| 32 | 10GEW | Bearing Retainer | 4652 | 1046G | Brake Shoe | 4895 | 10EXQ | Brake Ring Gear |
| 42 | 10FFZ | Line Guide Pawl | 4729 | 108WQ | O Ring | 4896 | 10F0N | Brake Case |
| 60 | 10CFW | Spacer | 4814 | 103LE | Screw | 4897 | 104MX | Washer |
| 191 | 10MPT | Screw | 4815 | 10GFB | Washer | 4898 | 10BAK | Side Plate Cam Lever |
| 623 | 103C0 | Screw | 4817 | 103L7 | Screw | 4899 | 10AZB | Brake Dial |
| 664 | 1057S | Spacer B | 4819 | 10CLF | Idle Gear | 4932 | 10GZQ | Click Spring |
| 686 | 105NK | E Lock | 4863 | 10A3T | Star Drag Nut | 5064 | 10Q5Q | Handle Nut Plate |
| 1652 | 10LVE | Screw | 4865 | 10EYS | Bearing Spacer | 5065 | 10FFC | Handle Nut |
| 1672 | 105NC | E Lock | 4868 | 10D3H | Key Washer | 5066 | 10CEY | Handle Assembly |
| 1696 | 10896 | Cast Control Spacer | 4869 | 10CMB | Drive Gear | 5067 | 10ATY | Star Drag |
| 2120 | 10KXV | Click Plate Retainer | 4870 | 10CHF | Drag Washer | 5068 | 10KDM | Cast Control Cap |
| 2122 | 10BT0 | Click Pin | 4871 | 1058L | Drive Shaft | 5069 | 10GK3 | Right Side Plate |
| 2123 | 10BT2 | Click Spring | 4872 | 10J47 | Idle Gear | 5070 | 10BMW | Roller Clutch Inner Tube |
| 2127 | 10J1N | Star Drag Spacer | 4874 | 10FJB | Pawl Cap | 5071 | 10FWD | Level Wind Protector |
| 2144 | 10C47 | Washer | 4876 | 103DC | Screw | 5072 | 10NVR | Line Guide |
| 2224 | 1085F | Spool Tension Spacer | 4877 | 10FNV | Idle Gear | 5073 | 10EVD | One-Piece Frame |
| 2253 | 103N4 | Screw | 4878 | 10AEZ | Worm Shaft Pin | 5074 | 10L13 | Spool Assembly |
| 2396 | 10F5C | Roller Clutch Bearing | 4879 | 104SN | Worm Shaft | 5075 | 10D0A | Left Side Plate |
| 2717 | 105NB | E Lock | 4880 | 10NFQ | Level Wind Guard | 5306 | 10TMT | Spool Tension Spring |
| 3483 | 109BB | Anti-Reverse Ratchet | 4881 | 10CPX | Pinion Gear | 5310 | 10HJG | Idle Gear Pin |
| 3763 | 10KNG | Side Plate Spring | 4882 | 10487 | Yoke Spring | 5386 | 10EX6 | Ball Bearing |
| 3818 | 109T0 | Drive Shaft Retainer | 4883 | 1046V | Yoke | 5609 | 10LCT | Screw |
| 4033 | 108SK | Washer | 4884 | 10F3X | Clutch Cam Retainer | 5860 | 10J26 | Star Drag Click Plate |
| 4061 | 103ED | Screw | 4885 | 10K0N | Clutch Cam | | | |
| 4117 | 10PXY | Bushing | 4886 | 10MME | Clutch Pawl | | | |
| 4124 | 10A70 | Star Drag Spring | 4887 | 10QGH | Clutch Plate | 4652 | 1046G | Brake Shoe (accessory) |
| 4343 | 105C3 | Ball Bearing | 4888 | 10BVL | Clutch Guard | | | |
| 4502 | 104CN | Clutch Pawl Spring | 4890 | 1096S | Clutch Bar Guide | 4692 | 10LQ0 | B-100 Oil (accessory) |

Please note that the number of adjusting washers may not be the same as shown in the exploded views.
(Adjustment will vary with each individual product.)

(241029)_005