

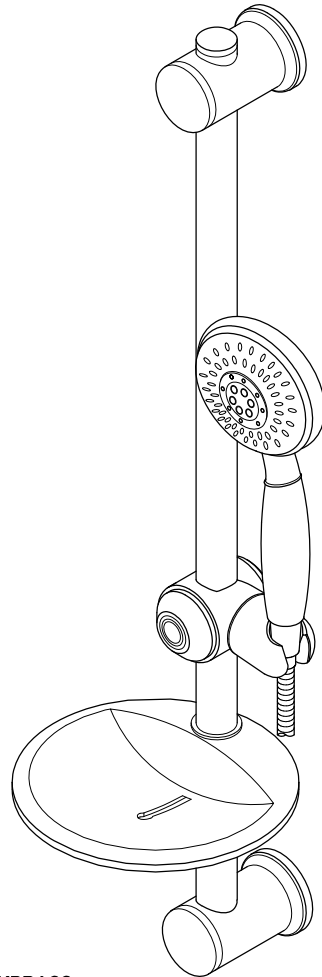

Adjustable Slide Bar with or without Hand Shower Installation Instructions



Parts:

Mounting
Screw &
Anchor



1 Pc

www.kingstonbrass.com

TOLL-FREE CUSTOMER SERVICE: 1-877-2-KBRASS

TECHNICAL SUPPORT E-mail: service@kingstonbrass.com

12775 Reservoir Street, Chino, CA 91710

NOTICE

Failure to follow all directions may cause leaks
which may result in water damage

CAUTION

Failure to follow all installation directions may
cause product to detach from the wall and
cause serious injury

Tools Required

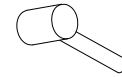

Hammer



Marking Pencil

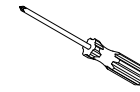

Phillips Screwdriver

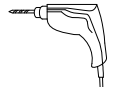

Power Drill

Legal Disclaimer :

This bar is not to be used as a grab bar and it is not intended to support weight. Before you begin, identify the appropriate area to install this slide bar, proper location should be above 48" from the floor (as per ASTM F446).

It is recommended that slide bar to be mounted directly to the structural framing of your home. If necessary, cross bracing can be installed to provide adequate support.

Installation:

1

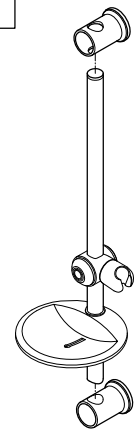

1. Assemble slide bar and position at the desired location.

2

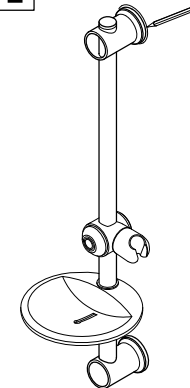

2. Mark the position of the mounting screw by inserting a pencil through the center of the end post.

3

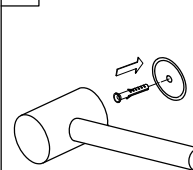

3. Remove slide bar and drill a small hole, insert plastic anchor until it is flushed with the surface of the wall.

4

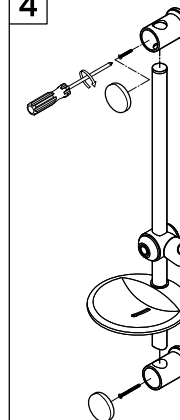

4. Attach slide bar to wall and fasten by threading the shorter screw to the top and longer screw to the bottom plastic anchor or wood stud, press decorative cover into place. Lastly connect the hand shower per manufacturer installation instruction.