

# INSTRUCTION MANUAL

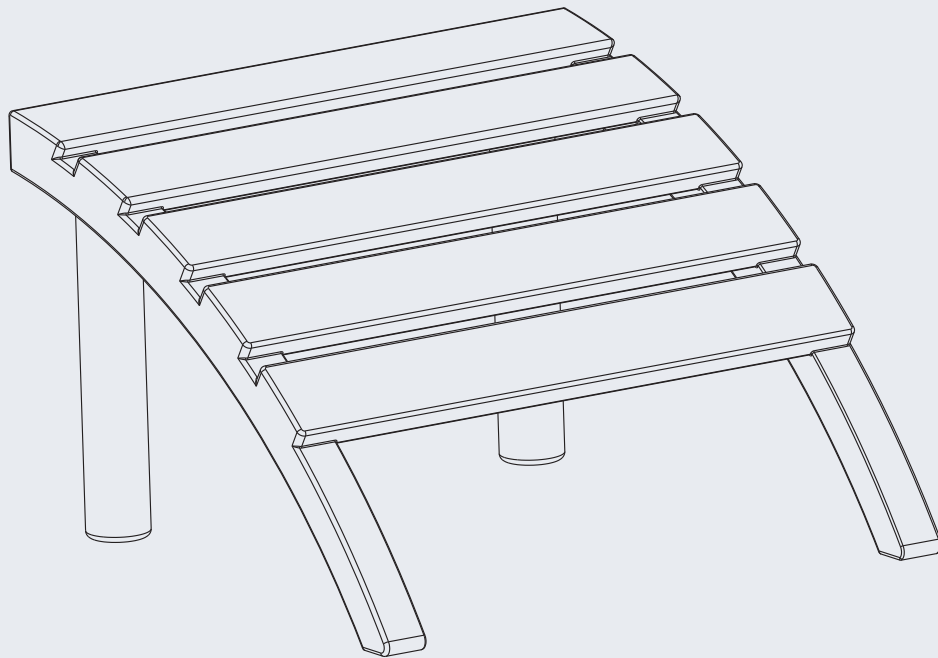

Outdoor Poly Adirondack Ottoman

V1.0

## ! CARE & MAINTENANCE

**Please keep this instruction for your future reference.**

- Be careful when assembling, avoid damaging the painted surface.
- Clean the ottoman with lukewarm water, mild detergent & soft cloth.
- Firmly secure all connections before use. Do not use any part of this item as a step ladder.
- Do not use or store this item in the proximity of open flame or flammable/combustible chemicals.
- Be aware that some parts are heavy and have sharp edges.
- Please do not exceed the weight limitations of this item.

## NO TOOLS REQUIRED



**OTTOMAN  
80 LBS  
CAPACITY**



**1 PERSON  
ASSEMBLY**



**UP TO 1 MIN.  
ASSEMBLY**

## PARTS

**A**

**OTTOMAN  
TOP**

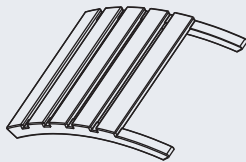

**1 PC**

**B**

**OTTOMAN  
LEG**

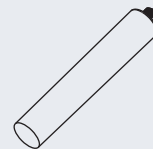

**2 PCS**

## PRODUCT ASSEMBLY – OVERALL VIEW

Look at following overall view of this ottoman and learn the exact position of each part to be assembled.

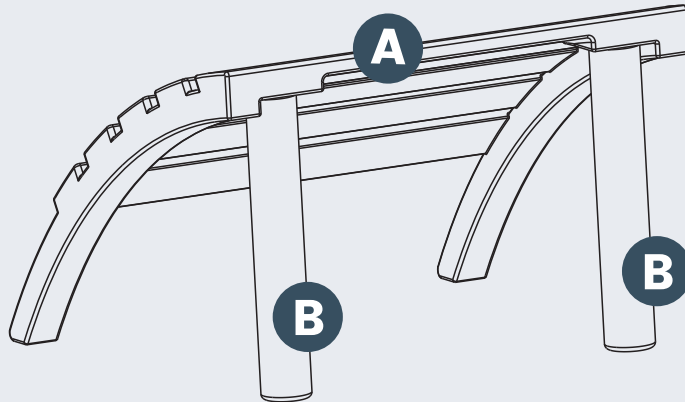

## PRODUCT ASSEMBLY

1

Pick out **Part A Ottoman Top** and 1 pc of **Part B Leg** from the package.

Align the threaded head of fix spacing **Part B Leg** with the screw hole in the bottom of **Part A Ottoman Top**.

Turn the screw clockwise until the leg attaches firmly to the ottoman top.

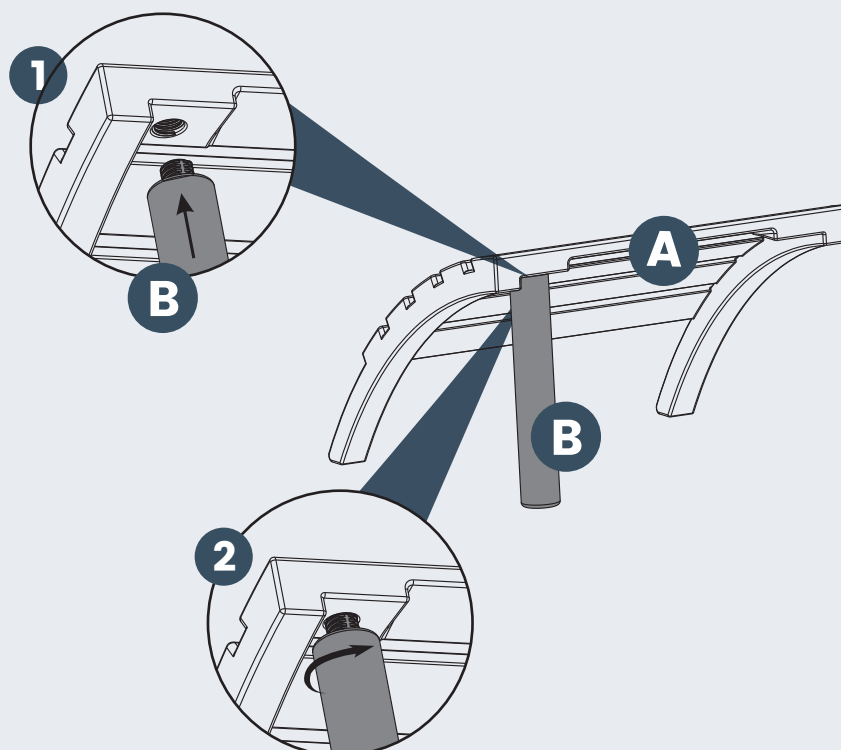

## PRODUCT ASSEMBLY

2

Do the same to attach another **Part B Leg** to **Part A Ottoman Top** by step 1 & 2.

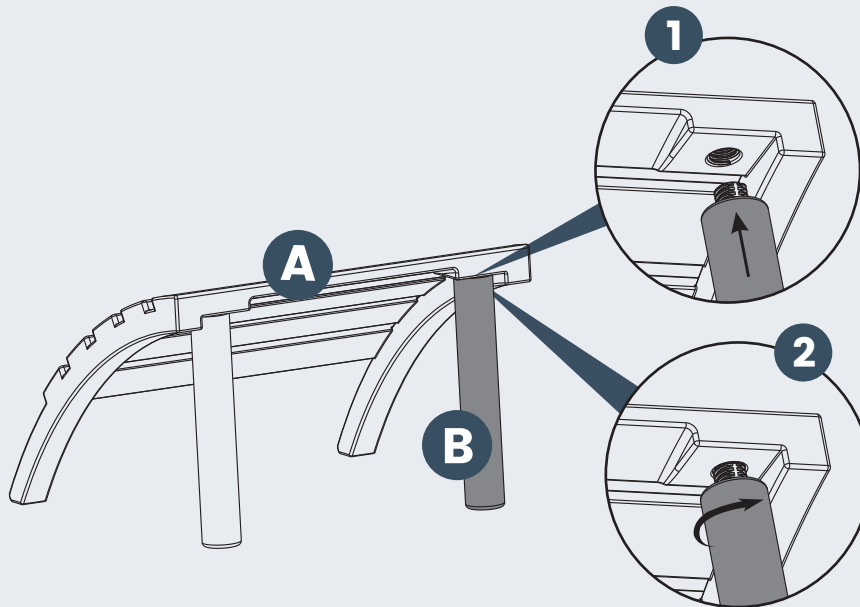

3

Check and tighten the legs again to ensure the ottoman is steady enough.

Enjoy the ottoman now.

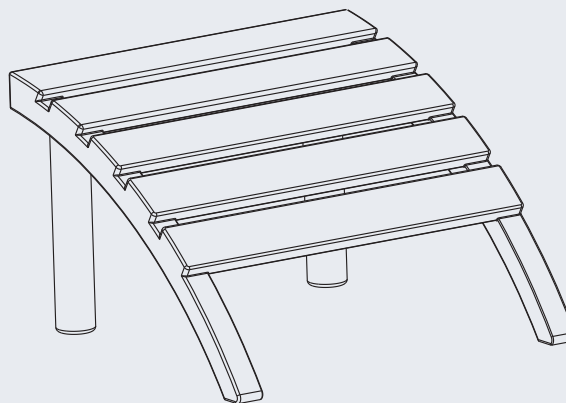

## CLEANING TIPS

**REGULAR CLEAN:** Use a mixture of warm water and mild soap. Gently scrub the surface with a soft bristle brush to remove any dirt or stains.

**QUICK CLEAN:** You can simply wipe down the furniture with a damp cloth.

Regular cleaning not only preserves the aesthetic appeal of your furniture, but also helps extend its lifespan.