



Design House is a registered brand  
of DHI Corp. Mequon, WI 53092  
1-800-558-8700

## SINGLE HANDLE TUB & SHOWER FAUCET WITH PRESSURE BALANCE DEVICE

Notes: The picture in this installation instructions is for reference only, pls refer to actual product in installation process.

### MODELS

547679-Satined Nickel  
547661-Polished Chrome  
547687-Polished Chrome  
547703-Satined Nickel  
547604-Polished Chrome  
547612-Satined Nickel  
547711-Polished Chrome  
547729-Satined Nickel  
562777-Polished Chrome  
562785-Satined Nickel  
562793-Oil Rubbed Bronze  
562801-Satined Nickel  
562819-Oil Rubbed Bronze



### PRODUCT SPECIFICATIONS

SPECIFICATIONS
Max. Flow Rate: 2.0 GPM (7.56 LPM)
ASME A112.18.1/CSA B125
Polish chrome or Satined Nickel or Oil Rubbed Bronze

SPECIFICATIONS
Ceramic cartridge



### SAFETY INFORMATION

Please read and understand this entire manual before attempting to assemble, operate or install the product.

#### WARNING

- Protect your eyes with safety glasses when cutting or soldering water supply lines.

#### CAUTION

- If you solder the joints during installation of the faucet, the seats, cartridges, and washers must be removed before using a flame or the warranty will be voided on these parts.
- Cover the sink drain to avoid losing parts.

### PREPARATION

Before beginning assembly of product, make sure all parts are present. Compare parts with package contents list and hardware contents. If any part is missing or damaged, do not attempt to assemble the product. Contact customer service for replacement parts.

#### Estimated Assembly Time: 30 minutes

Tools Required for Assembly (not included): Adjustable Wrench, Groove Joint Pliers, Pipe Wrench, Phillips Head Screwdriver, and Supply Lines.

Installations may vary depending on how the previous faucet was installed. Supplies necessary for the installation of the faucet are not all included; however, they are available wherever plumbing supplies are sold.

Prior to beginning installation, turn off the hot and cold water lines, then turn on the old faucet to release built-up pressure. When installing the new faucet, hand tighten the connector nuts. **DO NOT OVERTIGHTEN.** Connections that are too tight will reduce the integrity of the system.

### ASSEMBLY INSTRUCTIONS

Recommended component locations:  
(see Fig. 1)

Recommended depth for valve body  
in wall is 2-1/2" (2-1/8" MIN - 2-3/4" MAX).

1A. Shower and / or spout outlet hole :  
1-1/4" diameter .

1B. Valve access hole :  
3-3/4" MIN - 4-3/4" MAX . diameter .

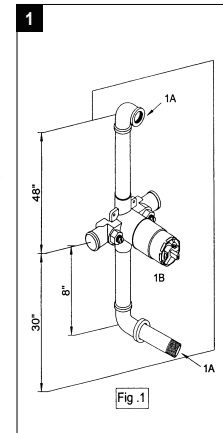

A. Install tub spout and shower arm  
(see Fig. 4) .

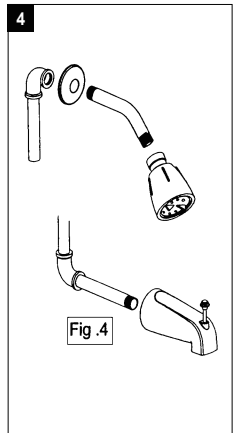

#### Assembly

A. Position valve body correctly in wall  
(see Fig. 2) . UP marking is on up side  
and DOWN marking on down side .

B. Remove valve screws of plastic valve  
protector.

C. Turn on hot and cold water  
supply lines .  
Note : Pressure must be approximately  
equal on both hot and cold sides for  
valves to function properly .

D. Rotate stem to allow water to flow  
From tub spout until there is no  
foreign matter in discharge .

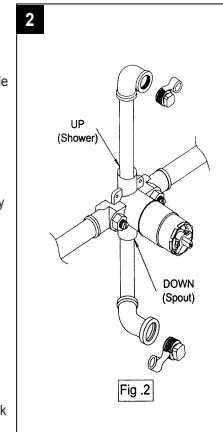

#### Assembly

A. Install A 1/2" iron pipe plug  
(not included) on both shower and tub  
outlets . Turn stem to full " ON " and check  
all connections for leaks .

B. Turn stem to "OFF" .

A. Caution : Slowly remove pipe plugs  
from shower and tub outlets .

B. After wall treatment , remove  
escutcheon screws.

C. Install sleeve and screw  
bonnet onto body.

D. Optional sticker for marking of "red"-hot  
and "blue"-cold to escutcheon .  
" red " direct to hot side and " blue "  
direct to cold side .

E. Install the handle assembly  
(see Fig. 3) .

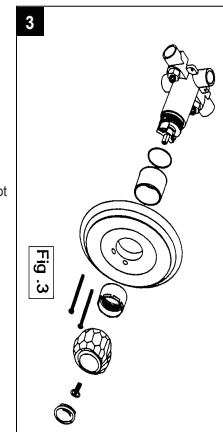

Anti-scald ring: this device limits the  
maximum temperature to avoid accidental  
scalding. It can be set in any of several  
positions to achieve the desired  
temperature.

A. Remove the handle assembly to  
reveal the limiter (see Fig. 3). Located  
on the front of the cartridge.

B. Remove the inverter and the sleeve.

C. Ensure the Down limiter unmovable,  
adjust the Up limiter to desired  
temperature (see Fig. 5, 6 and 7).  
Note: Recommended location is shown  
in Fig. 6.

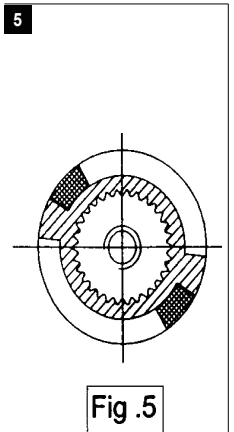

Hot water adjustment

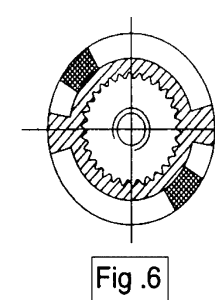

Position in the middle is  
recommended

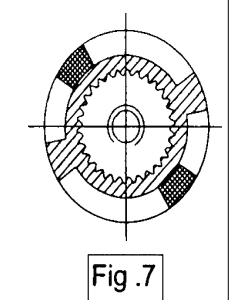

Cold water adjustment

## CARE AND MAINTENANCE

Clean periodically with a soft cloth. Avoid abrasive cleaners, steel wool, and harsh chemicals as these will dull the finish and void your warranty.

## TROUBLESHOOTING

PROBLEM	POSSIBLE CAUSE	CORRECTIVE ACTION
Leaks from spout	Damaged or dirty valve seat.	1. Remove faucet handle, cartridge, housing and valve spool to check the rubber valve seal. Clean it or replace by calling Customer Service.
Bonnet is loose or bottom gasket on cartridge is dirty or twisted.	Bonnet is loose or bottom gasket on cartridge is dirty or twisted.	1. Remove faucet handle. Tighten the bonnet. Clean or replace O-ring.

## LIMITED LIFETIME WARRANTY

The distributor warrants to the original consumer purchaser this product to be free from defects in material and workmanship under normal use in residential applications. At its option, the Company will provide repair parts or replace defective product when the product is used in accordance with the manufacturer's specifications.

The distributor provides a limited warranty on the finish of this product to the original purchaser. At its option, the distributor will provide repair parts or replace defective product when the product is used in accordance with the manufacturer's specifications. Use of mild abrasive, abrasive or chemical cleaners may damage the finish of the faucet. We recommend cleaning your faucet with a soft cloth, moistened with water. Damage resulting from the use of abrasive or chemical cleaners SHALL VOID THIS WARRANTY.

This warranty is not applicable to any products or parts of products where damage is caused by use of non-genuine parts; is due to installation error, product misuse, negligence or faulty maintenance; or where the product is not installed according to local building codes.

This warranty excludes labor charges or damage incurred during installation, repair or replacement, and any indirect, incidental or consequential damages, losses, injury or costs of any nature. This warranty is in lieu of and excludes all other warranties, conditions and guarantees, whether expressed or implied, including without restriction those of merchantability or fitness of use. Liability under this warranty will not exceed the purchase price for the product claimed to be defective by the original consumer purchaser. Some states or provinces do not allow the exclusion or limitation of consequential damages so the above limitations or exclusions may not apply. This warranty gives you specific legal rights and you may also have other rights which vary from state to state, or province to province.

Inquiries regarding warranty claims can be directed to 1-800-558-8700, 8 a.m. - 5 p.m., CST, Monday - Friday.



