

# CARE & MAINTENANCE

## Spare Parts

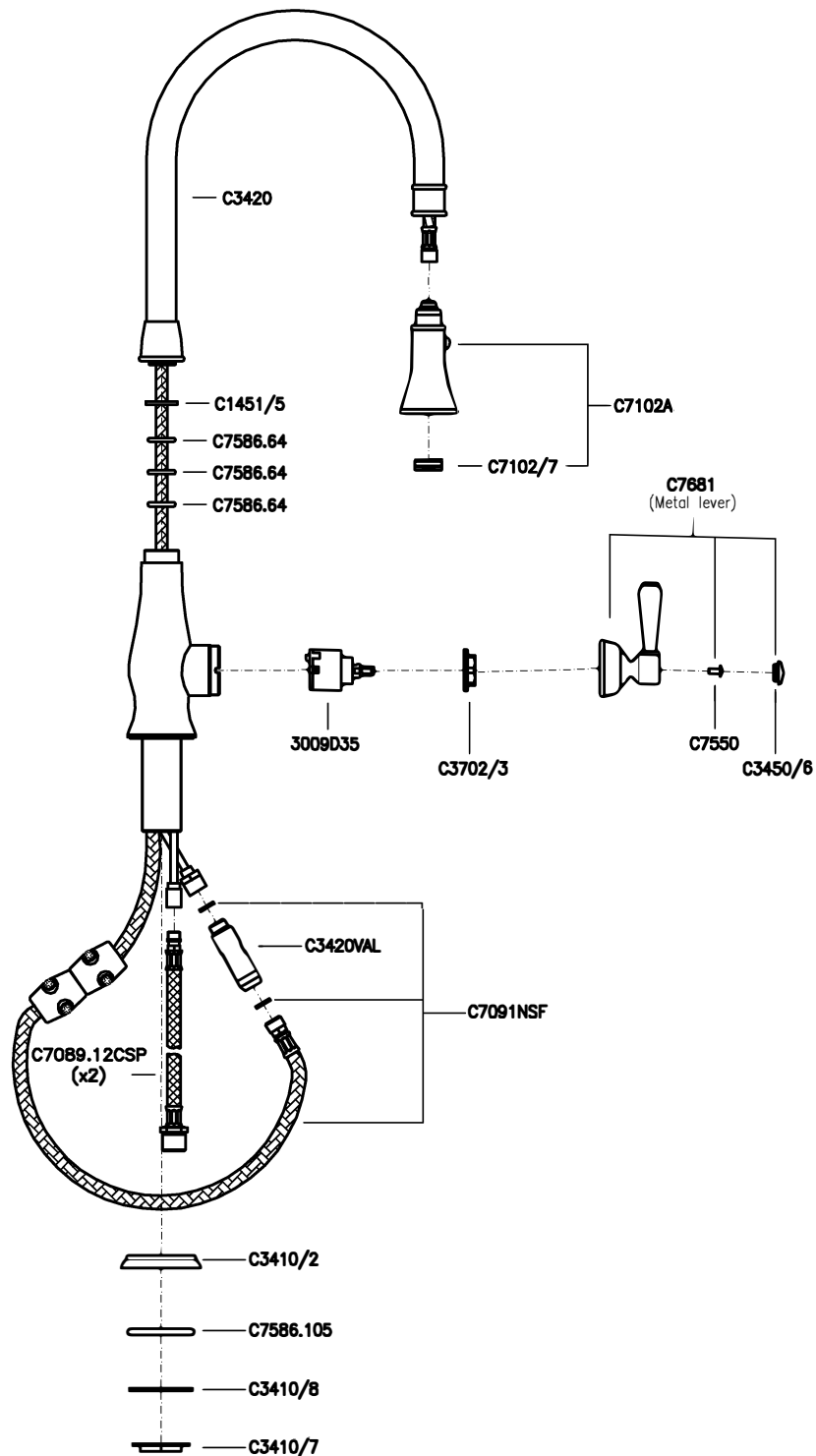

## Cleaning

Clean the chromium plated surfaces with soap and water or with mild liquid detergent. Do not use any abrasive cleaners or chloride bleach.

The gold plated or nickel plated surfaces; even if make on thickness way; must be cleaned only with a damp cloth or with a non abrasive and acid fluid very diluted.

Use the same cleaning procedure for all other finishings including satin nickel, inca brass.

**WARNING:** the use of cleaning products not recommended might irreparably harm the surfaces of the faucets which in such case are not covered by our warranty.