

MCKINNEY STORAGE FULL/QUEEN/E.KNG BED ASSEMBLY INSTRUCTIONS



PARTS PACKING CONFIGURATIONS

BOX #1:

A. HEADBOARD 1 PC

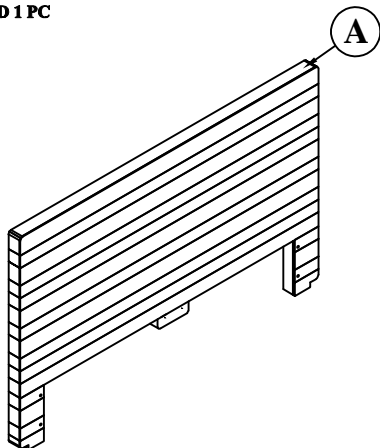

BOX #2:

B. FOOTBOARD 1 PC

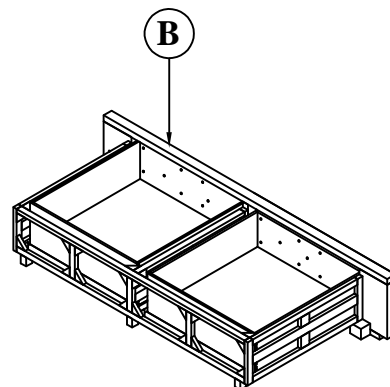

BOX #3:

C. SIDE RAIL 2 PCS
D. ENTER SLAT SUPPORT 1 PC
E. SUPPORT LEG 3 PCS
F. SLAT ROLL 1 SET

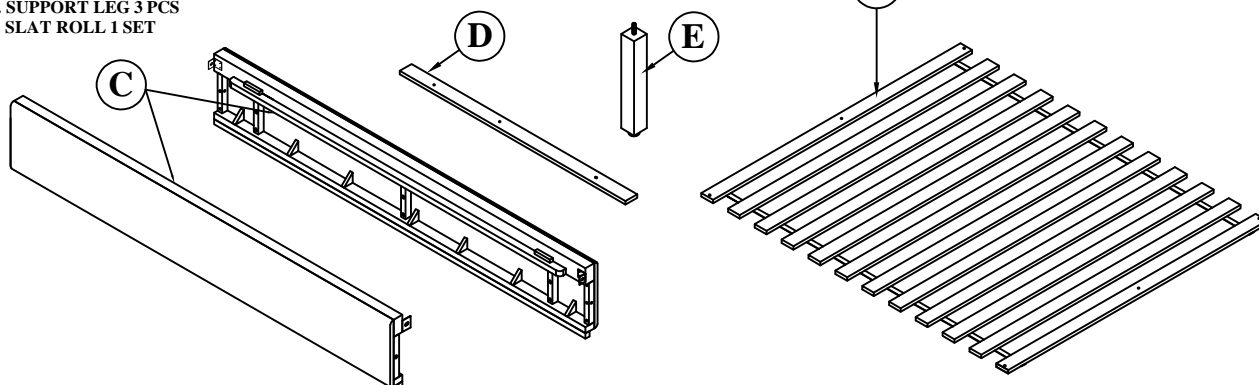

HARDWARE PACKED IN BOX #3

No	Description	Photo	Quantity
1	ALLEN BOLT (M8X30)		4 PCS
2	ALLEN BOLT (M8X50)		4 PCS
3	SPRING WASHER (M9)		8 PCS
4	FLAT WASHER (M9)		8 PCS
5	WOOD SCREW (M4X20)		12 PCS
6	WOOD SCREW (M4X30)		6 PCS
7	METAL BRACKET		2 PCS
8	ALLEN KEY		1 PC

MCKINNEY STORAGE FULL/QUEEN/E.KNG BED ASSEMBLY INSTRUCTIONS

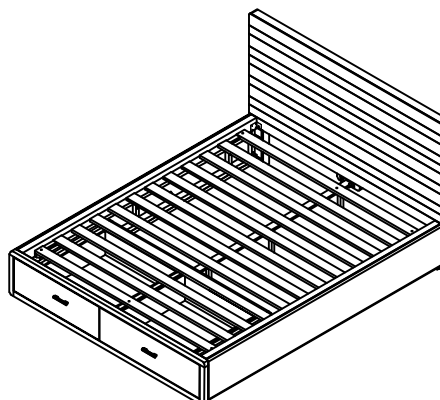

TOOL REQUIRED

PHILLIPS-HEAD SCREWDRIVER (NOT PROVIDED)



MCKINNEY STORAGE FULL/QUEEN/E.KNG BED

ASSEMBLY INSTRUCTIONS



STEP 1

ATTACH THE SIDE RAILS (C) TO THE HEADBOARD (A) USING ONE M8X30 ALLEN BOLT (1), SPRING WASHER (3) AND FLAT WASHER (4) THROUGH THE METAL BRACKET [UPPER] AND ONE M8X50 ALLEN BOLT (2), SPRING WASHER AND FLAT WASHER THROUGH THE WOODEN CLEAT [LOWER]. REPEAT FOR SECOND SIDE RAIL. ATTACH ONE METAL BRACKET TO THE HEADBOARD, PER THE ILLUSTRATION, WITH SIX M4X20 WOOD SCREWS (5).

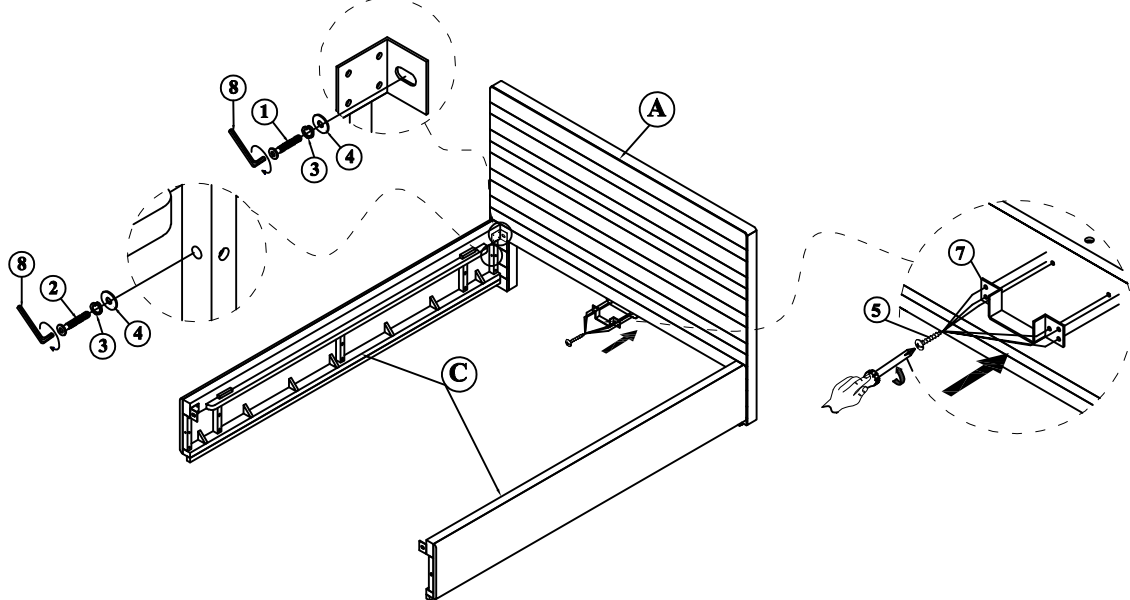

STEP 2

REPEAT STEP 1 TO CONNECT THE FOOTBOARD (B) TO THE SIDE RAILS. TIGHTEN ALL ALLEN BOLTS, INCLUDING THOSE FROM STEP 1, COMPLETELY WITH THE ALLEN KEY (8). CONNECT THE METAL BRACKET TO THE FOOTBOARD WITH SIX M4X20 WOOD SCREWS.

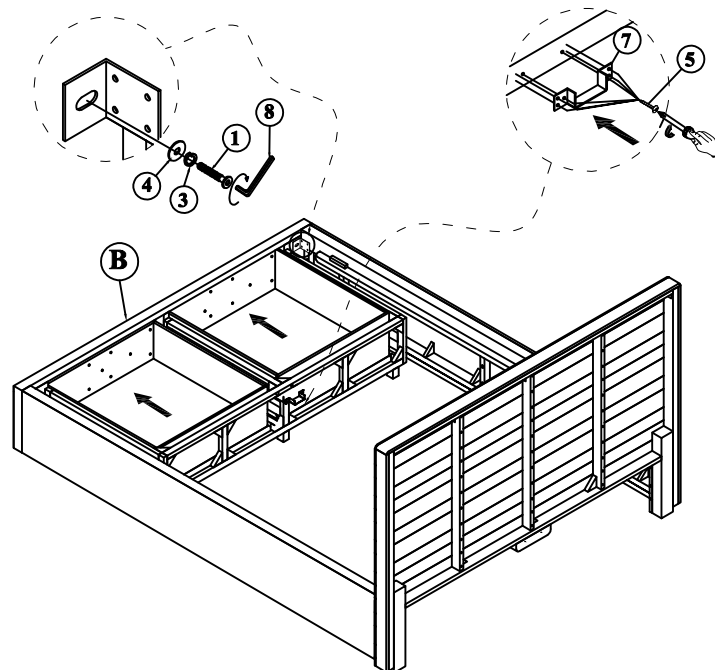

MCKINNEY STORAGE FULL/QUEEN/E.KNG BED ASSEMBLY INSTRUCTIONS



STEP 3

CONNECT THE SUPPORT LEGS (E) TO THE CENTER SLAT SUPPORT (D) AND THEN PLACE THE SLAT ASSEMBLY IN THE PRE-ATTACHED BRACKETS.

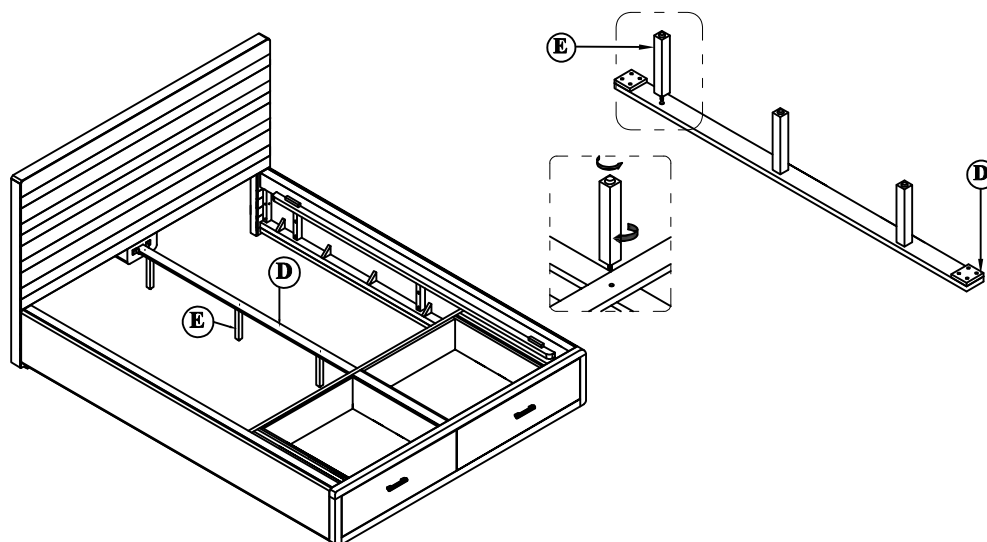

STEP 4

SECURE THE SLAT ROLL (F) TO THE BED ASSEMBLY WITH SIX M4X30 WOOD SCREWS .

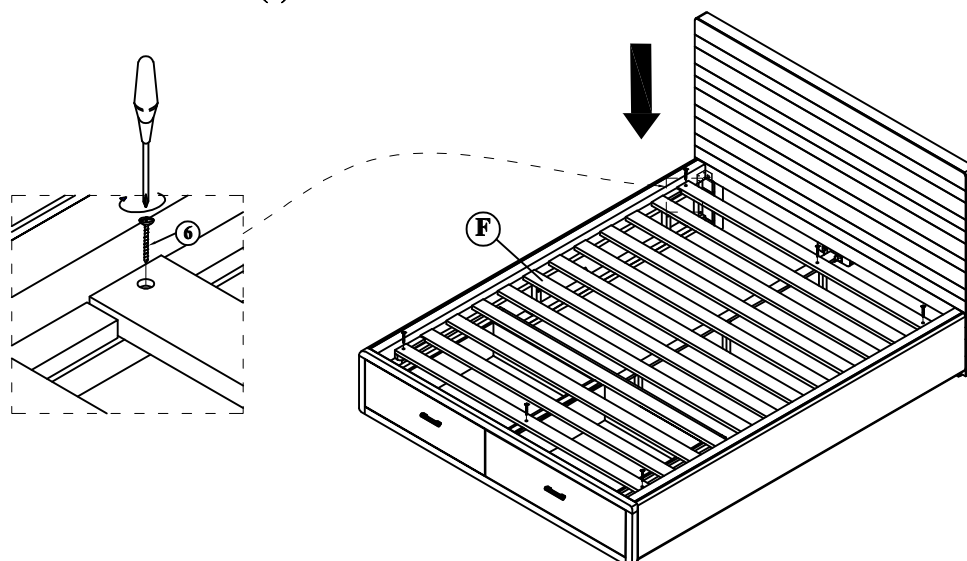

INSTRUCTIONS FOR ADJUSTING LEVELER

POSITION THE BED IN YOUR SPACE AND LOCATE THE LEVELER UNDER EACH SUPPORT LEG. TURN THE LEVELER COUNTER-CLOCKWISE TO EXTEND THE LEVELER AND CLOCKWISE TO RETRACT IT.

ADJUST EACH LEVELER UNTIL EACH SUPPORT LEG IS APPLY EQUAL, UPWARD PRESSURE ON THE SUPPORT SLAT.

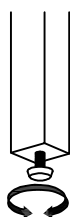

MAINTENANCE INSTRUCTIONS:

REMOVE YOUR MATTRESS, AND BOX SPRING IF APPLICABLE, BEFORE MOVING YOUR BED.

LIFT YOUR BED WHEN MOVING IT; DRAGGING CAN DAMAGE THE SUPPORTS.

RE-ADJUST THE LEVELERS AFTER MOVING YOUR BED.

MCKINNEY STORAGE C. KING BED ASSEMBLY INSTRUCTIONS



PARTS PACKING CONFIGURATIONS

BOX #1:

A. HEADBOARD 1 PC

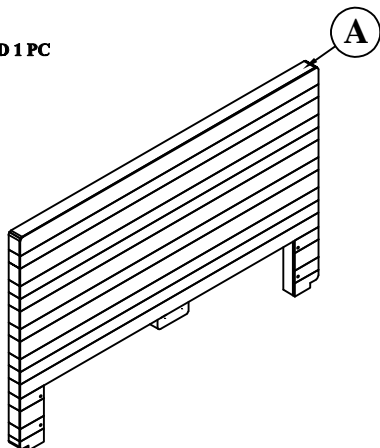

BOX #2:

B. FOOTBOARD 1 PC

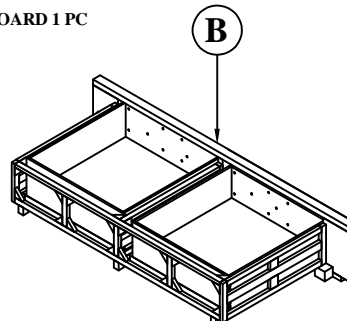

BOX #3:

C. SIDE RAIL 2 PCS
D. ENTER SLAT SUPPORT 1 PC
E. SUPPORT LEG 3 PCS
F. SLAT ROLL 1 SET
G. SIDE RAIL SPACER 2 PCS

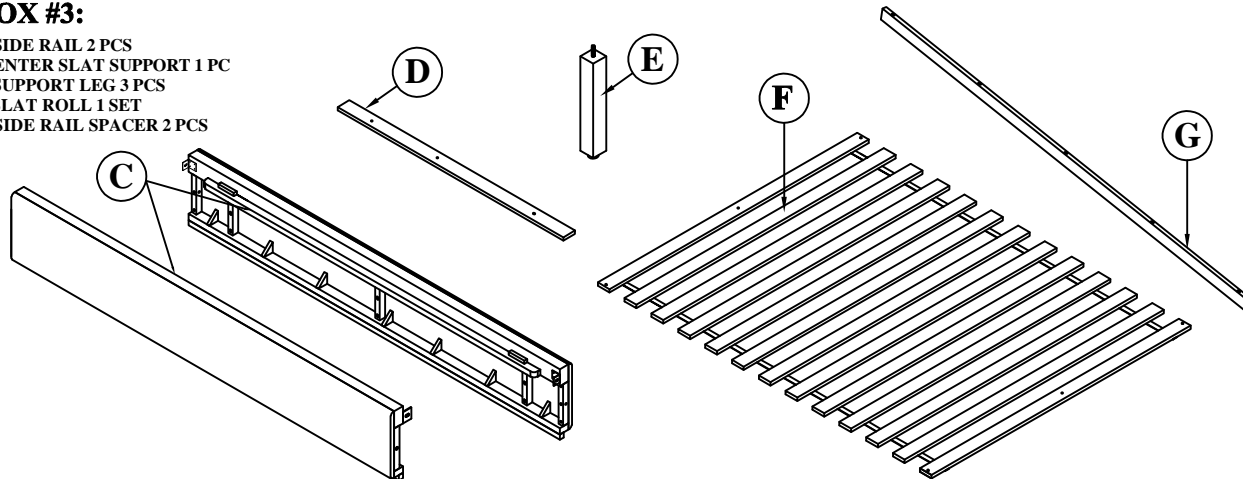

HARDWARE PACKED IN BOX #3

No	Description	Photo	Quantity
1	ALLEN BOLT (M8X30)		4 PCS
2	ALLEN BOLT (M8X50)		4 PCS
3	SPRING WASHER (M9)		8 PCS
4	FLAT WASHER (M9)		8 PCS
5	WOOD SCREW (M4X20)		12 PCS
6	WOOD SCREW (M4X30)		6 PCS
7	METAL BRACKET		2 PCS
8	ALLEN KEY		1 PC
9	ALLEN BOLT (M6X60)		10 PCS

MCKINNEY STORAGE C.KNG BED ASSEMBLY INSTRUCTIONS

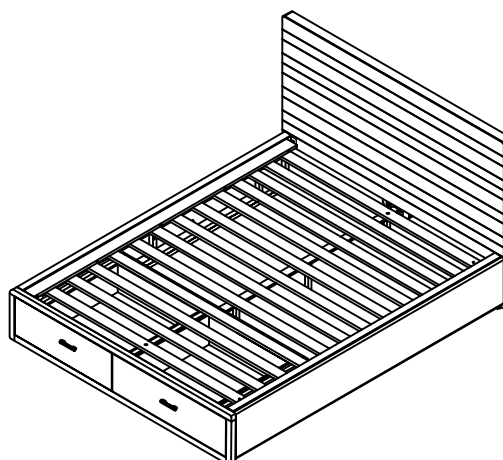

TOOL REQUIRED

PHILLIPS-HEAD SCREWDRIVER (NOT PROVIDED)



MCKINNEY STORAGE C.KNG BED

ASSEMBLY INSTRUCTIONS



STEP 1:

ATTACH THE SIDE RAILS (C) TO THE HEADBOARD (A) USING ONE M8X30 ALLEN BOLT (1), SPRING WASHER (3) AND FLAT WASHER (4) THROUGH THE METAL BRACKET [UPPER] AND ONE M8X50 ALLEN BOLT (2), SPRING WASHER AND FLAT WASHER THROUGH THE WOODEN CLEAT [LOWER]. REPEAT FOR SECOND SIDE RAIL. ATTACH ONE METAL BRACKET TO THE HEADBOARD, PER THE ILLUSTRATION, WITH SIX M4X20 WOOD SCREWS (5).

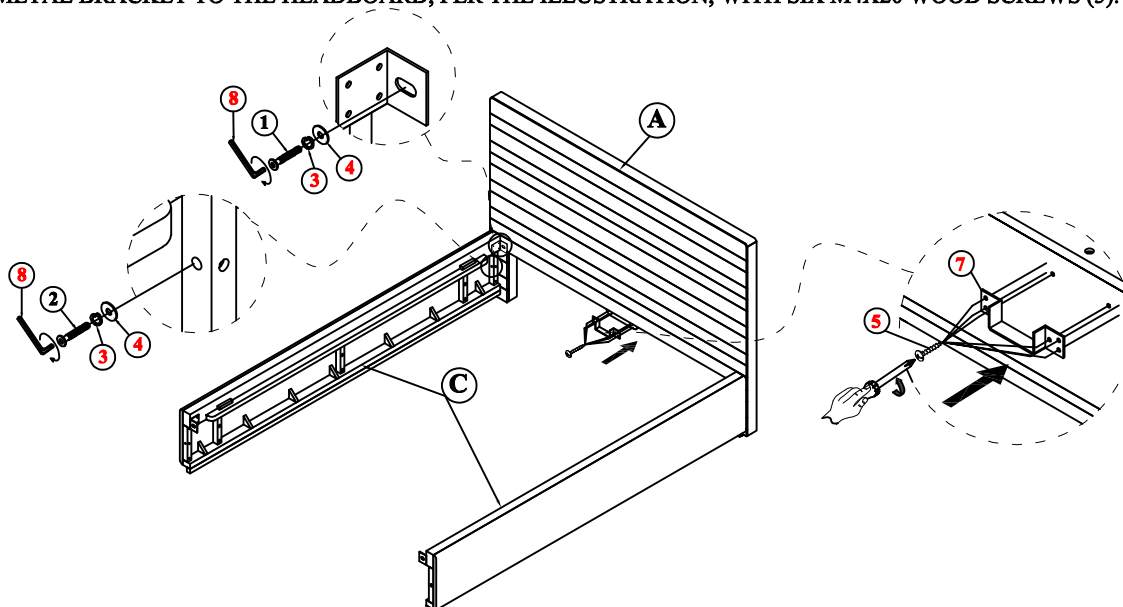

STEP 2:

REPEAT STEP 1 TO CONNECT THE FOOTBOARD (B) TO THE SIDE RAILS. TIGHTEN ALL ALLEN BOLTS, INCLUDING THOSE FROM STEP 1, COMPLETELY WITH THE ALLEN KEY (8). CONNECT THE METAL BRACKET TO THE FOOTBOARD WITH SIX M4X20 WOOD SCREWS.

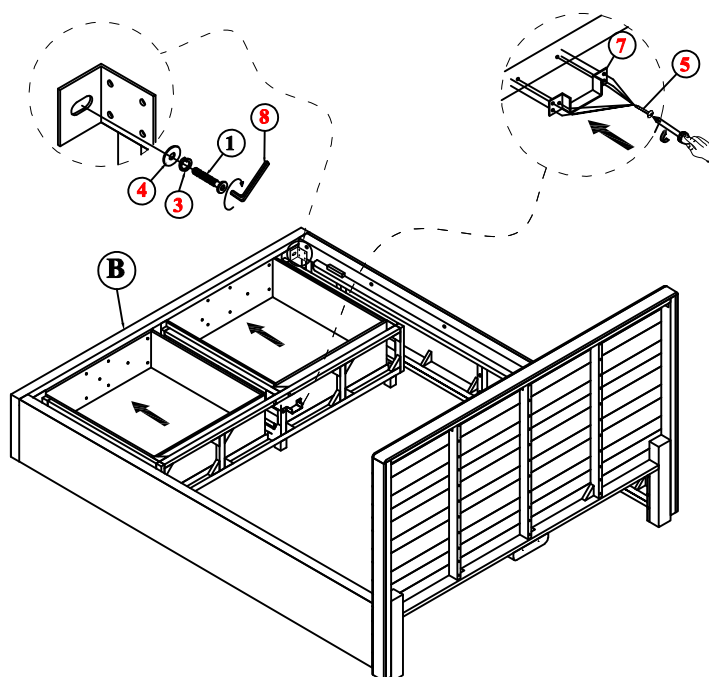

MCKINNEY STORAGE C.KNG BED ASSEMBLY INSTRUCTIONS



STEP 3:

CONNECT THE SUPPORT LEGS (E) TO THE CENTER SLAT SUPPORT (D) AND THEN PLACE THE SLAT ASSEMBLY IN THE PRE-ATTACHED BRACKETS.

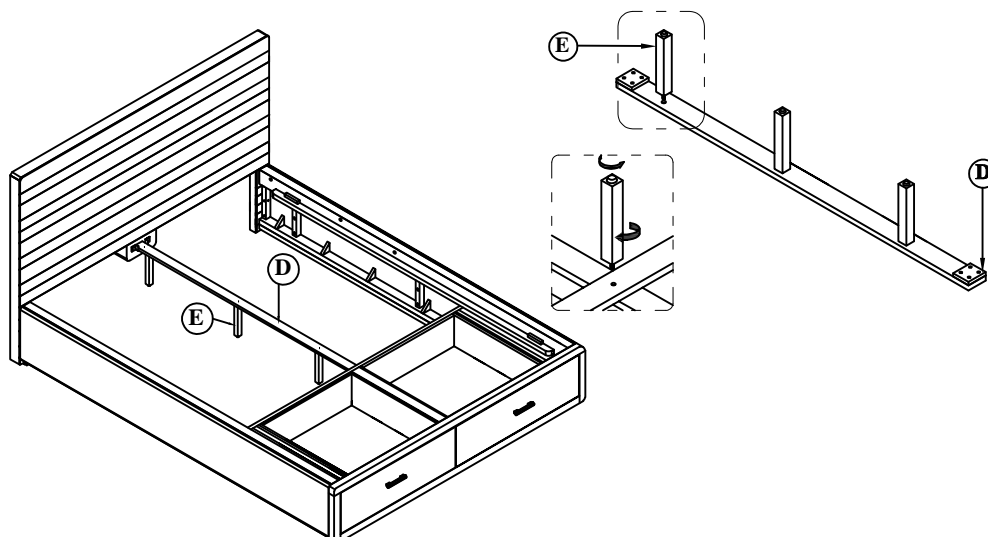

STEP 4:

SECURE THE SLAT ROLL (F) TO THE BED ASSEMBLY WITH SIX M4X30 WOOD SCREWS .

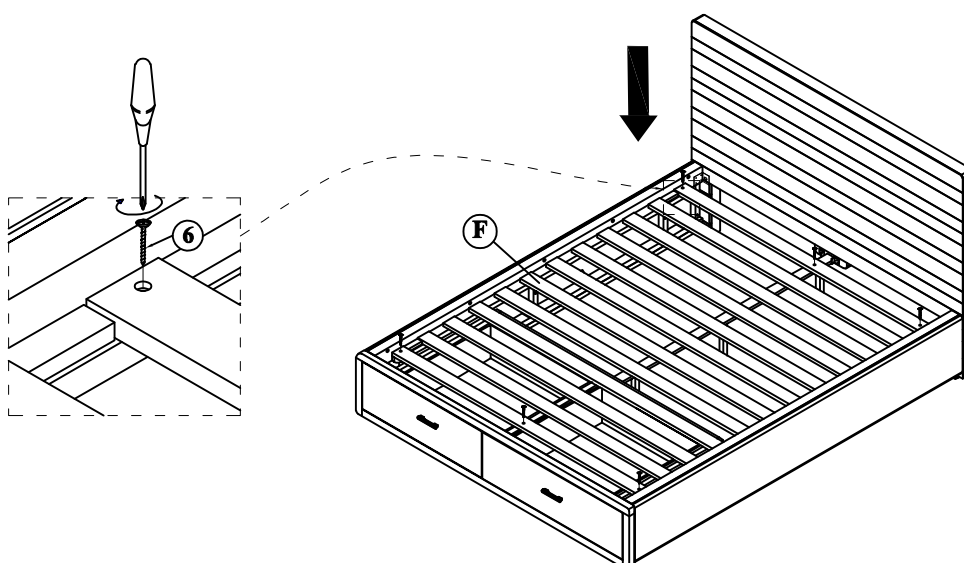

MCKINNEY STORAGE C.KNG BED ASSEMBLY INSTRUCTIONS



STEP 5:

SECURE THE SIDE RAIL SPACER (G) TO THE ASSEMBLED BED WITH TEN M6X60 ALLEN BOLTS. TIGHTEN COMPLETELY WITH THE ALLEN KEY (8)

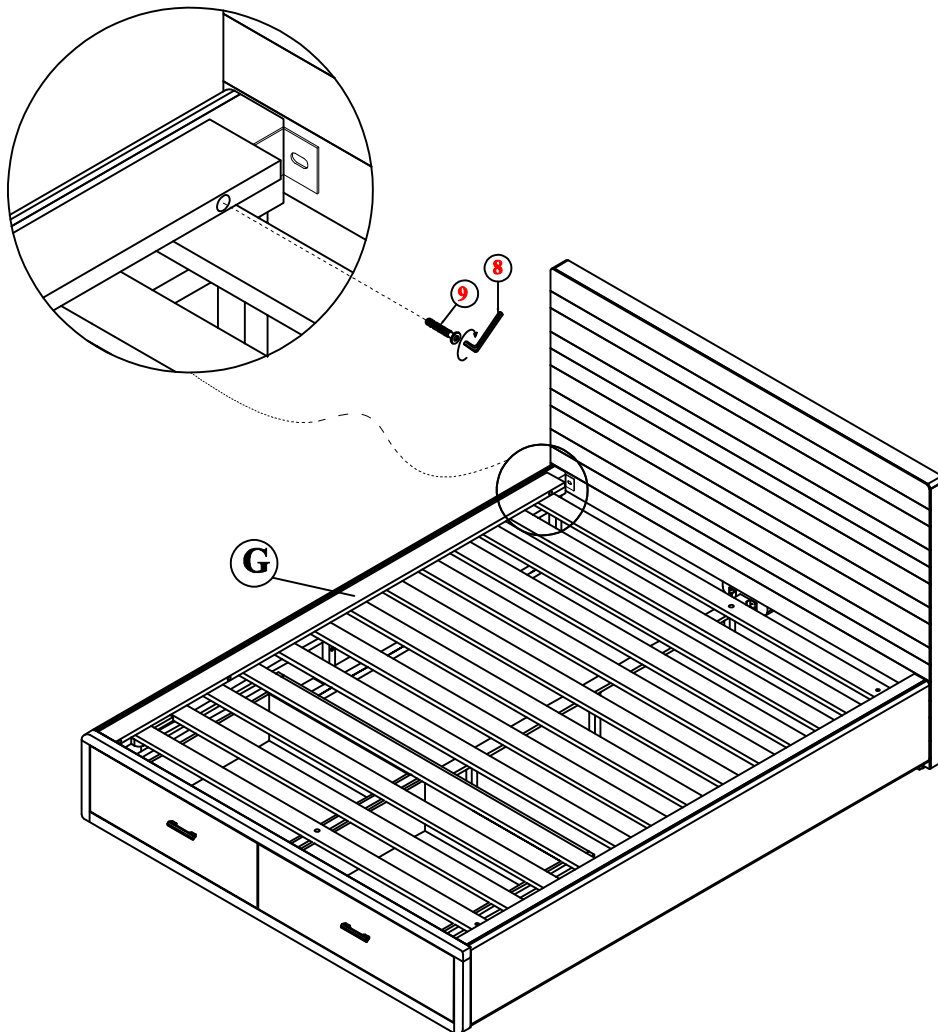

INSTRUCTIONS FOR ADJUSTING LEVELER

POSITION THE BED IN YOUR SPACE AND LOCATE THE LEVELER UNDER EACH SUPPORT LEG. TURN THE LEVELER COUNTER-CLOCKWISE TO EXTEND THE LEVELER AND CLOCKWISE TO RETRACT IT.

ADJUST EACH LEVELER UNTIL EACH SUPPORT LEG IS APPLY EQUAL, UPWARD PRESSURE ON THE SUPPORT SLAT.

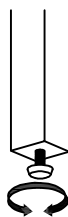

MAINTENANCE INSTRUCTIONS:

REMOVE YOUR MATTRESS, AND BOX SPRING IF APPLICABLE, BEFORE MOVING YOUR BED.

LIFT YOUR BED WHEN MOVING IT; DRAGGING CAN DAMAGE THE SUPPORTS.

RE-ADJUST THE LEVELERS AFTER MOVING YOUR BED.