

## Power Recliner with Power Headrest

### IMPORTANT NOTE

Read these instructions carefully, and familiarize yourself with each procedure before assembling the furniture. Check that you have all the component parts, and familiarize yourself with each part before proceeding.

Take all the fittings out of the plastic bag and separate them into groups. Ensure you have enough space to lay out all the parts before assembly. To prevent damage to the parts, we recommend that you assemble the unit on a soft, level surface.

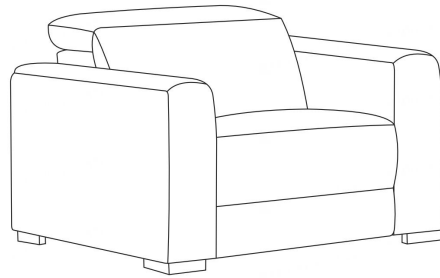

### Part List

A. Wood Leg  
4 pieces

B. Spanner  
1 piece

C. Grommets  
8 pieces

D. Screw #1  
8 pieces

E. Screw #2  
4 pieces

F. Plastic Feet  
4 pieces

H. Transformer  
1 piece



### Assembly Instructions

#### STEP 1

Detach the Transformer (H) and accessories from the bottom of the seat (See Figure 1.)

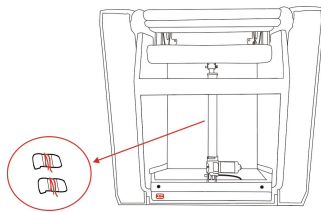

Figure 1

#### STEP 2

Take the accessories out then attach the Wood Leg (A) to the bottom of the seat with Screws (D) and Grommets (C), attach the Plastic Feet (F) with Screws (E). (See Figure 2.)

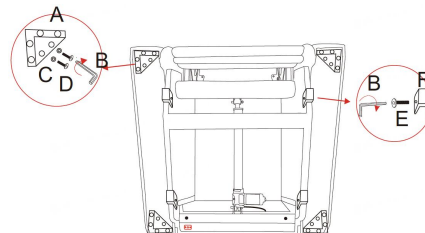

Figure 2

### Assembly Instructions

#### STEP 3

Plug the Transformer (H) to transformer switch. (See Figure 3.)

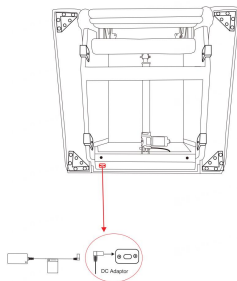

Figure 3

#### STEP 4

Plug the transformer (H) into a nearby outlet, still making sure it is clear of the metal base. (See Figure 4.)

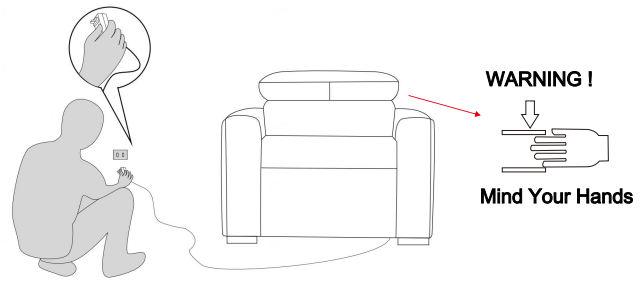

Figure 4

### IMPORTANT NOTE

- To avoid any risk of suffocation to children or pets, dispose of all plastic bags immediately.
- To ensure proper performance, occasionally check for loose screws and tighten as needed.
- If the reclining functions are not working properly, check for loose cable connections before contacting the retailer.