

SIDES	BOTTOM
2 PCS #8-32×3/8 pack in Poly-Bag seperately	
Material:Steel-0.028"-C.R.S Pored Coated Red	

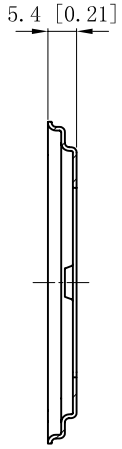

CUTAWAY VIEW A-A

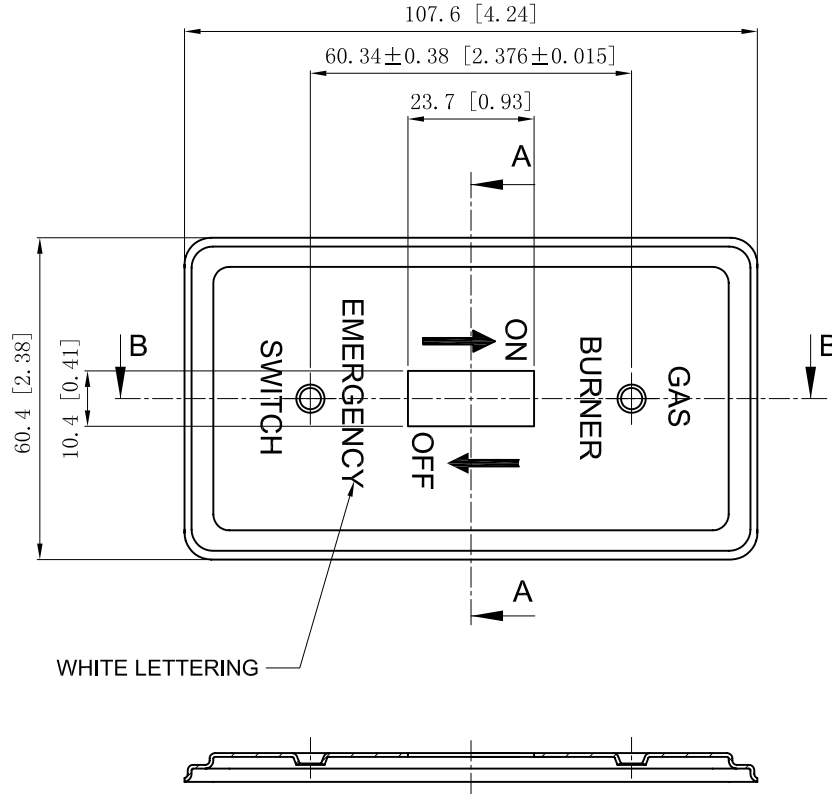

WHITE LETTERING



CUTAWAY VIEW B-B

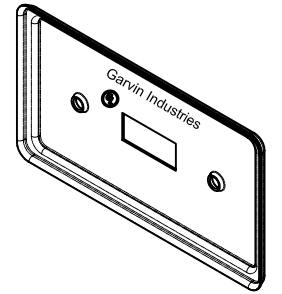

DESCRIPTION
TRADE REFERENCE TERMS

This data sheet is for reference only .GARVIN INDUSTRIES reserves the right to make changes to the design without prior notice.

STANDARD PACKING
25/100 PCS

<b>GARVIN INDUSTRIES</b>		
TITLE HANDY BOX COVER WITH 1-TOGGLE & ON/OFF		
SIZE A4	DWG NO. BP-19350	REV B
DATA SHEET		