

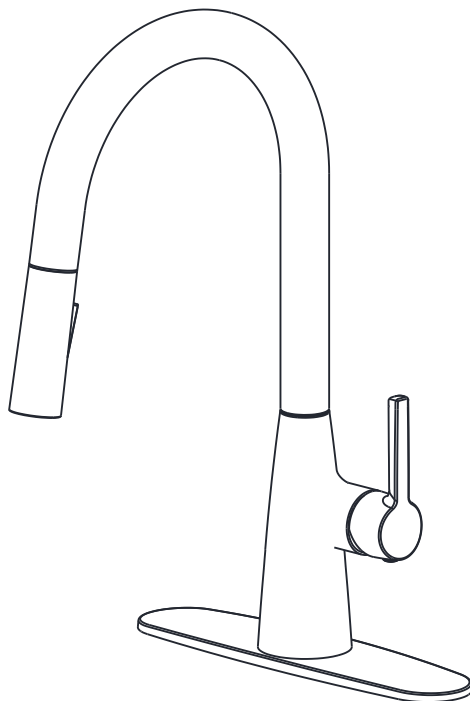

ITEM: KF-AZ701**
ANZZI SENSOR KITCHEN FAUCET
INSTALLATION & OPERATION MANUAL

V1.0
09/12/2024



DON'T WAIT! REGISTER NOW!

Register your product within 90 days to ensure your product is recognized as an official purchase and is eligible for warranty coverage.

Register online at <https://anzzi.com/pages/register> or scan the QR code at PG. 2.



PRODUCT REGISTRATION*

IMPORTANT: Warranty will not be recognized unless product is registered.

Register online at <https://anzzi.com/pages/register> or Scan the QR code below.

Registering online is fast, secure, and ensures we receive your information.

1

USE YOUR PHONE CAMERA
TO SCAN THE QR CODE

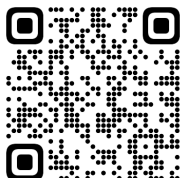

2

FILL IN A QUICK
REGISTRATION FORM

Thank you for your purchase!

Registering your products ensures you maximize your warranty benefits and receive prompt service and support.

Name*

Email*

City*

Order #*

Installer Name

...

Model Purchased*

Installer Phone Number

Customer Age Range

Submit

3

CLICK SUBMIT AND
ENJOY PEACE OF MIND

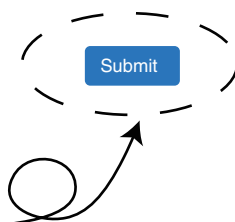

Need help? For technical support call 305-614-4070 or visit us at www.ANZZI.com

PRODUCT SIZE CHART

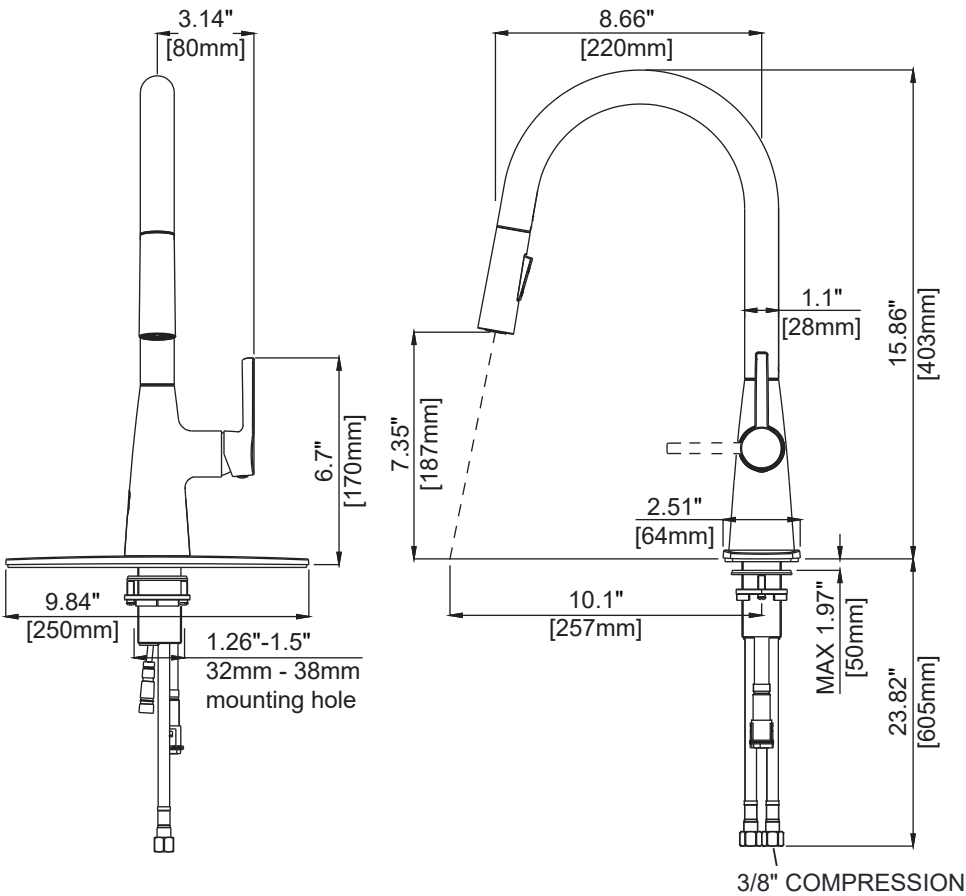

TOOLS AND MATERIALS

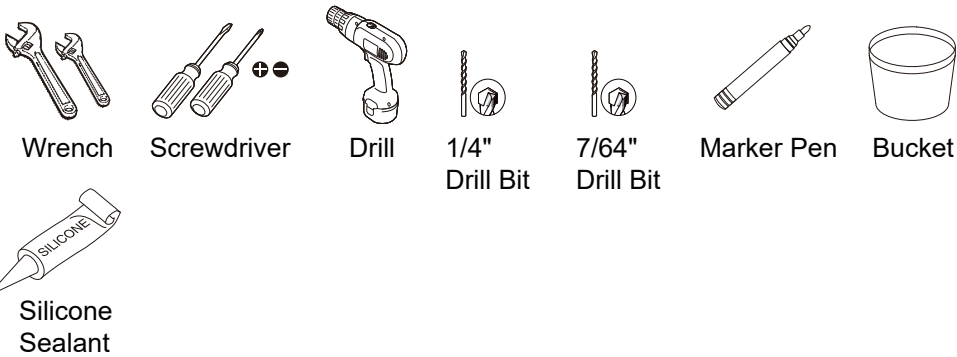

COMPONENTS

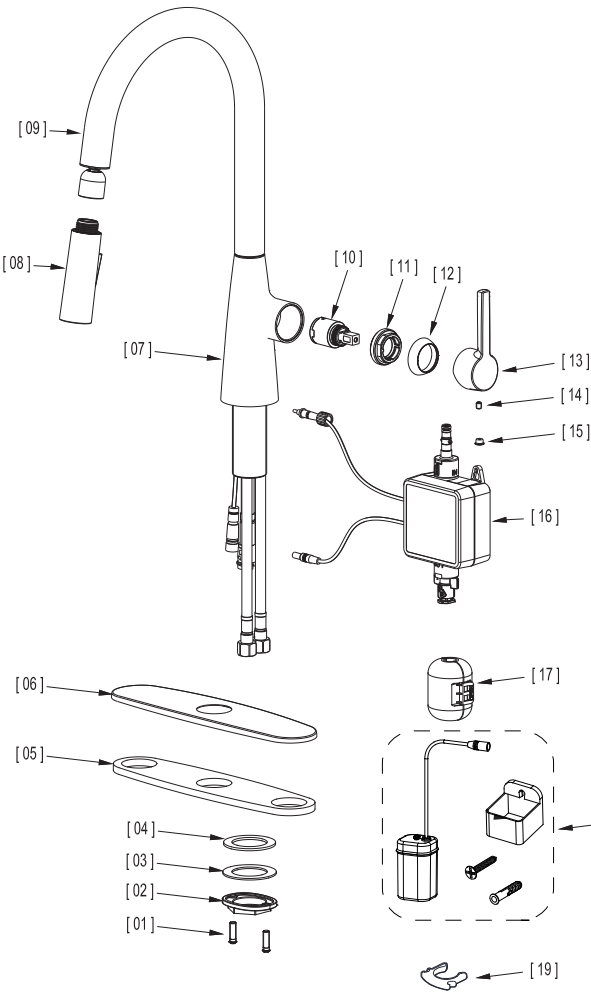

| Part | Description | Qty. |
|------|---------------|------|
| [01] | Screw | 2 |
| [02] | Mounting Nut | 1 |
| [03] | Metal Washer | 1 |
| [04] | Rubber Washer | 1 |
| [05] | Gasket | 1 |
| [06] | Escutcheon | 1 |
| [07] | Faucet | 1 |
| [08] | Sprayer | 1 |
| [09] | Spout | 1 |
| [10] | Cartridge | 1 |
| [11] | Retainer | 1 |
| [12] | Cover | 1 |
| [13] | Handle | 1 |
| [14] | Screw | 1 |
| [15] | Cap | 1 |
| [16] | Control Box | 1 |
| [17] | Weight | 1 |
| [18] | Battery Box | 1 |
| [19] | C-clip | 2 |

Before installation:

1. Please check that all components are present.
2. Ensure that all supply lines are free of debris with supply stops installed.
3. Ensure water pressure is between 20-125 PSI.
4. If you are having difficulties on installation, please contact a professional plumber.

INSTALLATION

1.1 SINGLE HOLE

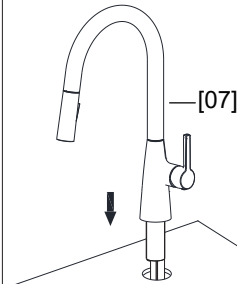

1.2 THREE HOLES

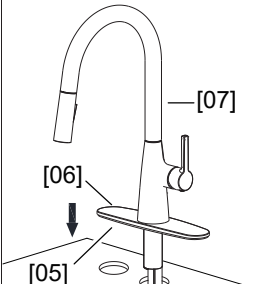

STEP 1

Remove **Rubber Washer [04]**, **Metal Washer [03]** and **Mounting Nut [02]** from **Faucet [07]**.

Single hole application: Install **Faucet [07]** through the faucet hole.

Three holes application: Install **Faucet [07]** through **Escutcheon [06]** and **Gasket [05]** through the faucet hole. Adjust the **Escutcheon [06]**.

Note: Faucet handle should always be on the right-hand side. (fig 1.1, 1.2)

STEP 2

2.1 Slide **Rubber Washer [04]** and **Metal Washer [03]** up onto **Faucet [07]** from under the sink and secure with **Mounting Nut [02]**. (fig 2.1)

2.2 Hand tighten the **Mounting Nut [02]** and tighten the **Screws [01]** with a screwdriver to secure the faucet. (fig 2.2)

2.1

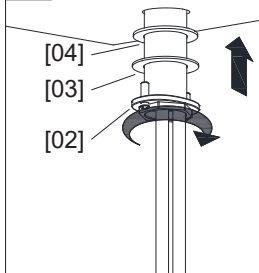

2.2

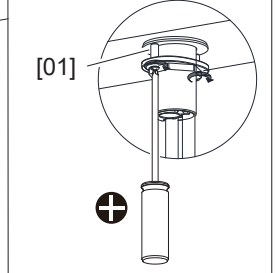

3.1

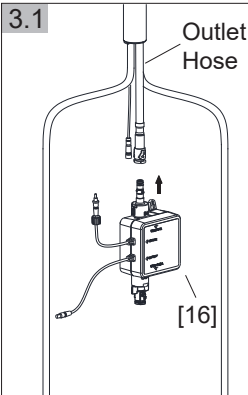

3.2

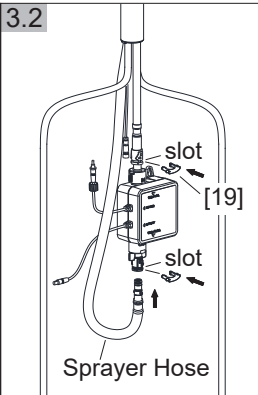

STEP 3

3.1 Connect the **Control Box [16]** to the **Outlet Hose** (the shortest one) under the sink, as the picture shows. Push in until a "click" is heard. Next, tug the **Control Box [16]** downward to ensure it's connected firmly. (fig 3.1)

3.2 Connect the **Sprayer Hose** (the longest one) to the bottom connector of the **Control Box [16]**. Push in until a "click" is heard. Then, tug the hose downward to ensure it's connected firmly. (fig 3.2)

3.3 Install and push the **C-clips [19]** to the **slots** of **Control Box [16]** and **Outlet Hose** until they stop to secure the connections. (fig 3.2)

INSTALLATION

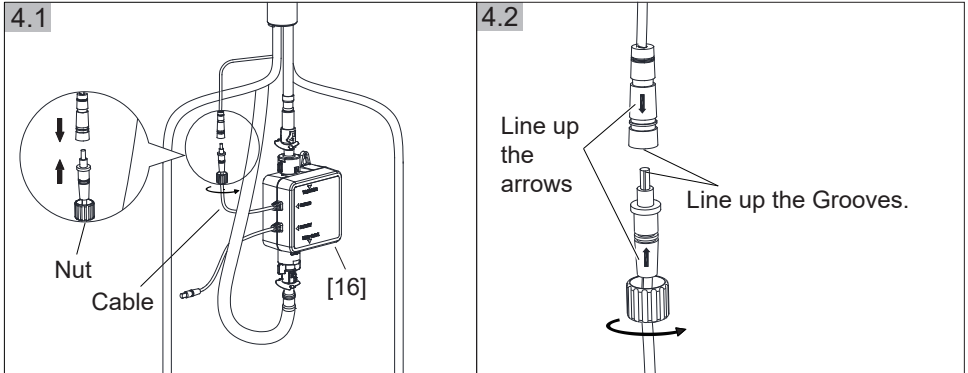

STEP 4

Connect the **Faucet [07]** 6-pin cable to the cable of **Control Box [16]**. Secure the connection by tightening the **Nut** found on the cable of **Control Box [16]**. (fig 4.1, 4.2)
IMPORTANT! Make sure to line up the arrows and grooves found on both cables. Forcing a misaligned connection will damage the pins and cause the touchless sensor to malfunction.

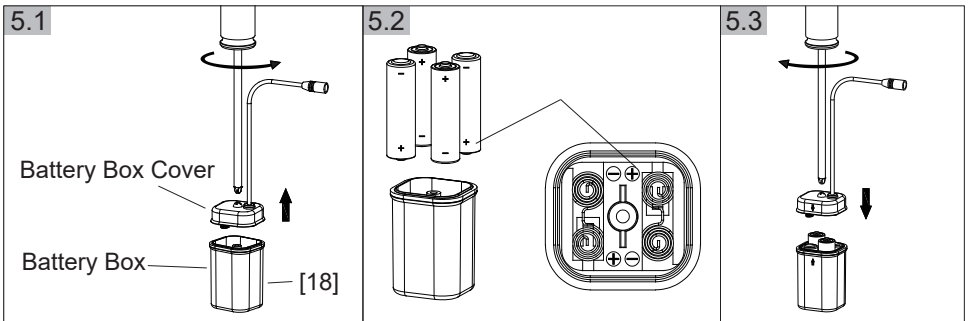

STEP 5

- 5.1 Remove the **Battery Box Cover** with a screwdriver. (fig 5.1)
5.2 Install 4 AA batteries(not provided) to the **Battery Box [18]**. (fig 5.2)
5.3 Install the **Battery Box Cover** back to the **Battery Box [18]** with screwdriver. (fig 5.3)

Notice:

- Make sure the battery polarities match.
- Don't mix old and new batteries.
- Do not mix alkaline, standard (carbon zinc) or rechargeable (nickel cadmium, nickel manganese) batteries.
- Do not throw away used batteries into the garbage. Please properly dispose of all used batteries in accordance to your local codes and laws.

INSTALLATION

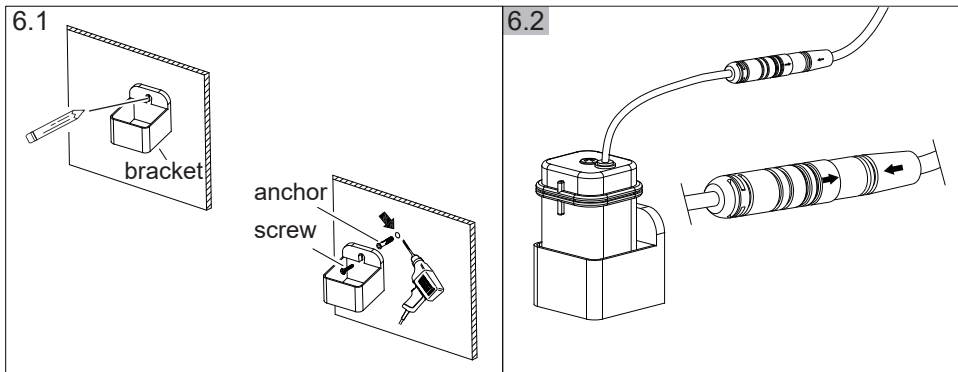

STEP 6

- 6.1 Identify the mounting location of the **bracket**. Mark the screw holes through the **bracket** on the wall. **Ensure that all wires and hoses are organized to avoid tangles or kinks, as these could affect the faucet's performance. Use zip ties if needed.** (fig 6.1)
- 6.2 Drill 7/64" pilot holes in the mounting location if drilling into wood material.
Drill 1/4" holes in the mounting location if drilling into tile material and insert the **anchor**. (fig 6.1)
- 6.3 Secure the **bracket** with **screw**. (fig 6.1)
- 6.4 Connect the cable of **Battery Box [18]** with the cable of **Control Box [16]**. (fig 6.2)
IMPORTANT! Make sure to line up the arrows found on both cables.
Forcing a misaligned connection will damage the pins and cause the touchless sensor to malfunction.

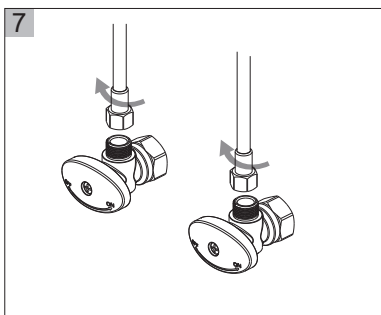

STEP 7

Make sure all fittings and end connections are free of debris. Turn off the supply valves (not provided). Connect faucet supply hoses to the supply valves, making sure the hose with "HOT" label connected to the hot supply valve and the hose with "COLD" label connected to the cold supply valve, hand tighten them, then tighten with wrench. **DO NOT OVERTIGHTEN.**

WARNING: Do not use pipe dope or other sealants on water connections.

INSTALLATION

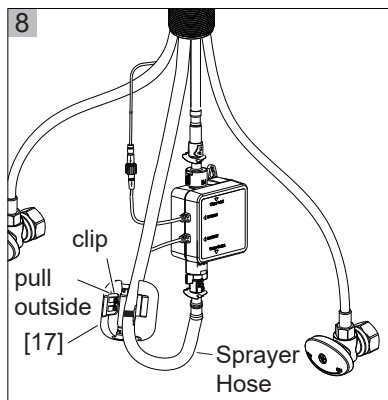

STEP 8

- 8.1 Pull the **clip** of **Weight [17]** outside to open it.
- 8.2 Install the **Weight [17]** to the position of the **Sprayer Hose** where is marked with a "weight" label.
- 8.3 Push to close the **Weight [17]** until a "click" sound is heard.
- 8.4 Shake the **Weight [17]** to make sure it is secured.

WARNING: Pull the Sprayer downward and check the **Weight [17]**. **Ensure that all wires and hoses are organized to avoid tangles or kinks, as these could affect the faucet's performance. Use zip ties if needed.**

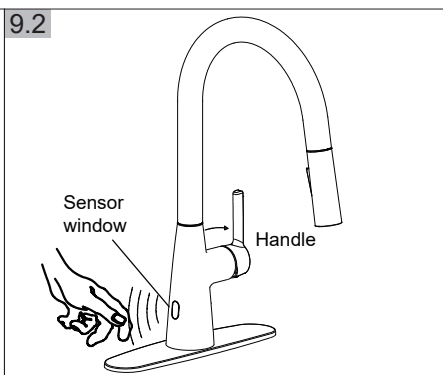
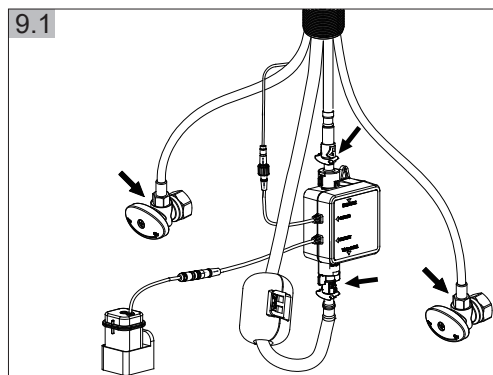

STEP 9

- 9.1 Turn on hot and cold water supplies and check all connections at arrows for leaks. Retighten if necessary, but do not overtighten. (fig 9.1)
- 9.2 Open the handle and wave your hand over the sensor within 2.7" (7cm) distance to start the flow of water. Set the water temperature using the handle. Turn the handle forward will raise the water temperature. Let the water flow and check all connections at arrows for any leaks. The water flow will automatically stop in 3 minutes. (fig 9.1)

OPERATION

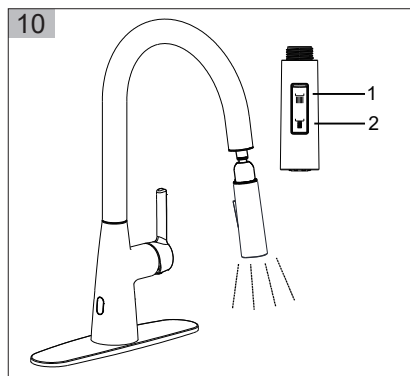

SPRAYER FUNCTIONS

The sprayer will be on flow mode when faucet is turned on. Press the button to switch to spray mode. The sprayer will switch back to flow mode automatically when the faucet is turned off.

Notice:

1. Leaks or damage may occur due to improper installation. Read all instructions before making any final connections and turning on water supplies.
2. Please keep the sensor window clean.
3. When the battery is low, the sensor window will flash five time with intermission until battery runs out. Please replace the batteries as soon as possible.
4. When the batteries run out and new replacement batteries are not available, please remove the **Control Box [16]** and connect the **Sprayer Hose** to the **Outlet Hose** directly. Then install one **C-clip [19]** to the **slot** of **Outlet Hose** to secure. Then the faucet can be operated by the handle.
5. Make sure to close the faucet handle when no one is at home.
6. When leaving home or not using the faucet for an extended period of time please take the following actions:
 - a. Close all water supply lines for the faucet.
 - b. Remove the batteries from the battery box.
7. ANZZI will not be held liable for any damages resulting from incorrect or improper installation.

CLEANING & MAINTENANCE

1. To preserve the finish on the metallic parts of your ANZZI faucet, apply non-abrasive wax, such as car wax. Rinse off any cleaners immediately.
2. Clean the aerator regularly for calcium build-up or any blockage that reduces water flow.
3. If the water flows slower than normal, please clean the filter at the inlet hoses.
 - a. Remove the hot and cold supply hoses. (fig 11.1)
 - b. Insert each hose into a cup of clean water and agitate it back and forth for 15 seconds to remove any possible debris. Then, take out the hose from the cup and drain it. (fig 11.2)
 - c. Connect the supply hoses back to the supply valves. Tighten the nuts of the supply hoses but do not over tighten.
 - d. Turn on hot and cold water supplies and check all connections for leaks. Retighten if necessary, but do not overtighten.

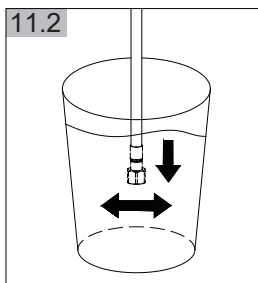
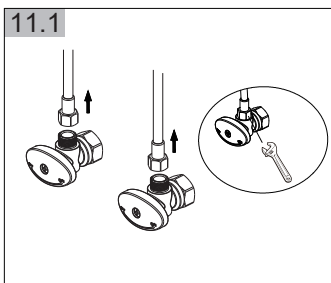

4. If the problem cannot be solved by measures at above point 3, please check the **Filter** at the **Control Box [16]** as figure shows at the right. Clean the **Filter** by following steps below if needed.
 - a. Turn off the handle, remove the **C-clip [19]** and disconnect the **Outlet Hose** from the **Control Box [16]**.
 - b. Remove the **Adapter** from the **Control Box [16]**.
 - c. Remove the **Filter** from the **Adapter** and clean it with brush and clean water only.
 - d. Install the **Filter** and **Adapter** back to the **Control Box [16]** and tighten. **DO NOT OVER TIGHTEN.**
 - e. Connect the **Outlet Hose** to the **Control Box [16]**. Tug the **Control Box [16]** downward to test engagement.
 - f. Install the **C-clip [19]** back to the **Outlet Hose** again.

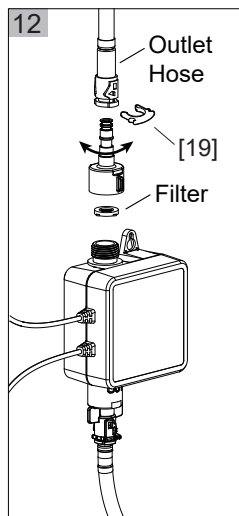

Troubleshooting Table

| Symptoms | Probable Causes | Recommended Action |
|--------------------|--|---|
| No flow | The supply stops are closed. | Confirm that the supply stops are open. |
| | Handle is in the closed position. | Rotate the handle to the open position. Refer to the "Operation" section. |
| | No battery installed. | Install battery, refer to Step 5. |
| | The battery is dead. | Replace battery, refer to Step 5. Before replacing the battery, you can remove the Control Box [16] and connect the Sprayer Hose to the Outlet Hose directly. Then install one C-clip [19] to the slot of Outlet Hose to secure. Then the faucet can be operated by the handle. |
| | Still no flow when the batteries are installed and the handle is on. | Call ANZZI customer support at 305-614-4070. |
| Too little water | There is blockage on the filters. | Check and clean the filters by following "CLEANING & MAINTENANCE". |
| | The water pressure is low. | Raise the water pressure. |
| Short battery life | Use non alkaline or inferior batteries. | Replace with alkaline batteries. |

