

SHIMANO

STELLA

STL-5000SW

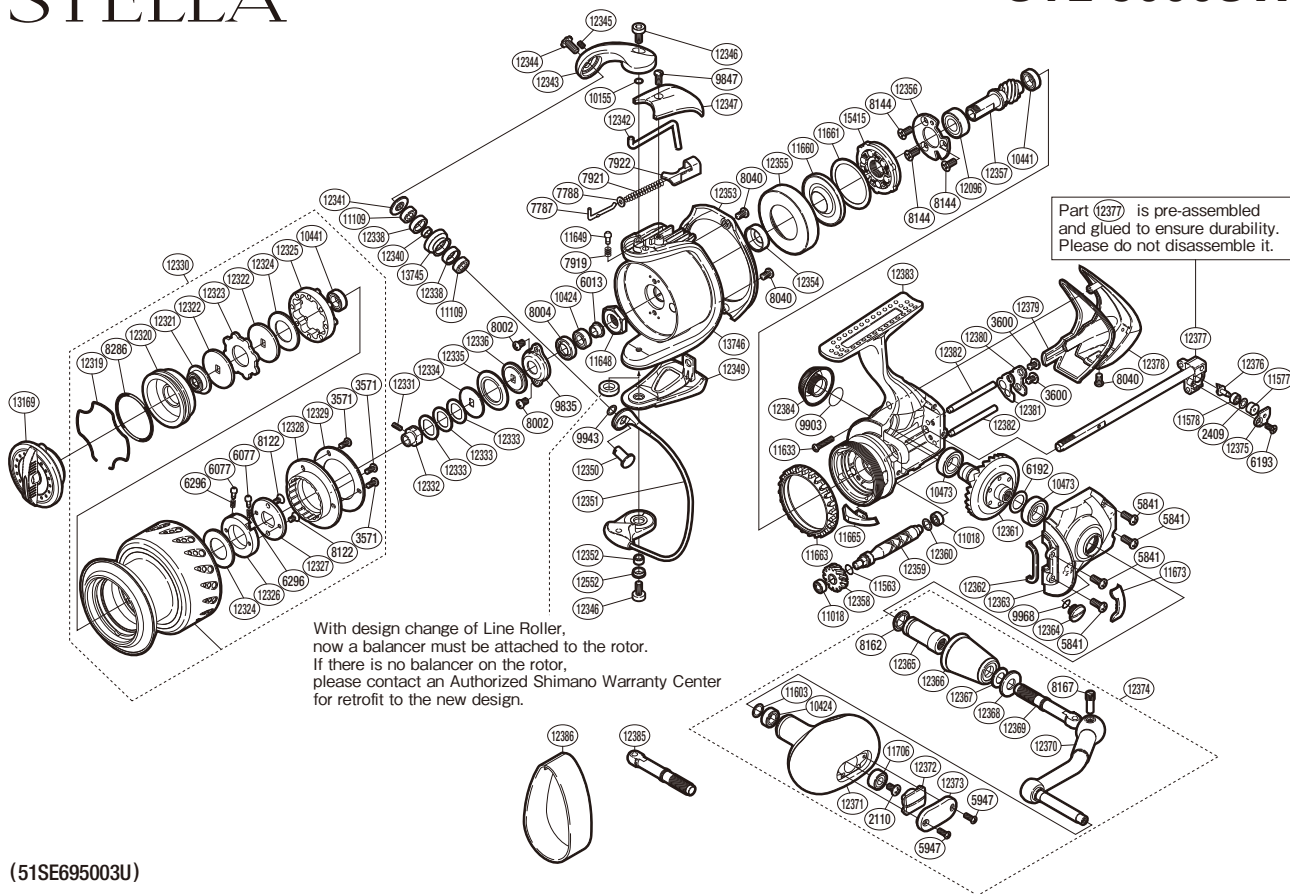

(51SE695003U)

#	Part No.	Description	#	Part No.	Description	#	Part No.	Description
2110	103E9	Screw	11648	1080F	Rotor Nut	12353	1073X	Rotor Guard
2409	1059U	Spacer	11649	106ZD	Click Pin	12354	10K7G	Rotor Ring
3571	10MPP	Screw	11660	10MDG	Roller Clutch Water Proof	12355	10HFV	Roller Clutch Cover
3600	103L4	Screw	11661	10G6J	Roller Clutch Outer Spacer	12356	1051S	Bearing Retainer
5841	1080B	Screw	11663	104FW	Friction Ring	12357	1059A	Pinion Gear
5947	103NH	Screw	11665	107DX	Bail Trip Strike	12358	10GU1	Idle Gear
6013	1072N	Main Shaft Spacer	11673	10J3J	Friction Ring Spacer	12359	102JM	Worm Shaft
6077	1035W	Click Pin	11706	10KX1	Ball Bearing	12360	10J7K	Washer
6192	10HHT	Washer	12096	104Q6	Bail Bearing	12361	109YK	Drive Gear
6193	10MGG	Screw	12319	10B88	Drag Washers Retainer	12362	10CB4	Flange Water Proof
6296	10JMD	Click Spring	12320	10LWR	Thrust Bushing	12363	10JKK	Side Cover
7787	105RG	Bail Spring Guide A	12321	10NFC	Bearing Support	12364	109PM	Oil Cap
7788	1064R	Spring Guide A Support	12322	10B9Z	Key Washer	12365	10C7J	Handle Shaft Cover B
7919	1077Q	Click Spring	12323	10BE8	Eared Washer	12366	10B2F	Handle Shaft Cover
7921	105FX	Bail Spring	12324	1031R	Drag Washer	12367	10ARY	Handle Lock Spacer
7922	1077C	Bail Spring Seat	12325	10AHH	Spool Bushing	12368	10FME	Large Handle Shank Washer
8002	10LZ2	Screw	12326	10JJU	Drag Click Holder	12369	10K7C	Handle Shaft (Left)
8004	107F3	Bearing Water Proof	12327	109HE	Drag Click Holder Cover	12370	107UT	Handle Shank Assembly
8040	10MHG	Screw	12328	10C1J	Drag Cover	12371	1040L	Handle Knob
8122	10MGD	Screw	12329	109ZK	Drag Cover I.D. Plate	12372	10B97	Handle Knob Seal
8144	10ML2	Screw	12330	10J3Z	Spool Assembly	12373	108SR	Handle Knob I.D. Plate
8162	10PV4	Handle Shaft Seal	12331	10PRL	Set Screw	12374	10H2L	Handle Assembly
8167	10PV2	Handle Shaft Screw	12332	10LTL	Bearing Bushing	12375	10H7Q	Oscillating Pawl Cover
8286	108WC	O Ring	12333	10BUL	Spool Washer	12376	106V4	Oscillating Pawl
9835	1076M	Rotor Nut Lock Plate	12334	10HZW	Spool Support B	12377	108EU	Main Shaft Assembly
9847	10CYU	Screw	12335	10JPF	Bearing Water Proof	12378	10GGA	Rear Protector
9903	108WA	O Ring	12336	103P0	Spool Support	12379	107CA	Rear Shield
9943	10HYH	Washer	12338	107RA	Line Roller Bushing	12380	10BEQ	Worm Shaft Retainer
9968	108W9	O Ring	12340	10GAF	Bearing Spacer	12381	10H1N	Worm Shaft Retainer Washer
10155	10HWN	Spacer	12341	10777	Line Roller Plate	12382	1030S	Oscillating Guide
10424	105BN	Ball Bearing	12342	108GK	Bail Trip Lever	12383	10ADT	Body
10441	104JS	Ball Bearing	12343	106HK	Bail Arm	12384	10P5Q	Handle Screw Cap
10473	104PS	Ball Bearing	12344	10K46	Screw	12552	10K54	Bail Trip Cam Bushing
11018	10PDA	Ball Bearing	12345	10PN1	Set Screw	13169	10963	Drag Knob
11109	104VP	Ball Bearing	12346	10Q85	Screw	13745	10KUE	Line Roller
11563	10CJV	Worm Shaft Ring	12347	108R3	Bail Spring Cover	13746	10A1K	Rotor
11577	10JV1	Oscillating Slider Bushing	12349	10M9S	Bail Hold Support Guard	15415	10QPS	Roller Clutch Assembly
11578	10PC0	Ball Bearing	12350	10PZ3	Line Roller Support			
11603	10HV3	Washer	12351	10PP7	Bail Assembly	12385	10FEW	Handle Shaft (Right) (Accessory)
11633	10LSC	Screw	12352	107LB	Screw Collar	12386	109UP	Line Band (Accessory)

Please note that the number of adjusting washers may not be the same as shown in the exploded views. (Adjustment will vary with each individual product.)

(241224)_003