

NOTES: UNLESS OTHERWISE SPECIFIED

1. MATERIAL SPECIFICATIONS:

BODY AND COUPLING NUT: STAINLESS STEEL PER ASTM A582
 INSULATOR: PTFE PER ASTM D1710
 GASKET: SILICONE RUBBER PER A-A-59588
 RETAINING RING: BERYLLIUM COPPER PER ASTM B196
 CENTER CONTACT BRASS PER ASTM B16
 FERRULE: COPPER ALLOY
 SHRINK TUBING: POLYOLEFIN

2. FINISH SPECIFICATIONS:

BODY: .00015 MIN. GOLD PER ASTM B488 OVER
 .00050 MIN. NICKEL PER AMS-QQ-N-290
 CONTACT: .00030 MIN. GOLD PER ASTM B488 OVER
 .00050 MIN. NICKEL PER AMS-QQ-N-290
 FERRULE AND COUPLING NUT: .00005 MIN. GOLD PER ASTM B488
 .00050 MIN NICKEL PER AMS-QQ-N-290

3. ELECTRICAL SPECIFICATIONS:

IMPEDANCE: 50 OHMS
 FREQUENCY RANGE: 0 TO 18.0 GHz
 VSWR: 1.15 +.02F(GHz)

4. FOR USE WITH RD-316 (DOUBLE BRAID) CABLE OR EQUIVALENT.

5. FOR CABLING PROCEDURE, USE CAP 5-04 WITH TRIMMING DIMENSIONS SHOWN.

6. CONNECTOR DESIGNED TO OPERATE WITH CABLE HAVING DIMENSIONS INDICATED IN DETAIL A.

7. CENTER CONTACT SHIPPED LOOSE.

8. CRIMP FERRULE USING .151 HEX DIE.

REV	DESCRIPTION	BY DATE	APPD
B	ER065548	JL 11/07/16	DCAM

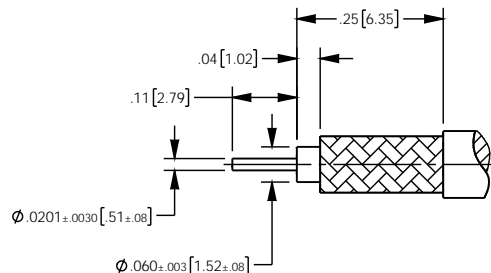
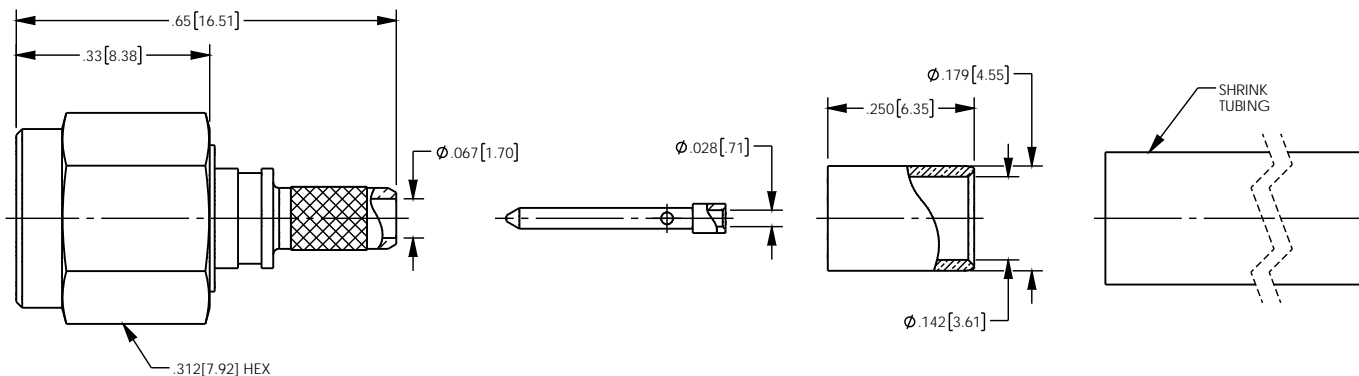

CATALOG P/N: 250-900-0631G

PER ASME Y14.5M-1994 UNLESS OTHERWISE SPECIFIED, DIMENSIONS ARE IN INCHES (MM) TOLERANCES: DECIMAL: .XX [XX] ± .01 [0.3] XXX [XXX] ± .005 [0.13] XXXX [XXXX] ± .XXXX		 WINCHESTER Winchester Electronics Corporation ELECTRONICS 199 Park Road Ext Suite 104 Middlebury, Connecticut 06762	
ANGLES: ± 2°		SCALE: 4:1	THIRD ANGLE
CUSTOMER SALES DRAWING		SMA STRAIGHT PLUG	
DRAWN JL	DATE 11/08/2016	APPROVED JL	DATE 11/10/2016
APPROVED DCAM	DATE 11/09/16	APPROVED XXX	DATE XX/XX/XX
A		SD250-900-0631G	SHT OF REV 1 1 B