

White Wyndham 2-Door 4-Drawer Vanity with Granite 4" Centerset Black Pearl Rectangle Bowl Vanity Top, Unassembled, 49x22

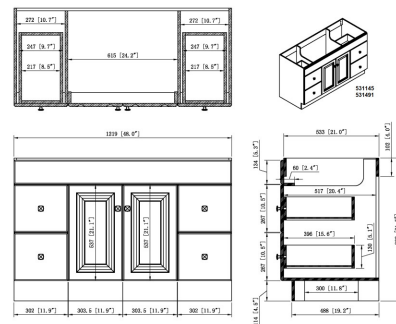
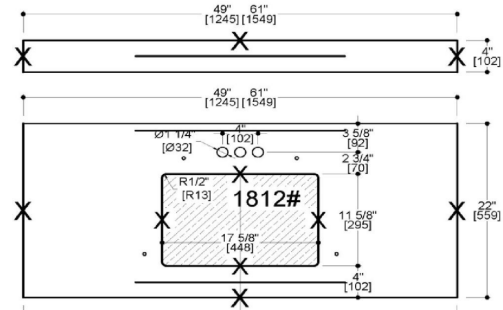

## SPECIFICATIONS

MATERIAL CONSTRUCTION:	Wood/Granite
ASSEMBLY REQUIRED:	Yes
ASSEMBLED DIMENSIONS:	35.5" H x 49" L x 22" D
ASSEMBLED WEIGHT:	237 lbs.
TOOLS NEEDED FOR INSTALLATION:	Screwdriver
CONSTRUCTION TYPE:	Frameless
HINGE STYLE:	Concealed
DOOR STYLE:	2 MDF Slab Doors
DRAWER STYLE:	4 MDF Drawers
GLIDE STYLE:	STD Easy Glide
FAKE DWR STYLE:	MDF
DWR #1 DIMENSIONS:	5.12" H x 15.59" W
DWR CONSTRUCTION:	N/A
SHELF STYLE:	N/A
SHELF ADJUSTABILITY INCREMENTS:	N/A
SHELF MAX WEIGHT CAPACITY:	N/A
SHELF DIMENSIONS:	N/A
SHELF THICKNESS:	N/A
SHELF MATERIAL:	N/A
FRAME STYLE:	N/A
FACE FRAME MATERIAL:	MDF
SIDES MATERIAL:	Particle Board
BOTTOM MATERIAL:	Particle Board

TOE KICK INSET WIDTH:	4.5"
BACK PANEL MATERIAL:	N/A
BACK BRACE MATERIAL:	Particle Board
FAUCET TYPE:	Lav Centerset
NUMBER OF MOUNTING HOLES:	3
BOWL MATERIAL:	Ceramic
BACK SPLASH INCLUDED:	Yes
COLOR:	Black Pearl
NUMBER OF BOWLS:	1
BOWL DIMENSIONS:	7.4" H x 11.63" W x 17.63" D
BOWL SHAPE:	Rectangle
SINK THICKNESS:	N/A
MOUNTING TYPE:	Undermount
OVERFLOW HOLE:	Yes
WARRANTY:	1-Year limited warranty
CARB COMPLIANT:	CARB Phase 2
LEGAL FOR SALE IN CALIFORNIA:	Yes
TSCA TITLE IV COMPLIANT:	Yes



TYPE:  
JOB:  
ORDER CODE:  
APPROVALS: