

# SCHOOLHOUSE



## York Door Set with Globe Knob + Deadbolt

Made-to-order and custom assembled to your specifications, the York Product Origin:

- Assembled in the USA from parts made in China
- Made by Emtek
- Ships direct from the manufacturer

### Requires:

- Standard door preparation and installation
- Single 2-1/8" bore hole and 1" edge bore

### Complete Set Includes:

- Solid brass cylinder, housing, collar, thumbturn and backplate
- Hardened steel bolt
- Heavy gauge steel understrike and brass trim strike
- Extension collar for thin doors (1-3/8" - 1-3/4")
- 2-1/4" deadbolt mounting screws
- Schlage C Keyway and 2 keys

### Warranty:

- Emtek Lifetime Limited Warranty

Made to order and non-returnable

<b>Backset</b>	2-3/8" or 2-3/4"
<b>Compatible Door Thickness</b>	1-3/8" - 2-1/8"
<b>Door Prep</b>	Standard
<b>Backplate Dimensions</b>	2.375" Dia.
<b>Backplate Thickness</b>	0.375"
<b>Exterior Projection</b>	0.5"
<b>Interior Projection</b>	1"

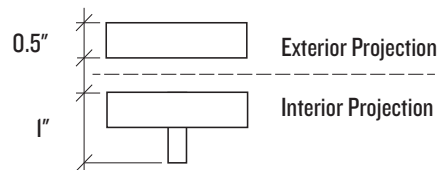
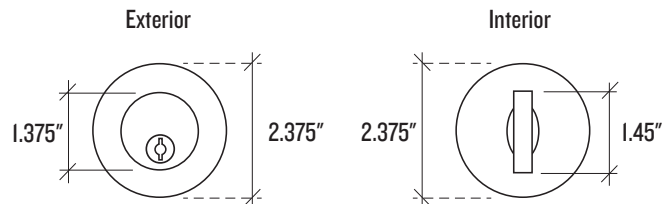

### Finish Options



# SCHOOLHOUSE



## York Door Set with Globe Knob + Deadbolt—Passage

Passage sets are non-locking and are primarily used on interior doors or on exterior doors paired with a coordinating deadbolt.

### Product Origin:

- Assembled in the USA from parts made in China
- Made by Emtek
- Ships direct from the manufacturer

### Requires:

- Standard door preparation and installation
- Single 2-1/8" bore hole and 1" edge bore

### Complete Set Includes:

- Latch plate
- Full-lip strike plate
- Inside passage half spindle
- Concealed fastener installation kit

### Warranty:

- Emtek Lifetime Limited Warranty

Made to order and non-returnable

<b>Backset</b>	2-3/8" or 2-3/4"
<b>Compatible Door Thickness</b>	1-3/8"–1-3/4"
<b>Door Prep</b>	Standard
<b>Backplate Dimensions</b>	2.5" Dia.
<b>Backplate Thickness</b>	0.375"
<b>Knob Dimensions</b>	2"
<b>Projection</b>	3.125"

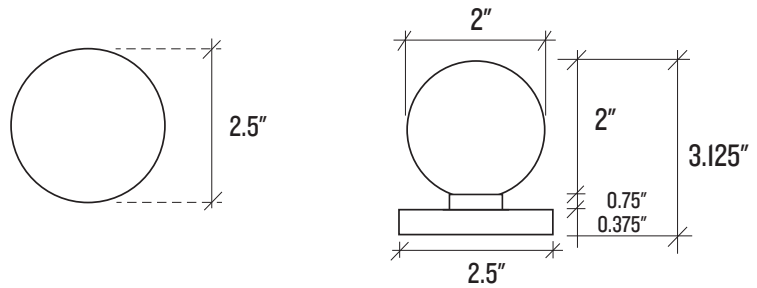

### Finish Options

