

INSTRUCTION MANUAL

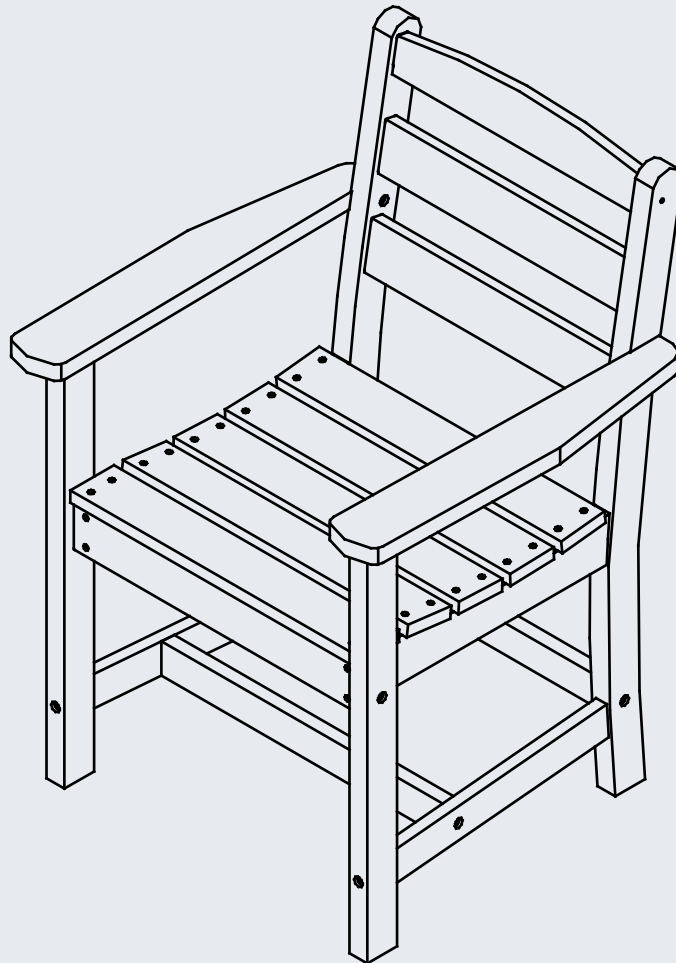

Patio Dining Arm Chair

V1.0

! CARE & MAINTENANCE

Please keep this instruction for your future reference.

- Be careful when assembly, avoid hurting the top surface.
- Clean the table with lukewarm water, mild detergent & soft cloth.
- Firmly secure all bolts before use, do not use any part of this item as a step ladder.
- Reconfirm that all bolts, screws, and nuts are secure every 90 days.
- Do not use or store this item in the proximity of open flame or flammable/combustible chemicals.
- Be aware that some parts are heavy and have sharp edges.
- Do not overtighten screws. (Insert all screws before tighten screws.)
- Please do not exceed the weight limitations of this item.

TOOLS REQUIRED



CHAIR
330 LBS
CAPACITY



1 PERSON
ASSEMBLY



UP TO 20 MIN.
ASSEMBLY

HARDWARE

1

M4.2 x 60mm
SCREW

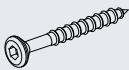

4 PCS

2

M6.3 x 45mm
SCREW



2 PCS

3

M6.3 x 60mm
SCREW

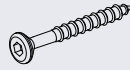

6 PCS

4

M6.3 x 80mm
SCREW

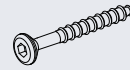

8 PCS

5

ALLEN
WRENCH

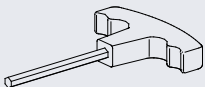

1 PC

6

SCREWDRIVER

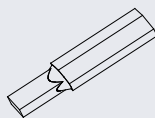

1 PC

7

ALLEN
WRENCH

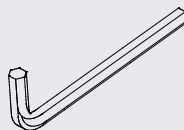

1 PC

PARTS

A

RIGHT ARM REST

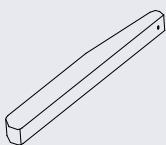

1 PC

B

LEFT ARM REST

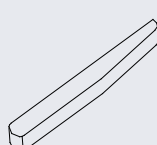

1 PC

C

SEAT BOARD

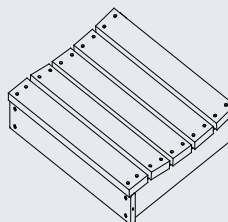

1 PC

D

CHAIR BACK

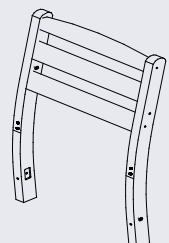

1 PC

PARTS

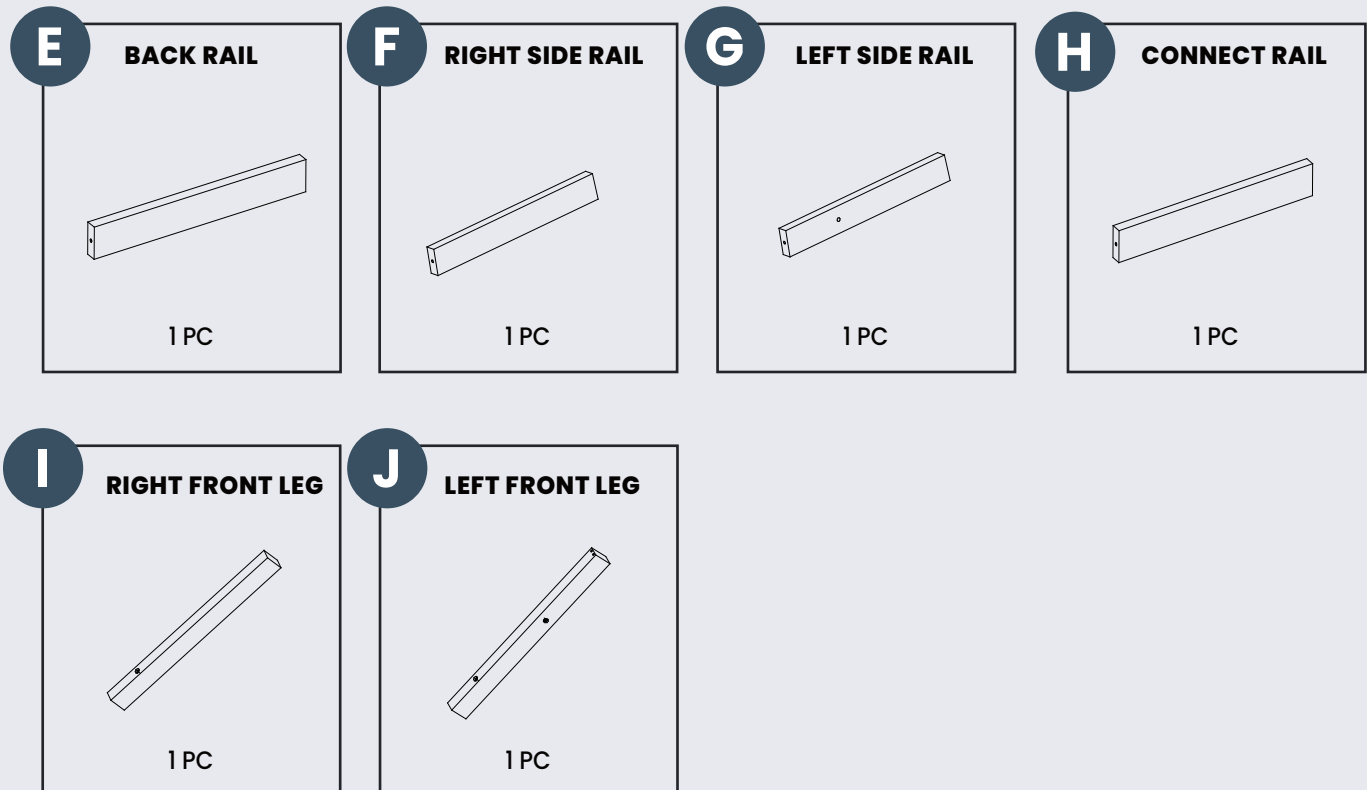

PRODUCT ASSEMBLY - OVERALL VIEW

Look at following overall view of this chair and learn the exact position of each parts to be assembled.

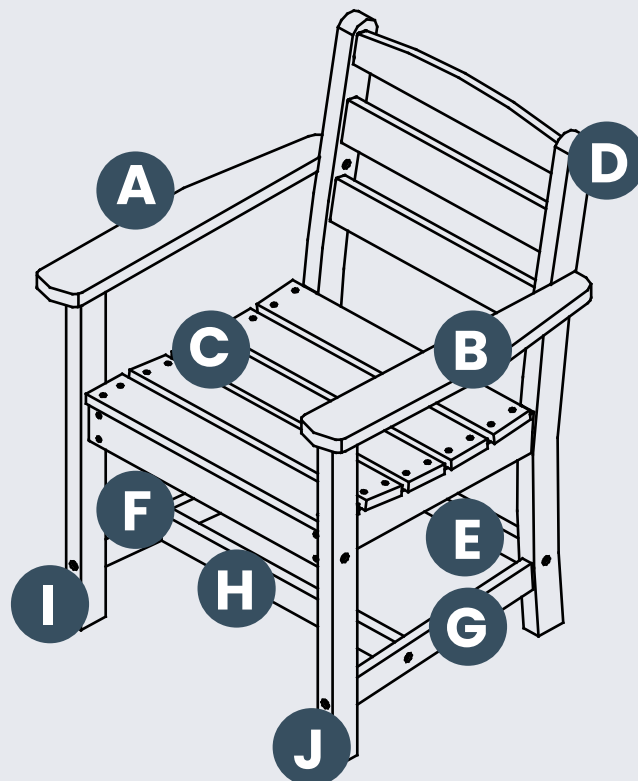

PRODUCT ASSEMBLY

1

Loosely attach **Part E Back Rail** to **Part D Chair Back** with 2 pcs of **Hardware #3 Screw**.

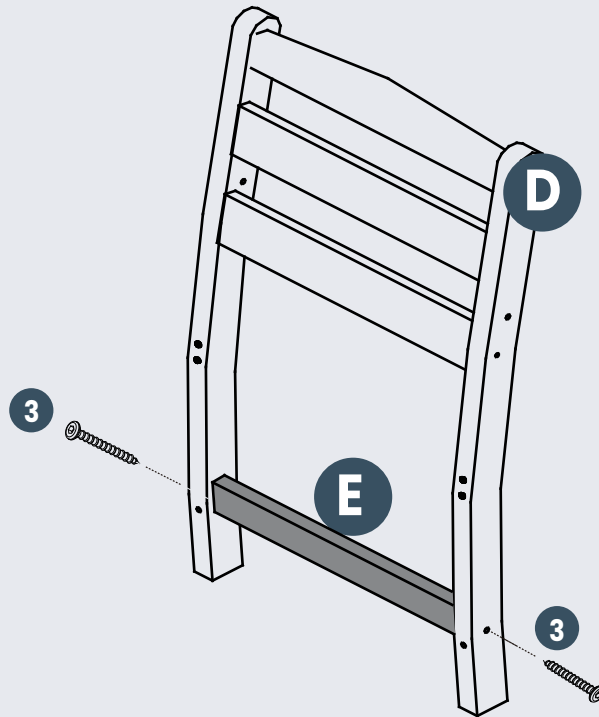

2

Loosely attach **Part C Seat Board** to **Part D Chair Leg** with 4 pcs of **Hardware #4 Screw**.

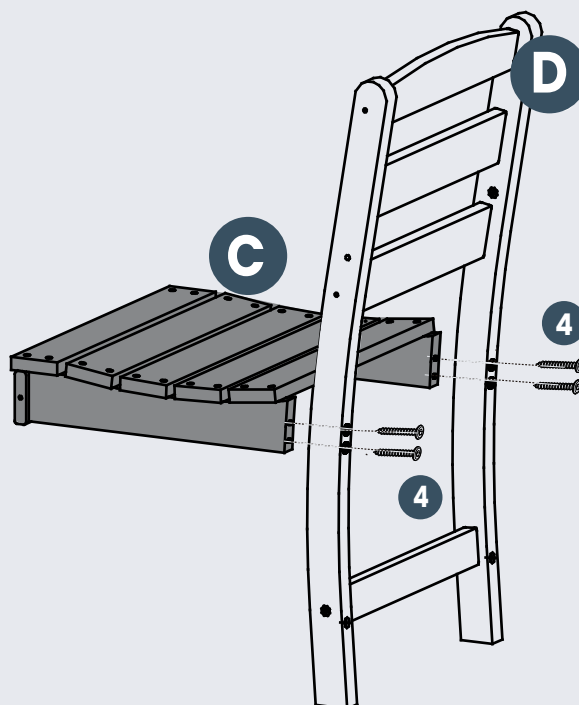

PRODUCT ASSEMBLY

3

Loosely attach both **Part I Right Front Leg** and **Part J Left Front Leg** to **Part C Seat Board** with 2 pcs of **Hardware #3 Screw**.

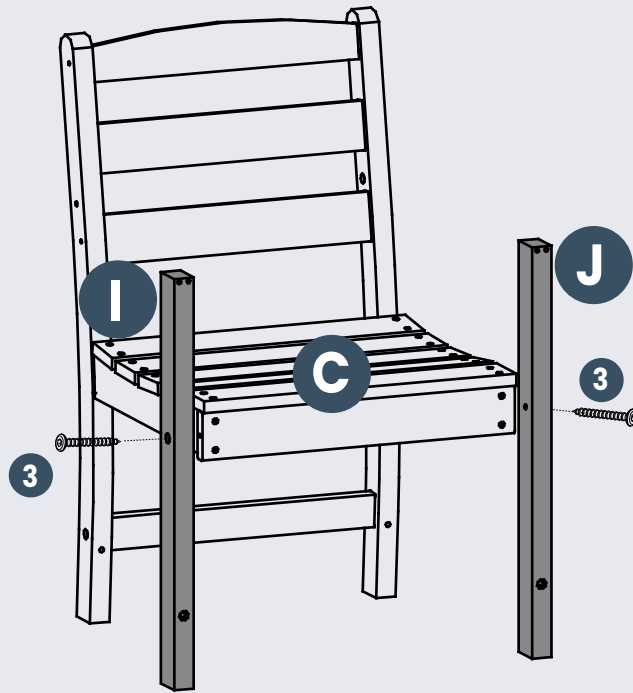

4

Loosely attach both **Part A Right Arm Rest** and **Part B Left Arm Rest** to **Part D Chair Back** with 2pcs of **Hardware #3 Screw**.

Loosely attach both **Part A Right Arm Rest** and **Part B Left Arm Rest** to both **Part I Right Front Leg** and **Part J Left Front Leg** with 4 pc sof **Hardware #1 Screw**.

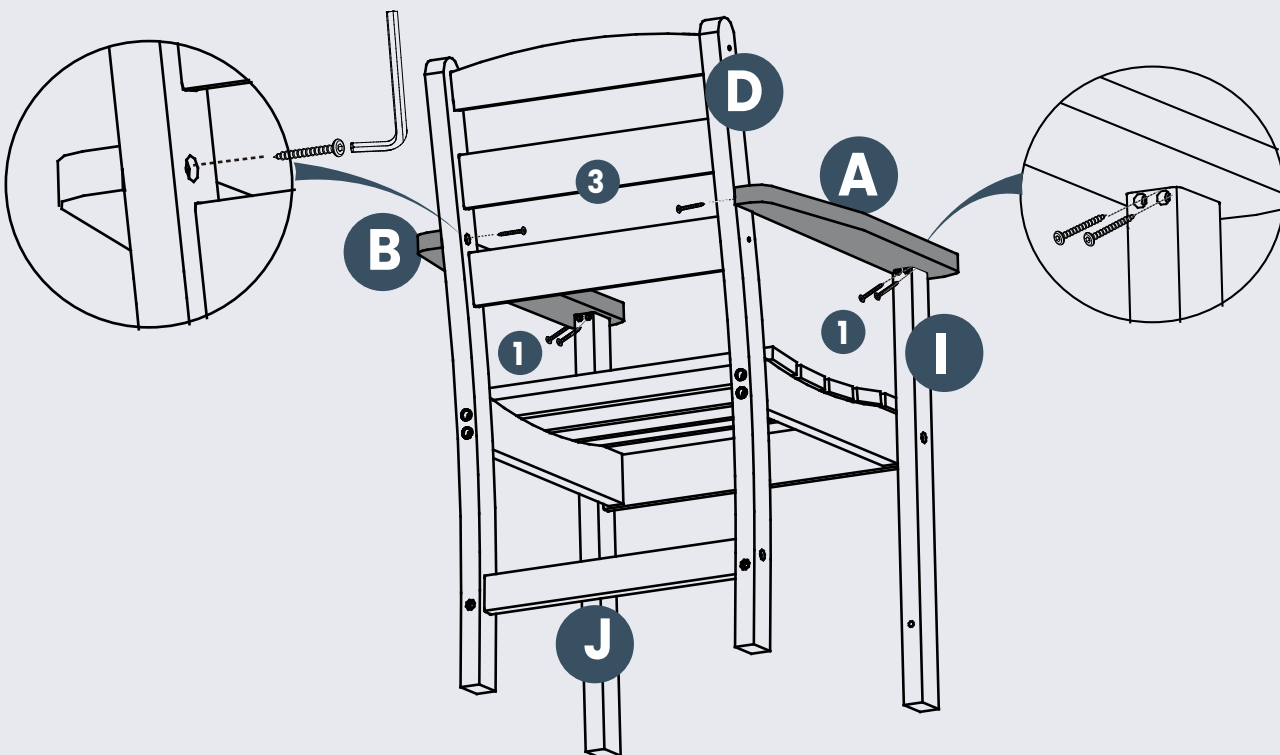

PRODUCT ASSEMBLY

5

Loosely attach **Part F Right Side Rails** between **Part D Chair Back** and **Part I Right Front Leg** with 2 pcs of **Hardware #4 Screw**.

Do the same step for the left side.

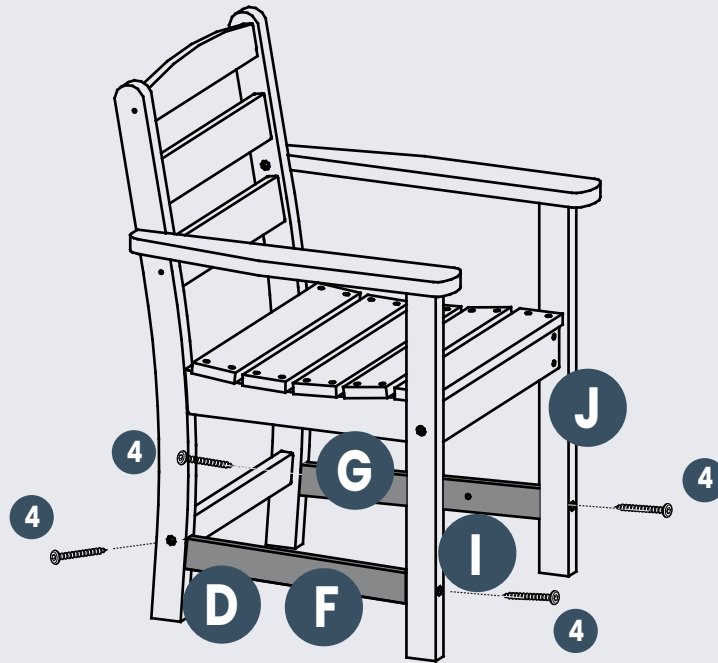

6

Loosely attach **Part H Connect Rail** between **Part F Right Side Rail** and **Part G Left Side Rail** with 2 pcs of **Hardware #2 Screw**.

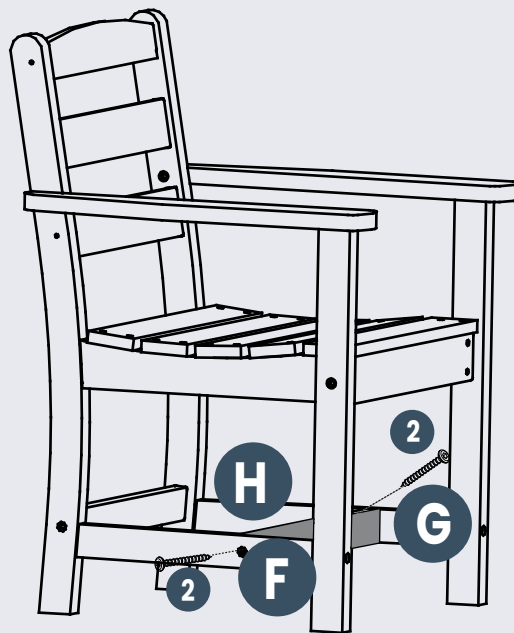

PRODUCT ASSEMBLY

7

Tighten all the screws when all the parts are loosely attached.
Adjust the chair and enjoy it.

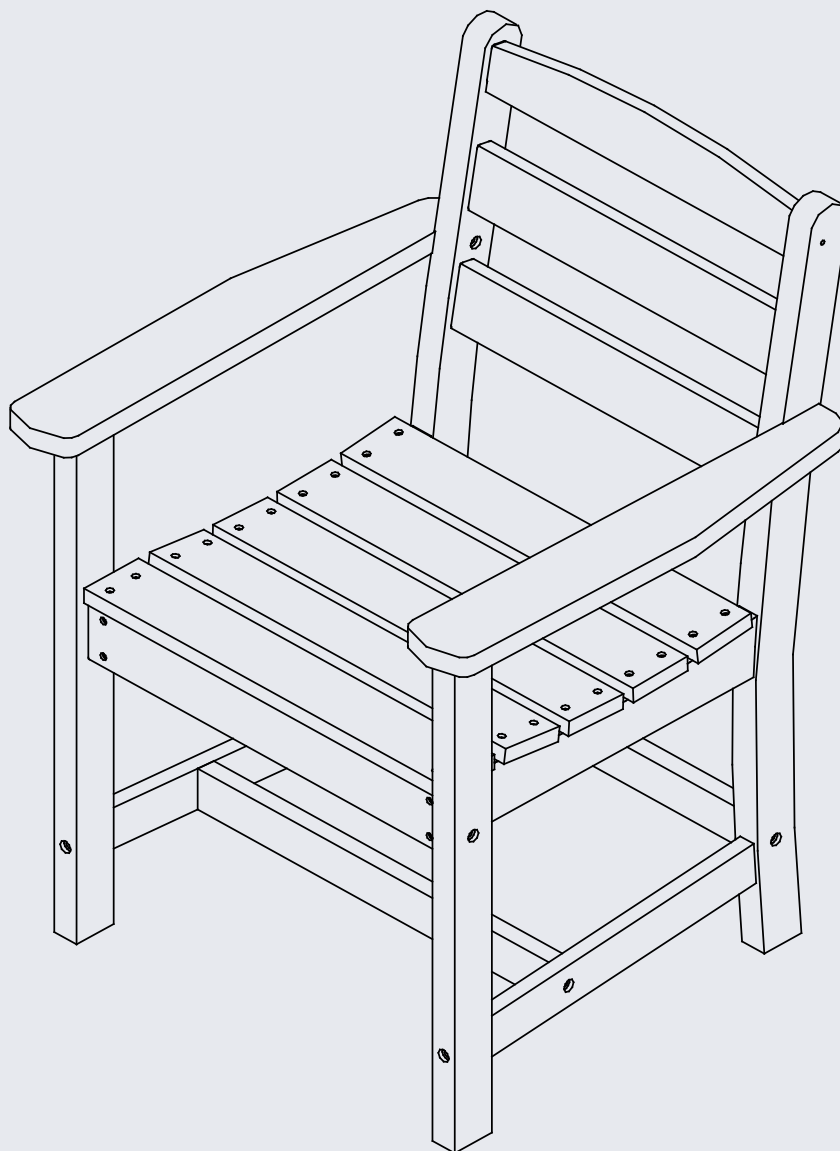

CLEANING TIPS

REGULAR CLEAN: Use a mixture of warm water and mild soap. Gently scrub the surface with a soft bristle brush to remove any dirt or stains.

QUICK CLEAN: You can simply wipe down the furniture with a damp cloth.

Regular cleaning not only preserves the aesthetic appeal of your furniture, but also helps extend its lifespan.