

homestyles®

20 05427 0691

Pantry

IMPORTANT

Carefully remove all the parts from the carton and place them individually on a soft cloth to prevent scratches or other damage.

Carefully and strictly follow these assembly instructions to ensure a completed product as designed.

Do not use power tools above 8 volts to assemble.

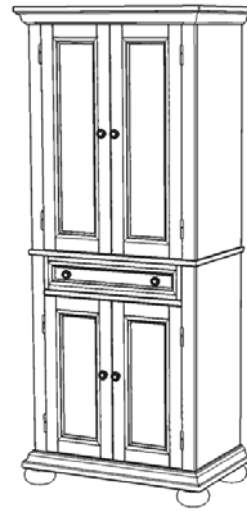

Part List



A.
Top
1 pc.



D.
Middle Panel
1 pc.



S.
Shelf
4 pcs.



E.
Base
1 pc.



T.
Drawer
1 pc.

Refer to 20 05427 0692
instructions for drawer assembly.

For assembly see instructions in carton 20 05427 0692.

Home Styles Customer Service: www.homestyles-furniture.com,
servicedesk@homestyles-furniture.com, 888-680-7460, 877-831-0319