

SIDES	BOTTOM
4 KNOCKOUTS	1/2" KNOCKOUTS
2 1/2" KNOCKOUTS	
2 PCS 8-32×1/2 Screws Installed	
2 PCS 10-32×1 Screws Installed	
Material: Steel-0.0625"-G60 Galvanized	

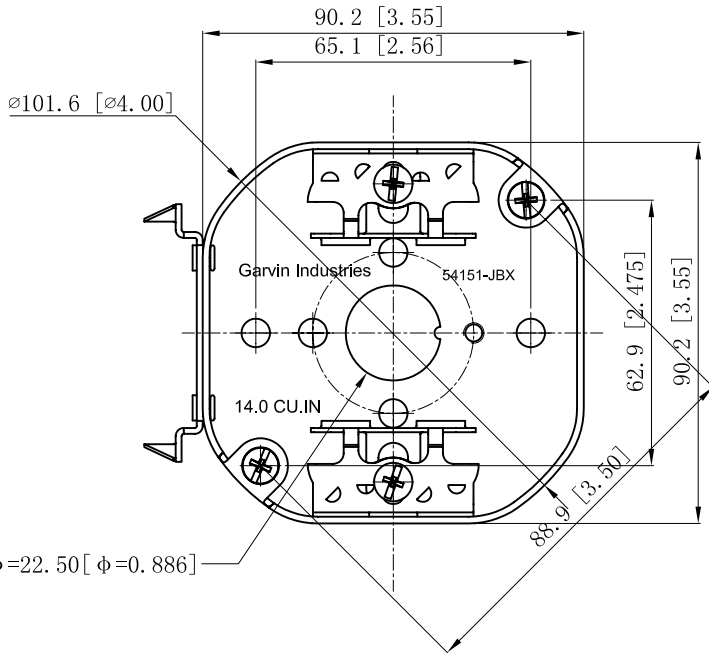
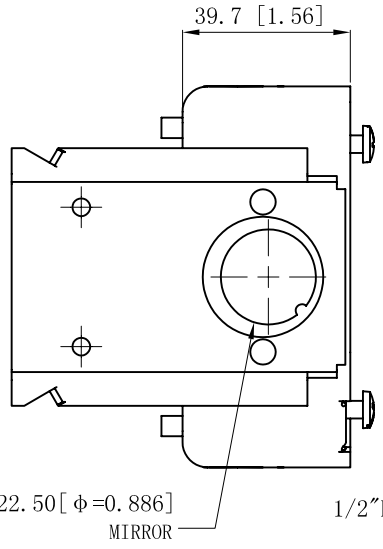
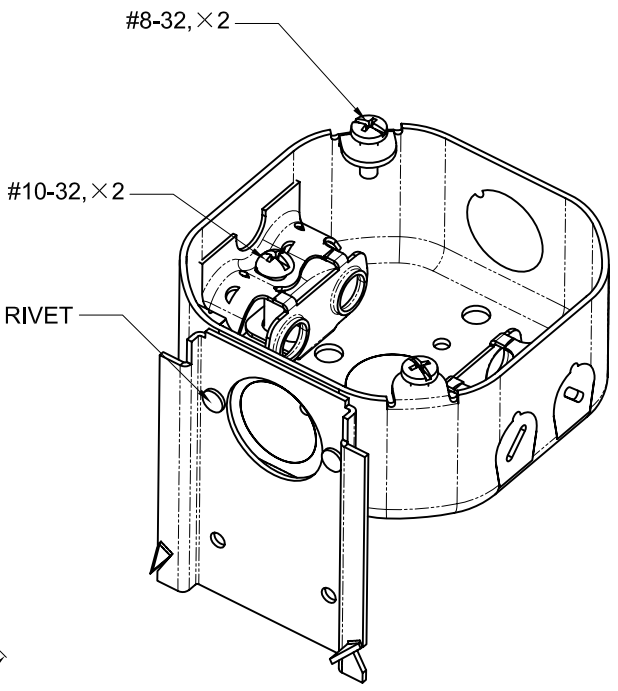
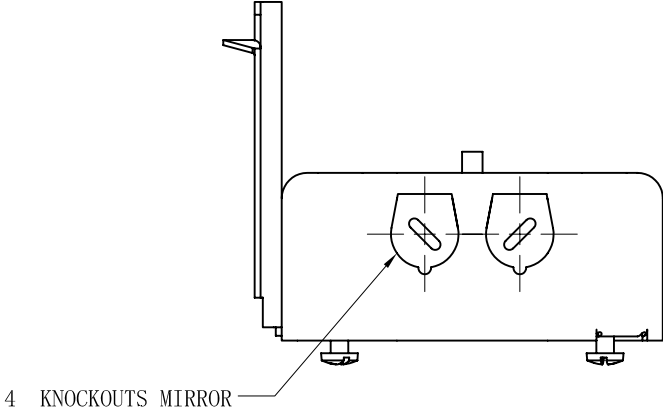

This data sheet is for reference only. GARVIN INDUSTRIES reserves the right to make changes to the design without prior notice.

DESCRIPTION
TRADE REFERENCE TERMS

STANDARD PACKING
25 PCS

GARVIN INDUSTRIES	
4" OCTAGON BOXES 1-1/2" DEEP	
SIZE A4	DWG NO. 54151-JBX
DATA SHEET	
REV B	