

Brookings Bath Vanity Fully Assembled 49x22
Sherwin Williams® Gray Base and Camilla II Top

FULLY
ASSEMBLED
VANITY

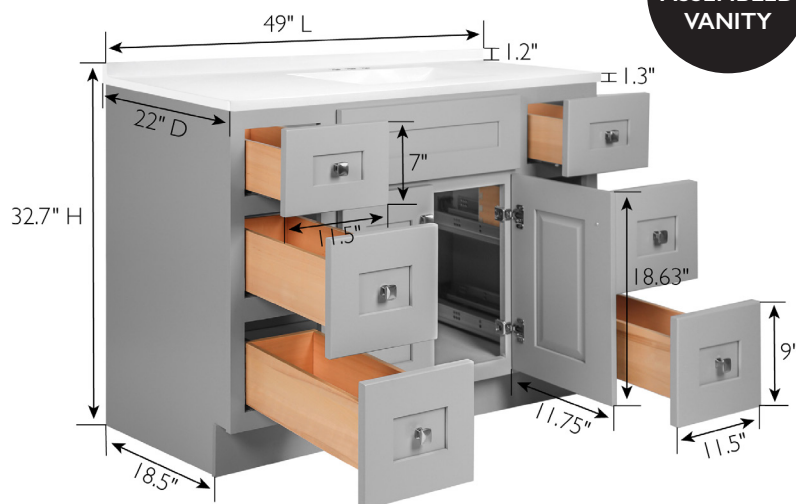

SPECIFICATIONS

MATERIAL CONSTRUCTION:	Wood/Cultured Marble	TOE KICK INSET WIDTH:	4.5"
ASSEMBLY REQUIRED:	No	BACK PANEL MATERIAL:	Plywood
ASSEMBLED DIMENSIONS:	32.7" H x 49" L x 22" D	BACK BRACE MATERIAL:	Solid Wood
ASSEMBLED WEIGHT:	166.42 .lbs	FAUCET TYPE:	Lav Centerset
TOOLS NEEDED FOR INSTALLATION:	Phillips Screwdriver; Rubber Mallet, Wood Glue Face Frame	NUMBER OF MOUNTING HOLES:	3
CONSTRUCTION TYPE:		BOWL MATERIAL:	Ceramic
HINGE STYLE:	Soft Close	BACK SPLASH INCLUDED:	Yes
DOOR STYLE:	2 Shaker Doors	COLOR:	Gray
FACE FRAME MATERIAL:	Solid Wood	NUMBER OF BOWLS:	1
SIDES MATERIAL:	Plywood	BOWL DIMENSIONS:	19.3" W x 12.5" D
BOTTOM MATERIAL:	Plywood	BOWL SHAPE:	Rectangle
		SINK THICKNESS:	1.18"
		MOUNTING TYPE:	Floor Mount
		OVERFLOW HOLE:	Yes
		WARRANTY:	1-Year limited warranty
		TSCA TITLE IV COMPLIANT:	Yes
		LEGAL FOR SALE IN CALIFORNIA:	Yes
		PROP 65 HARMFUL MATERIAL:	Formaldehyde



TYPE:
JOB:
ORDER CODE:
APPROVALS: