

SHIMANO

STELLA

STL-18000SW

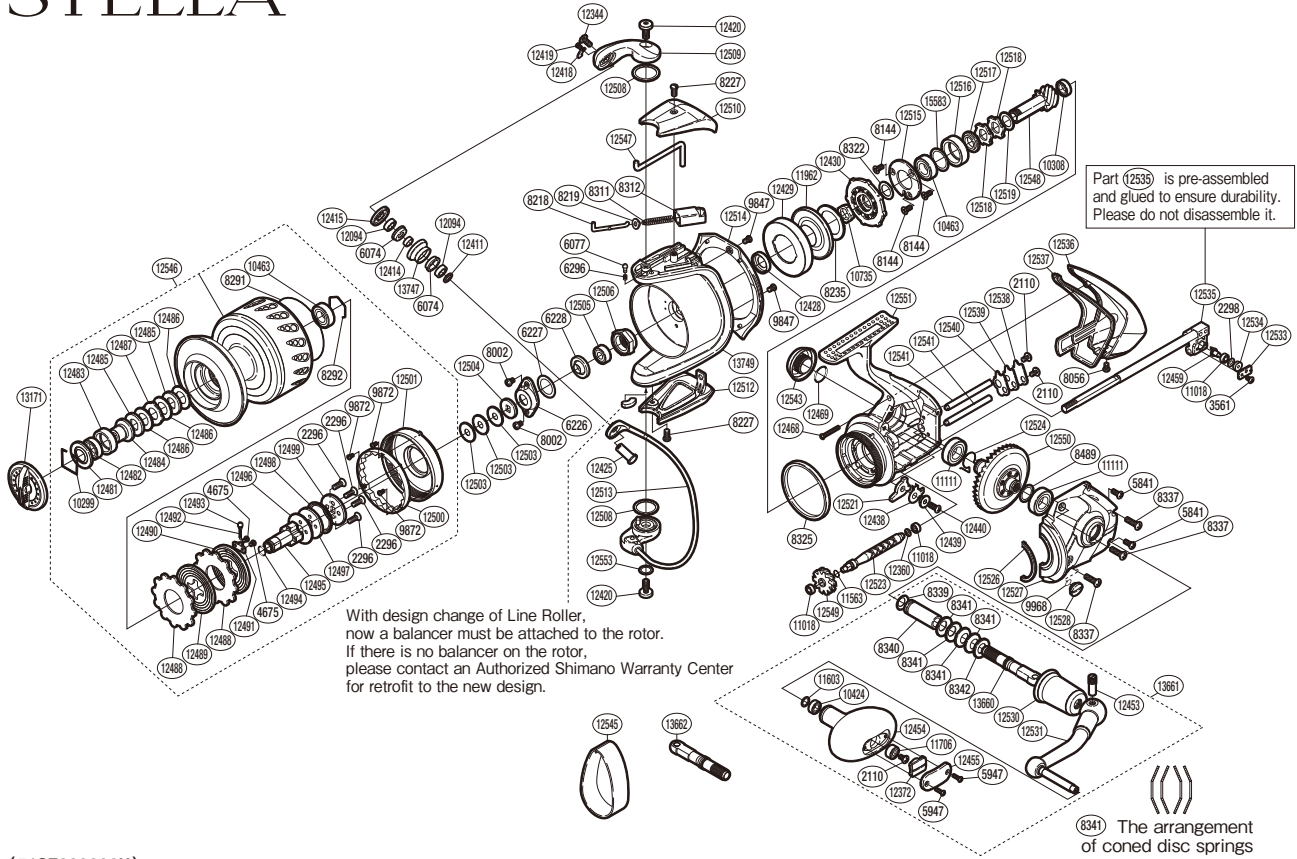

(51SE699803U)

#	Part No.	Description	#	Part No.	Description	#	Part No.	Description
2110	103E9	Screw	12094	104K1	Ball Bearing	12508	10J7H	Washer
2296	10MLB	Screw	12344	10K46	Screw	12509	106HP	Bail Arm
2298	10703	Spacer	12372	10B97	Handle Knob Seal	12510	108UC	Bail Spring Cover
3561	10MT4	Screw	12411	107EY	Line Roller Support Collar	12512	10M9U	Bail Hold Support Guard
4675	10LV7	Screw	12414	10GAG	Bearing Spacer	12513	10PPB	Bail Assembly
5841	1080B	Screw	12415	10778	Line Roller Plate	12514	1073T	Rotor Guard
5947	103NH	Screw	12418	107LE	Screw Retainer	12515	1054W	Bearing Retainer
6074	107RC	Line Roller Bushing	12419	107LF	Screw Support	12516	10JA9	Bearing Housing
6077	1035W	Click Pin	12420	10Q86	Screw	12517	10BAE	Pinion Gear Collar
6226	10K2V	Rotor Nut Lock Plate	12425	10PZ4	Line Roller Support	12518	107VM	Anti-Reverse Ratchet
6227	109PD	Washer	12428	10K7H	Rotor Ring	12519	10HHP	Washer
6228	107F5	Bearing Water Proof	12429	10HFW	Roller Clutch Cover	12521	10J3S	Assist Anti-Reverse Pawl
6296	10JMD	Click Spring	12430	10QRF	Roller Clutch Assembly	12523	102JP	Worm Shaft
8002	10LZ2	Screw	12438	102VH	Anti-Reverse Pawl Cover	12524	10805	Anti-Reverse Pawl Spring
8056	10L63	Screw	12439	10J3U	Anti-Reverse Pawl Collar	12526	10CB6	Flange Water Proof
8144	10ML2	Screw	12440	103HM	Screw	12527	10JKM	Side Cover
8218	105RH	Bail Spring Guide A	12453	10PV0	Handle Shaft Screw	12528	109PN	Oil Cap
8219	10HD9	Spring Guide A Support	12454	102KC	Handle Knob	12530	10C7T	Handle Shaft Cover B
8227	10CYT	Screw	12455	108T0	Handle Knob I.D. Plate	12531	107UX	Handle Shank Assembly
8235	10L5Y	Roller Clutch Reinforce	12459	106V5	Oscillating Pawl	12533	10H7S	Oscillating Pawl Cover
8291	108WD	O Ring	12468	10LSD	Screw	12534	10JV4	Oscillating Slider Bushing
8292	10LWM	Bearing Retainer	12469	108WP	O Ring	12535	108EW	Main Shaft Assembly
8311	105FZ	Bail Spring	12481	10LQZ	Seal Plate	12536	10GGC	Rear Protector
8312	1077E	Bail Spring Seat	12482	10KX7	Ball Bearing	12537	107CC	Rear Shield
8322	10HHM	Washer	12483	10LWS	Thrust Bushing	12538	10BET	Worm Shaft Retainer A
8325	104AZ	Friction Ring	12484	10LWJ	Bearing Support	12539	10AYU	Worm Shaft Retainer B
8337	10MBH	Screw	12485	10BA1	Key Washer	12540	10H1Q	Worm Shaft Retainer Washer
8339	10PV5	Handle Shaft Seal	12486	1031T	Drag Washer	12541	1030U	Oscillating Guide
8340	10AVY	Handle Shaft Cover A	12487	10BEB	Eared Washer	12543	10P5S	Handle Screw Cap
8341	1052E	Coned Disc Spring	12488	10C18	Drag Washer	12546	10J40	Spool Assembly
8342	10HVB	Small Handle Shank Washer	12489	10BS6	Spool Drag Disk	12547	108GN	Bail Trip Lever
8489	105UB	Washer	12490	10BY2	Spool Drag Disk	12548	105E4	Pinion Gear
9847	10CYU	Screw	12491	109ZN	Click Spring Holder	12549	10GU4	Idle Gear
9872	10PRU	Screw	12492	10JMG	Click Spring	12550	109YT	Drive Gear
9968	108W9	O Ring	12493	10382	Click Pin	12551	10AFE	Body
10155	10HWN	Washer	12494	108WQ	O Ring	12553	10G83	Washer
10299	10B6K	Drag Washers Retainer	12495	10LTN	Bearing Bushing	13171	10967	Drag Knob
10308	104PN	Ball Bearing	12496	10P3G	Spool Support C	13660	10JHB	Handle Shaft (Left)
10424	105BN	Ball Bearing	12497	103P2	Spool Support A	13661	108Y4	Handle Assembly
10463	10BGC	Ball Bearing	12498	10JPG	Bearing Water Proof	13747	10KU7	Line Roller
10735	105B6	Stopper	12499	10HZZ	Spool Support B	13749	10A4M	Rotor
11018	10PDA	Ball Bearing	12500	109ZP	Drag Click Ratchet	15583	10GF9	Washer
11111	104PV	Ball Bearing	12501	10C1K	Drag Cover			
11563	10CJV	Worm Shaft Ring	12503	10BXM	Spool Washer			
11603	10HV3	Washer	12504	10J3W	Spool Support D			
11706	10KX1	Ball Bearing	12505	108PD	Ball Bearing	12545	109UQ	Line Band (Accessory)
11962	10MGZ	Roller Clutch Water Proof	12506	1080H	Rotor Nut	13662	10FF0	Handle Shaft (Right) (Accessory)

Please note that the number of adjusting washers may not be the same as shown in the exploded views. (Adjustment will vary with each individual product.)

(241224)_003