

423.5

175.5

178.3

ECOFILTER ASSEMBLY INSTRUCTIONS

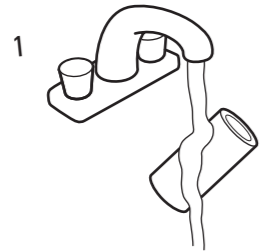

1 REMOVE FILTER from filter bag and rinse in cold tap water for 15 seconds to remove any surface carbon. Set filter aside.

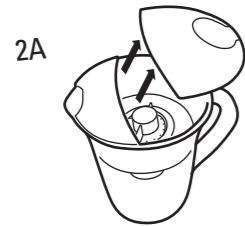

2 REMOVE LID THEN REMOVE CAP inside the reservoir by turning it ¼ turn counterclockwise and pulling it up and out to remove.

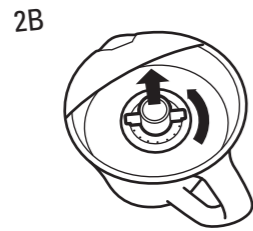

3 THOROUGHLY HAND WASH entire pitcher, cap, reservoir and rear lid with a mild dish soap. Do not wash in the dish washer. Rinse well and hand dry.

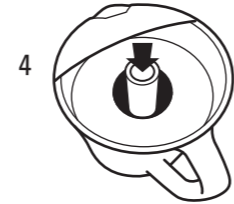

4 INSERT FILTER using the center rod as a guide. Ensure filter is seated properly at the bottom of the reservoir.

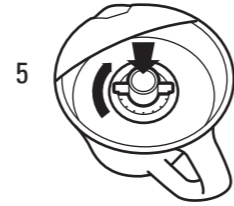

5 REPLACE CAP by aligning it on the center rod and turning it ¼ turn clockwise to lock

Note: the filter is pressure fit (from top to bottom) so you may have to push the cap down a bit prior to engaging the lock.

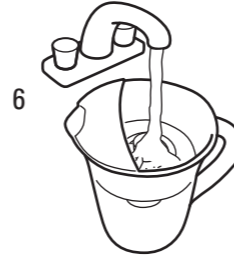

6 FILL RESERVOIR with cold tap water.

7 DISCARD your first two pitchers of filtered water to flush the system.



8 FILL PITCHER and dispense your filtered water as necessary.

Note: Replace filter after 120 gallons of filtration.

CLEANING INSTRUCTIONS

We recommend to thoroughly clean your device prior to first use and in between filter changes. Hand Wash entire pitcher, cap, reservoir and rear lid with a mild dish soap. Do not wash in the dish washer. Rinse well and hand dry.

TROUBLESHOOTING TRY THESE TIPS...

- Review the inside of the filter to ensure there is no damage to the filter itself which may prevent it from sealing 100%.
- To achieve maximum performance and ensure a tight seal, make sure the filter is seated properly inside the reservoir chamber.
- Check to make sure the cap inside the reservoir is aligned properly and the ¼ turn lock is engaged.
- Check for cracks in the reservoir or damage to your filter. Please contact customer service for additional instructions.
- Store device in the refrigerator or out of direct sunlight.

For all other issues, please contact our customer service center at 1-800-503-2939 or email customerservice@zerowater.com

ZERO WATER
7 Neshaminy Interplex, Suite 116
Trevose, PA 19053

2-010ECOINSERT-E-01

R1030.4

361

SmithDesign
8 Budd Street, Morristown, NJ 07960
973 429 2177 | smithdesign.com

02.03.21

20129
ZERO WATER

■ BLACK

EcoFilter Wrap Die Update
M01_ZW_EcoFilter_Wrap_INSIDE.ai

AM: JG ARTIST: BG
AD: MH RT/ILL: ME

COLORS ARE APPROXIMATE ONLY.
Supplied fonts are for the exclusive print production use ONLY. Client MUST purchase all fonts per font licensing agreements.

PRODUCTION NOTES:

LIMITATION OF LIABILITY CLIENT APPROVAL
Please review this for accuracy and contact Smith Design with any amendments and/or your approval by phone or email. Following approval, Smith Design is not liable for any loss or damage due to incorrect information.

unit : mm