

Remove old vents. It may be necessary to “square up” the hole to 8" x 8" maximum.

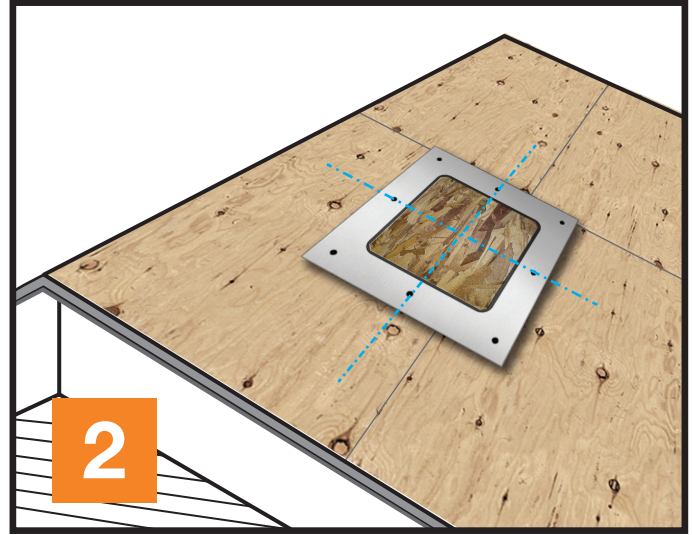

Place a Kwik-Plug™ centered in the vent hole opening.

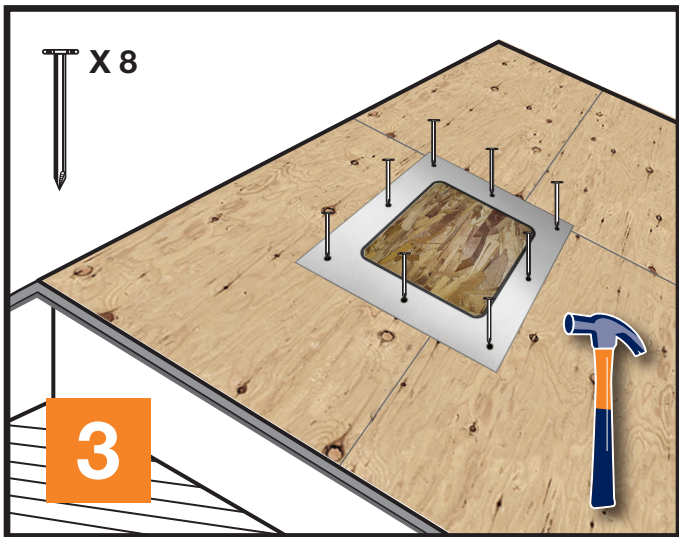

Fasten with eight 1 1/2" long roofing nails using the pre-punched holes provided.



Nails must be installed in all 8 pre-punched locations.



Use Kwik-Plug™ to repair *any* roof deck damage under 8 inches square.
The Repair that Restores Roof Integrity



CAUTION!

Working above grade is inherently dangerous, be sure that proper fall protection measures are in place. When working with power tools and sheet metal, gloves and eye protection are absolutely required.