

FLEXSTEEL®

W1042-831

RECTANGULAR DINING TABLE

IMPORTANT

Carefully remove all parts from the carton, and put them individually on a soft cloth to prevent damage to the parts.

We have taken great care in the design of this product and request that you carefully and accurately follow our assembly instructions to ensure proper set-up.

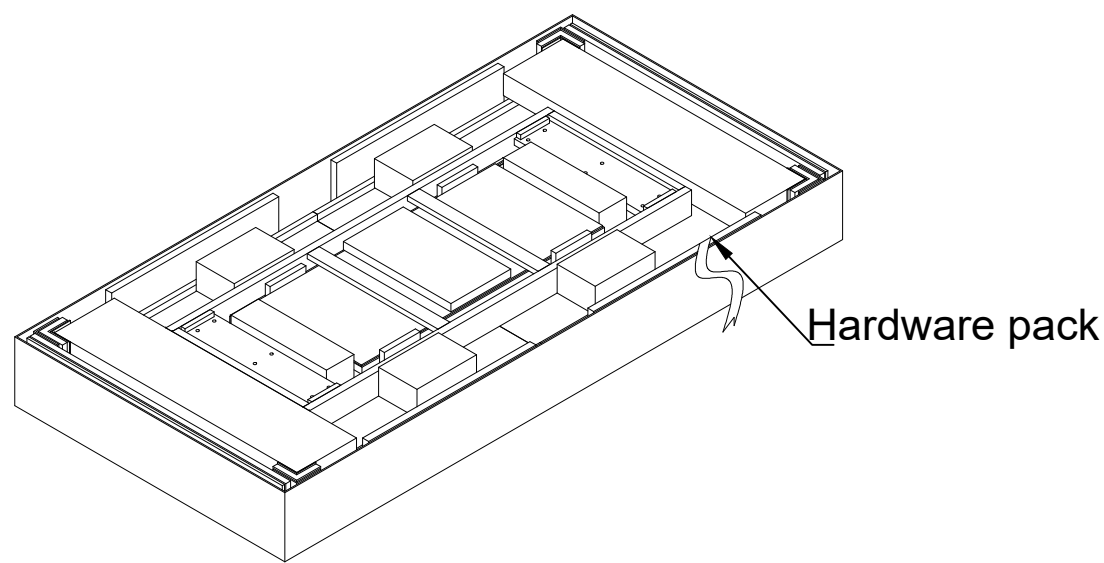
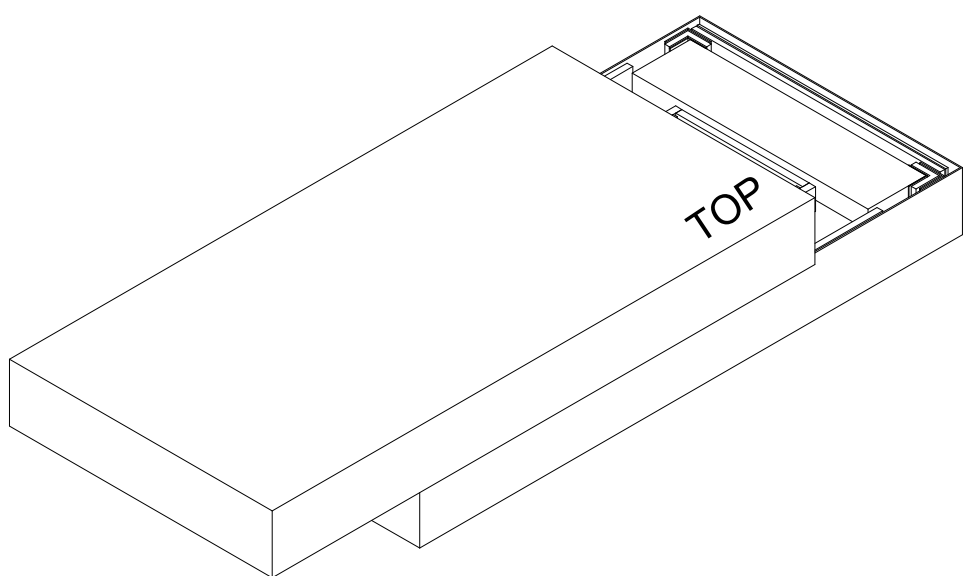
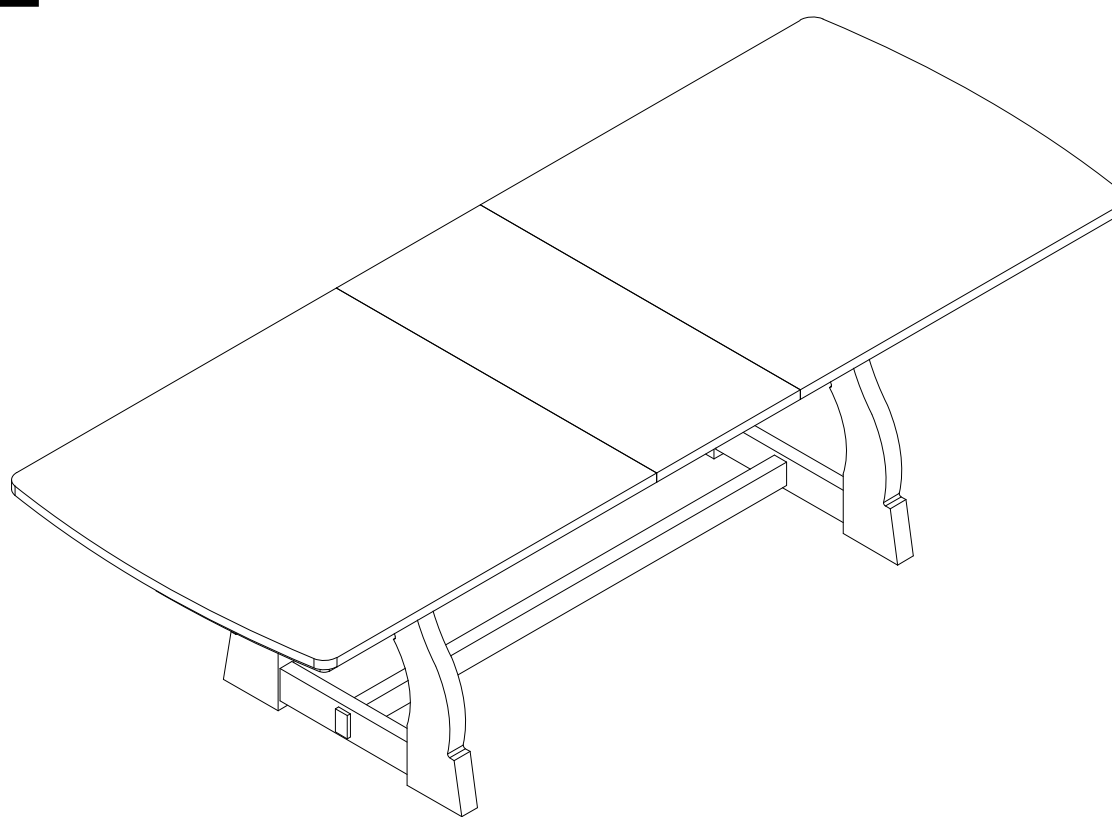

Part List

Assembly Instructions 1/5

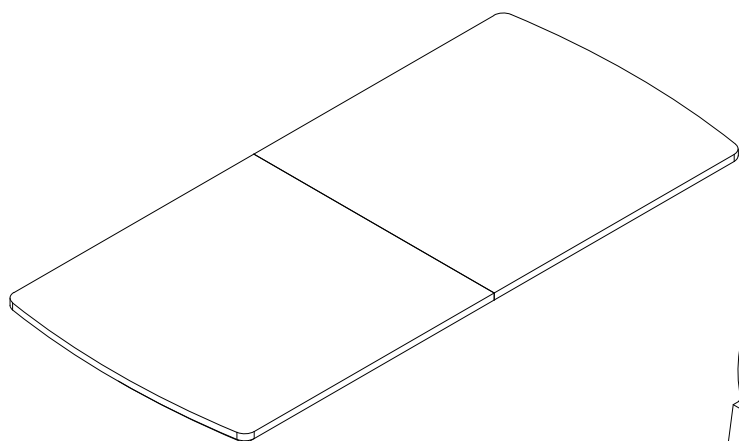

A. Table Top
1 piece

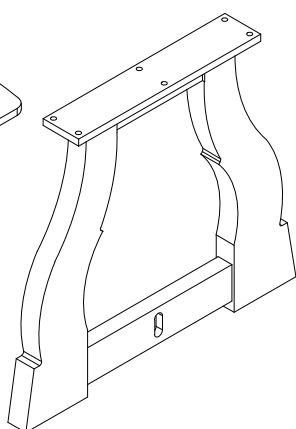

B. Leg
2 pieces

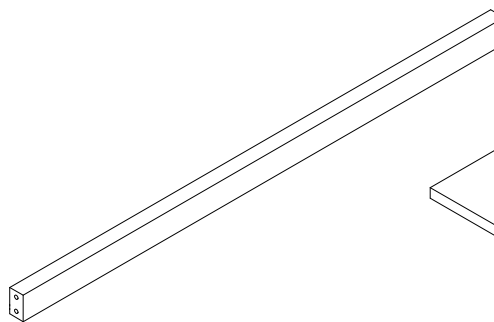

C. Stretcher
1 piece

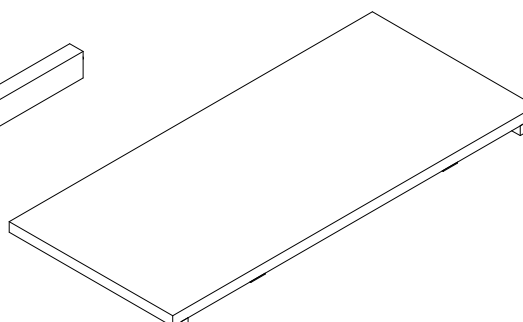

D. Extension Leaf
1 piece

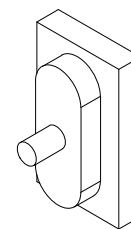

E. Wooden Buttons
2 pieces

Hardware List

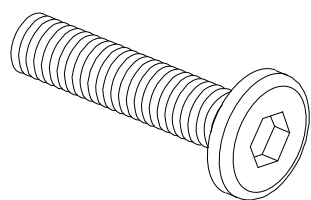

Large Bolt
Ø5/16"-18 UNC x 1-3/4"
4 pieces

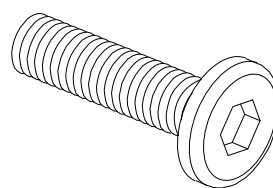

Small Bolt
Ø5/16"-18 UNC x 1-1/2"
12 pieces

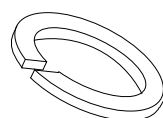

Spring Washer
Ø5/16" x 1.5mm
16 pieces

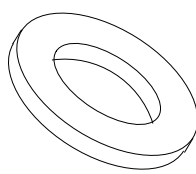

Flat Washer
Ø5/16" x Ø19mm x 1.5mm
16 pieces

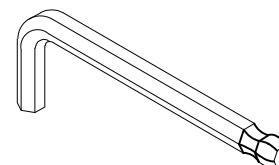

Hex Key
5/32"
1 piece

FLEXSTEEL®

Assembly Instructions 2/5

IMPORTANT NOTES

- Do not tighten up all the bolts until each part is properly assembled.
- Keep the Hex Key in a safe place as you may need to tighten up the bolts in the future.
- Use a soft cloth between these parts and the floor.
- We recommend this product be assembled by at least two adults.

STEP 1

Attach the Stretcher (C) to both Legs (B) using the Large Bolts, Spring Washers, and Flat Washers. Fully tighten the bolts using the Hex Key. (See Figure 1)

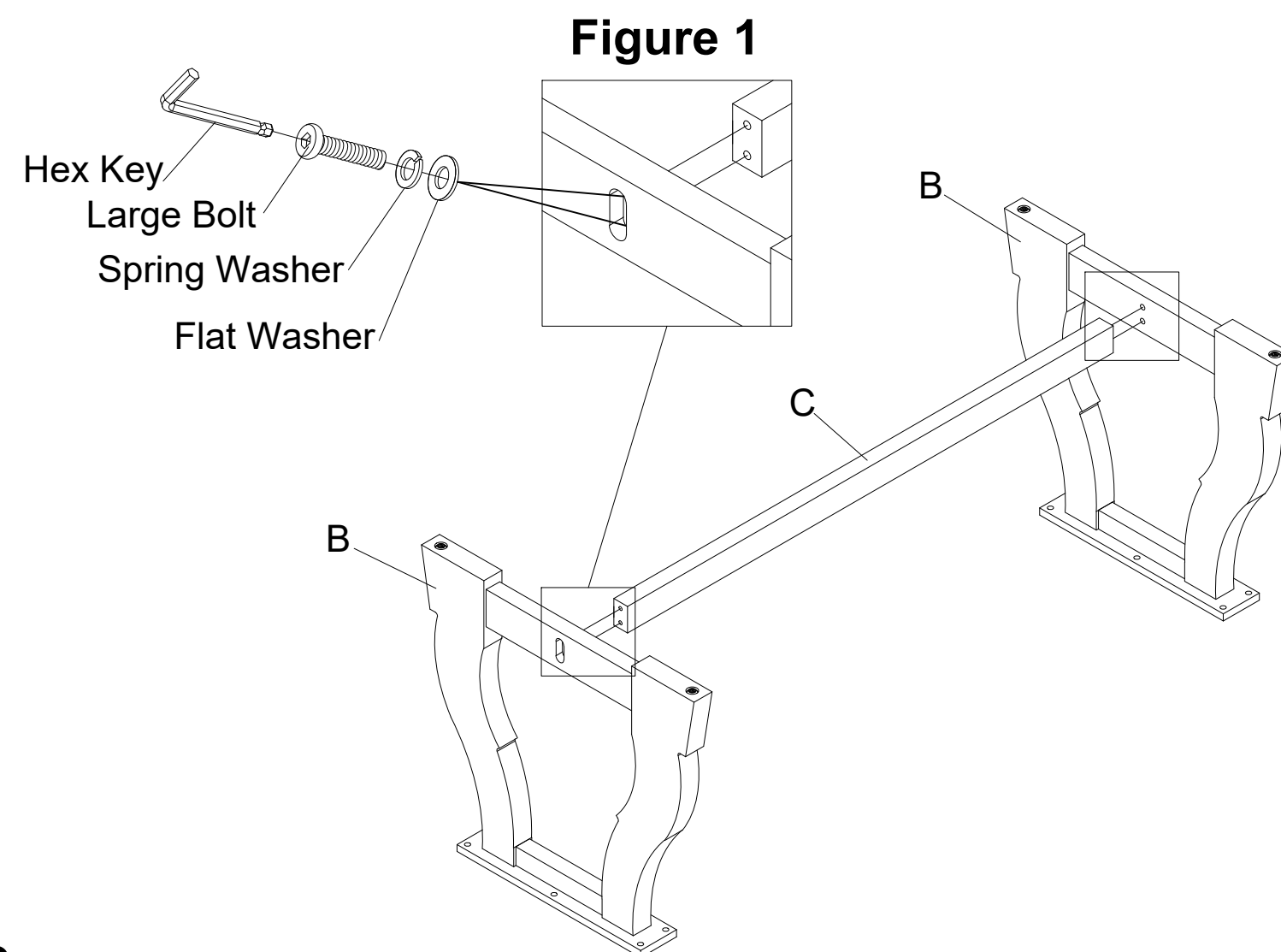

STEP 2

Attach the Legs (B) to the Table Top (A) using the Small Bolts, Spring Washers, and Flat Washers. Fully tighten the bolts using the Hex Key. (See Figure 2)
Press the Wooden Buttons (E) to Legs (B). (See Figure 3)

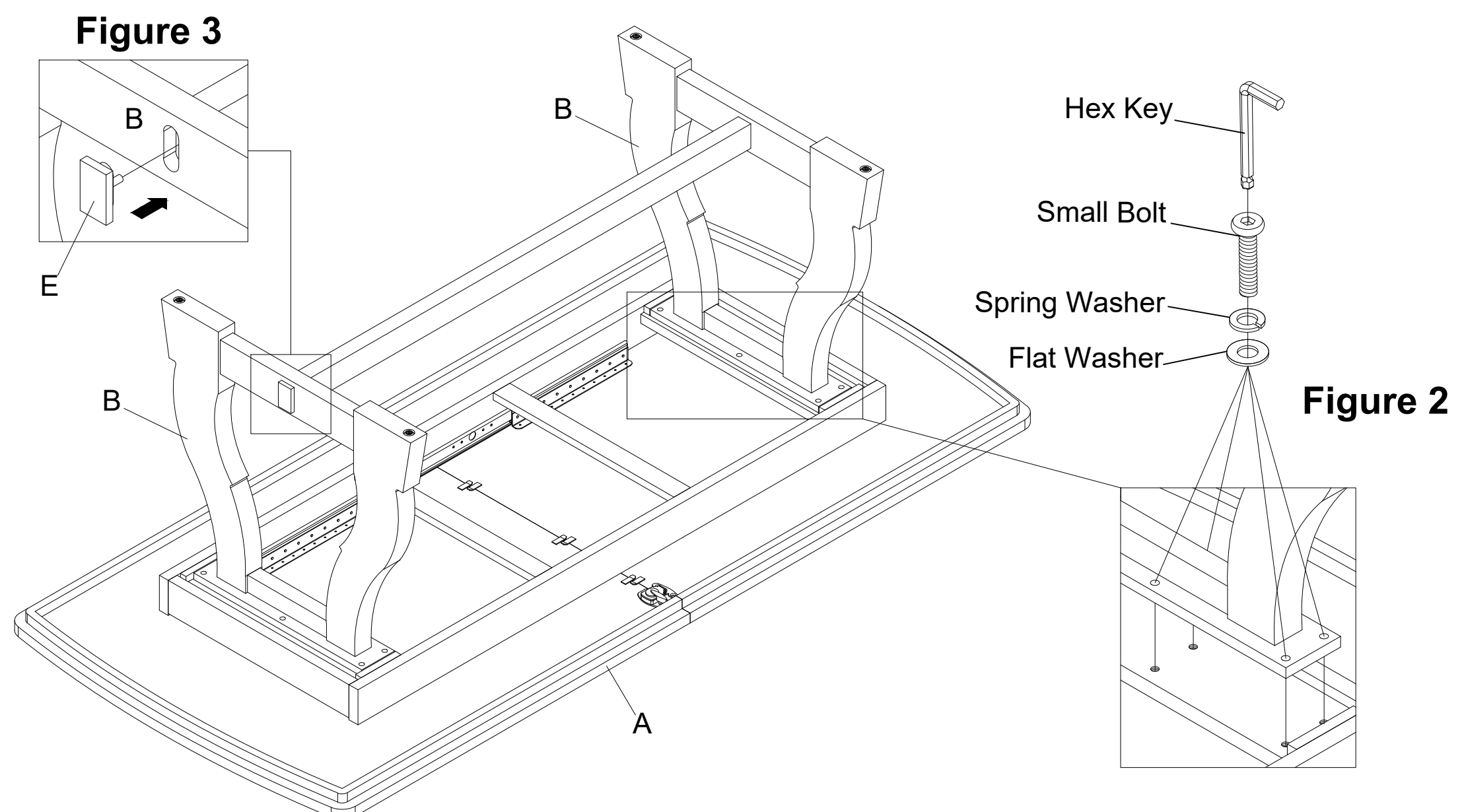

FLEXSTEEL®

Assembly Instructions 3/5

STEP 3

Ask for assistance to lift the unit upright and position it at the desired location.
Adjust the levelers on the legs until the furniture is leveled. (See Figure 4)

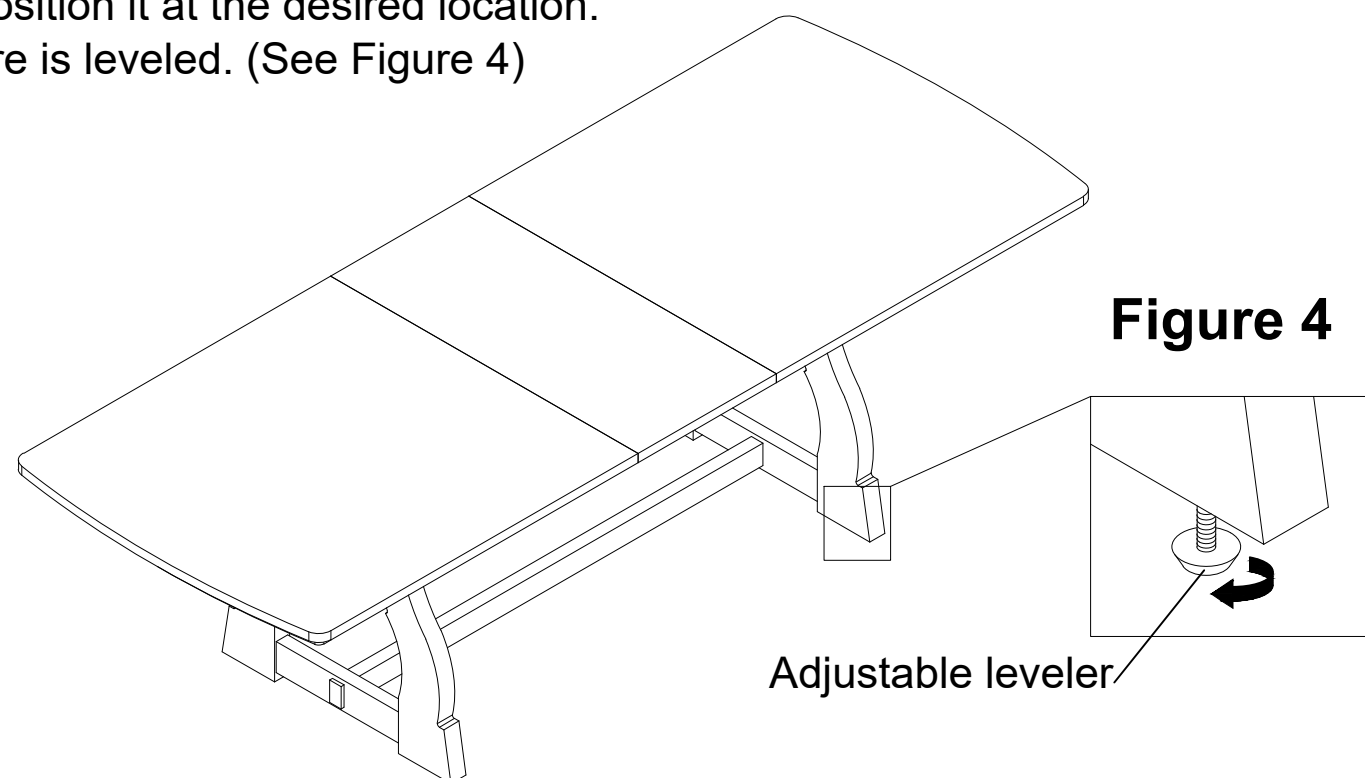

To Retrieve Leaf

1. Unlock the latches under the Table Top (A) and release the latches on both slide mechanisms to allow the slide to operate, then pull the Table Top extension evenly from both ends. (See Figure 5)
2. Lift the Extension Leaf (D) out of the Table Top compartment (A) as shown and place it in the center of the Table Top frame. (See Figure 6)
3. Push the Table Top (A) from both ends to close and lock the latches under the Table Top. (See Figure 7)

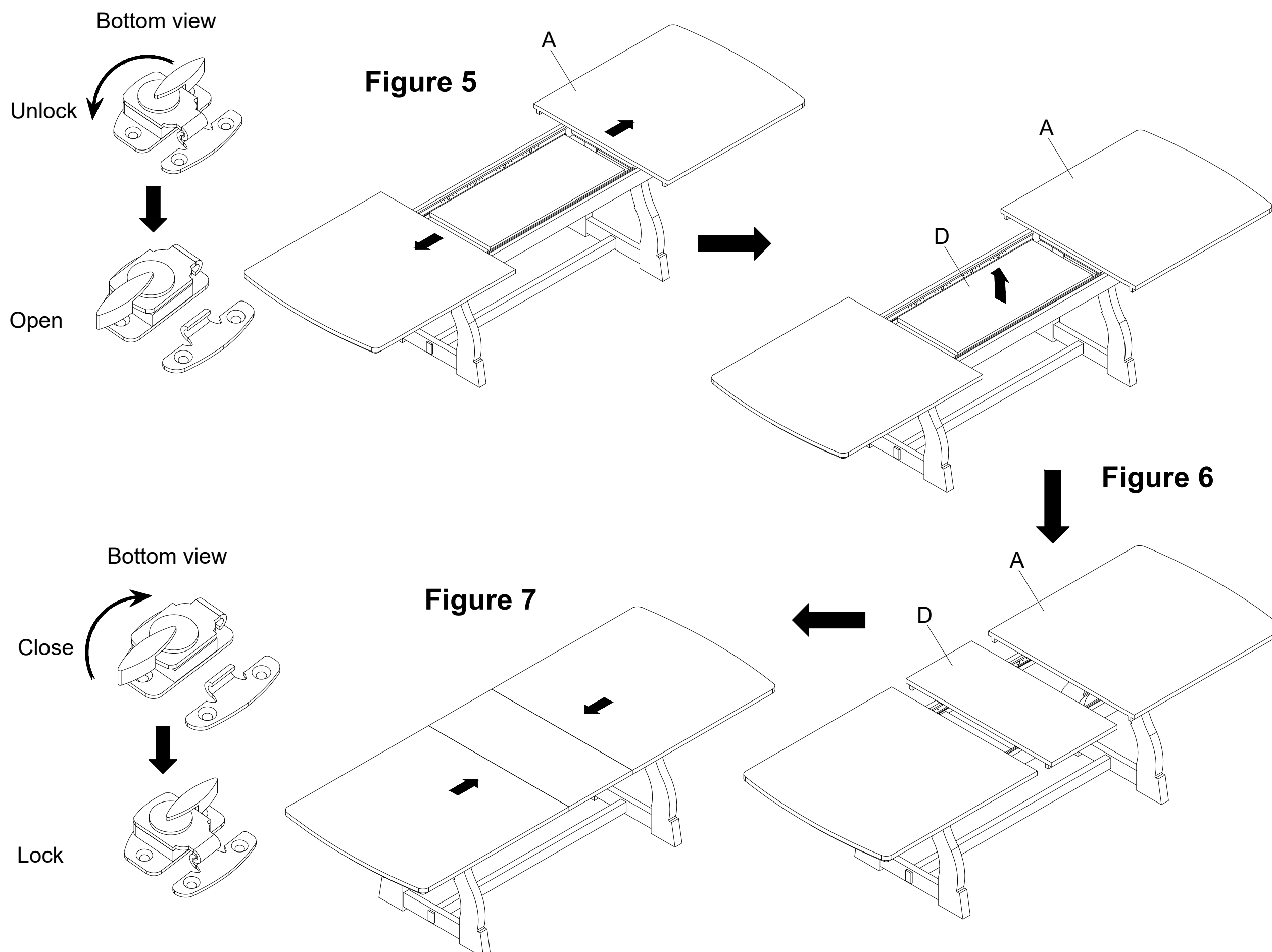

To Store Leaf

1. Unlock the latches underneath the Table Top (A) and release the latches on both slide mechanisms to allow the slide to operate, then pull the Table Top wide open equally from both ends. (See Figure 8)
2. Lift the Extension Leaf (D) from of the Table Top (A) to store within the compartment. (See Figure 9)
3. Push the Table Top (A) from both ends to close and lock the latches underneath the Table Top. (See Figure 10)

Figure 8

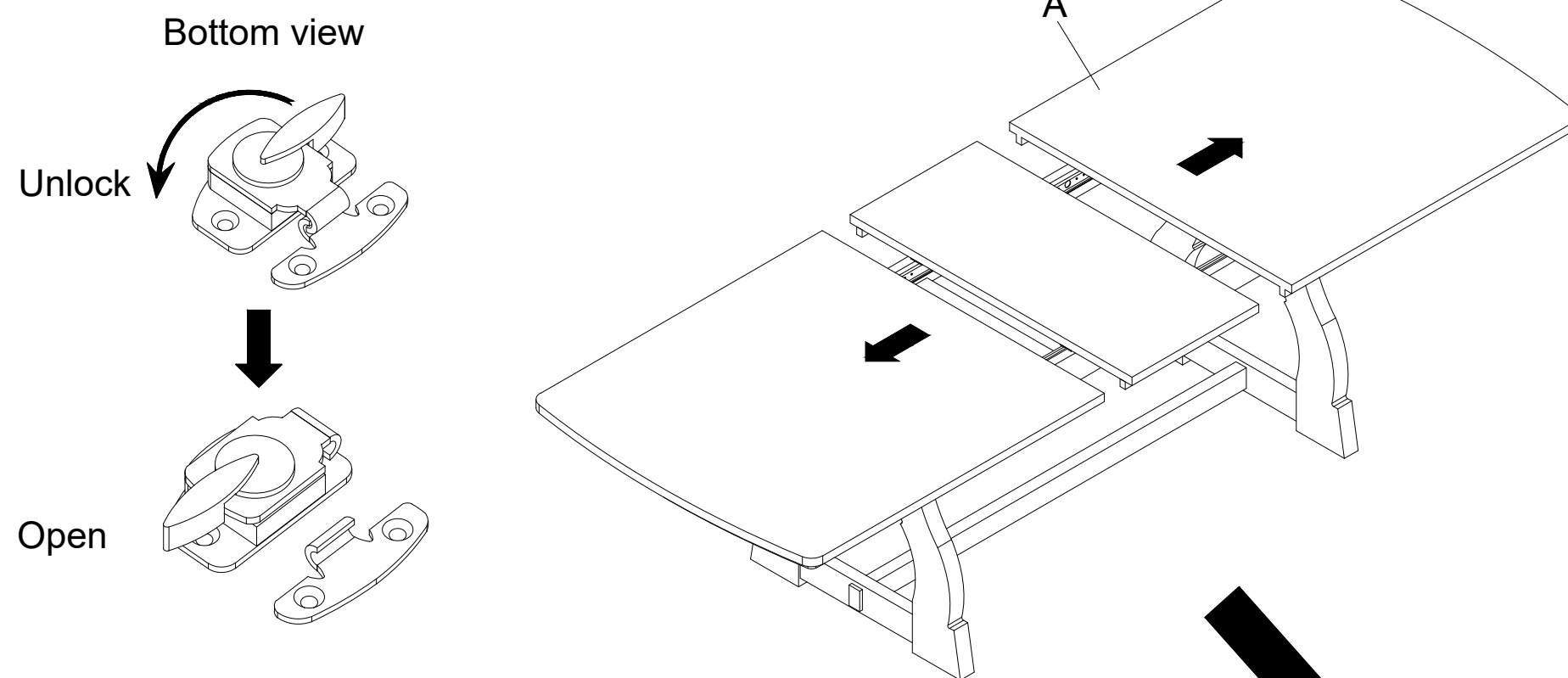

Figure 9

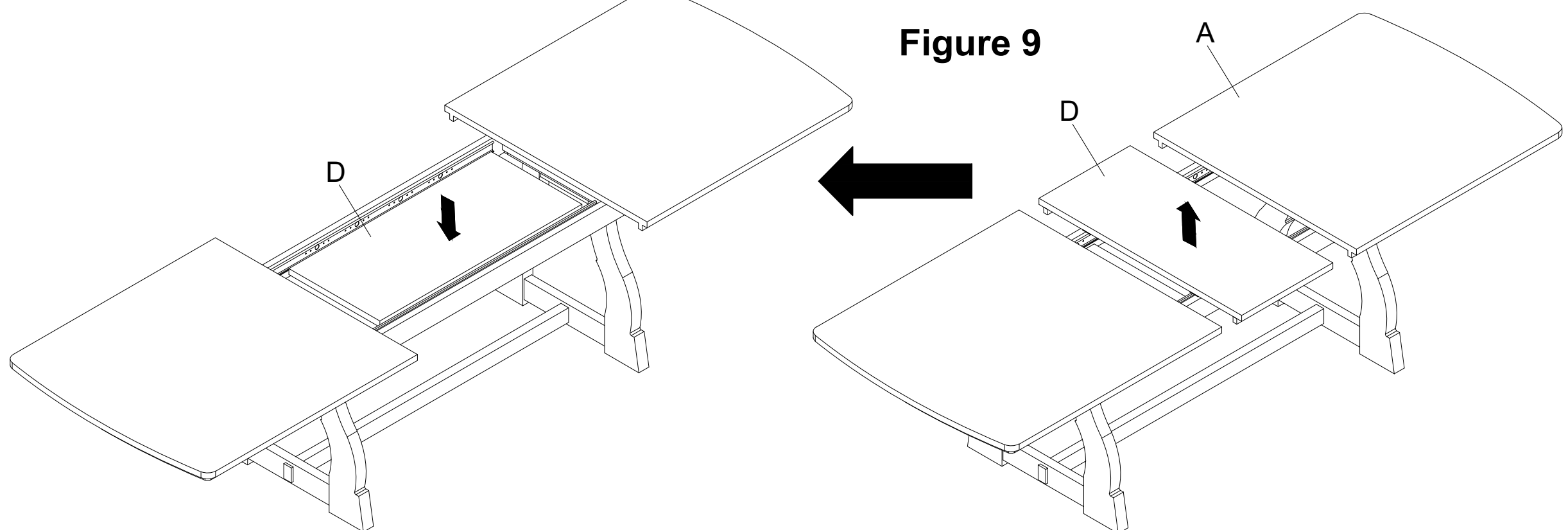
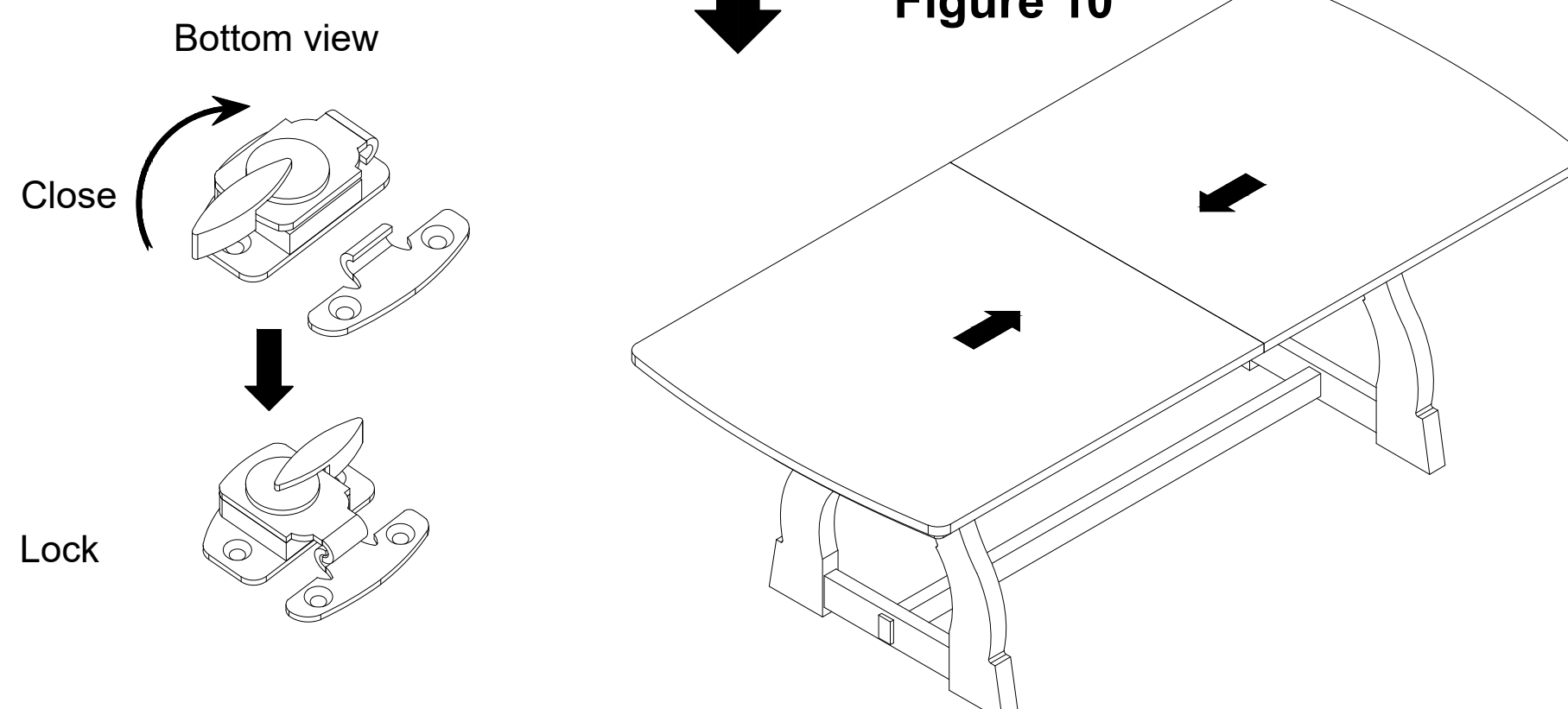
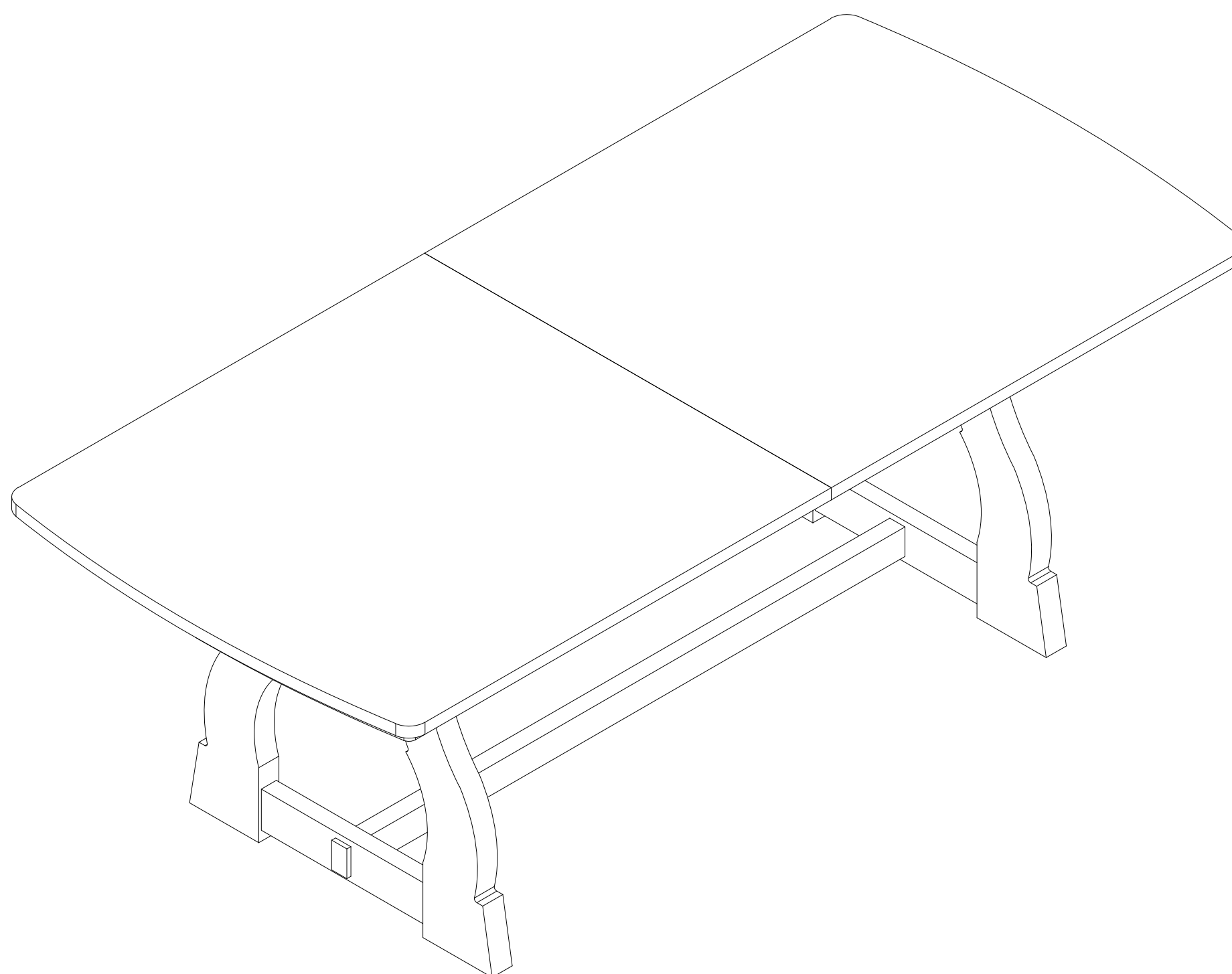

Figure 10



FLEXSTEEL®

Assembly Instructions 5/5



CARE INSTRUCTIONS

- To avoid scratches, do not place sharp or jagged objects directly on the table top.
- Do not place hot items directly on the table top.
- Use placemats or trivets under hot items and coasters under beverages to prevent marks and stains.
- Avoid the use of harsh chemicals or abrasive cleaning materials.
- Wipe the table clean with a soft, dry cloth after each use.
- Wipe up spills quickly with a soft, dry cloth.

Flexsteel Industries, Inc.

For Parts or Customer Service call

toll-free:

1-888-415-3979

Monday-Friday

8:00 a.m. -5:00 p.m.

(Central Time)

Email:

customersolutions@flexsteel.com

www.flexsteel.com