

**33-Lb.  
Countertop Ice Maker**

*User's Manual*

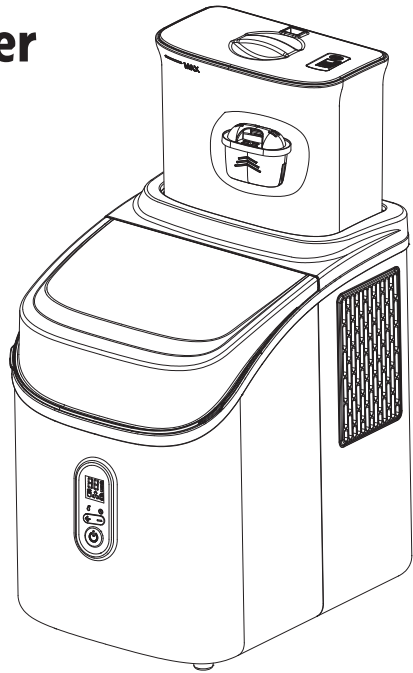

Model MCIM30FST

**PLEASE READ THIS MANUAL CAREFULLY BEFORE USING YOUR ICE MAKER AND  
KEEP IT FOR FUTURE REFERENCE.**



## Product Registration

Thank you for purchasing a Magic Chef® product. The first step to protect your new product is to complete the product registration on our website: [www.mcappliance.com/register](http://www.mcappliance.com/register). The benefits of registering your product include the following:

1. Registering your product will allow us to contact you regarding a safety notification or product update.
2. Registering your product will allow for more efficient warranty service processing when warranty service is required.
3. Registering your product could act as your proof of purchase in the event of insurance loss.

Once again, thank you for purchasing a Magic Chef® product.

## **TABLE OF CONTENTS**

BEFORE PUTTING INTO USE.....	2
SPECIFICATIONS.....	2
<b>IMPORTANT SAFETY INSTRUCTIONS</b>	
IMPORTANT SAFETY TIPS.....	3
NAME OF THE PARTS.....	4
<b>OPERATING PROCEDURES &amp; MAINTENANCE</b>	
UNPACKING YOUR ICE MAKER.....	6
CONNECTING YOUR ICE MAKER.....	6
HOW TO CLEAN .....	7
CARE AND MAINTENANCE.....	7
USING YOUR ICE MAKER.....	8
TROUBLESHOOTING.....	12
ICE MAKER WARRANTY.....	13

## **BEFORE PUTTING INTO USE**

- Before connecting the appliance to the power supply, let the unit stand upright for 1 hour, which
- will reduce the possibility of the cooling system malfunctioning due to improper handling.
- Clean your unit thoroughly before putting into use. (See "How to Clean")
- Use the parts diagram on page 4 to ensure proper positioning of internal components.

## **SPECIFICATIONS**

Product Description	Countertop Ice Maker		
Model No.	MCIM30FST		
Unit Dimensions (Inches)	Width	Height	Depth
	8.7"	16.3"	11.8"
Net Weight	16.8(lbs.)		

# **IMPORTANT SAFETY INSTRUCTIONS**

## **IMPORTANT SAFETY TIPS**

When using electrical appliances, basic safety precautions should be followed to reduce the risk of fire, electric shock, and injury to persons or property. Read all instructions before using any appliance.

- Do not operate the ice maker if the power cord is damaged.
- Always plug the ice maker into a grounded 120V outlet.
- Connect to properly polarized outlets only. No other appliance should be plugged into the same outlet. Be sure that the plug is fully inserted into the receptacle.
- Keep the power cord away from heat sources and high-traffic areas.
- Avoid using extension cords; if necessary, use one rated at 1875W or higher.
- Unplug the ice maker before cleaning or making repairs.
- Exercise caution and use reasonable supervision when appliance is used near children.
- Do not use your ice-maker outdoors. Place the ice-maker away from direct sunlight and make sure that there is at least 6 inches of space between the back of your unit and wall. Keep a minimum distance of 6 inches on each side of your unit free.
- Do not use other liquid to make the ice-cube other than water.
- Do not clean your ice maker with flammable fluids. The fumes can create a fire hazard or explosion.
- Do not tip over.
- If the ice maker is brought indoors from outdoors during the wintertime, give it a few hours to adjust to room temperature before plugging it in.

**⚠ DANGER/CAUTION:** Risk of fire or explosion. Flammable refrigerant used.

- DO NOT use mechanical devices to defrost ice maker.
- To be repaired only by trained service personnel.
- Consult repair/owner's manual before attempting to install or service this product. All safety precautions must be followed.
- Dispose of properly in accordance with local or federal regulations.
- DO NOT puncture refrigerant tubing. Follow handling instructions carefully.

- All safety messages will follow the safety alert symbol and the word "DANGER" or "WARNING".
- Failure to follow these instructions can result in serious injury or death.
- All safety messages will tell you what the potential hazard is, tell you how to reduce the chance of injury, and tell you what can happen if the instructions are not followed.
- The ice maker should be installed in accordance with the safety standard for refrigeration systems, ASHRAE15. The ice maker shall not be installed in corridor or hallways of public buildings.
- To reduce the risk of fire or explosion, we recommend that all service and any part replacements be handled by our factory-authorized technicians. This ensures the correct components are used and the service is performed properly.

### **IMPORTANT:**

The wires in this mains lead are colored in accordance with the following code:

Green or Green with a yellow stripe: Grounding

White: Neutral

Black: Live

## NAME OF THE PARTS

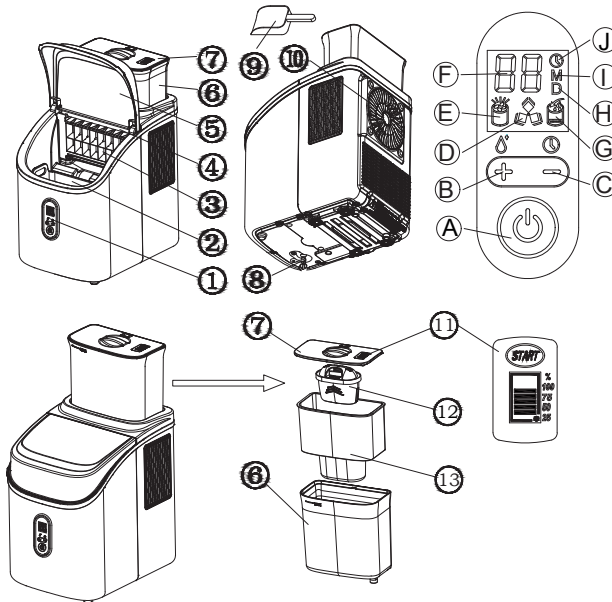

### General instrucion

#### 1. Control Panel:

##### A. **ON/OFF button:**

Start or stop ice making; At the same time can cancel the cleaning and timer setting program; When the unit is making ice cube, press the button for more than 5 seconds, the unit will switch to ice harvest process by force.

##### B. **Time "+" and clean button:**

Ice making time adjustment: when adjusting the ice thickness, press once to increase ice-making time by one minute.

Timing time adjustment: when setting timing time, press 1 time and the timing time will increase 1 hour.

Automatic cleaning: in standby mode, press the button for more than 5 seconds to enter the automatic program

##### C. **Time "-" and timer setting button.**

Ice making time adjustment: when adjusting the ice thickness, press 1 time and the ice making cycle will reduce 1 minute.

Timing time adjustment: when setting timing time, press 1 time and the timing time will reduce 1 hour.

## NAME OF THE PARTS

Timing setting: in standby mode, press the button for more than 5 seconds to set the timing of the machine.

- D. Ice cube symbol: when the symbol is always on, the unit is making ice cube. when the symbol flashes, the unit is ice harvest.
- E. Ice full warning symbol: the unit will automatically make ice after removing the ice.
- F. Digital display:

Ice thickness display: when the number is displayed simultaneously with "D" on the right, means the current ice thickness adjustment gear; For example, the display of "1" and "D" means that the ice making time is increased by 1 minute.

Ice making time countdown display: when the number is displayed simultaneously with "M" on the right, means the ice making time countdown display; For example, the display of "2" and "M" means that the unit will start harvesting ice in about 2 minutes.

Timing display: when the number is displayed simultaneously with "⌚" on the right, means the timing startup or shutdown display.

Automatic cleaning time countdown display: when the number is blinking, there is no unit display on the right side, means the cleaning time countdown; For example, if the display of "20" blinks, it means that the automatic cleaning will end after about 20 minutes.

- G. Water shortage symbol: If the symbol is on, the machine is short of water.
  - H. Ice thickness adjustment unit, display in conjunction with digital display.
  - I. Ice making time countdown unit, display in conjunction with digital display.
  - J. Timing setting, display in conjunction with digital display.
2. Ice basket
  3. Evaporator
  4. Water separator pipe
  5. Front up cover
  6. Water tank
  7. Cover for the water reservoir
  8. Water draining cap: To draining out the water from unit
  9. Ice scoop
  10. Hot Air Outlet
  11. 60 Day timer (Countdown for replacing filter element)
  12. Filter element
  13. Filter element water tank

## **OPERATING PROCEDURES & MAINTENANCE**

### **UNPACKING YOUR ICE MAKER**

1. Remove all exterior and interior packaging. Check that ice basket and ice scoop is included. If any parts are missing, please contact our customer service.
2. Clean the interior with lukewarm water and a soft cloth. Remove the ice basket and wash it in warm water.
3. Place the ice maker on a flat, level surface away from sunlight or heat sources. Make sure that there is at least 6 inches of space between the back and sides of your ice maker and the wall.
4. Wait one hour before plugging in the ice maker to allow the refrigerant to settle.
5. The appliance must be positioned so that the plug is accessible.

**WARNING:** Fill with potable water only.

### **CONNECTING YOUR ICE MAKER**



## **DANGER**

**\* Improper use of the grounded plug can result in the risk of electrical shock. If the power cord is damaged please call our customer service at 888-775-0202.**

1. This unit should be properly grounded for your safety. The power cord of this appliance is equipped with a three-prong plug which mates with standard three prong wall outlets to minimize the possibility of electric shock.
2. Plug your appliance into an exclusive, properly installed, grounded wall outlet. Do not under any circumstances, cut or remove the third (ground) prong from the power cord. Any questions concerning power and/or grounding should be directed toward a certified electrician.
3. This appliance requires a standard 110-120 volt, 60Hz electrical outlet with three-prong ground.

Before using your ice maker, it is strongly recommended to clean it thoroughly.

**The ice maker is not designed to be installed in an outside area such as a garage or a porch. Ambient temperatures of below 50°F or above 105°F will hinder the performance of the appliance.**

## HOW TO CLEAN

1. Unplug the unit and remove the ice basket.
2. Clean the inside with warm water and mild detergent.
3. Rinse thoroughly and drain using the bottom drain plug.
4. Dry with a soft cloth before reuse.

After using your ice maker for a long time, we also suggest you should clean your unit. Especially to the water separator pipe and the water filters, you must clean them periodically.

## CARE AND MAINTENANCE

1. If the water separator pipe is blocked and there is no water flowing down when you listen to the compressor and the water pump inside are still working, Clean the each hole on the pipe wall displayed in following picture.

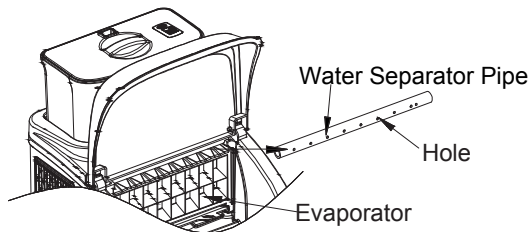

2. For both of the water tank and the big water reservoir, clean them with diluted detergent, warm water and a soft cloth. Then use the water to rinse the inside, and drain out the water from the draining port by unplugging the Water drainage cap on the bottom. This helps keep your ice and machine clean and sanitary, and also make the unit work normally.
3. When cleaning, if find that the ice cube left on the evaporator and can not be taken out easily, you can turn on the unit to let the unit enter the ice making process, then press “**ON/OFF**” button for more than 5 seconds to let the unit start ice harvest process to melt the ice cube. It will help you remove the hard ice cube.

### **How to drain out the water from the internal tank and big water reservoir completely**

Because the water in the big water reservoir is stop to drain port by the water valve, if you want to drain away all the water, please plug on the unit and but don't start the unit, then remove the Water drainage cap at the bottom. Wait some minutes, all of the water will flow out.

# USING YOUR ICE MAKER

## INSTALL AND REPLACE FILTER ELEMENT

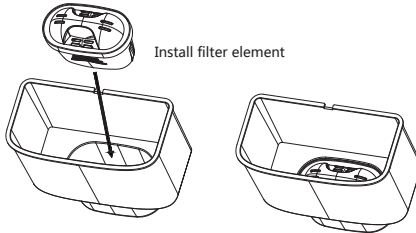

Install filter element

Filter element pressed into filter element water tank

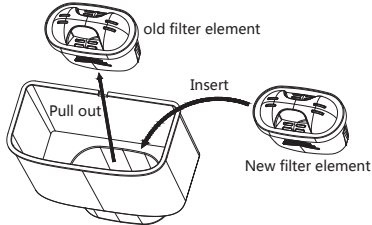

Replace filter element



When to replace the filter element ?

Please replace the filter element with a new one when the timer days becomes 0

! After replacing the filter element, press and hold the timer "start" for 5 seconds to reset the timer

## ADD WATER TO ICE MAKER

Method 1: Manually add water:

Insert the "water tank" into the corresponding position on the top of the machine, open the "water tank cover", pour drinking water, the water level should be lower than the "MAX" mark line, and then cover the "water tank cover" to prevent foreign matter from entering the water tank. As shown in the picture on the right:

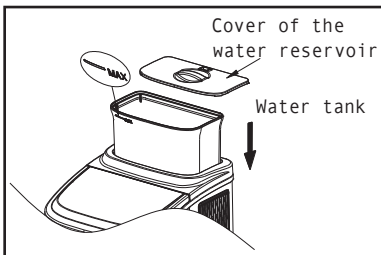

## ICE MAKING OPERATION

### Operation and display areas

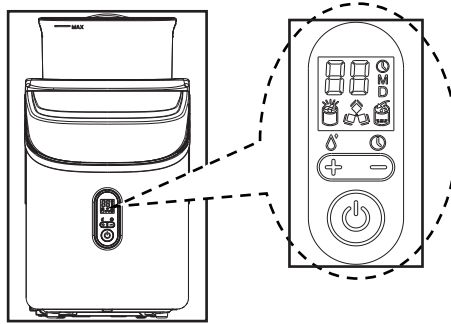

1. Ice making startup: Plug in the power plug, the display symbol  stays on, press the "  " key on the operation panel, water will be added to the water tank through the electromagnetic water valve, after reaching the standard water level, the unit starts to make ice, the symbol  and " 0 " and " D " stays on, steady " 0 D ", means that the ice is made at the default time;  
After a few minutes of ice making work, there will be a flashing number and symbol "M", if the display shows '10M,' about 10 minutes remain in the ice-making cycle.
2. After each ice making is finished, the unit will start to harvest the ice cube, and the ice making symbol  will be shining. Water will be added to the tank through the electromagnetic water valve until it reaches the standard water level of the tank, and the unit will enter the next ice making cycle; when the water added to the tank cannot reach the standard water level of the tank, the symbol  stays on, and the unit will stop working.  
After a water shortage, it is necessary to restart the machine, otherwise it will wait for about 15 minutes and automatically start up.  
Note: Each ice-making cycle is about 10-25 minutes, and the ice-making time may vary according to the ambient temperature and the water temperature added. Especially the first time to make ice, due to the higher water temperature in the tank, the ice making time will be longer. But the ice-making cycle will not exceed 35 minutes.
3. How to Adjust Ice Thickness: If your ice cubes are too thin, press the '+' button to increase ice-making time. when the number and symbol "D" are displayed on the display screen, it means setting ice-making time, the default is "0", press the "+" key once to increase the ice-making time by one minute, and the ice cube will be thicker, the ice-making time can be increased by up to 6 minutes, the display will display the corresponding number; Press the "-" key once to reduce the ice-making time by one minute, and the ice cube will be thinner, the ice-making time can be reduced by up to 6 minutes. After the unit is powered on again, it returns to the default setting of "0". After the ice making time is set, it can only start from the new cycle.
4. When ice full symbol  is on, the unit will stop, take out the ice cube inside, the unit will start working again.
5. Ice making shutdown: Press the "On/Off" button on the operation panel to shut down the unit and enter the standby mode when the unit is working.

## FORCED ICE HARVESTING OPERATION

If press the **"On/Off"** button more than 5S, when the ice maker is working, the unit will start harvest. Press **"On/Off"** button, the unit will turn off.

## ***AUTOMATIC SELF-CLEANING PROGRAM***

Automatic self-cleaning program, the default cleaning time is 20 minutes. Plug in the unit with the water tank filled with water, press the **"+"** button on the operation panel for more than 5 seconds to start entering the self-cleaning function, and the number **"20"** on the display flashes, indicating the end of the self-cleaning function after 20 minutes.

Cancel the self-cleaning program: It takes about 20 minutes to complete a self-cleaning program. When the program is finished, the system will automatically be in the off state. You can also force a stop to the self-cleaning program by pressing the **"On/off"** button on the operation panel.

## TIMED STARTUP AND TIMED SHUTDOWN FUNCTION OPERATION

### Using the Timer Function

Timer setting range: 1-24 hours

Timed shutdown: When the unit is working, timer setting the unit off.

Timed startup: When the unit is in standby, timer setting the unit on.

### How to Set the Timer

Press the "-" button on the operation panel for more than 5 seconds, and the timing time "1" and symbol "🕒" appear on the display screen, then press the "+" button to adjust the timing time you need, each time you press, the time increases by 1 hour; Press "-" to reduce the timing time. The symbol "🕒" is shining during the time adjustment process, and the setting will be completed when the symbol turns on after 5 seconds.

**Timed Startup Display:** "5" and "🕒" are displayed in the standby state, indicating that the unit will automatically start up after 5 hours;

**Timed Shutdown Display:** in the ice making condition, the symbol "🕒" is on, indicating that there is a timed shutdown setting at present, press the "-" button for more than 5 seconds, you can display the current setting time, display "5" and "🕒", indicating that the machine will automatically shut down after 5 hours.

### How to Cancel the Timing

When the unit has been timed, press the "-" button on the operation panel for more than 5 seconds, the number and "🕒" on the screen blink, and then press the "-" button on the operation panel for more than 5 seconds, the timing will be canceled; You can also set the timing time to "0", and the timing will be canceled after 5 seconds. You can also directly press the "🔌" key on the operation panel to force off the timing function and directly turn it on or off.





**How to Drain Water:** pull out the drain plug at the bottom of the ice maker to empty the water in the inner tank; The ice maker must be in standby mode to drain water from the water tank and inner tank. Then reset the drain plug when the drain is complete.

In order to ensure hygiene requirements, please change the water every 24 hours and clean the inner tank and water tank every three days.

## WARNING

- A. make sure the water tank, water filter and the water separator pipe is not blocked, clean them
- B. The water temp will affect the ice making capacity. The lower temp, the more ice cube produce.
- C. The cooler ambient temp, the more ice cube produce.
- D. always use good quality water to make sure the pump work well. Bad quality water will cause pump noise, but doesn't affect the unit working.
- E. The compressor restart 3 mins later if you turn off the unit.

## TROUBLESHOOTING

PROBLEM	POSSIBLE CAUSE	SOLUTION
<  > is on	Lack of water	Turn off the unit and add water to <MAX> level, then re-start the unit.
<  > is on	Too much ice cube in the basket	Remove the ice cube in the basket.
<  > is flash	The ice full plate blocked	Take out the ice cube under the ice full plate, make sure the ice full plate can roll smoothly. Or wait 3-6 hours until the ice cube melt and the ice full plate roll back automatically.
The water reservoir has water, but <  > is on	The inlet solenoid valve breakdown	Contact customer service for repair.
<E> is on	The ice making system damage	Contact customer service for repair.
	Too much water in the ice basket	Drain out the water below the ice basket, and then turn on the unit.
<E1> is on	Ambient temp sensor breakdown	The unit can still work, change a new sensor
<E2> is on	Water temp sensor breakdown	The unit can still work, change a new sensor
No water in the water Separator pipe	The holes are blocked	Use slim wire to prick each hole, till the water can flow out easily.
	Water filter block	Clean the water filter
Ice cube thick and can't Drop down	Ice making cycle too long	Press <-> to reduce the ice making time.
Ice cube thin	Ambient temp too high	Move the unit to cool place
	Water temp too high	The water temp should be no more than 25°C (77°F)
	Ice making short	Press <+> to increase the ice making time.
Unit work but no ice cube	Ambient temp is high or the Water temp is high	Move the unit to somewhere ambient Temp lower than 30°C (86°F), fill cool water
	Refrigerant system leakage	Contact customer service for repair.
	Refrigerant system block	Contact customer service for repair.



## Warranty

### Limited Warranty

MC Appliance Corporation warrants each new "Countertop Ice Maker" to be free from defects in material and workmanship, and agrees to remedy any such defect or to furnish a new part(s), (at the company's option) for any part(s) of the unit that has failed during the warranty period. Parts and labor expenses are covered on this unit for a period of one year after the date of purchase. A copy of the dated sales receipt/invoice is required to receive warranty service, replacement or refund.

In addition, MC Appliance Corporation warrants the compressor (parts only) to be free from defects in material and workmanship for a period of five years. The consumer is responsible for all labor and transportation expenses related to the diagnosis and replacement of the compressor after the initial one-year warranty expires. In the event that the unit requires replacement or refund under the terms of this warranty, the consumer is responsible for all transportation expenses to return the unit to our factory prior to receiving a replacement unit or refund. A refund or replacement will be issued at the discretion of MC Appliance Corporation.

This warranty covers appliances in use within the contiguous United States, Alaska, Hawaii, and Puerto Rico. The warranty does not cover the following:

- Damages due to shipping damage or improper installation.
- Damages due to misuse or abuse.
- Punctures to the evaporator system due to improper defrosting of the unit
- Content losses due to failure of the unit.
- Repairs performed by unauthorized service agents.
- Service calls that do not involve defects in material and workmanship, such as instruction on proper use of the product or improper installation.
- Replacement or resetting of house fuses or circuit breakers.
- Failure of this product if used for purposes other than its intended purpose.
- Disposal costs of failed units not returned to our factory.
- Any delivery or installation costs incurred as the result of a unit that fails to perform as specified.
- Expenses for travel and transportation for product service if your appliance is located in a remote area where service by an authorized service technician is not available.
- The removal and reinstallation of your appliance if it is installed in an inaccessible location or is not installed in accordance with published installation instructions.
- Refunds for non repairable products are limited to the price paid for the unit per the sales receipt.
- This warranty is non transferable. This warranty applies only to the original purchaser and does not extend to any subsequent owner(s).

### LIMITATIONS OF REMEDIES AND EXCLUSIONS

Product repair in accordance with the terms herein, is your sole and exclusive remedy under this limited warranty. Any and all implied warranties including merchantability and fitness for a particular purpose are hereby limited to one year or the shortest period allowed by law. MC Appliance Corporation is not liable for incidental or consequential damages and no representative or person is authorized to assume for us any other liability in connection with the sale of this product. Under no circumstances is the consumer permitted to return this unit to the factory without the prior written consent of MC Appliance Corporation.

Some states prohibit the exclusion or limitation of incidental or consequential damages, or limitations on implied warranties. This warranty gives you specific rights, and you may also have other rights which vary from state to state.

Model  
MCIM30FST

Parts & Labor  
One Year

Compressor (Parts Only)  
Five Years

Type of Service  
Carry In

For Service or Assistance, please call **888-775-0202**. Or visit us on the web at [www.mcappliance.com](http://www.mcappliance.com) to request warranty service or order parts.



**CNA International, Inc. d/b/a MC Appliance Corporation. All rights reserved.  
Magic Chef® is a registered trademark of CNA International, Inc.**

**[www.mcappliance.com](http://www.mcappliance.com)**

**Printed in China**