

INSTRUCTION MANUAL

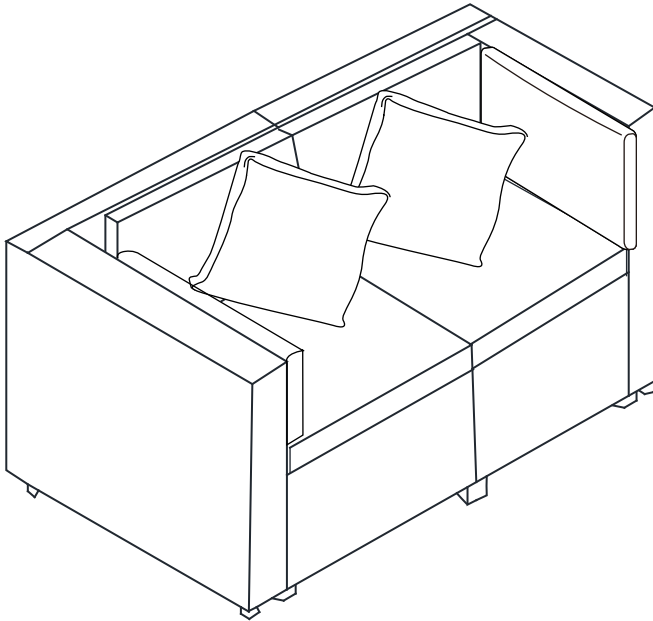

**Logan Rattan Corner Sofa
with Cushions & Pillow (Set of 2)
SKU: OP112-A**

V1.0

! NOTICE

Do not overtighten screws. (Insert all screws before tightening screws.)

- Please do not exceed the weight limitations of this item.
- Do not stand on or use any part of this item as a step ladder.
- Firmly secure all bolts, screws and nuts before use.
- Reconfirm that all bolts, screws, and nuts are secure every 90 days.
- Do not use or store this item in the proximity of open flame or flammable/combustible chemicals.
- Be aware that some parts are heavy and have sharp edges.

TOOLS REQUIRED



ALLEN WRENCH
(PROVIDED)



WRENCH
(PROVIDED)



CHAIR
330 LBS
CAPACITY



1 PERSON
ASSEMBLY



UP TO 60 MIN.
ASSEMBLY

HARDWARE

1

M6 x 50mm
BOLT



20 PCS

2

M6 WASHER



48 PCS

3

M6 NUT



20 PCS

4

ALLEN
WRENCH



1 PC

5

WRENCH



1 PC

6

M6 x 35mm
BOLT



8 PCS

PARTS

A

CORNER BACKREST

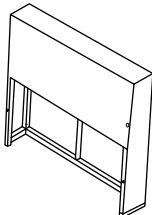

2 PCS

B

CORNER LEFT SIDE

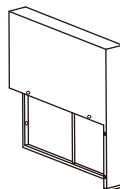

1 PC

C

CORNER SIDE PANEL

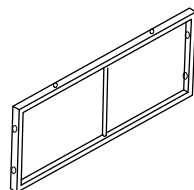

2 PCS

PARTS

D

CORNER RIGHT SIDE

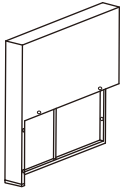

1 PC

E

CORNER SEAT - LEFT

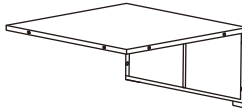

1 PC

F

CORNER SEAT - RIGHT

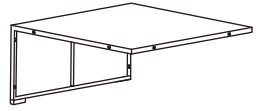

1 PC

CUSHION

Z1

SEAT CUSHION

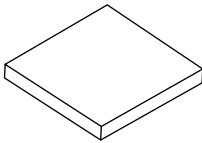

2 PCS

Z2

SIDE CUSHION

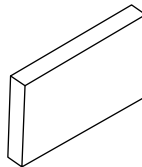

2 PCS

Z3

BACK CUSHION

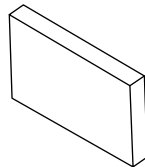

2 PCS

Z4

PILLOW

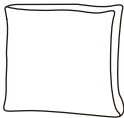

2 PCS

PRODUCT ASSEMBLY - CORNER SEAT - LEFT

1

Attach the part B Corner Left Side to part A Corner Backrest with 2 PCS of part 1 bolt and part 3 nut and 4 PCS of part 2 washer.

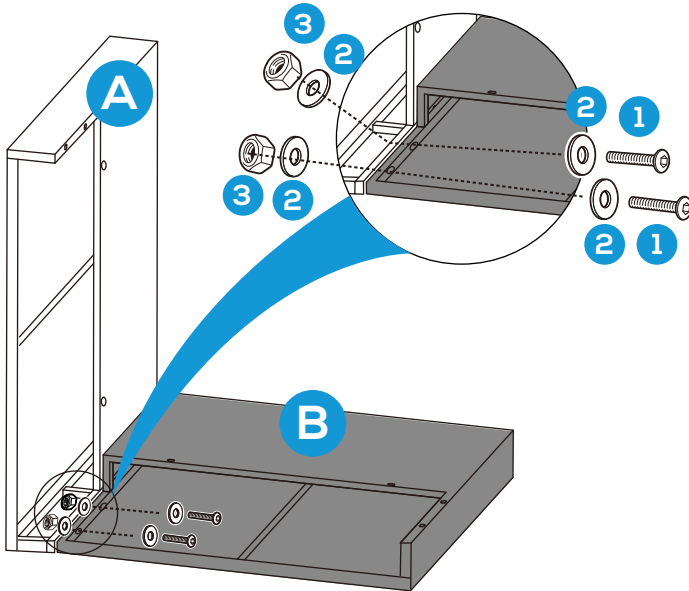

2

Attach the part E Corner Seat to part A Corner Backrest and part B Corner Left Side with 6 PCS of part 1 bolt and part 3 Nut as well as 12 PCS of part 2 washer.

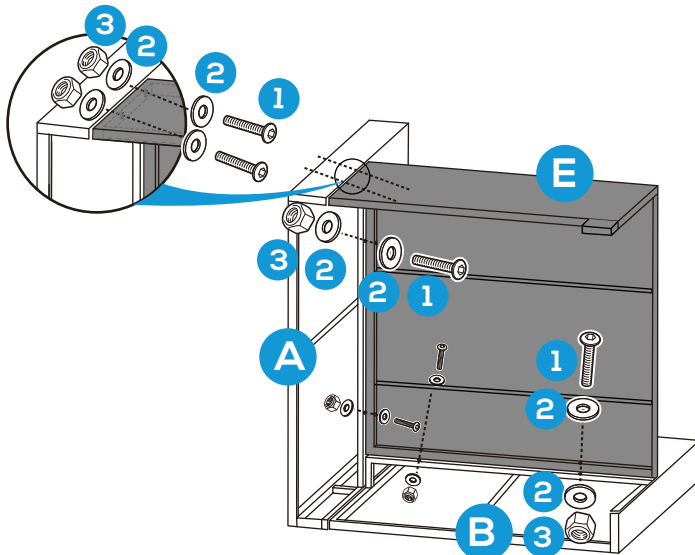

PRODUCT ASSEMBLY - CORNER SEAT - LEFT

3

Attach part C Corner Side Panel with part B Corner Left Side with 2 pcs of part 1 Bolt, 2 pcs of part 3 Nut as well as 4 pcs of part 2 washer.

Attach part C Corner Side Panel with part E Corner Seat with 4 pcs of bolt 6 and part 2 Washer.

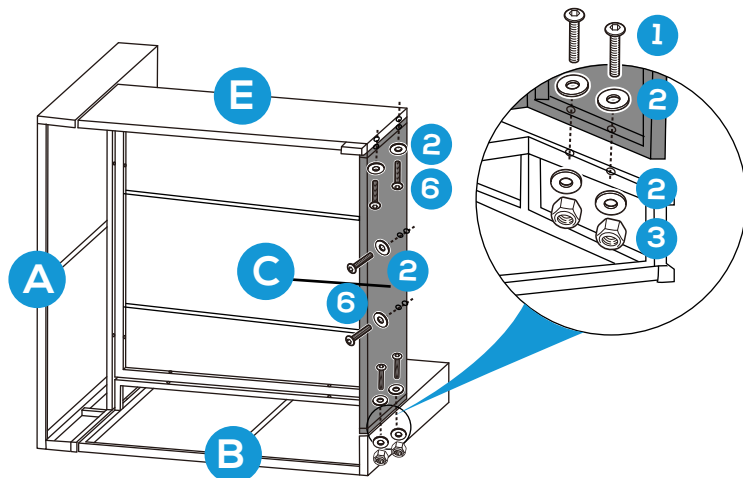

4

Place part Z1 Seat Cushion, part Z3 Back Cushions and part Z2 Side Cushion onto the Corner Seat, as below.

The assembly of Left corner seat finishes.

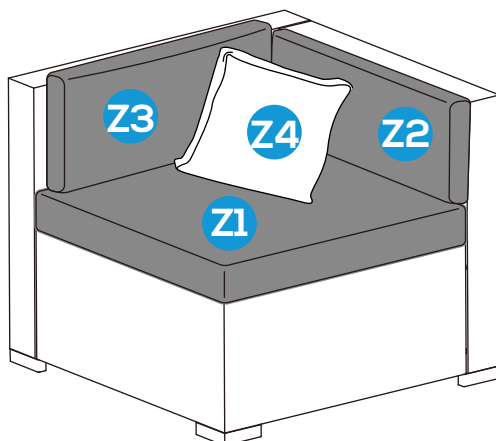

PRODUCT ASSEMBLY - CORNER SEAT - RIGHT

5

Attach the part D Corner Right Side to part A Corner Backrest with 2 PCS of part 1 bolt and part 3 nut as well as 4 PCS of part 2 washer

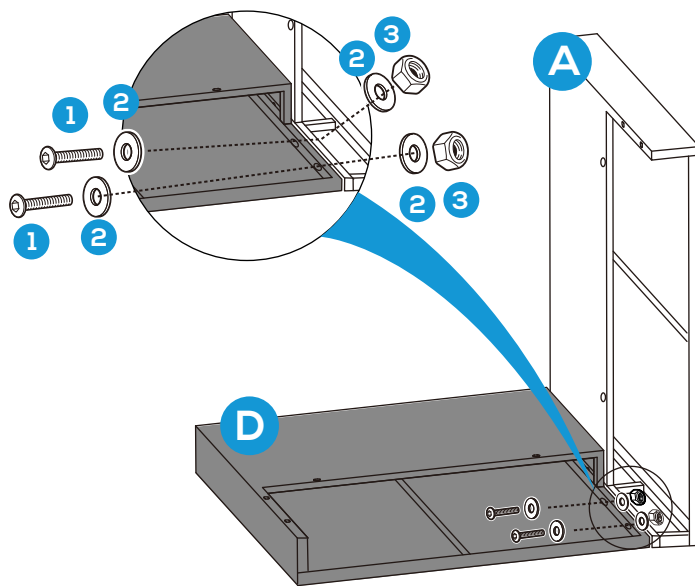

6

Attach the part F Corner Seat - Right to part A Corner Backrest with 4 PCS of part 1 bolt and part 3 nut as well as 8 PCS of part 2 washer.

Attach the part F Corner Seat - Right to part D Corner Right Side with 2 PCS of part 1 bolt and part 3 nut as well as 4 PCS of part 2 washer.

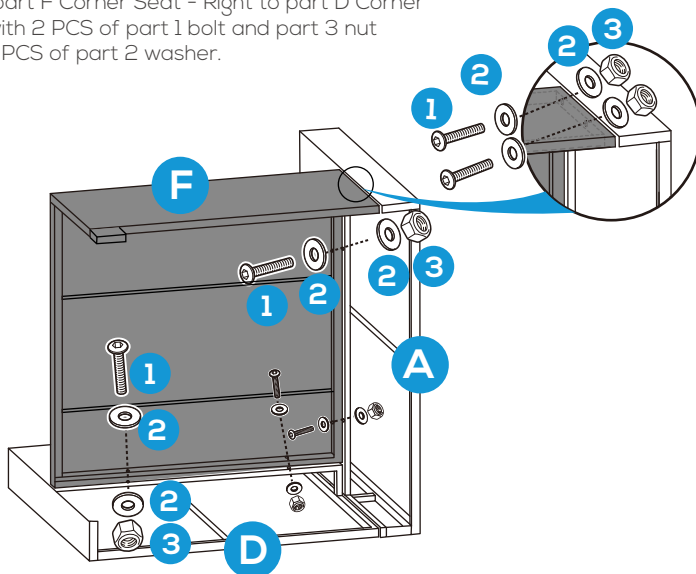

PRODUCT ASSEMBLY - CORNER SEAT - RIGHT

7

Attach part C Corner Side Panel to part D Corner Right Side with 2 pcs of part 1 Bolt, part 3 Nut as well as 4 pcs of part 2 Washer.

Attach part C Corner Side Panel to part F Corner Seat with 4 PCS of part 6 bolt and part 2 Washer.

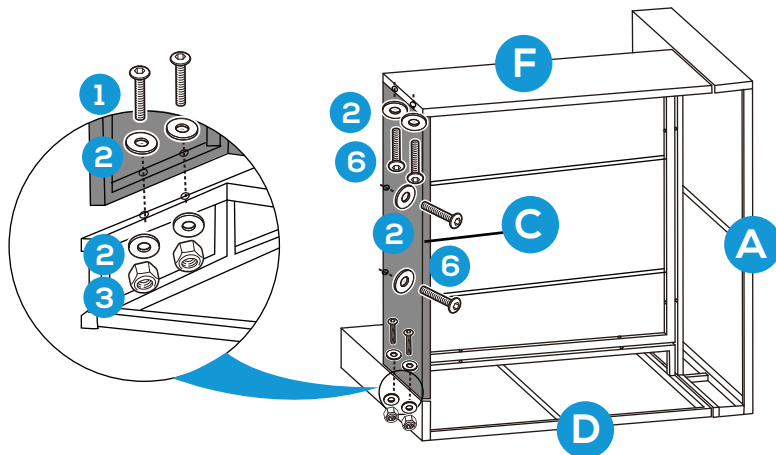

8

Place part Z1 Seat Cushion, part Z3 Back Cushions and part Z2 Side Cushion onto the Corner Seat.

The assembly of Right corner seat finishes.

