

SHIMANO

CALCUTTA CONQUEST MD

23CQMD300XLH

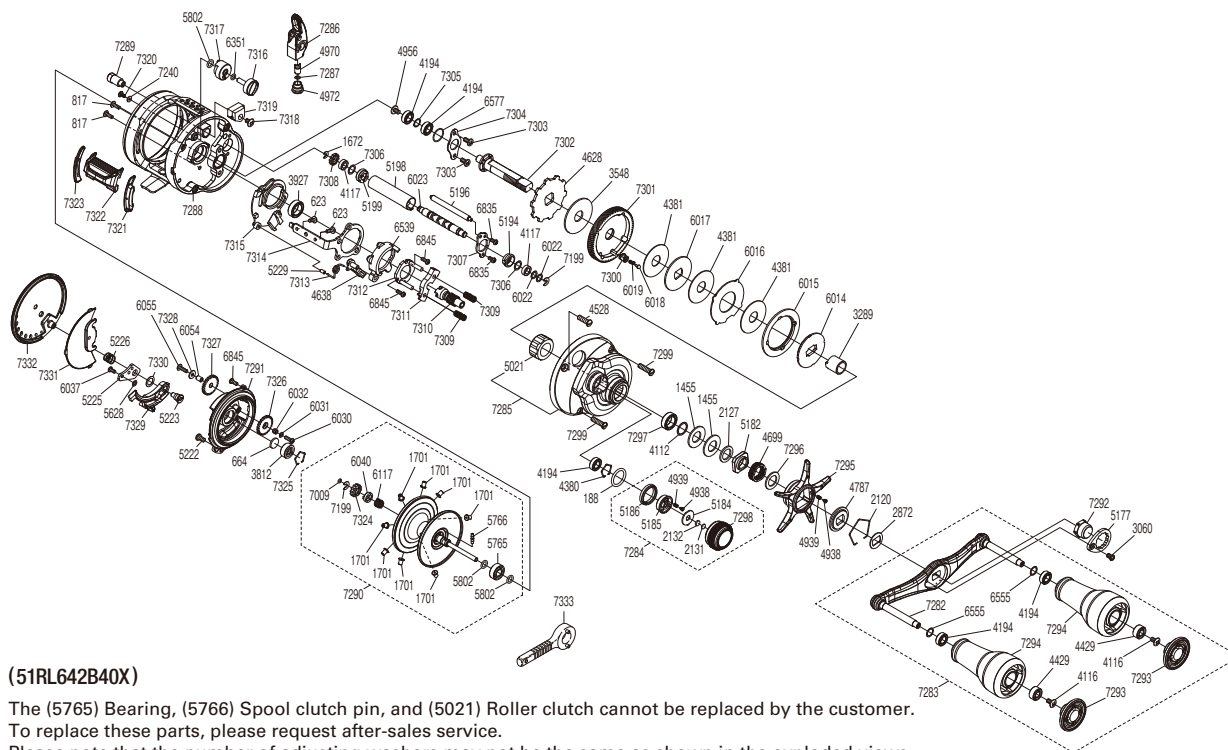

(51RL642B40X)

The (5765) Bearing, (5766) Spool clutch pin, and (5021) Roller clutch cannot be replaced by the customer. To replace these parts, please request after-sales service. Please note that the number of adjusting washers may not be the same as shown in the exploded views. (Adjustment will vary with each individual product.)

Part No.	Description	Part No.	Description	Part No.	Description
BNT0188	O Ring	BNT5222	Screw	BNT7292	Handle Nut
BNT0623	Screw	BNT5223	B Side Plate Insert	BNT7293	Handle Knob Seal
BNT0664	Spacer B	BNT5225	Damper Bush	BNT7294	Handle Knob
BNT0817	Screw	BNT5226	Damper Spring	BNT7295	Star Drag
BNT1455	Drag Spring Washer (H)	BNT5229	Clutch Pawl Spring Collar	BNT7296	Washer
BNT1672	E Lock	BNT5628	Washer	BNT7297	Ball Bearing
BNT1701	Brake Collar (Gray)	BNT5765	Ball Bearing	BNT7298	Cast Control Cap
BNT2120	Click Plate Retainer	BNT5766	Spool Clutch Pin	BNT7299	Screw
BNT2127	Star Drag Spacer	BNT5802	O Ring	BNT7300	Drag Click Pin Holder
BNT2131	Cast Control Spacer	BNT6014	Pressure Plate	BNT7301	Drive Gear
BNT2132	Cast Control Spacer	BNT6015	Drag Click Ratchet	BNT7302	Drive Shaft
BNT2872	Drive Shaft Shield	BNT6016	Eared Washer	BNT7303	Screw
BNT3060	Screw	BNT6017	Drag Washer	BNT7304	Drive Shaft Retainer
BNT3289	Roller Clutch Inner Tube	BNT6018	Drag Click	BNT7305	Washer
BNT3548	Drag Washer	BNT6019	Click Spring	BNT7306	Washer
BNT3812	Ball Bearing	BNT6022	Washer	BNT7307	Worm Bushing Retainer
BNT3927	Ball Bearing	BNT6023	Worm Shaft	BNT7308	Idle Gear C
BNT4112	Washer	BNT6030	Screw	BNT7309	Yoke Spring
BNT4116	Screw	BNT6031	Washer	BNT7310	Pinion Gear
BNT4117	Bushing	BNT6032	Idle Gear B Support	BNT7311	Yoke
BNT4194	Ball Bearing	BNT6037	Screw	BNT7312	Clutch Cam Retainer
BNT4380	Retainer	BNT6040	Spool Shaft Cam	BNT7313	Clutch Pawl Spring
BNT4381	Drag Washer	BNT6054	Idle Gear D Support	BNT7314	Clutch Plate
BNT4429	Ball Bearing	BNT6055	Screw	BNT7315	Clutch Guard
BNT4528	Screw	BNT6117	Spool Shaft Spring	BNT7316	Br Dial
BNT4628	Anti-Reverse Ratchet	BNT6351	O Ring	BNT7317	Brake Cam
BNT4638	Clutch Pawl	BNT6539	Clutch Cam	BNT7318	Screw
BNT4699	Star Drag Spring	BNT6555	Washer	BNT7319	Brake Holder
BNT4787	Star Drag Click Plate	BNT6577	O Ring	BNT7320	Screw
BNT4938	Click Pin	BNT6835	Screw	BNT7321	Clutch Bar Guide B
BNT4939	Click Spring	BNT6845	Screw	BNT7322	Clutch Button Assembly
BNT4956	Screw	BNT7009	O Ring	BNT7323	Clutch Bar Guide A
BNT4970	Line Guide Pawl	BNT7199	E Lock	BNT7324	Idle Gear A
BNT4972	Pawl Cap	BNT7240	Washer	BNT7325	Bearing Retainer
BNT5021	Roller Clutch Bearing	BNT7282	Handle Shank Assembly	BNT7326	Idle Gear B
BNT5177	Handle Nut Plate	BNT7283	Handle Assembly	BNT7327	Idle Gear D
BNT5182	Star Drag Nut	BNT7284	Cast Control Cap Assembly	BNT7328	Washer
BNT5184	Cast Control Click Plate	BNT7285	A Side Plate Assembly	BNT7329	B Side Plate Cam Lever
BNT5185	Click Pin Holder	BNT7286	Line Guide Pawl Holder Assembly	BNT7330	Washer
BNT5186	Cast Control Click Holder	BNT7287	Washer	BNT7331	B Side Plate Seal
BNT5194	Worm Bushing A	BNT7288	Frame Assembly	BNT7332	B Side Plate
BNT5196	Level Wind Guide	BNT7289	Magnet Holder Assembly		
BNT5198	Level Wind Guard	BNT7290	Spool Assembly		
BNT5199	Worm Bushing B	BNT7291	Dial Case Assembly	BNT7333	Wrench (Accessory)