



VTD-TTAD24R2F
VTD-TTAD30R2V
**2.1 Megapixel Outdoor HD-TVI/
AHD/CVBS IR Dome Cameras**



FEATURES

- 1/3" 2.1 MegaPixel CMOS Sensor
- HD-TVI & AHD/CVBS Video Output
- 3.6mm Fixed Iris Lens (VTD-TTAD24R2F) / 2.8~12mm Varifocal Lens (VTD-TTAD30R2V)
- 24 Infrared LED's with 70' IR Range (VTD-TTAD24R2F) / 30 Infrared LED's with 100' IR Range (VTD-TTAD30R2V)
- Digital Wide Dynamic Range (D-WDR)
- True Mechanical Day/Night function by ICR
- 3D-DNR Noise Reduction
- IP66 Weather Resistance
- Supports Up The COAX Control
- Over 1500' HD Video Transmission (Depending on cable characteristics and integrity)
- 12VDC Operation



VITEK

Safety Precaution

- To prevent electrical shock and risk of fire hazards, do not expose this unit to rain or moisture and only use specified power source..

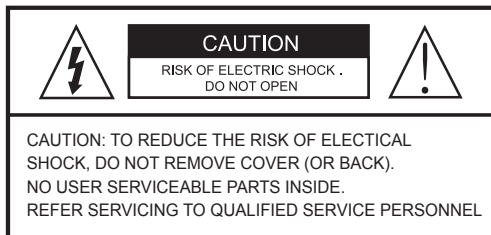

The symbol is intended to alert the user to the presence of uninsulated "dangerous voltage" within the product's enclosure that may be of sufficient magnitude to constitute a risk of electrical shock.



The symbol is intended to alert the user to the presence of important operating and maintenance (servicing) instructions in the literature accompanying the unit.





• Warning :

This equipment has been tested and found to comply with the limits for a Class A digital device, pursuant to part 15 of the FCC Rules. These limits are designed to provide reasonable protection against harmful interference when the equipment is operated in a commercial environment. This equipment generates, uses, and can radiate radio frequency energy and, if not installed and used in accordance with the instruction manual, may cause harmful interference to radio communications. Operation of this equipment in a residential area is likely to cause harmful interference in which case the user will be required to correct the interference at their own expense.

• Caution :

Any changes or modifications in construction of this device which are not expressly approved by the party responsible for compliance could void the user's authority to operate the equipment.
Main power quality should be that of a typical commercial environment. If the user of the model requires continued operation during power interruptions, it is recommended that the device be powered from an uninterruptible power supply (UPS).

Components and Accessories

Camera		Screws	
User Manual		Hex Wrench	
Drill Template			

Overview

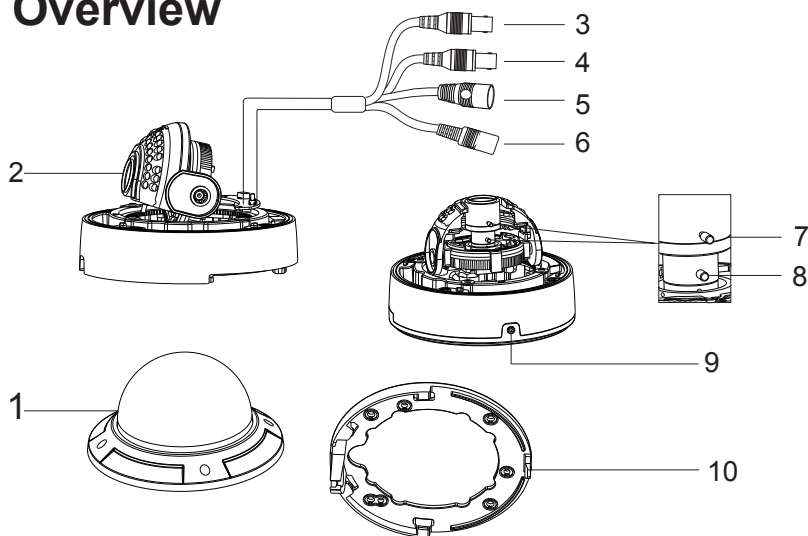

1	Lower Dome	5	Power Cable
2	Lens	6	Focus
3	HD-TVI Output	7	Zoom
4	AHD/CVBS Output	8	Lock Screw

Video Connection

Connect the video connector to a BNC patch cable.

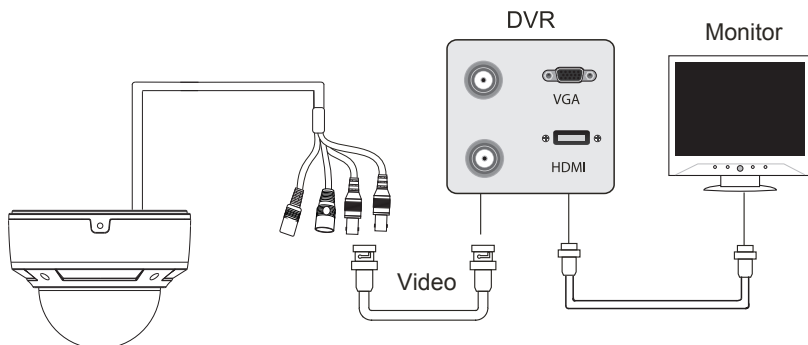

AHD/CVBS Switch:

Switch to CVBS Mode: Press & Hold the Switch for 5 seconds

Switch to AHD Mode: Press & Release the Switch quickly

Power Connection

Connect the power connector to a 12 VDC power adaptor.

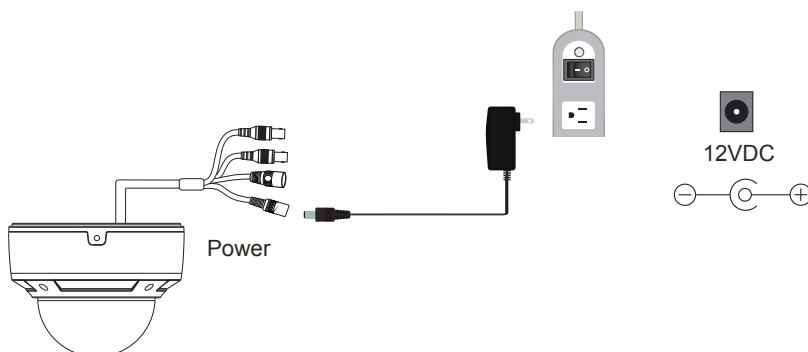

Installation

Before you begin, please make sure that the wall or ceiling is strong enough to withstand 3 times the weight of the camera. The mounting steps are as follows:

1. Loosen the screws to open the lower dome and then loosen the lock screw to remove the mounting base.

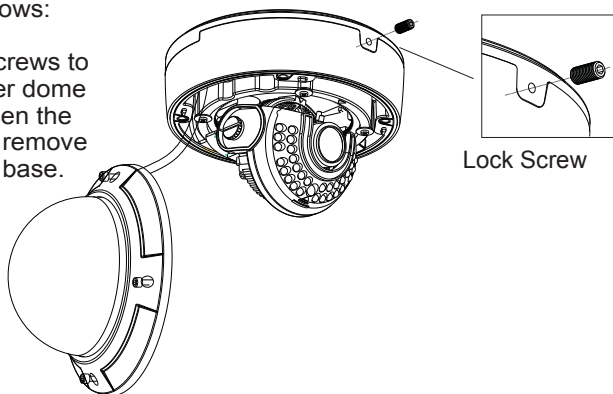

2. Attach the drill template to the place where you want to install the camera, then drill 4 screw holes and 1 cable hole (if you want to route the cables through the mounting base) according to the drill template.

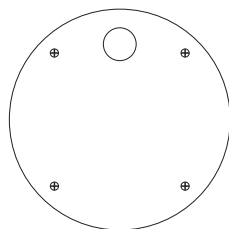

3. Route the cables and connect the power & video cables, then secure the mounting base to the ceiling or wall with screws.

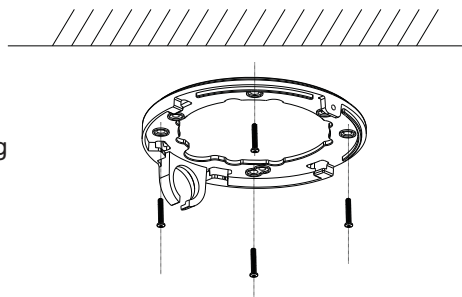

Installation

4. Install the camera to the mounting base with the lock screw.

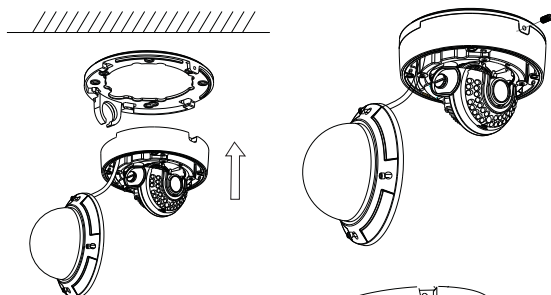

5. Adjust the Three-axis camer bracket to obtain the optimum viewing angle.

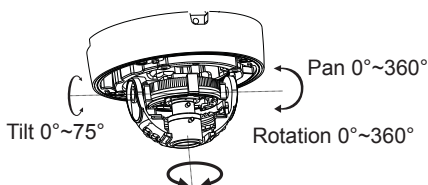

6. Adjust the Focus and Zoom screw to achieve a clear image.

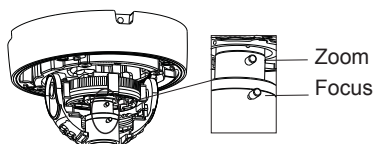

7. Install the dome bubble on the camera with the screws, then carefully remove the protective film to complete the installation.

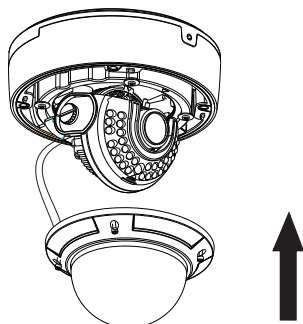

Camera OSD Menu

The Transcendent HD-TVI/AHD camera series must be connected to a DVR which supports HD-TVI/AHD video signal input and COC protocol to access the OSD setup menu. Different DVRs manufacturers may have different modes of menu operation.

The following menu toolbar will pop up by right-clicking the mouse when using VITEK Transcendent Series HD-TVI DVRs.



You will see the following interface by clicking the  button.

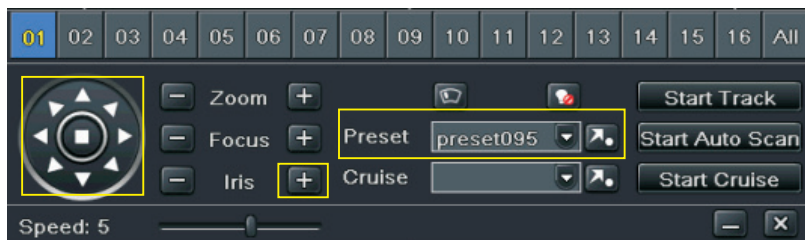

Click “Iris +” to go to the main menu. You can also select preset NO. 95, then click the  button (call preset NO.95) to go to the following main menu.

MAIN MENU

▶ 1. LENS	MANUAL
2. EXPOSURE	↵
3. BACKLIGHT	OFF
4. WHITE BAL	AWB
5. DAY&NIGHT	EXT ↵
6. NR	↵
7. SPECIAL	↵
8. ADJUST	↵
9. EXIT	SAVE&END ↵

You can select the menu by clicking ▲ (U) or ▼ (D) key on the direction area. Click ◀ (L) or ▶ (R) key to select the menu on the left. The menu with arrow icon which means it has sub-menu. You can select the menu and click “Iris +” or call preset NO.95 to enter the sub-menu. To return to the previous menu or exit the main menu, please select “RET” or “Save & END” by clicking U or D key and then click “Iris +” or call preset NO.95.

Detailed Specifications	VTD-TTAD24R2F	VTD-TTAD30R2V
Image Sensor	1/3" 2.1 MegaPixel CMOS Sensor	
Resolution	1080p (2.1 MegaPixel)	
Effective Pixels	1920(H) x 1080(V)	
Signal System	PAL/NTSC	
Video Output	1x HD-TVI (BNC) & 1 AHD/CVBS (BNC)	
Lens	3.6mm Fixed	2.8~12mm (Vari-Focal)
Day/Night	True Day/Night by ICR	
S/N Ratio	>52dB (AGC OFF)	
Auto Gain Control	OFF ~44.8dB	
Min Illumination	0 Lux (LED ON)	
IR LEDs	24	30
IR Distance	70'	100'
Color-B/W Auto Switch	Yes	
Electronic Shutter	1/50s ~ 1/67500s	
White Balance	AWB	
WB Range	2300~9600K	
BLC	Yes	
WDR	Digital WDR	
Transmission Distance	Up to 1500' (Depending on cable characteristics & integrity)	
Up the COAX Control	YES	
Noise Reduction	Yes	
Weather Resistance	IP66	
Power Supply	12VDC	
Working Environment	-4~122 / 10%~90% Humidity	
Weight	21.34 oz. / 1.33 lbs. / 605g	34.22 oz. / 2.14 lbs. / 970g
Dimensions	4.57" x 3.58" (116mm×91mm) Dia x H	5.91" x 4.49" (150 x 114mm) Dia x H



VT-TWM03
Optional Wall Mount
with cable feed
through (for VVTD-
TTAD30R2V only)

LIMITED PRODUCT WARRANTY

VITEK products carry a three (3) year limited warranty. VITEK warrants to the purchaser that products manufactured by VITEK are free of any rightful claim of infringement or the like, and when used in the manner intended, will be free of defects in materials and workmanship for a period of three (3) years, or as otherwise stated above, from the date of purchase by the end user. This warranty is nontransferable and extends only to the original buyer or end user customer of a VITEK Authorized Reseller.

The product must have been used only for its intended purpose, and not been subjected to damage by misuse, willful or accidental damage, caused by excessive voltage or lightning.

The product must not have been tampered with in any way or the guarantee will be considered null and void.

This guarantee does not affect your statutory rights.

Contact your local VITEK Reseller should servicing become necessary.

VITEK makes no warranty or guarantee whatsoever with respect to products sold or purchased through unauthorized sales channels. Warranty support is available only if product is purchased through a VITEK Authorized Reseller.



28492 CONSTELLATION ROAD VALENCIA, CA 91355
WWW.VITEKCCTV.COM

Version 2.0
June 2016