

PEDESTAL BASE FOR SILVER SCREEN POPCORN MACHINES

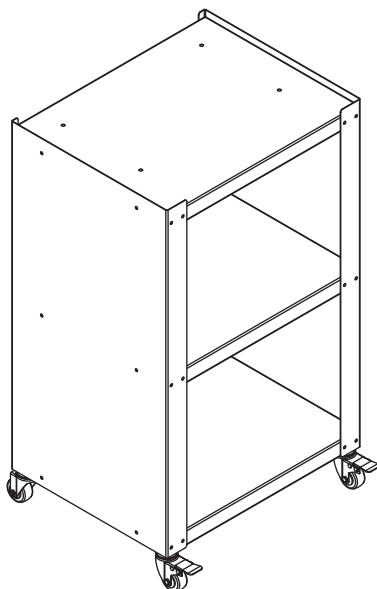

CONTENTS

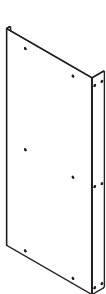

1 x Left Side Panel

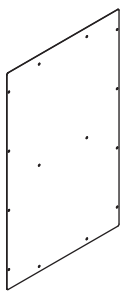

1 x Back Panel



1 x Right Side Panel

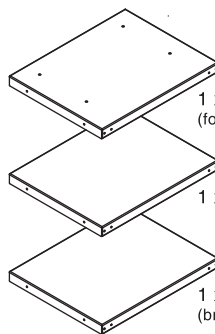

1 x Top Shelf
(four holes on surface)

1 x Middle Shelf

1 x Bottom Shelf
(brackets for casters)

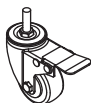

4 x Casters
(2 x Brake and 2 x w/o Brake)



38 x Screws



4 x Bolts



4 x Wing Nuts

DO NOT TIGHTEN SCREWS UNTIL FULLY ASSEMBLED

1 ATTACH SIDE PANELS

- Attach the **left and right side panels** to the **top shelf**, **middle shelf**, and **bottom shelf** with **screws**.
- Continue to secure the **left and right side panel** with additional **screws** from the front.

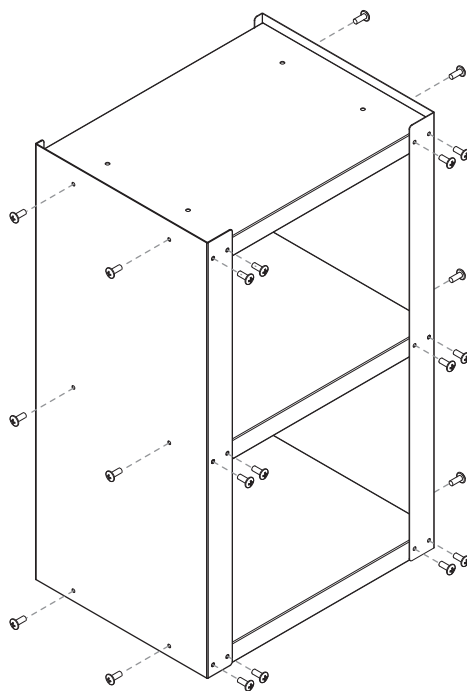

DO NOT TIGHTEN SCREWS UNTIL FULLY ASSEMBLED

2 ATTACH BACK PANEL

- Attach the **back panel** to the pedestal with **screws**.

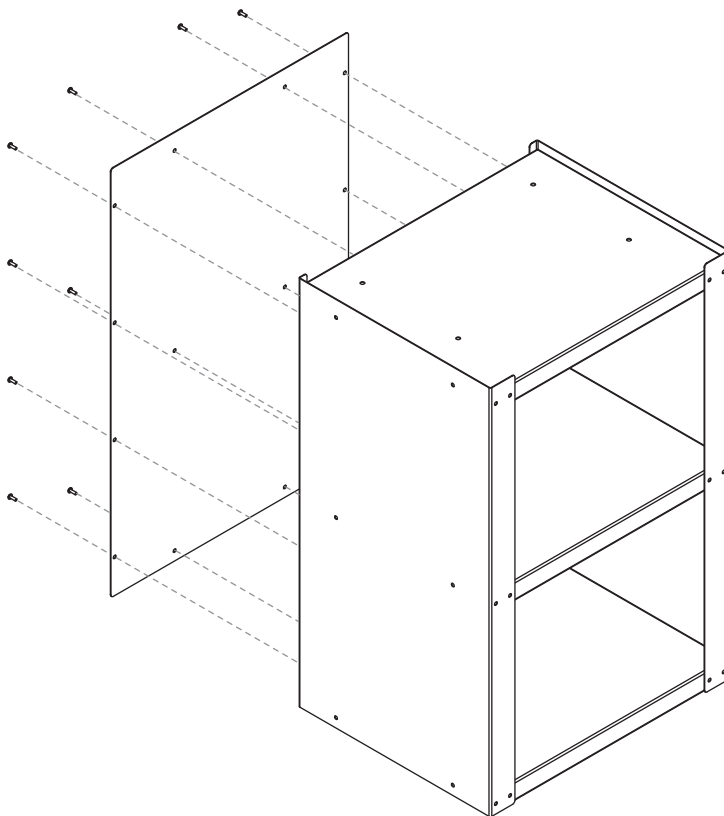

3 ATTACH CASTERS

- Twist the **casters** to the **bottom shelf**.

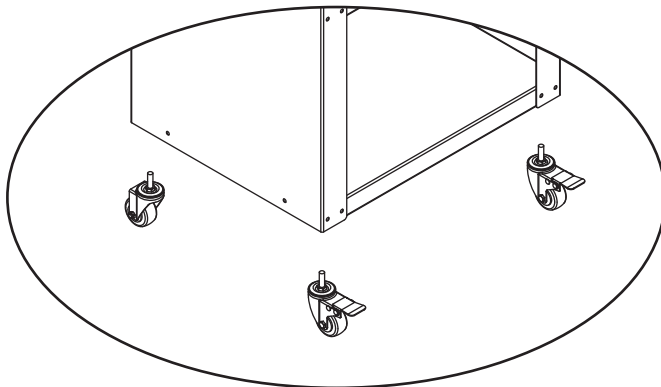

4 FINAL CHECK

- Stand the pedestal upright on a level surface/floor.
- Ensure casters are touching the floor evenly.
- Firmly tighten all screws to ensure they are secure.

5 SECURE THE POPCORN MACHINE

- Place the popcorn machine on top of the pedestal.
- Open the popcorn machine and remove the drop door and clean out tray.
- Locate the holes on the bottom of the popcorn machine and secure to the pedestal with **bolts** and **wing nuts**.

