

BOSS[®]
AUDIO SYSTEMS

 **Bluetooth**[®]

SB18BRGB **USER MANUAL**
BLUETOOTH[®] | 18" AMPLIFIED SOUND BAR
FEATURES BUILT-IN CLASS A/B AMPLIFIER
AND MULTICOLOR ILLUMINATION OPTIONS



1

Thank you for purchasing this

BOSS[®]
AUDIO SYSTEMS

SB18BRGB Sound Bar

Please read through these instructions carefully so you will know how to operate your model properly.

After you have finished reading the instructions, keep this document in a safe place for future reference.

THIS PACKAGE CONTAINS

1x SB18BRGB sound bar



Mounting kit



1x 12V power port plug adapter



1x Remote control + 1x keychain



1x User manual + 1x Warranty card

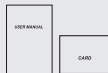

IMPORTANT

Please enter below the Serial No. which is located on the exterior of the product. Retain this information for future reference.

Model _____

Serial No. _____

Date of Purchase _____

Read and understand all instructions before you use your product. If you do not follow the instructions in this manual, we are not responsible for injury or damage resulting from improper handling. This will also void the warranty.

Important Safety Precautions

- **Be sure to observe the following guidelines:**
 - Do not increase speaker volume so high that you cannot hear what is around you.
 - Use caution or temporarily discontinue use in potentially hazardous situations.
- Do not make any adjustment on the product when driving or in other situations where distractions can be hazardous. Responsible and safe driving is your primary responsibility when operating a vehicle.
- Start volume at a low setting then gradually increase the volume until you can hear it comfortably, without sound distortion and ear discomfort.
- In the event of smoke, strange noise or odor emitted from the product or any other abnormal operational signs appearing on the product, disconnect the product from the power supply. Discontinue use and contact your dealer or our technical support. Using the product in this condition may result in permanent damage to the system.
- Servicing must only be carried out by a technician. Contact our technical support for any service question.

Installation Precautions

- **WARNING: Always consult a professional installer.**
- Installation must be performed by a professional. Contact our technical support for any installation questions.
- Observe the safety and operating instructions of the devices which are connected to the product.
- Only use attachments/accessories specified by the manufacturer for installation.
- Do not modify this product, as this affects the safety of the product. Risk of injury or damage to the product.
- Before installation, disconnect the negative terminal of the vehicle battery to prevent damage to the product, fire, and/or possible injury.

Care for Your Product

- **DO NOT** clean the product in hot weather (e.g. hot sunlight).
- **DO NOT** use abrasive or highly alkaline cleaner on the product.
- **DO NOT** use gasoline, acetone, carbon tetrachloride or other aggressive chemical solutions on the product.
- **DO NOT** scrape the product with razor blade or other sharp instrument.
- **DO NOT** use a pressure washer or pressurized water.
- This product is water resistant. However, never submerge the product in water.

Introduction

The product is a Bluetooth speaker system which is ideal for installation in an ATV (All Terrain Vehicle) or UTV (Utility Vehicle). You can stream audio from a mobile phone to this product via Bluetooth. You can also play music files stored in a USB flash drive, and music from an external device (e.g. a mobile phone or MP3 player) can be played via 3.5 mm AUX input jack.

You can output audio from the sound bar to an external amplifier or powered speakers through RCA output.

The product is integrated with LED lights which can be controlled using the supplied lighting controller.

This product is shockproof and water resistant. This product is designed to be operated with 10-16 VDC negative ground vehicle power supply only. Never connect this product to any other voltage supply (e.g. 24 VDC).

Product Overview

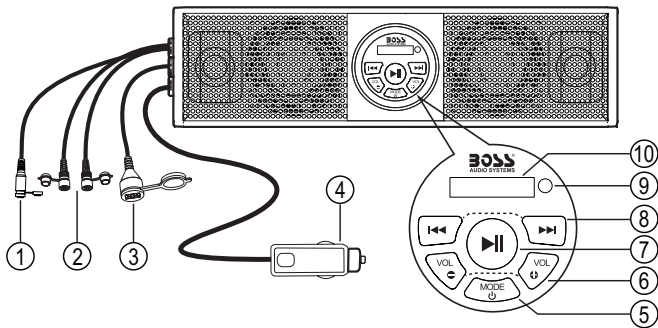

- | | |
|---|--|
| 1 3.5mm audio input jack | 6 Volume buttons |
| 2 RCA audio output sockets | 7 Start/pause/resume play button |
| 3 USB port | 8 Track selection buttons |
| 4 12V power port plug with 10A fuse | 9 Remote sensor (aim the remote control directly at the sensor when using the remote controller) |
| 5 Power button (hold down to power on or off);
Mode button | 10 Display |

Mounting on ATV or UTV



Always consult an expert when in doubt about the installation.

You must work with an assistant to mount the sound bar due to its heavy weight.

Use only the supplied accessory for mounting. Using other mounting methods may void the warranty.

To ensure security of the mounted sound bar, always check the mounting conditions (e.g. clamp fastening) of the sound bar before each vehicle ride.

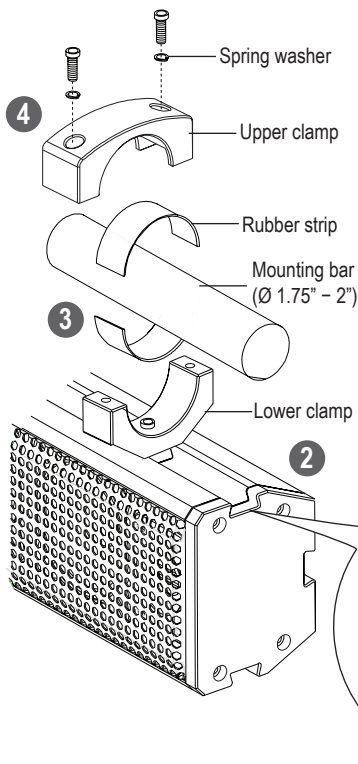

1. With correct orientation, attach a sliding block to the lower part of a clamp using a proper hex wrench (not included). Make sure not to tighten the block for subsequent insertion into the channel.
2. Find the sliding channel (groove) on the top panel of the sound bar. Correctly orient the sliding block and insert it into the channel from either end of the channel. Then slide the clamp to a proper position and tighten it with a hex wrench.
3. Attach the supplied rubber pads for secure clamping and abrasion prevention.
4. Tighten the upper clamp to the lower clamp with a hex wrench. Make sure the supplied spring washers are used to provide more stable bolt tightening against vibration.

Repeat the steps above to secure the sound bar with the other clamp.

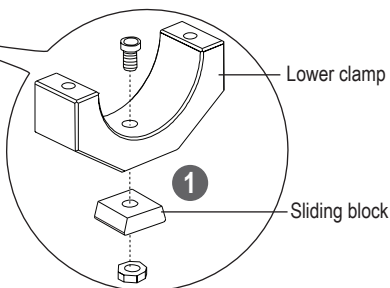

Option 1: Using Power Port

If your vehicle has a 12V power port, directly connect the sound bar to your vehicle for power connection.

1. Insert the 12V power port plug of the sound bar into your vehicle power port. When the power supply is connected, the power LED indicator illuminates on the power port plug.

Note: To avoid battery drain, it is recommended to unplug after each use (if the port power is not switched off with the ignition key).

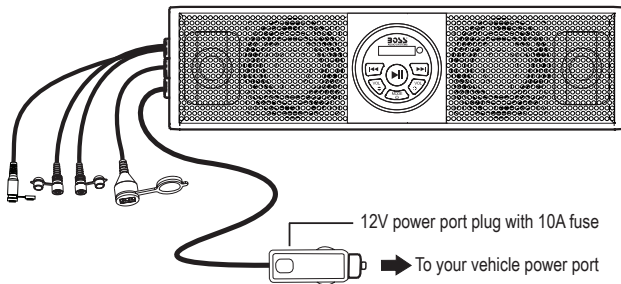

Option 2: Using Power Port Plug Adapter

If your vehicle does not have a 12V power port, use the supplied power port plug adapter for connection to your vehicle battery.

Important:

- To avoid short circuits and any resulting damage to the sound bar, the negative terminal of the vehicle battery must be disconnected first.
1. Connect the black/ground wire of the power port plug adapter to the vehicle's metal frame or to the negative battery terminal. Fasten the ground wire with a bolt/screw on the metal surface. Make sure the metal surface is clean with no paint, rust or dirt.
 2. Connect the red wire of the power port plug adapter to the positive battery terminal.
If needed, use extension wires of 12-14 gauge for connection to the battery. **Remember to install a 15A in-line fuse (not included) and an on/off switch (not included).** An on/off switch is not needed if you unplug the sound bar after each use or if the vehicle power port is turned off with the ignition key. Refer to the illustration.
 3. Insert the power port plug of the sound bar into the power port plug adapter.
When the power supply is connected, the power LED indicator illuminates on the power port plug.

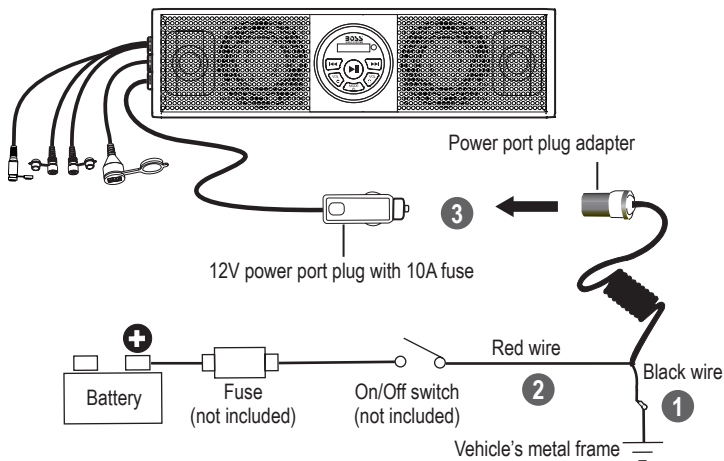



Option 3: Direct connection to vehicle battery

Important:

- To avoid short circuits and any resulting damage to the sound bar, the negative terminal of the vehicle battery must be disconnected first.
- Remove the plug from the supplied power port plug cable.
 - Connect the power port plug's negative wire to the vehicle's metal frame or to the negative battery terminal, and the power port plug's positive wire to the positive battery terminal.
- To prevent electrical damage, you must install **1) a 15A fuse (not included)** and **2) an on/off switch (not included) to be in line with the power wire which connects to the positive battery terminal.**
 - Fasten the ground wire with a bolt/screw on the metal surface. Make sure the metal surface is clean with no paint, rust or dirt.

Turn on or off

- Press and hold  on the sound bar (or on the remote control) to turn on or off the sound bar.
- Press briefly  on the remote control to turn on or off the LED lights.

➔ To avoid battery drain when the sound bar is not used, disconnect the sound bar from the battery by unplugging the power port plug or using the inline on/off switch (not included).

Before you can stream music from your mobile device (iOS device or Android device) to the sound bar through Bluetooth, pair the sound bar with your mobile device.

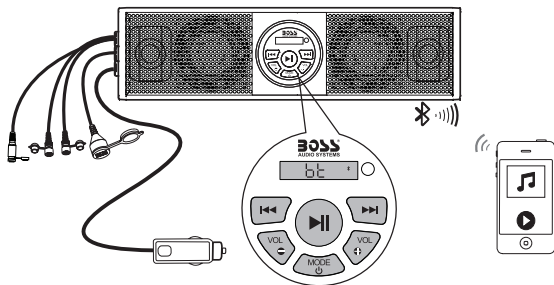

1. The sound bar automatically switches to Bluetooth mode when turned on. "bt" appears and flashes to indicate that the sound bar enters pairing mode.
If Bluetooth mode is not activated, press **MODE**  briefly to select Bluetooth mode.
2. On your mobile device, enable Bluetooth function and select the device name ("Boss Audio SB18BRGB") to pair the sound bar with the mobile device. If prompted for password, enter "0000".
If no Bluetooth device is paired within ten minutes, the sound bar will automatically exit pairing mode. In this case, you need to repeat the steps above to re-enter the pairing mode.
Note: Only one device can be paired at a time.
3. When successfully paired/connected, "bt" on the display stops flashing and lights up. Play audio on your mobile device, and audio will be streamed to the sound bar.
After pairing, the sound bar will be automatically connected to your mobile device each time the two are turned on. To connect a second mobile device, disconnect the current Bluetooth connection by holding down **▶||** for two seconds then repeat the steps above for pairing.

Playback control

- To pause or resume play, press **▶||**.
- To select the previous or next track, press **◀◀** or **▶▶**.
- To adjust volume, press **VOL +/-**.

➔ To maximize audio performance, set the volume of the connected device to a minimum of 75%. Ideally, on the highest volume setting you can get without distortion.

To avoid battery exhaustion, make sure to run the vehicle engine when operating the sound bar.

Operational range can be reduced by any obstacle between the sound bar and the device.

If the connected device is out of the effective range from the sound bar, the device will be automatically disconnected. The device will be automatically re-connected if it is back to the effective range.

You can listen to an external audio device (e.g. MP3 player or a mobile phone) through the sound bar.

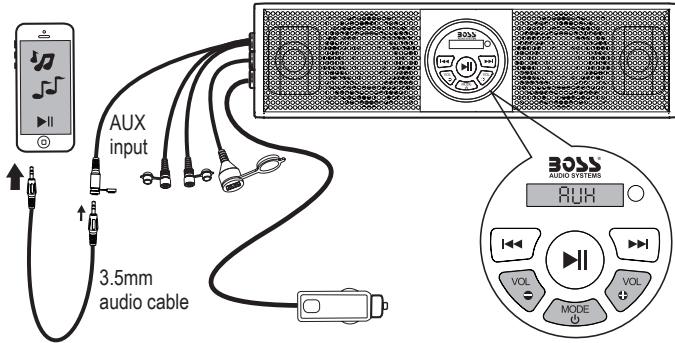

1. Using an audio cable with 3.5mm plug (not included), connect the AUX input (3.5 mm) from the sound bar to the headphone jack on your audio device.
2. The sound bar automatically switches to AUX mode when AUX connection is made. "AUX" is displayed. If AUX mode is not activated, press **MODE**  briefly to select AUX mode.
3. Select and play audio files on your audio device. Audio from the connected device will be played on the sound bar.

➔ To maximize audio performance, set the volume of the connected device to a minimum of 75%. Ideally, on the highest volume setting you can get without distortion.

Operating the sound bar consumes the vehicle battery. To avoid battery exhaustion, make sure to run the vehicle engine when operating the sound bar.

Playback control

- To pause or resume play, press **▶||**.
- To adjust volume, press **VOL +/-**.
- To select the previous or next track, use the controls only on the connected device.

You can enjoy audio stored on a USB storage device through the sound bar.

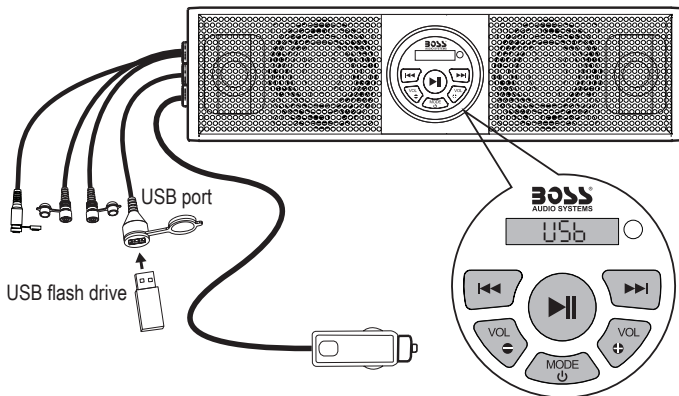

1. Connect a USB flash to the USB port from the sound bar.
2. The sound bar automatically switches to USB mode when USB connection is made. "USB" is displayed briefly.

If USB mode is not activated, press **MODE**  briefly to select USB mode.

Music plays automatically.

- ➔ MP3 and WMA files are playable. The USB port can provide 1A current for mobile device charging. Operating the sound bar consumes the vehicle battery. To avoid battery exhaustion, be sure to run the vehicle engine when operating the sound bar.

Playback control

- To pause or resume play, press **▶||**.
- To select the previous or next track, press **◀◀** or **▶▶**.
- To adjust volume, press **VOL +/-**.

You can output audio from the sound bar to an external amplifier or powered speakers through RCA output.

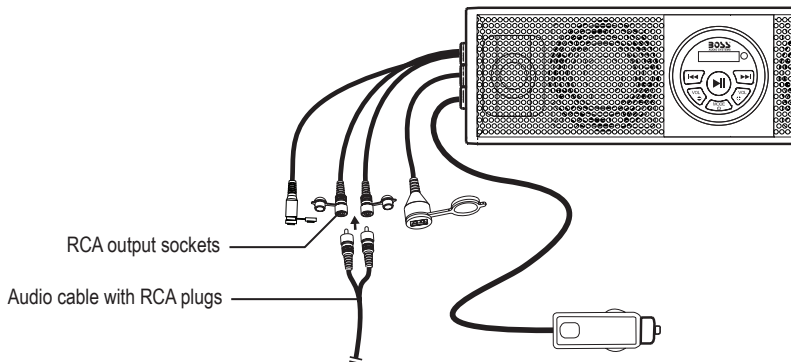

Fuse Replacement

If the power LED indicator on the power port plug does not illuminate, this indicates the fuse inside the power port plug is blown. Replace the blown fuse with a new 10A AGC fuse (glass cartridge type).

1. Locate the screw cap on the front end of the power port plug. Turn counterclockwise the screw cap to open then access the fuse inside.
2. Replace with a new fuse (not included). Then replace the power port plug while ensuring the contact head sticks out.

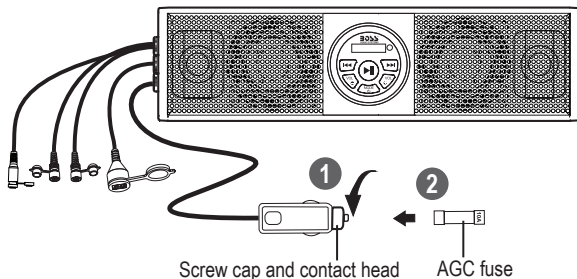

The sound bar comes with a remote control. You can use the remote control to control both music playback and the LED lights which are integrated with the sound bar.

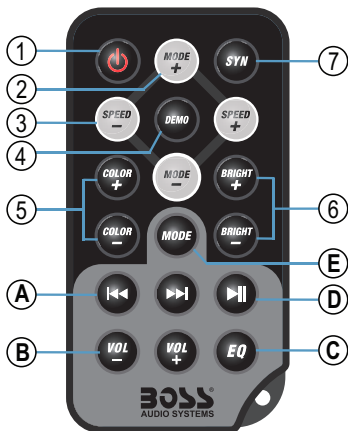

Light control buttons

1. Press and hold to turn the sound bar on or off.
Press briefly to turn lights on or off.
2. **MODE +/-** Switch from static to dynamic illumination and select a dynamic illumination pattern.
3. **SPEED +/-** For dynamic illumination, select a dynamic illumination speed.
4. **DEMO** Cycle red, green and blue illumination.
5. **COLOR +/-** Switch from dynamic to static illumination and select an illumination color.
6. **BRIGHT +/-** For static illumination, change the illumination intensity.
7. **SYN** Enable or disable lights flashing to music. When enabled, **SPEED** buttons are invalid.

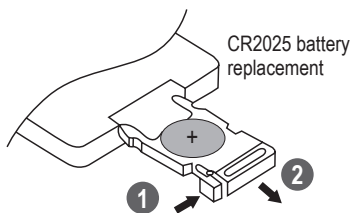

Playback control buttons

- A. For Bluetooth and USB, select the previous or next track.
- B. **VOL +/-** Increase or decrease volume.
- C. **EQ** For Bluetooth and USB, select a preset sound mode.
- D. Start, pause or resume music play.
- E. **MODE** Select a mode (Bluetooth, AUX and USB).

Important notes on battery

- Observe correct polarity while inserting the battery. Replace only with the same type or equivalent type.
- Do not leave the battery under direct sunlight. This may cause fire, explosion or excessive heat.
- Remove the battery from the remote control if not used for a long period of time.
- The remote control contains a coin/button type battery, which is a choke hazard. Keep the battery out of reach of children at all times! If swallowed, the battery can cause serious injury or death.

If you have problems using this product, check the following points before you request service. If you still have a problem, contact our technical support.

Problem	Solution
No power.	Power connection is not made. See the section "Power Connection" for details.
	The ACC switch of the vehicle is not on. Turn the ACC switch on.
	The fuse inside the power port plug is blown. Replace the fuse.
No sound.	Press MODE to select the correct audio input.
	Check the connected device for volume level or playback status (e.g. pause or stop).
Cannot connect through Bluetooth.	The device is not paired with the sound bar. Pair the two (see "Bluetooth" section).
	Bluetooth on the device is disabled. Refer to the device's user manual on how to enable Bluetooth.
	Make sure the device is within range.
	The sound bar is already connected with another Bluetooth device. Disconnect the current Bluetooth connection.
	Bluetooth has been disconnected for more than seven minutes, manually reconnect Bluetooth through your mobile device.
Audio quality from Bluetooth connection is poor.	Move the device closer to the sound bar or remove obstacles or sources of interference that are affecting Bluetooth reception.
No response.	Power glitch or interference. Disconnect power for ten seconds then reconnect power.

Environmental Care

Do not throw away the product with normal household waste at the end of its life. Follow your local laws *if/when* disposing of electronic products. By doing this, you help preserve the environment.

Bluetooth

Bluetooth version.....	5.0 / EDR
Bluetooth profiles.....	A2DP, AVRCP
Bluetooth frequency.....	2402 - 2480 MHz
Transmission power.....	<4 dBm
Transmission distance.....	up to 33 ft / 10 m (line of sight)

Speakers

High power speaker	2 x 4" (102 mm)
Tweeter.....	2 x 1" (25 mm), soft dome

Amplifier

Amplifier class	Class A/B, full range
Input impedance.....	10 kΩ
Frequency response.....	45 Hz - 22 kHz

Connectivity

USB	USB-A, MP3/WMA playable; USB charging (1A)
AUX	3.5 mm jack for audio input
RCA	RCA sockets for audio output

General

Input voltage.....	12 VDC (allowable 10 - 16 VDC)
Current draw.....	6A MAX
Fuse.....	10A AGC type
Clamp size range (O.D.).....	1.75" - 2"
Weight	8.2 lbs / 3.7 kg

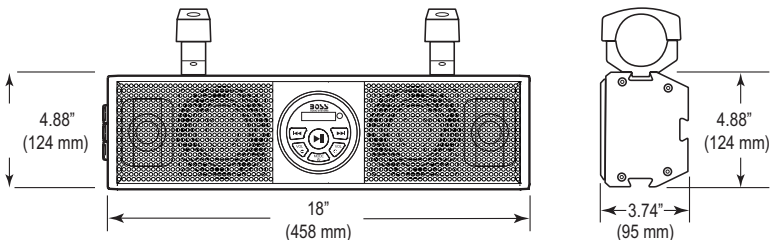
Dimension drawing

BOSS[®]
AUDIO SYSTEMS



BOSS Audio Systems
3451 Lunar Court • Oxnard, CA 93030
www.bosssaudio.com
805-751-4853 Customer Service
Tech Support: www.bosssaudio.com/support



0522

The Bluetooth® word mark and logos are registered trademarks owned by Bluetooth SIG, Inc. and any use of such marks by BOSS Audio Systems is under license. Other trademarks and trade names are those of their respective owners.