

Adventure Starts Here.

48" DINING BENCH

**SEAHAWK
DESIGNS**

EST. 2005

! NOTICE

- Do not overtighten hardware.
- Do not exceed the weight capacity of this item.
- Only use this item for what it is intended for, improper use will void any warranty.
- Firmly secure all bolts, screws and nuts before use.
- Reconfirm that all bolts, screws, and nuts are firmly secured every 90 days.
- Keep this furniture clear of all uncontrolled open flames or flammable/combustible materials. Exposure to fire, high heat, or embers will permanently damage the material.
- To avoid stripping and cracking of the material, DO NOT use power tools for assembly.
- Always prioritize caution and safety throughout the assembly process.

TOOLS REQUIRED

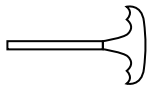

ALLEN WRENCH
(PROVIDED)

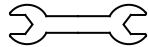

WRENCH
(PROVIDED)



660 LBS
WEIGHT
CAPACITY



SUGGESTED
1 PERSON
ASSEMBLY



ESTIMATED
ASSEMBLY
TIME: 20 MIN

1

SCREW
M6 x 60mm

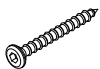

2 PCS

2

SCREW
M6 x 70mm



4 PCS

3

SCREW
M6 x 80mm



4 PCS

4

SCREW
M6 x 50mm

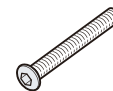

8 PCS

5

M6-NUT



8 PCS

6

M6-WASHER

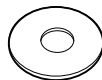

8 PCS

7

SCREW HOLE PLUG



14 PCS

PARTS

REF#: OP2146

A

BENCH SEAT



1 PC

B

BENCH LEG I

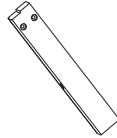

2 PCS

C

BENCH LEG II

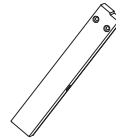

2 PCS

D

SHORT RAIL



2 PCS

E

SPANNER BAR

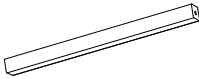

1 PC

F

FOOT BASE

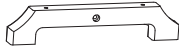

2 PCS

PRODUCT ASSEMBLY - OVERALL VIEW

REF#: OP2146

Please refer back to this image during the assembly process for part placement.

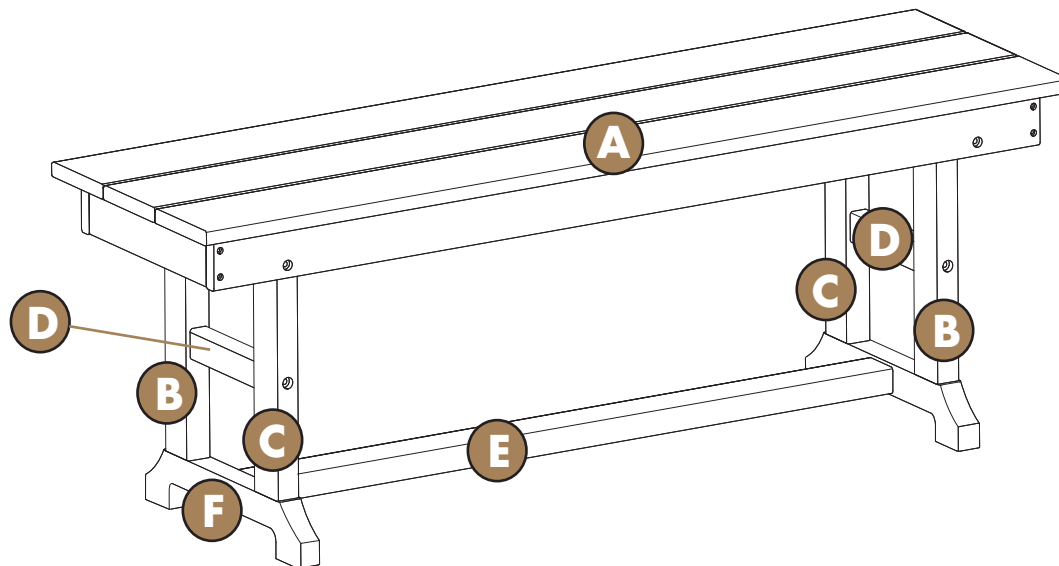

1

Step 1: Assemble the Bench Legs

- Attach **Part B (Bench Leg I)** and **Part C (Bench Leg II)** to **Part D (Short Rail)** using **2 - M6 Screw (#3)** (see image below).
- Do the same to attach another **Part B (Bench Leg I)** and **Part C (Bench Leg II)** to **Part D (Short Rail)**.
- Do not fully tighten the bolts yet. Tighten them to approximately 70% to allow for adjustments during final assembly.

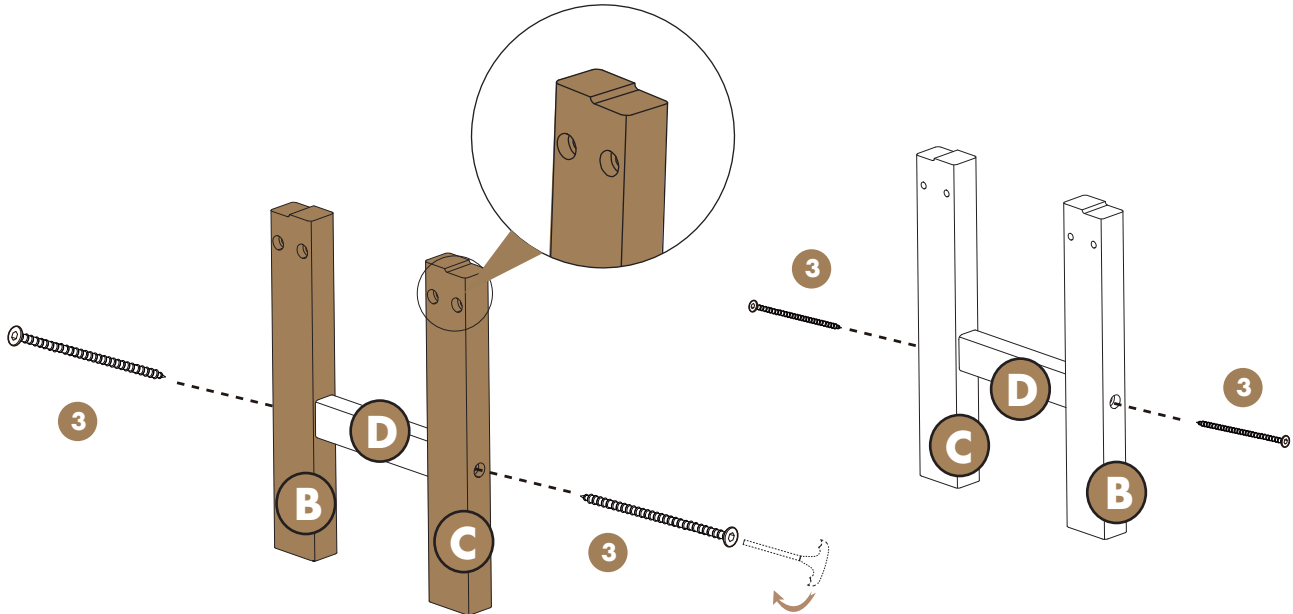

2

Step 2: Attach the Foot Base

- Attach **Part F (Foot Base)** to the **Assembled Legs (Part B, Part C and Part D)** using **2 - M6 Screw (#2)** (see image below).
- Repeat this step to attach the second **Part F (Foot Base)** to the other **Assembled Legs (Part B, Part C and Part D)** (see image below).

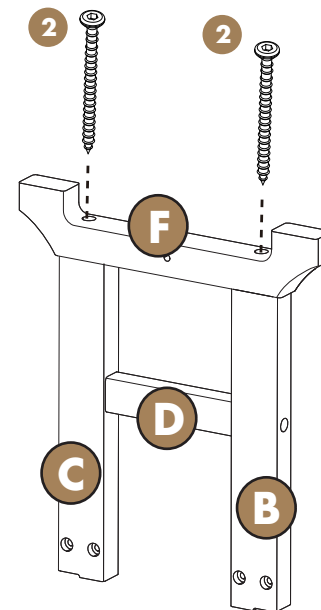
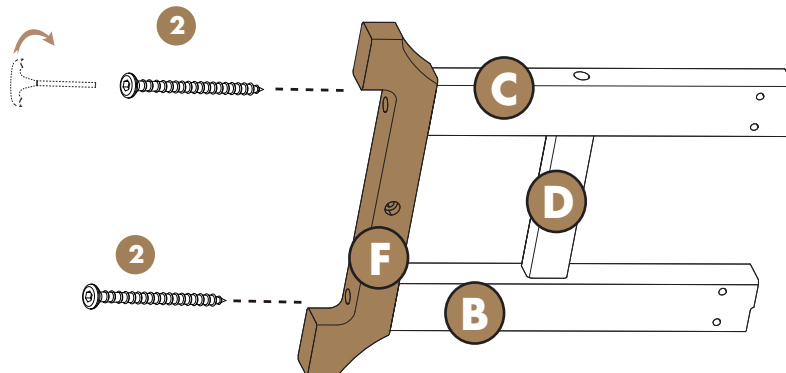

3

Step 3: Attach the Bench Legs to the Bench Seat

- Place **Part A (Bench Seat)** on a flat, stable surface.
- Attach the assembled **Bench Legs (Part B, Part C, Part D and Part F)** to **Part A (Bench Seat)** using **8 - sets** of the **M6 Bolt (#4)**, **M6 Washer (#6)**, and **M6 Nut (#5)** (see image below).

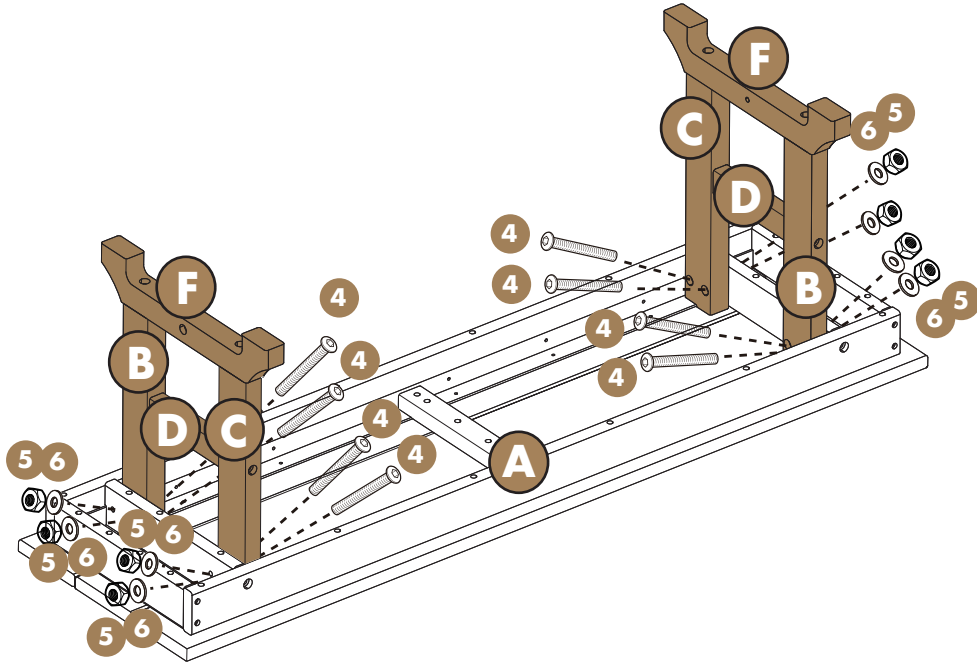

4

Step 4: Attach the Spanner Bar to the Foot Base

- Use **2 - M6 Screw (#1)** to secure **Part E (Spanner Bar)** to **2 - Part F (Foot Base)** (see image below).

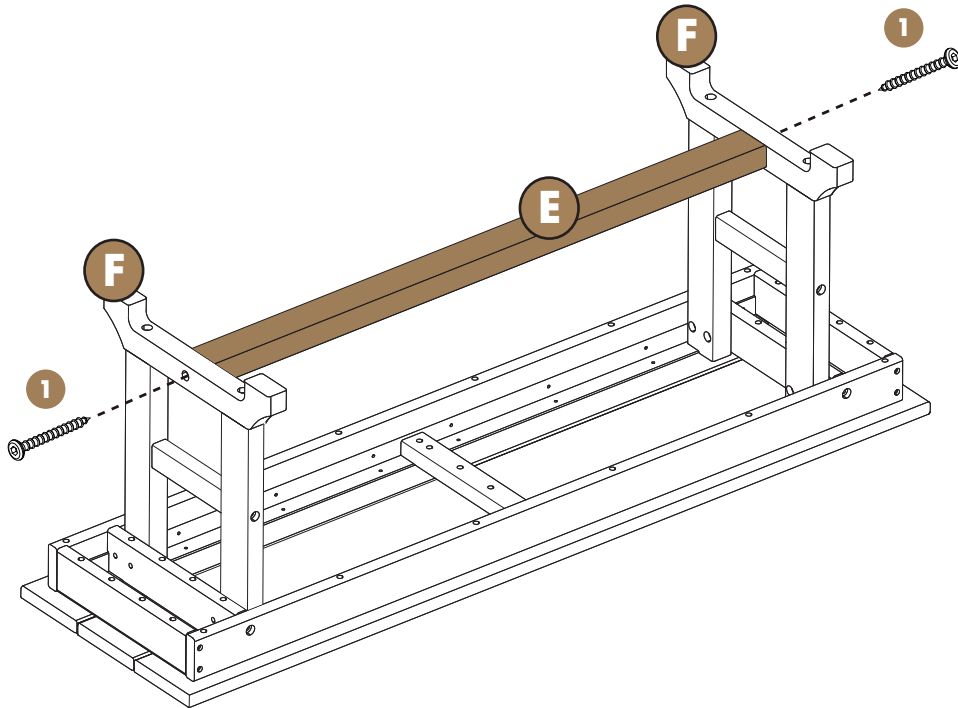

5

Step 5: Final Tightening and Stability Check

- Firmly press down on **Part A (Bench Seat)** to confirm the bench is level and stable. Once stability is confirmed, fully tighten all previously installed screws, bolts, and nuts.

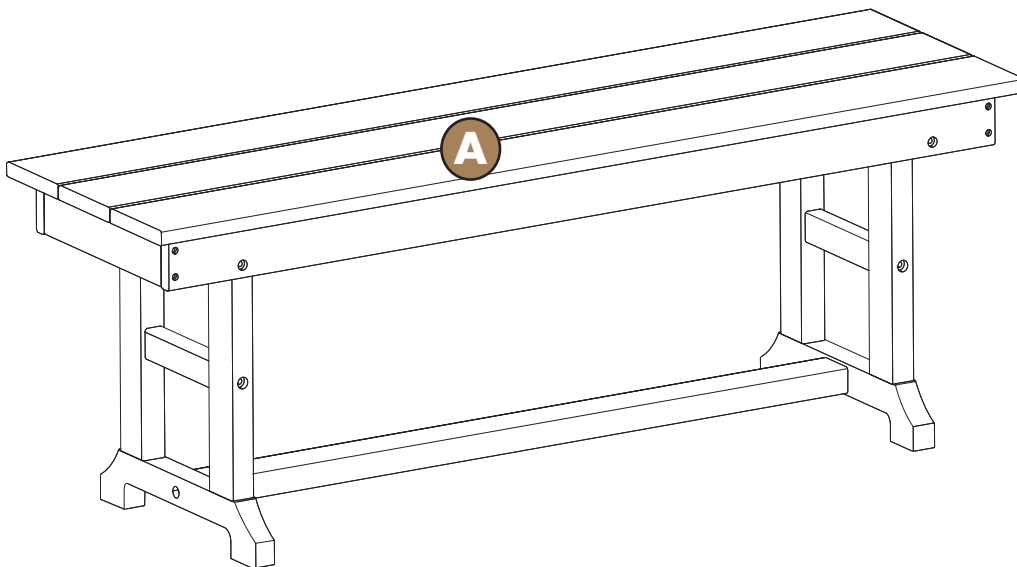

6

Step 6: Apply the Screw Hole Plugs

- Cover all exposed screw holes using **14 - Screw Hole Plug (#7)**. Insert all plugs into the exposed screw holes. Gently tap each plug into place using a rubber mallet to prevent damage. Ensure each plug is fully seated and flush with the bench surface (see image below).

ATTENTION: Do not use a metal hammer as it will damage the poly lumber.

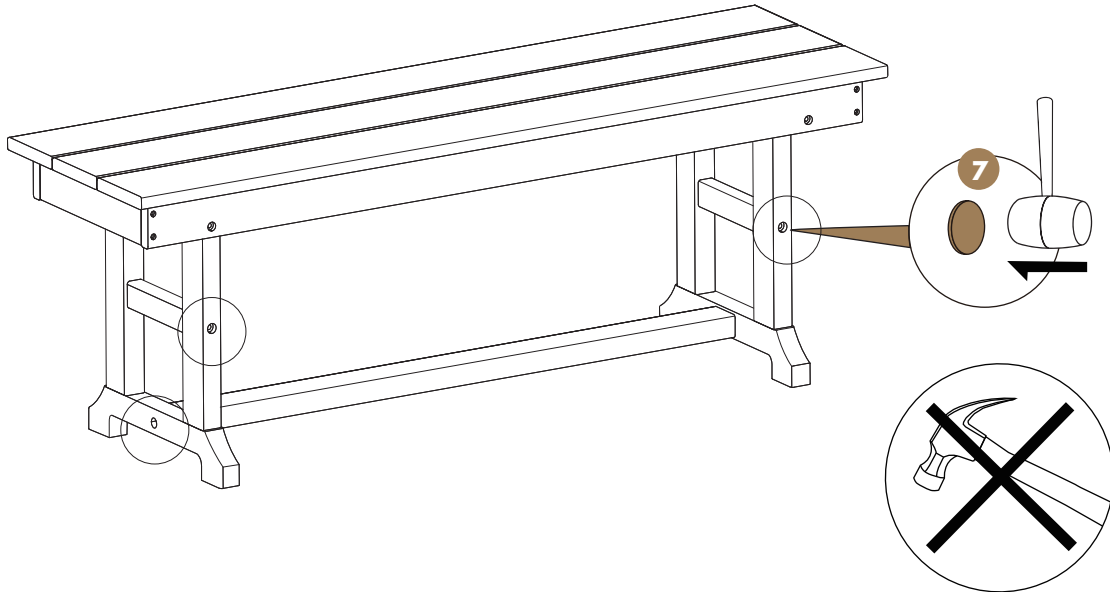

- **REGULAR CLEAN:** Mix **warm water** and **mild soap**. Use a **soft bristle brush** to gently scrub the surface and remove any dirt or stains.
- **QUICK CLEAN:** Simply wipe the furniture down using a damp cloth.

Tip: Cleaning your furniture regularly helps maintain its aesthetic appeal and extends its lifespan.

Enjoy!

Join our community and be the first to see what's new!

Follow us on socials:



Quickly register your outdoor furniture purchase to activate your warranty and enjoy peace of mind with guaranteed product protection:



Have questions or need assistance? Reach out to our dedicated team at **(909) 284-1052** or email us at **cs@seahawkdesigns.com**.