

# F1960 Brass PEX Female Sweat Adapter

Job Name	_____
Location	_____
Engineer	_____
Contractor	_____
Tag	_____ PO# _____

## Specifications

Manufactured to the highest industry standards, Jones Stephens' F1960 lead-free brass cold expansion fittings provide precise, secure, and leak-free connections. Made with DZR brass, F1960 cold expansion fittings are corrosion and chlorine/chemical resistant – making them a great fit for aggressive water environments. Approved for use with PEX-A piping. Can be used with F1960 PEX rings.

## Applications

Jones Stephens' F1960 Brass PEX Female Sweat Adapters are approved for use with commercial and residential non-potable water applications.

## Materials

Lead-free DZR brass

## Certifications/Listings/Approvals

- ASTM F1960-2021
- NSF/ANSI/CAN 61-2021
- NSF/ANSI/CAN 372-2022
- NSF/ANSI 14-2015
- CSA B137.5-2020
- Lead Law Compliant

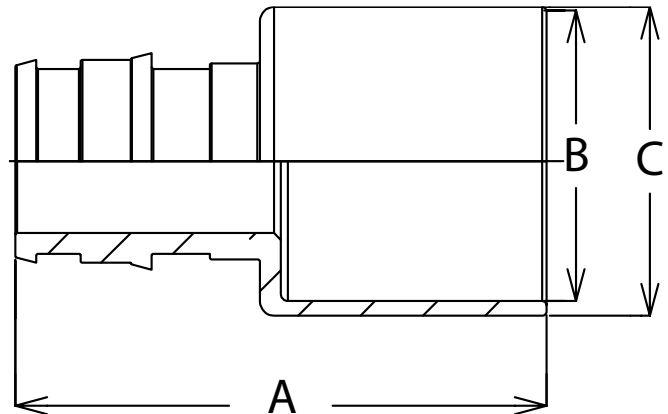

	ID	OD
F1960 Specified Dimensions	in (mm)	in (mm)
1/2" End Connection	.41(10.33)	.61(15.59)
5/8" End Connection	.53(13.40)	.74(18.90)
3/4" End Connection	.62(15.80)	.87(22.10)
1" End Connection	.83(21.00)	1.11(28.10)
1-1/4" End Connection	.80(20.32)	1.36(35.54)
1-1/2" End Connection	1.08(27.43)	1.49(37.85)
2" End Connection	1.56(39.62)	2.08(52.83)

**PRODUCT OFFERING ON PAGE 2**

**Dimensions and Product Offering**

PART NO.	SIZE	A - IN (MM)	A TOLERANCE ±IN(MM)	B - IN (MM)	B TOLERANCE ±IN(MM)	C - IN (MM)	C TOLERANCE ±IN(MM)	WEIGHT - LBS (G)	WEIGHT TOLERANCE ±LBS (G)
<b>F76842</b>	0.50"	1.24 (31.50)	0.36 (9.07)	0.63 (15.98)	0.04 (0.912)	0.71 (18.10)	9.068	0.04 (18.14)	0.02 (10.89)
<b>F76843</b>	0.50" x 0.75"	1.50 (38.15)	0.36 (9.07)	0.88 (22.33)	0.04 (0.912)	0.96 (24.40)	9.068	0.06 (27.22)	0.02 (10.89)
<b>F76846</b>	0.75"	1.74 (44.15)	0.36 (9.07)	0.88 (22.33)	0.04 (0.912)	0.88 (22.33)	9.068	0.08 (36.29)	0.02 (10.89)
<b>F76845</b>	0.75" x 0.50"	1.51 (38.30)	0.36 (9.07)	0.63 (15.98)	0.04 (0.912)	0.71 (18.10)	9.068	0.07 (32.66)	0.02 (10.89)
<b>F76844</b>	0.75" x 1.00"	1.91 (48.55)	0.36 (9.07)	1.13 (28.70)	0.04 (0.912)	1.22 (30.90)	9.068	0.11 (49.90)	0.02 (10.89)
<b>F76841</b>	1.00"	2.15 (54.55)	0.36 (9.07)	1.13 (28.70)	0.04 (0.912)	1.22 (30.90)	9.068	0.15 (68.04)	0.02 (10.89)
<b>F76168</b>	1.25"	2.50 (63.60)	0.36 (9.07)	1.38 (35.00)	0.04 (0.912)	1.51 (38.36)	9.068	0.28 (127.01)	0.02 (10.89)
<b>F76169</b>	1.50"	2.91 (73.80)	0.36 (9.07)	1.63 (41.35)	0.04 (0.912)	1.78 (45.30)	9.068	0.42 (190.51)	0.02 (10.89)
<b>F76170</b>	2.00"	3.59 (91.30)	0.36 (9.07)	2.13 (54.05)	0.04 (0.912)	2.31 (58.55)	9.068	0.81 (367.41)	0.02 (10.89)