

Brookings Unassembled 2-Door, 2-Drawer Vanity 36x31.5x21.73

Gray

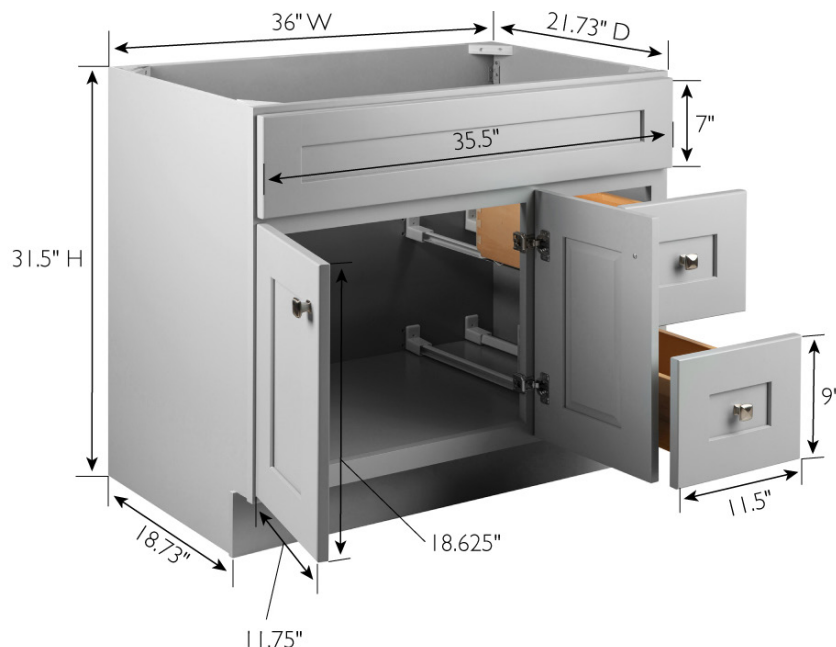

**SPECIFICATIONS**

<b>MATERIAL CONSTRUCTION:</b>	Wood
<b>ASSEMBLY REQUIRED:</b>	Yes
<b>TOOLS NEEDED FOR ASSEMBLY:</b>	Phillips Screwdriver, Rubber Mallet, Wood Glue
<b>ASSEMBLED DIMENSIONS:</b>	31.5" H x 36" L x 21.73" D
<b>ASSEMBLED WEIGHT:</b>	85.36 lbs.
<b>HINGE STYLE:</b>	Soft Close
<b>DOOR STYLE:</b>	2 Shaker Doors
<b>DRAWER STYLE:</b>	2 Drawers
<b>GLIDE STYLE:</b>	STD Easy Glide
<b>FAKE DWR STYLE:</b>	N/A
<b>DWR DIMENSIONS:</b>	5.12" H x 8.31" L x 17.99" D
<b>DWR CONSTRUCTION:</b>	Dove Tail
<b>SHELF STYLE:</b>	N/A
<b>SHELF ADJUSTABILITY INCREMENTS:</b>	N/A
<b>SHELF MAX WEIGHT CAPACITY:</b>	N/A
<b>SHELF DIMENSIONS:</b>	N/A
<b>SHELF THICKNESS:</b>	N/A
<b>SHELF MATERIAL:</b>	N/A

<b>FRAME STYLE:</b>	Face Frame
<b>FACE FRAME MATERIAL:</b>	Solid Wood
<b>SIDES MATERIAL:</b>	Plywood
<b>BOTTOM MATERIAL:</b>	Plywood
<b>TOE KICK INSET WIDTH:</b>	3"
<b>BACK PANEL MATERIAL:</b>	Plywood
<b>BACK BRACE MATERIAL:</b>	Solid Wood



<b>WARRANTY:</b>	1-Year limited warranty
<b>TITLE IV COMPLIANT:</b>	Yes
<b>PROP 65 HARMFUL MATERIAL:</b>	Formaldehyde



**TYPE:**  
**JOB:**  
**ORDER CODE:**  
**APPROVALS:**