

4358-6863 (4.21.16)



Highrise Belt-Positioning Booster

booster seat 18-45 kg (40-100 lb) 102-145 cm (40-57 in.)
and at least 4 years old



Read all instructions **BEFORE USING** this booster seat.

KEEP INSTRUCTIONS FOR FUTURE USE.

WARNING:

Failure to read, understand and follow the instructions and warnings in this instruction manual and the warnings on the system could result in serious injury or death to the child.

A. Before You Begin..... Pages 3-8

- A-1 Thank You...
- A-2 DJG Consumer Relations Contact Information
- A-3 Registration and Safety Notices
- A-4 Understanding Your Booster Seat

B. Safety Information..... Pages 9-11

- B-1 Vehicle Seating Position
- B-2 Installation in Vehicle
- B-3 Booster Seat Use
- B-4 Transport Canada Regulations
- B-5 Storing Your Booster Seat

C. Basic UsePages 12-16

- C-1 Choose Position for Your Child
- C-2 Preparing Booster Seat for Use
- C-3 Cup Holder
- C-4 Removing Pad for Cleaning

D. General Vehicle Installation ...Pages 17-20

- D-1 Understanding Your Vehicle
- D-2 Vehicle Seating Position
- D-3 Knowing Your Vehicle Belts

E. Aircraft Installation..... Page 21

- E-1 Booster Aircraft Information

F. Booster Seat Use..... Pages 22-26

- F-1 Preparing Booster Seat
- F-2 Install Booster Seat Using the Lap
and Shoulder Belt



Important Information.....Pages 27-31

- Warranty
- Replacement Parts Order Form

A-1 Thank You...

Thank you for choosing this car seat, referred to throughout this manual as a booster seat. Dorel Juvenile Group, (DJG) is committed to creating convenient, comfortable, and dependable products for children.

No one can predict if use of a restraint system will prevent injury or death in a particular crash. However, combined with careful driving, proper use of a restraint system can lower a child's risk of injury or death in most crashes.

Your child's safety is worth the time it will take to read, understand and follow the instructions and warnings.

After reading if you still have questions or concerns with the restraint system please contact our Consumer Relations Department.

On the bottom of the shell there is an expiry date for use of this booster seat. Do not use this seat after the expiry date.

A-2 Dorel Juvenile Group Consumer Relations Contact Information

Dorel Juvenile Group, Inc.

Website: www.djgusa.com

Fax: 1-800-207-8182

Mailing Address: Dorel Juvenile Group, Inc.
Attn: Consumer Relations
P.O. Box 2609
Columbus, IN 47202-2609

Telephone: 1-800-544-1108
8 A.M. to 6 P.M. EST M-TH
8 A.M. to 4:30 P.M. EST FRI

A-3 Registration and Safety Notices

Although booster seats are tested, evaluated and certified by the manufacturer and tested by Transport Canada, it is possible that a safety-related problem may be found. If there is ever a safety issue with your booster seat, we use registration information to reach owners.

Tear Off and Mail This Part or Register Online Débranchez et postez cette partie ou enregistrez en ligne 4359-4117C

Consumer: Just fill in your name, address and email. Please print.
Client: Simplement inscrire votre nom, adresse et courriel. S.V.P. imprimez.

Your Name/ Votre nom: _____

Your Street Address/ Votre adresse: _____

Province: _____

City/ Courriel (optional): _____

Model Number **Line Code** **Manufacture Date**

22163C - SGT COSCO ALPHA OMEGA 2008/12/08

L#3 B 119348

If you don't have the card or if your address changes, you will find the model number and manufactured date on the label located on side of shell.



There are three additional ways to register your information:

Online: www.djgusa.com/registration/carseat/can

Telephone: 1-800-544-1108

Mail: Send your name, address and your booster seat's model number, manufactured date, and date of purchase to:

Dorel Juvenile Canada
2855 Argentia Road, Unit 4
Mississauga, ON L5N 8G6
Attn: Consumer Relations

Please do not send in your registration card if you have registered your booster seat online.

For information on safety-related problems, you can also call Transport Canada's Road Safety Dept. at: 1-800-333-0371.

A-4 Understanding Your Booster Seat

Front View

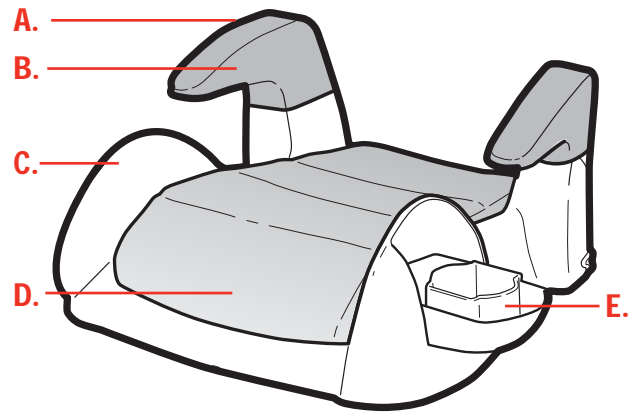

A. Armrest

B. Armrest Pads
(on select models)

C. Shell

D. Seat Pad
(styles may vary)

E. Cup Holder

Bottom View

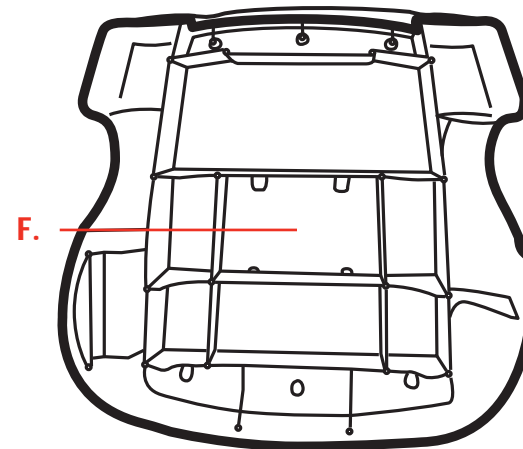

**F. Instruction Manual
Storage**

A. Before You Begin

⚠ WARNING:

Failure to read, understand and follow the instructions and warnings in this instruction manual and the warnings on the system could result in serious injury or death to the child.

B-1 Vehicle Seating Position

- ⚠ Always check vehicle owner's manual for booster seat use with front or side air bags.
- ⚠ For vehicles with no rear seats, check the vehicle owner's manual for location and installation of a booster seat.

B-2 Installation in Vehicle

- ⚠ When unoccupied, the booster seat must be firmly secured to the vehicle with the vehicle's seat belt only.
- ⚠ In a crash or sudden stop, an unsecured booster seat could injure the driver or other occupants in the vehicle.
- ⚠ Do not use the booster seat with a lap belt only.

- ⚠ In very few vehicles, the booster seat cannot be properly installed because of the type of seat belt system and/or air bag system. Always read and follow the vehicle owner's manual instructions for booster seat use.

B-3 Booster Seat Use

- ⚠ Do not use a booster seat that has been in a crash or a collision. The system must be replaced.
- ⚠ Do not use a booster seat if you do not know the history of the restraint.
- ⚠ Never take your child out of the booster seat or attend to the child's needs while the vehicle is moving.
- ⚠ Never leave child unattended in the booster seat.
- ⚠ To avoid the child being seriously burned, always check for hot seat and buckles before using this booster seat.
- ⚠ Do not use a booster seat with missing or damaged parts.
- ⚠ DJG does not recommend the use of accessories or add-ons that have not been certified with this booster seat at original purchase date.

- ⚠ **Never allow any child to play with this booster seat; it is not a toy.**
- ⚠ **Do not remove the warning labels.**
- ⚠ **This booster seat has been certified for use in passenger vehicles only. Do not use in a boat, motorcycle, aircraft or in a cargo van or bus where there are no seat belts.**
- ⚠ **Read all instructions and warning labels for additional warnings.**

B-4 Transport Canada Regulations

Transport Canada Road Safety Directorate regulates children's restraint systems under the Motor Vehicle Restraint Systems Safety Regulations (RSSR). The regulations require the manufacturer and/or importer to certify the booster seat to the applicable safety standards and place specified warnings and information on the labels fastened to each booster seat and in this instruction manual.

B-5 Storing Your Booster Seat

To protect your booster seat, store in the house, not in the garage or attic. The hot and cold temperatures can harm the shell if stored for a long period of time.

C-1 Choose Position for Your Child

Your child's height, weight and age determine how your booster seat should be used and placed in the vehicle.



**18-45 kg
(40-100 lbs.)
102-145 cm
(40-57 in.) and at
least 4 Years Old**
**Booster Seat using
vehicle lap/shoulder
belt combination**
Child and booster seat
are placed in the back
seat, facing the front of
the vehicle.

C. Basic Use

⚠ **WARNING:**

Verify your child's weight and height (do not guess) before using this booster seat.

C-2 Prepare Booster Seat For Use

Follow the instructions for attaching the seat pad that matches your booster seat.

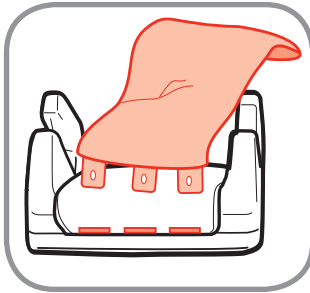

1. Install Partial Wrap Seat Pad

Place pad on the shell with the tabs facing the front.

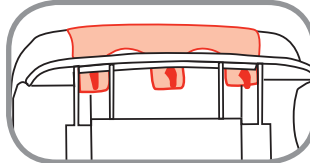

2. Pull tabs through the slots in shell and attach to hooks under shell.

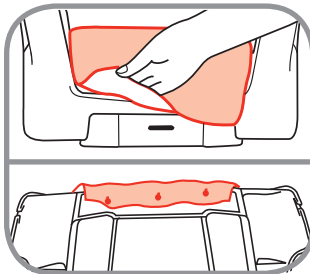

3. Wrap pad over the back of shell and attach to the hooks under shell.

13

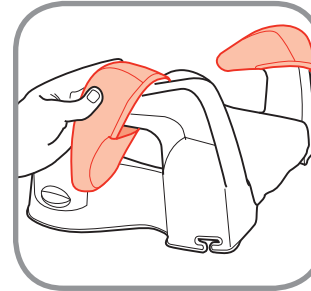

Install Armrest Covers (on select models)

Slide armrest covers over armrests as shown.

14

C-3 Cup Holder

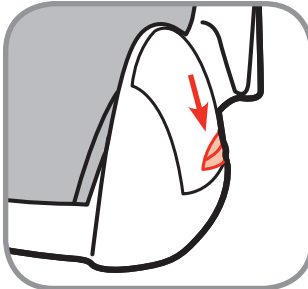

To Open Cup Holder

Push down on cup holder's tab to open. Push the cup holder up when not needed.

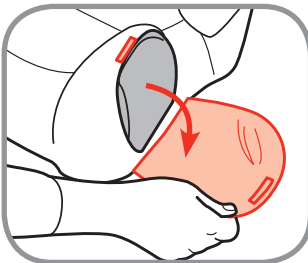
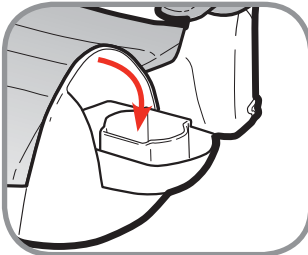

NOTE: Your pad may have a cup holder cover. To open the cup holder, unfasten and lay the cover down. Push down on cup holder's tab to open.

15

C-4 Cleaning Seat Pad

Cleaning Seat Pad

Remove the seat pad by reversing the directions for attaching your seat pad. See section C-2.

Machine wash separately with cold water on a gentle cycle. Do not use bleach. Tumble dry separately for 10-12 minutes on low heat. Remove immediately.

⚠ WARNING:

Do not use this booster seat without the seat pad. Failure to do this can result in serious injury.

Install Pad

Attach the seat pad to the shell by reviewing section C-2.

16

C. Basic Use

D-1 Understanding Your Vehicle

Your vehicle's features may be considerably different than those pictured here. Consult your vehicle owner's manual to help identify your vehicle's specific features and locations.

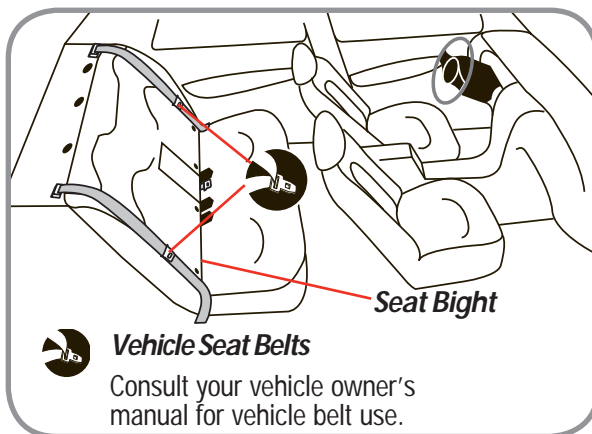

D-2 Vehicle Seating Position

⚠ WARNING:



Use the restraint system only on vehicle seats that face forward. Do not use on seats that face the sides or rear of the vehicle. For vehicles with an air bag, but without a back seat, refer to your vehicle owner's manual.

In very few vehicles, the restraint system cannot be properly installed because of the type of seat belt system or air bag system. Always read and follow the vehicle owner's manual instructions for restraint system use.

Safety Tip:



Children are safer when properly restrained in rear seating positions than in the front seating positions.

According to accident statistics, children in rear seating positions are statistically safer, whether you have air bags, advanced air bags, or no air bags at all.

To help protect your vehicle seat's upholstery from damage, use a single layered towel underneath and behind booster seat.

To avoid your child being seriously burned, take the following precautions:

- 1.** Park in the shade or where sun does not directly hit the booster seat.
- 2.** Cover the booster seat with a sheet or blanket when not in use.
- 3.** Check for hot booster seat and buckles before placing child in booster seat.

D-3 Knowing Your Vehicle Belts

Review your vehicle's owner manual for vehicle seat belt use with booster seats. This is your best source for information concerning your vehicle.

Not all vehicle belts will work with this booster seat. This booster seat must be tightly locked in place at all times during travel. You must determine if your vehicles belts are compatible with this booster seat.

Vehicle Belts

• Automatic/Passive Vehicle Seat Belts

You **MUST** have a vehicle lap and shoulder belt to install any booster seat.



• *Vehicle Belts in center of the door or side panel*

You must move the booster seat to another seating location. Consult your vehicle owner's manual.

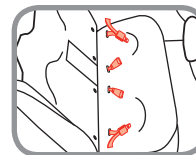

• *Vehicle Belts that are in front of the seat bight*

You may need to move the booster seat to another seating location. Consult your vehicle owner's manual.

E-1 Booster Aircraft Information



This booster seat is NOT certified for use in aircraft because aircraft seats do not have shoulder belts.

F-1 Preparing to Install Belt-Positioning Booster Seat

18-45 kg (40-100 lb) 102-145 cm (40-57 in.)
and at least 4 years old

Belt-positioning booster seat using only vehicle
lap/shoulder belt.

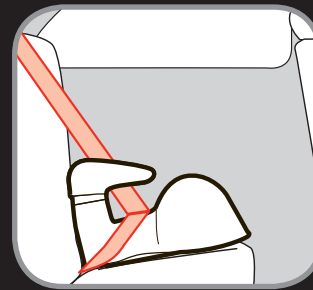

Lap/Shoulder Belt

⚠ WARNING:

Use only the vehicle's lap and shoulder belt system when restraining the child in this booster seat.

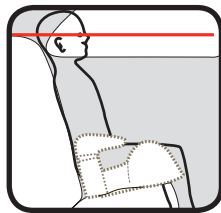

Do not use this booster seat if the tops of your child's ears are above the top of the vehicle seat back or vehicle's headrest.

Failure to follow these warnings can result in serious injury or death.



F-2 Installing Booster Seat Using the Lap and Shoulder Belts



1. *Place Booster Seat in Vehicle Forward-Facing in the Back Seat*

Place booster seat in the back seat, **flush** against the back of the vehicle seat.



NOTE: Make sure back of armrests are against the back of the vehicle seat.

F. Booster Seat Use



2. Place Child in Seat

Place the child's bottom flat against the booster seat. The child's upper and lower back should be flat against the vehicle seat back. This will allow the vehicle belt to be properly tightened.



3. Buckle Lap and Shoulder Belt

Lap belt should cross the child's thighs (not on the stomach). Both belts on the buckle side of booster seat should be under the armrest and the lap belt should be under both armrests as shown.



4. The shoulder belt should lay snugly across the center of the child's shoulders and across the chest (not on the face or neck). Pull up on the shoulder belt to tighten.

Check periodically to ensure your child has not moved out of position and loosened the vehicle belt.

⚠ WARNING:

Do Not Use the vehicle lap belt only when using this booster seat.

The shoulder belt must always be adjusted snugly across the child's chest.

NEVER place the shoulder belt behind the child's back or under the child's arms.

Failure to follow these warnings can result in serious injury or death to your child.



F. Booster Seat Use

Warranty

Dorel Juvenile Group, Inc. (DJG) warrants this product to the original retail purchaser as follows:

This product is warranted against defective materials or workmanship for **one year** from the date of original purchase.

An original receipt is required to validate your warranty.

DJG will, at its option, provide replacement parts or replace this product. DJG reserves the right to substitute if the part or model has been discontinued.

To make a claim under this warranty you may contact us at www.djgusa.com, fax us at 1-800-207-8182 24 hours a day, write to DJG Consumer Relations Department, P.O. Box 2609, Columbus, IN 47202-2609, or call 1-800-544-1108 from 8:00 a.m. to 6:00 p.m. EST Monday through Thursday and from 8:00 a.m. to 4:30 p.m. on Friday. **Proof of purchase is**

required and shipping charges are the responsibility of

the consumer. Warranty Limitations: This warranty does not include damages which arise from misuse or abuse of this product. **Limitation of Damages:** The warranty and remedies as set forth are exclusive and in lieu of all others, oral or written, express or implied. In no event will DJG or the dealer selling this product be liable to you for any damages, including incidental or consequential damages, arising out of the use or inability to use this product.

PLEASE REGISTER ONLINE AT:

WWW.DJGUSA.COM/REGISTRATION/CARSEAT/CAN OR
COMPLETE AND MAIL THE PRE-PAID OWNER REGISTRATION
CARD WITHIN (30) DAYS OF PURCHASE.

If there is ever a safety issue with your child restraint, we use registration information to reach owners. Please do not send in your registration card if you have registered your child restraint online.

Replacement Parts Order Form

For replacement parts, complete this form below. We must have your model number and manufacture date codes on the form to ensure proper replacement parts. They can be found on the stickers on the side of the infant restraint shell. Payment in U.S. dollars must accompany your order. Choose parts needed from the list supplied.

Mail form and payment to:

Dorel Juvenile Group, Inc.
Attn: Consumer Relations
P.O. Box 2609
Columbus, IN 47202-2609

Fax to: 1-800-207-8182

Website: www.djgusa.com

Please make money orders payable to Dorel Juvenile Group, Inc. Fill in the area on the next page to charge credit card. (Visa or MasterCard only). We do not accept cash, personal checks, or other credit cards. All outside of U.S. and Canada MUST use credit card.

We **MUST** have this information to process your order:

Model Number (5 digits & 4 letters): _____

Manufacture Date (yyyy/mm/dd): _____

Ship to (please print): _____

Name: _____

Address: _____

City: _____

Province: _____

Postal code: _____ Country: _____

Telephone (area code): _____

E-mail address: _____

Replacement Parts List

NOTE: If requested color is not available, similar color will be substituted. Prices are subject to change.

Part	Cost	Quantity	Total Cost
Pad Set	\$14.99	X _____	= \$ _____
Instructions	\$0.00	X _____	= \$ _____
Merchandise Total			\$ _____
Shipping and handling:			\$ _____
Up to \$25.00	\$5.95	\$100.01 to \$150.00	\$10.95
\$25.01 to \$50.00	\$6.95	\$150.01 to \$200.00	\$11.95
\$50.01 to \$75.00	\$8.95	\$200.01 and up	\$13.95
\$75.01 to \$100.00	\$9.95	Outside Continental USA	\$10.00

Sales Tax \$ _____

Residents of Quebec, add 5% GST and 9.5% QST.
 Residents of New Brunswick, Newfoundland and Labrador, add 13% HST.
 Residents of Nova Scotia add 15% HST.
 Residents of Saskatchewan add 5% GST and 5% PST.
 Residents of Manitoba add 5% GST and 7% PST.
 All other Provinces and Territories, add 5% GST.

Grand Total \$ _____

No shipping and handling on instructions for quantities under 6. Add \$.50 for each instruction over 6, then add applicable shipping and handling.

Fill Out For Credit Card

☐ Visa ☐ Mastercard

Card Exp. Date: _____

Cardholder's Name: _____

Card Number: _____

Signature: _____

