

INSTRUCTION MANUAL

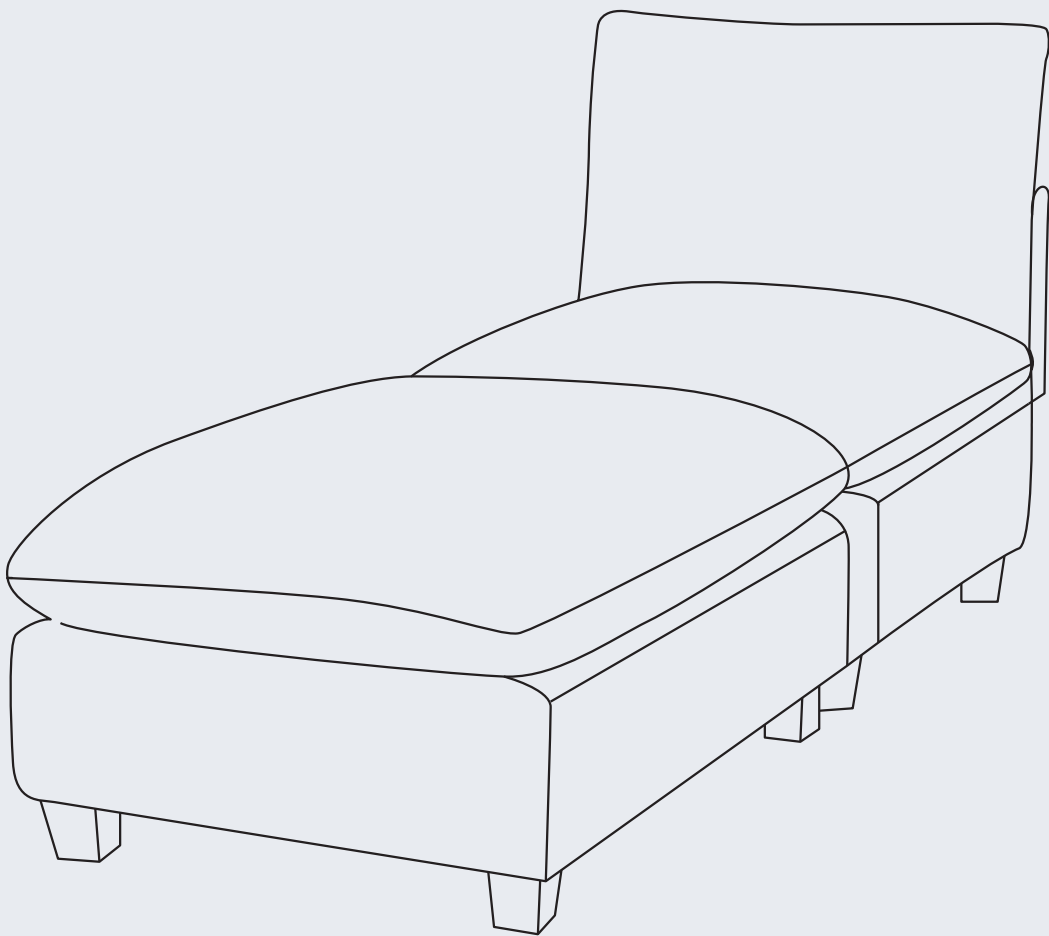

Upholstered Single Sofa Chair
with Ottoman

V1.0

! CARE & MAINTENANCE

Please keep this instruction for your future reference.

- Be careful when assembling to avoid damaging the product.
- Clean the table with lukewarm water, mild detergent & soft cloth.
- Firmly secure all bolts before use. Do not use any part of this item as a step ladder.
- Reconfirm that all bolts, screws, and nuts are secure every 90 days.
- Do not use or store this item in the proximity of open flame or flammable/combustible chemicals.
- Be aware that some parts are heavy and have sharp edges.
- Do not overtighten screws. (Insert all screws before tightening screws.)
- Please do not exceed the weight limitations of this item.

TOOLS REQUIRED



ALLEN WRENCH
(PROVIDED)



SOFA
330 LBS
CAPACITY



2 PERSON
ASSEMBLY



UP TO 30 MIN.
ASSEMBLY

HARDWARE

1

BOLT

M8 x 40mm



8 PCS

2

WASHER



12 PCS

3

NUT



4 PCS

PARTS

A

SEAT FRAME

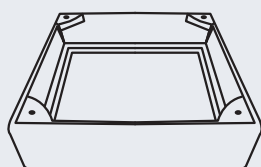

1 PC

B

BACKREST



1 PC

C

OTTOMAN FRAME

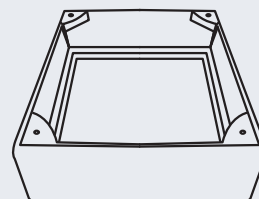

1 PC

D

OTTOMAN CUSHION

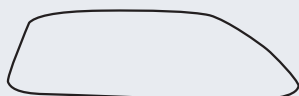

1 PC

E

SEAT CUSHION



1 PC

F

BACK CUSHION

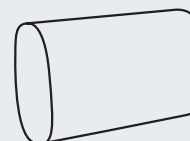

1 PC

PARTS

G

PLASTIC LEG



8 PCS

H

PLASTIC WASHER

Inner dia.10mm
Outer dia.48mm



8 PCS

PRODUCT ASSEMBLY - OVERALL VIEW

Look at following overall view of this sofa and learn the exact position of each part to be assembled.

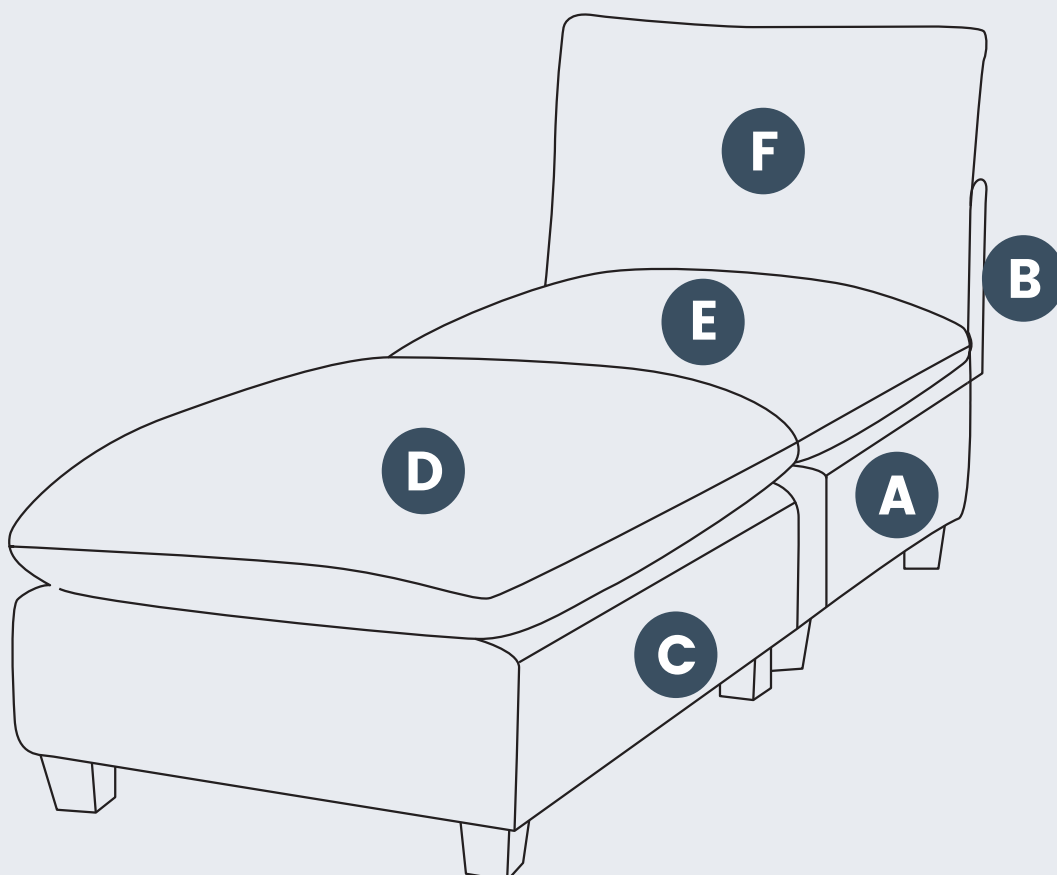

PAY ATTENTION: Note that after connecting the seat frame, do not immediately place **Part D, E, F Cushion**. You need to first put the assembled parts in the designated position that the sofa needs to be placed, and then you can place the **Part D, E, F Cushion**.

PRODUCT ASSEMBLY

1

Place 1 pc of **Part B Backrest Frame** on 1 pc of **Part A Seat Frame** with 4 sets of **Hardware (#1 Bolt + #2 Washer)**.

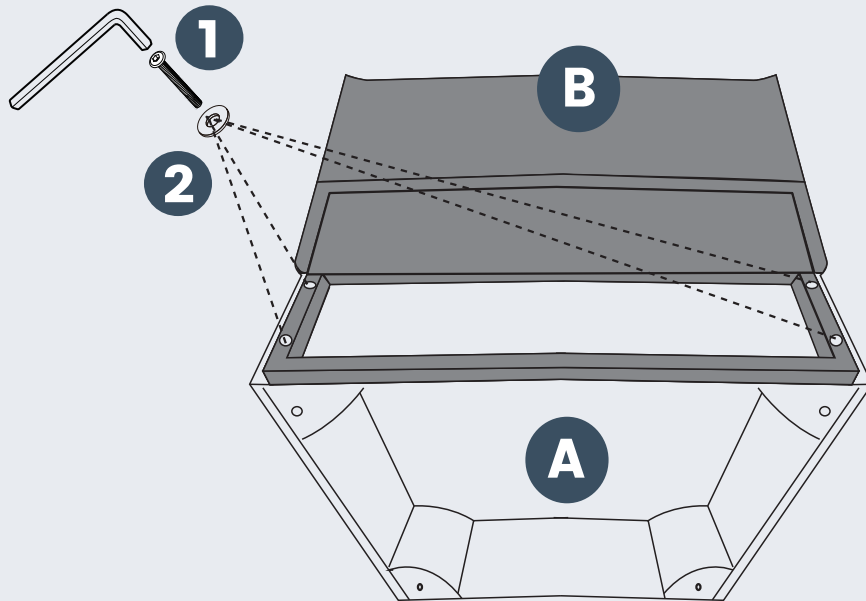

PRODUCT ASSEMBLY

2

Connect 8 sets of **Part G Plastic Legs** and **Part H Plastic Washers** to the **Part A Seat Frame** and **Part C Ottoman Frame** bottom.

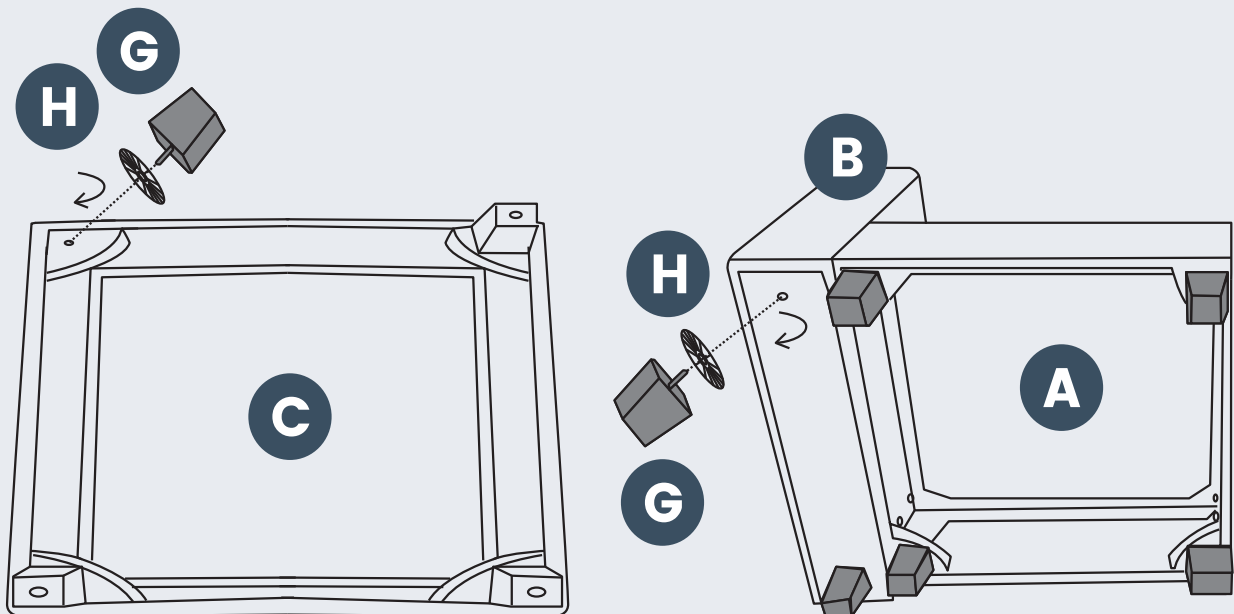

PAY ATTENTION: Note that after connecting the seat frame, do not immediately place **Part D, E, F Cushion**. You need to first move the loveseat to the designated position that it needs to be placed, and then follow the next step.

PRODUCT ASSEMBLY

3

Take out **Part D, E, F Cushion**, then gently pat to make them full. And then refer to the following picture to put the cushions in the corresponding positions.

Now enjoy your loveseat.

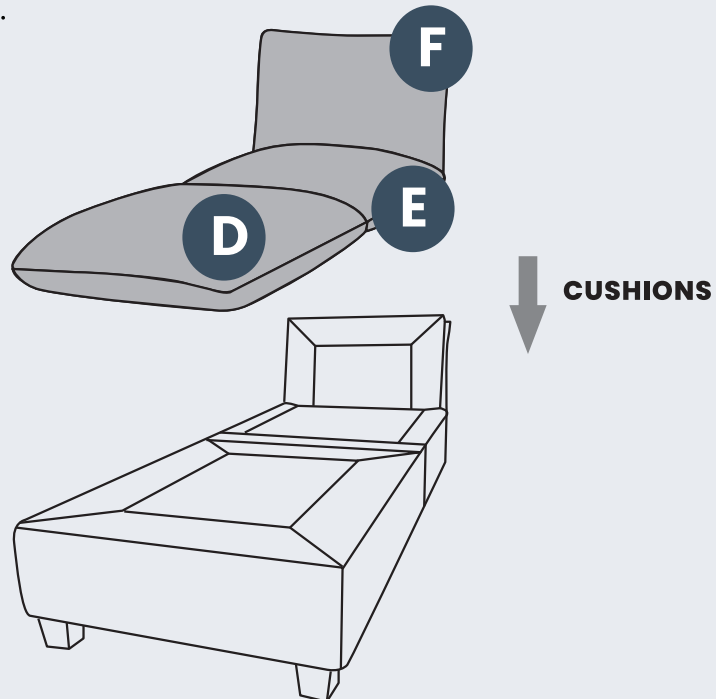

PRODUCT ASSEMBLY

4

Installation of sectional sofa is shown as below if you purchase a set of sofa. There are four connecting holes on side of **Part A Seat Frame**. Use 1 set of **Hardware (1pc of #1 Bolt + 2pcs of #2 Washer + 1pcs of #3 Nut)** for each connecting hole to lock the loveseat.

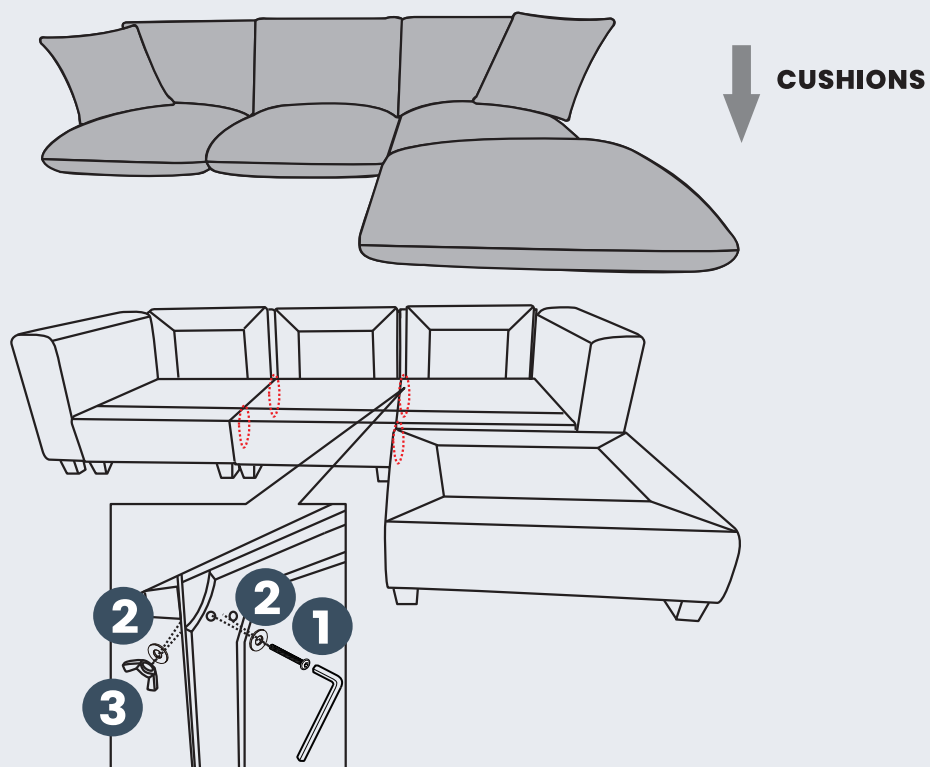

CLEANING TIPS

REGULAR CLEAN: Use lukewarm water, mild detergent and soft cloth to remove any dirt or stains.

QUICK CLEAN: You can simply wipe down the furniture with a damp cloth.

Regular cleaning not only preserves the aesthetic appeal of your furniture, but also helps extend its lifespan.