

Chest

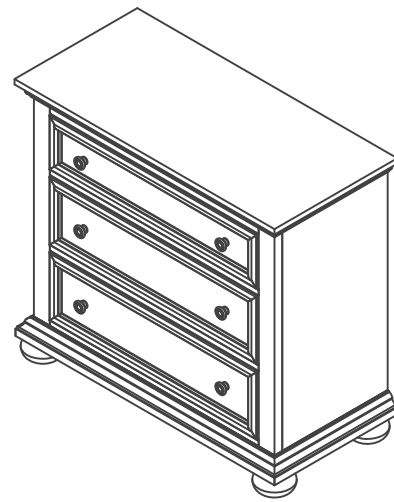

IMPORTANT

Carefully remove all the parts from the carton and place them individually on a soft cloth to prevent scratches or other damage.

Carefully and strictly follow these assembly instructions to ensure a completed product as designed.

Do not use power tools above 8 volts to assemble.

Part List

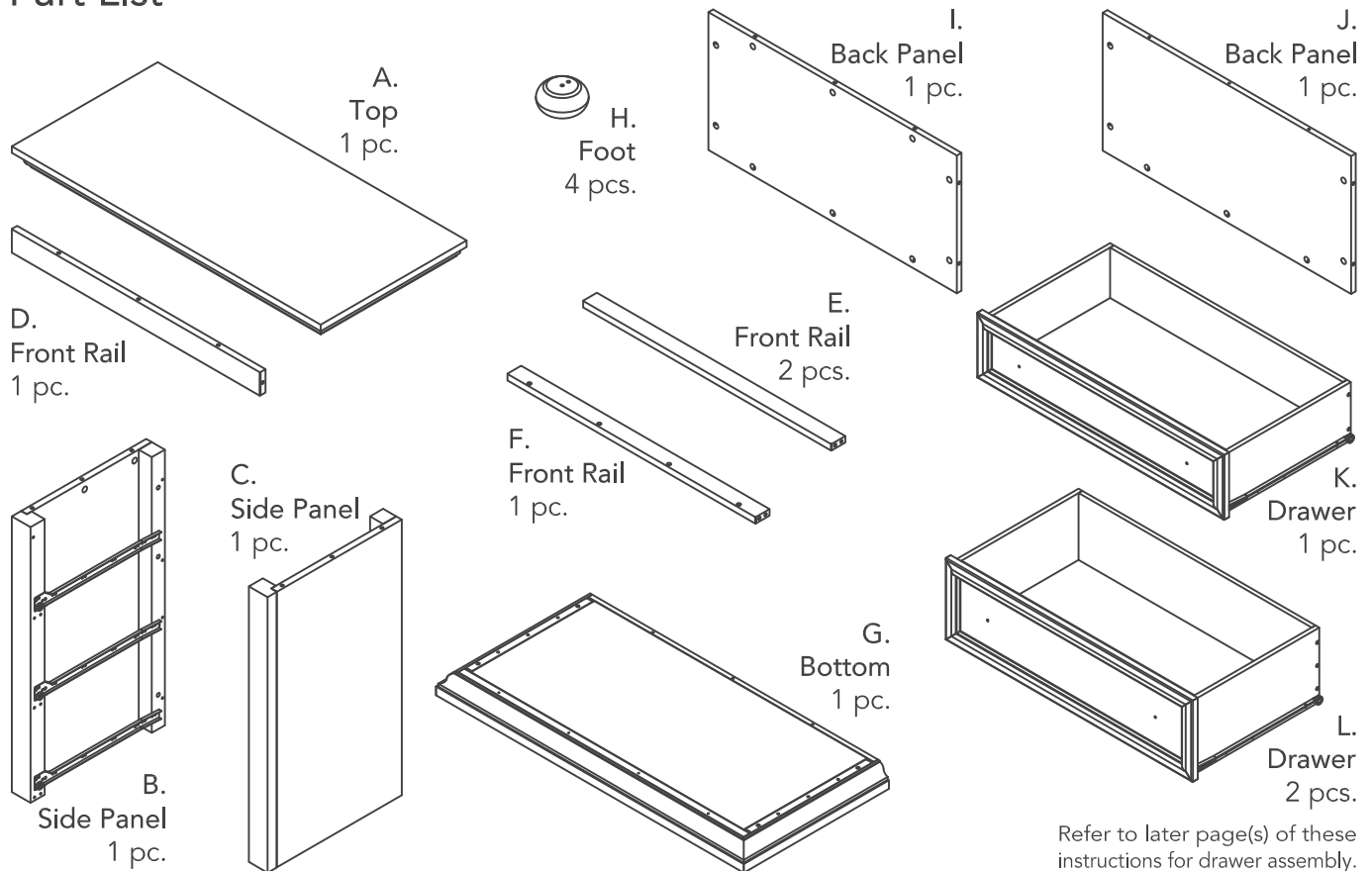

Refer to later page(s) of these instructions for drawer assembly.

Hardware List



Cam Lock Screw
40 pcs. (+4 extra)



Cam Lock
40 pcs. (+4 extra)



M4x45
1 3/4" Round Head Screw
6 pcs. (+1 extra)



M4x25
1" Round Head Screw
4 pcs. (+1 extra)



M3x32
1 1/4" Flat Head Screw
50 pcs. (+1 extra)



M3x19
3/4" Flat Head Screw
18 pcs. (+1 extra)



M6x90
Bolt
4 pcs. (+1 extra)



Wooden Dowel
8 pcs. (+1 extra)



5/32"x7/8"
Machine Screw
6 pcs.



Handle
6 pcs.



Allen Key
1 pc.



Allen Key (Small)
1 pc.

Tool(s) required for assembly: Phillips screwdriver, Level, Pencil, Drill (8 volts or less), 3/8" Drill Bit

Home Styles Customer Service: www.homestyles-furniture.com,
servicedesk@homestyles-furniture.com, 888-680-7460, 877-831-0319

Assembly Instructions 2/9

IMPORTANT

- Use a soft cloth between these parts and the floor.
- Do not use power tools above 8 volts to assemble.
- Do not tighten all the screws until each part is properly assembled.
- The unit must be level to work properly. Use the included adjustable levelers to level.
- Keep Allen Key in a safe place as the Bolts may need to be tightened up in the future.

STEP 1

Insert Cam Lock Screws into the pre-drilled holes of Top (A), Side Panels (B), (C), Bottom (G) and Back Panel (J).

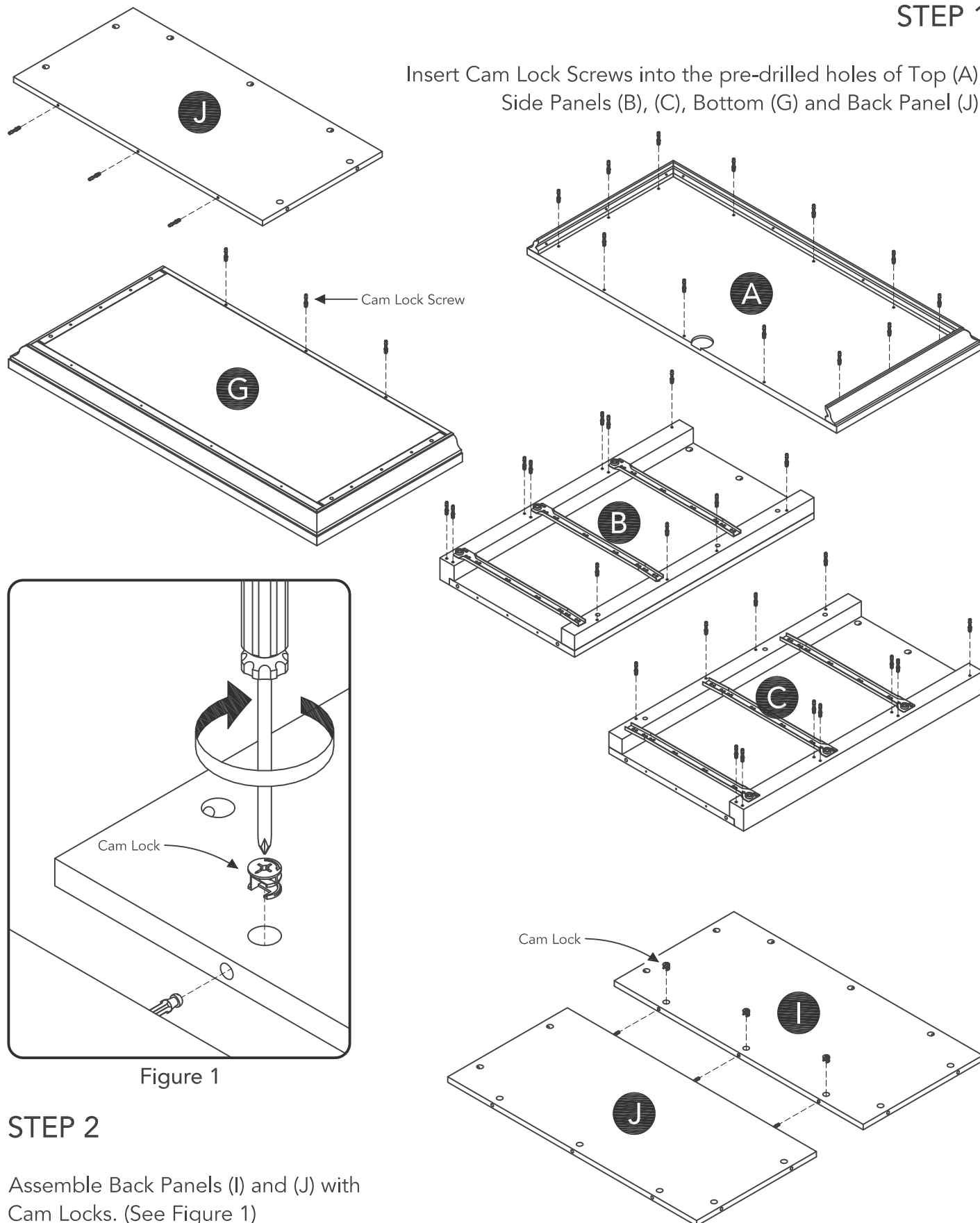

STEP 2

Assemble Back Panels (I) and (J) with Cam Locks. (See Figure 1)

STEP 3

Orientate Front Rails (E), (F) with 'Arrow' stickers pointing to the front, then attach unit from Step 2 and Front Rails (D), (E), (F) to Side Panel (B) with Cam Locks.

Attach Side Panel (C) to unit with Cam Locks.

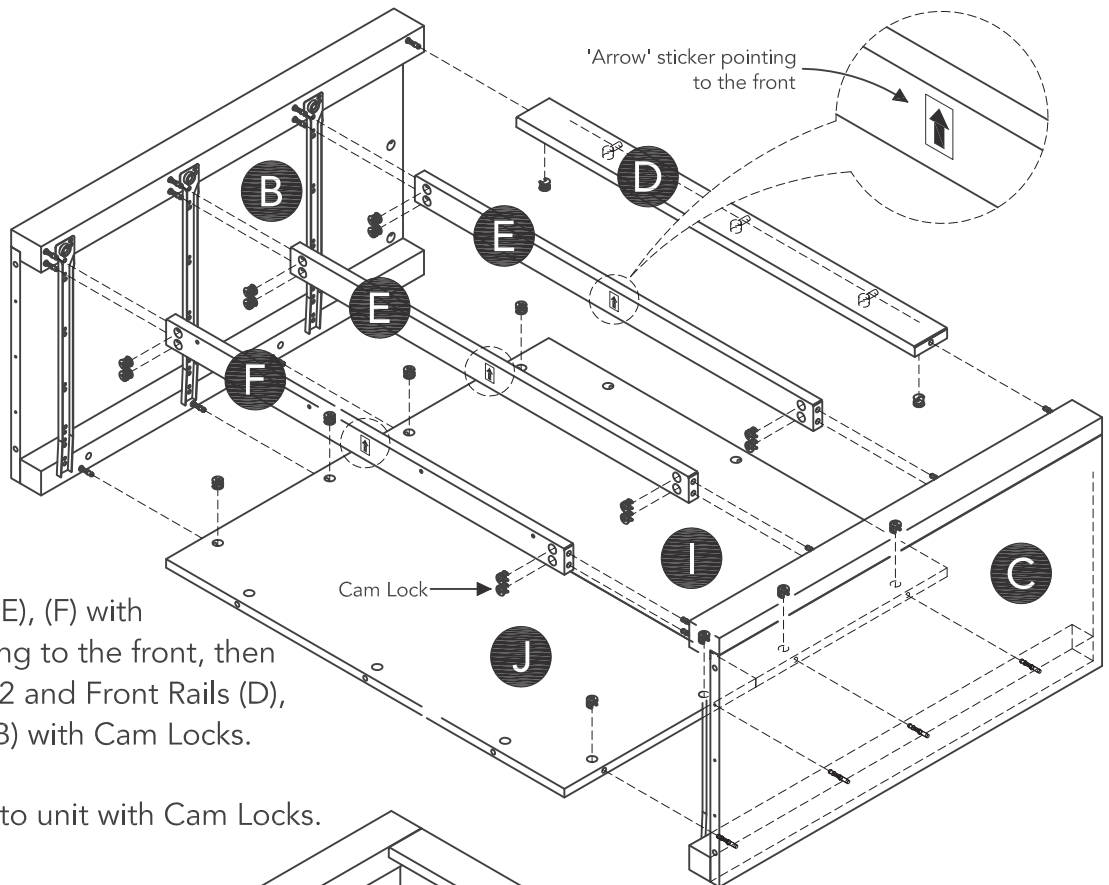

STEP 4

Attach Bottom (G) to unit with Wooden Dowels, Cam Locks, 1" and 1 3/4" Round Head Screws.

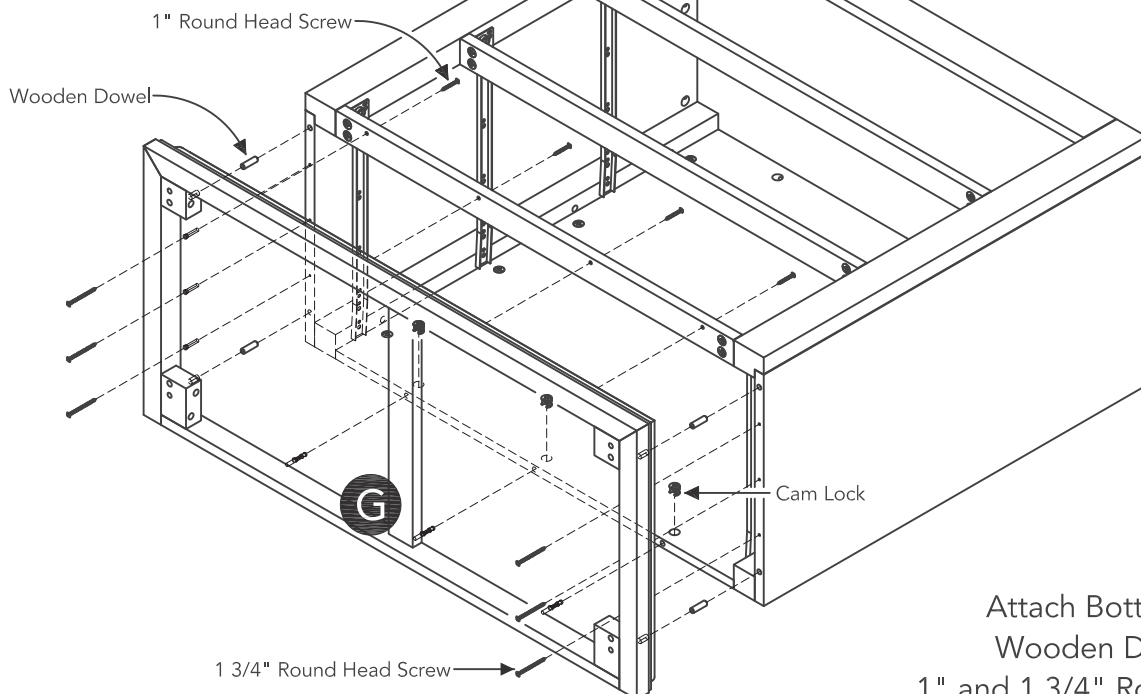

STEP 5

Attach Wooden Dowels to Feet (H).

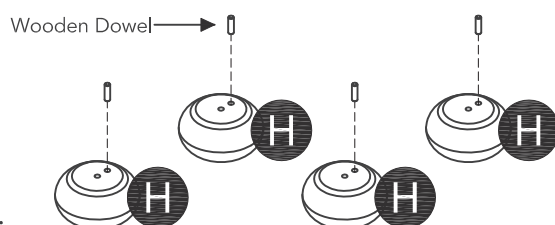

STEP 6

Attach Feet (H) to unit with Bolts.

Tighten Bolts with Allen Key.

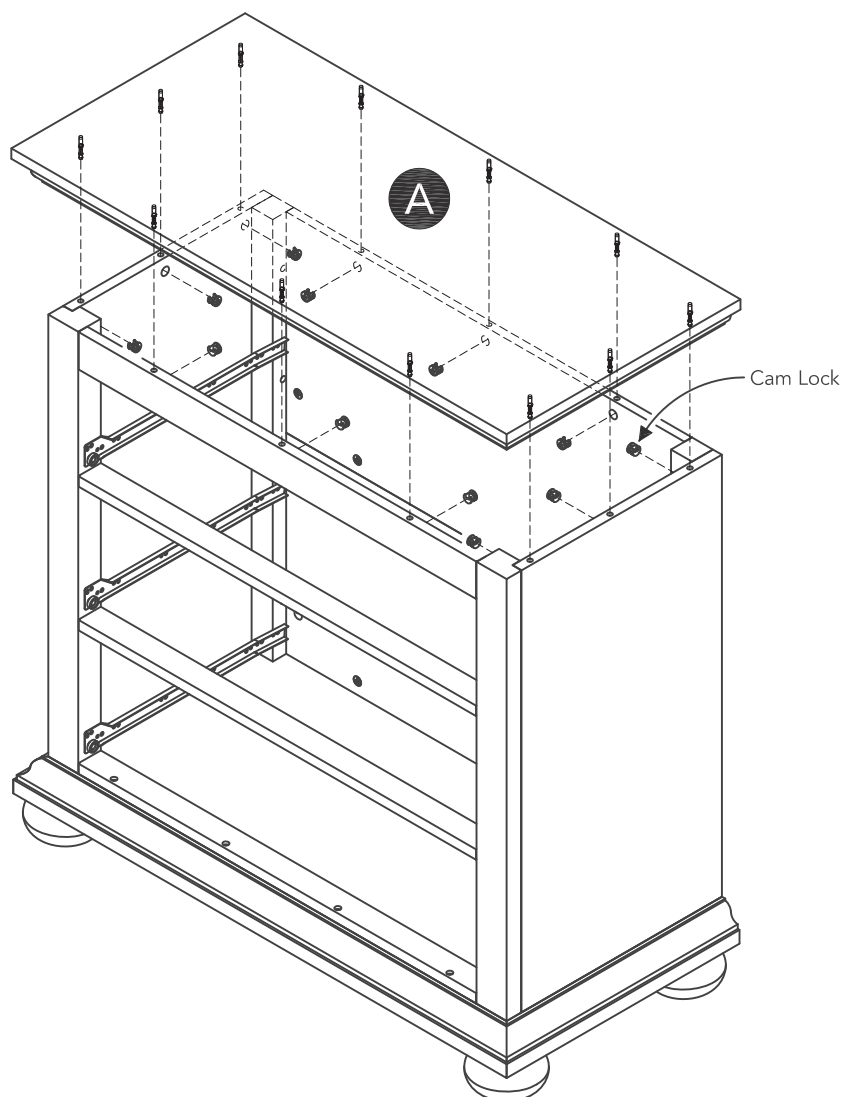
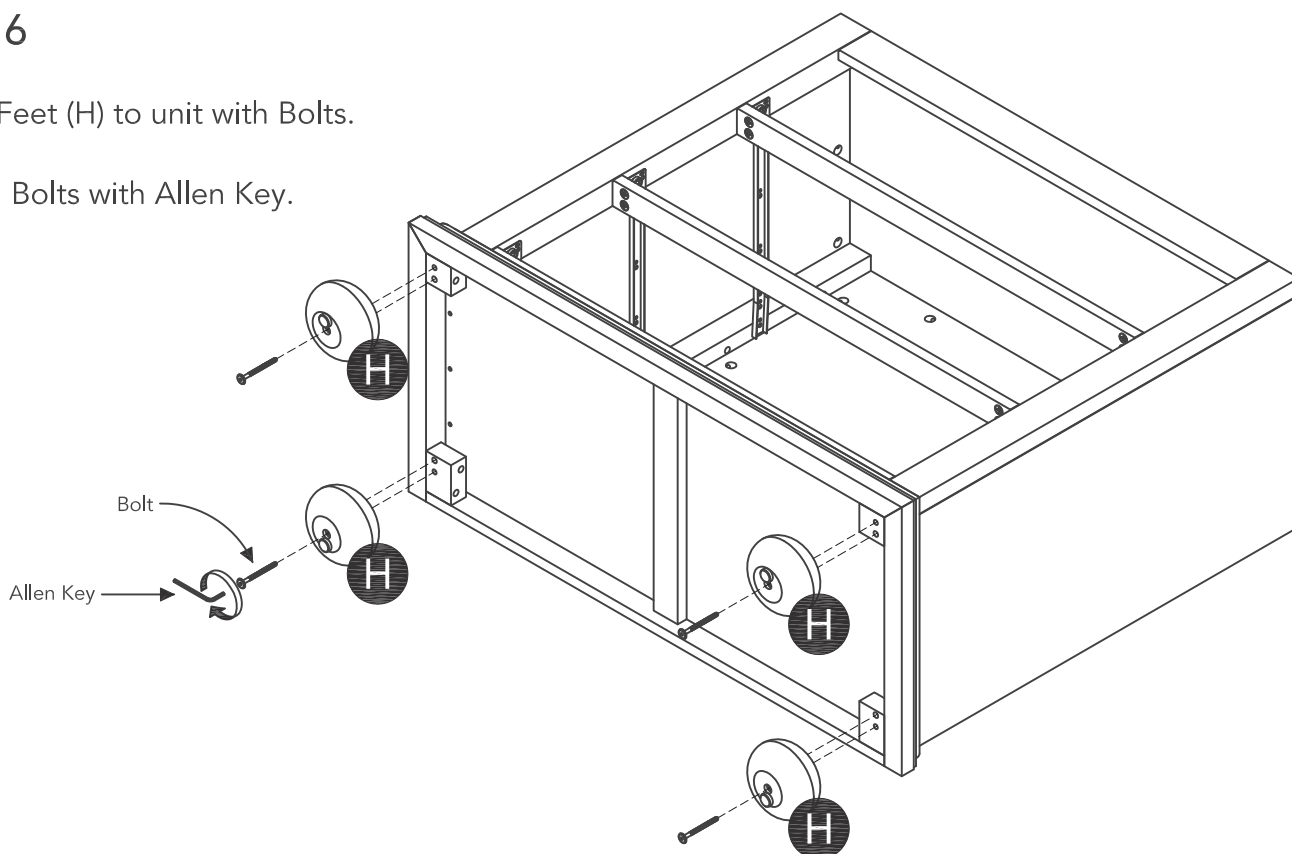

STEP 7

Attach Top (A) to unit with Cam Locks.

To level unit, adjust the adjustable levelers on the bottom of unit.
(See Figure 2)

Note: Unit must be level to work properly.

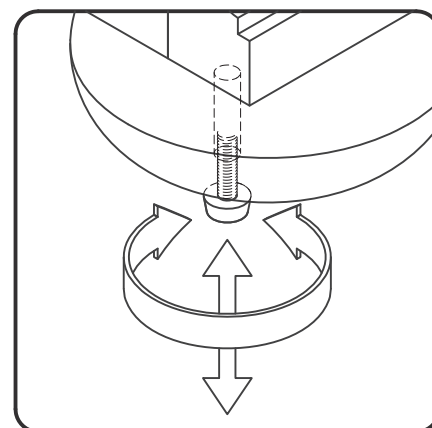

Figure 2

Assembly Instructions 5/9

IMPORTANT

- To help reduce the risk of the unit tipping over, the Tip-over Restraint must be installed following these instructions exactly.

STEP 8

Place unit at desired location.

Mark wall with pencil just above and in-line with hole in Top (A). (See Figure 3)

Move unit.

Drill a 3/8" hole in wall 1 1/2" below mark.

Insert Anchor into the wall hole and attach Tip-over Restraint to Anchor with 1 1/2" Round Head Screw and Flat Washer. (See Figure 4)

Move unit back into place and insert Tip-over Restraint into unit through hole in Top (A). (See Figure 5)

Screw Tip-over Restraint to unit with 1/2" Round Head Screw and Flat Washer. (See Figure 6)

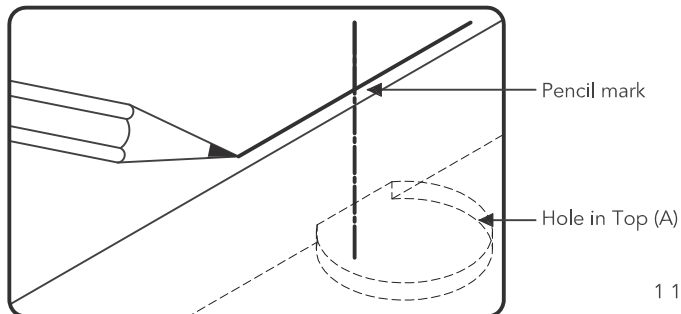

Figure 3

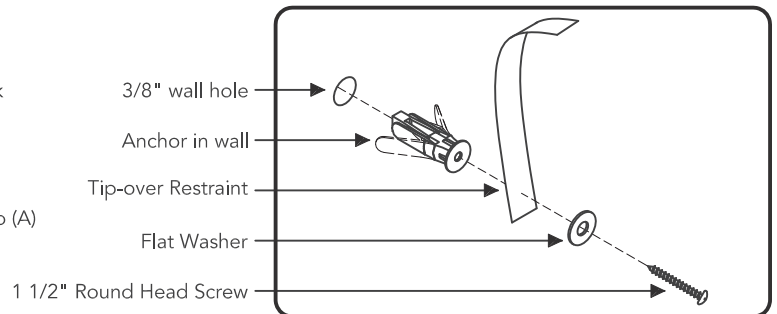

Figure 4

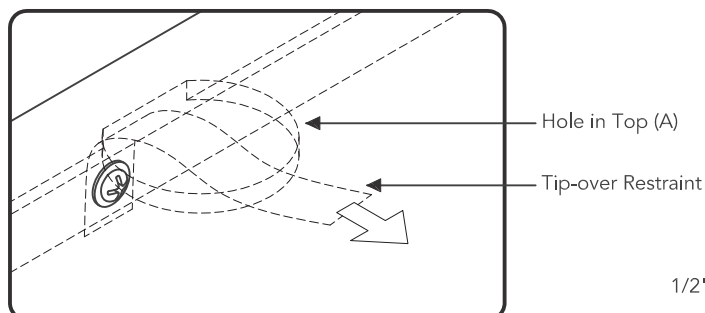

Figure 5

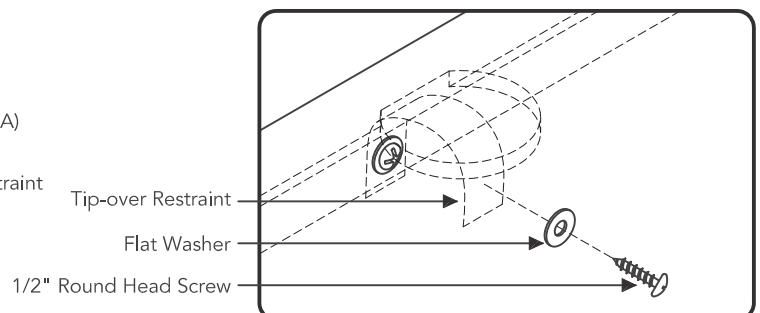
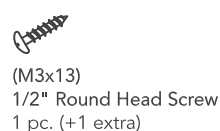
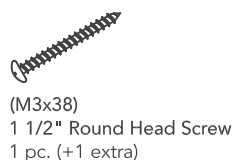
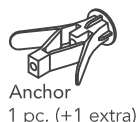
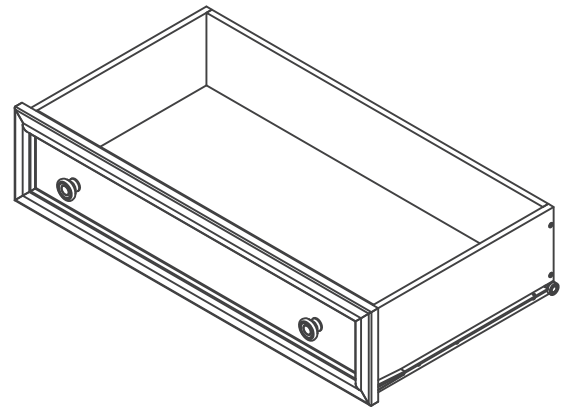
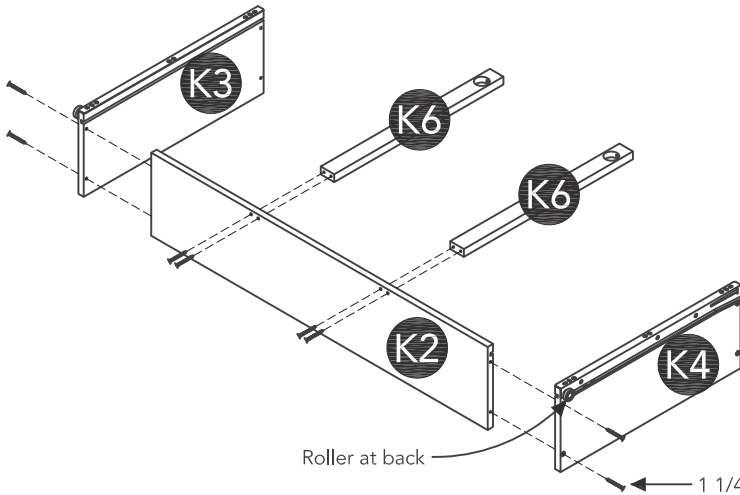

Figure 6

Hardware List



Drawer (K)



STEP 9

Attach Drawer Sides (K3), (K4) and Drawer Supports (K6) to Drawer Back (K2) with 1 1/4" Flat Head Screws.

STEP 10

Insert Drawer Bottom (K5) into the groove.

Attach Drawer Front (K1) to unit with 1 1/4" Flat Head Screws.

1 1/4" Flat Head Screw

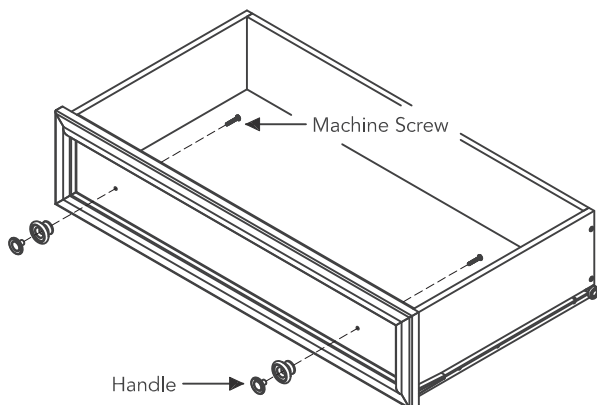
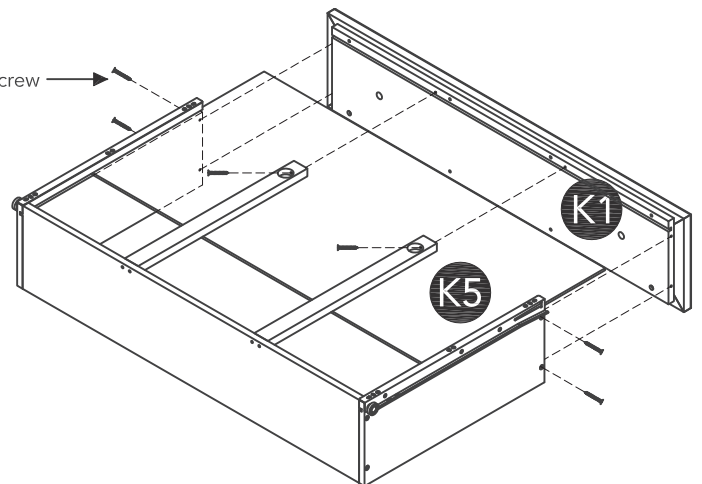

STEP 11

Attach Handles with Machine Screws.

Note: Drawer assembly is not complete until 3/4" Flat Head Screws are used in a later step.

Part List

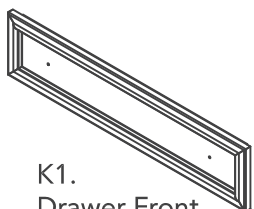

K1.
Drawer Front
1 pc.



K2.
Drawer Back
1 pc.

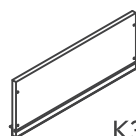

K3.
Drawer Side
1 pc.

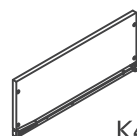

K4.
Drawer Side
1 pc.

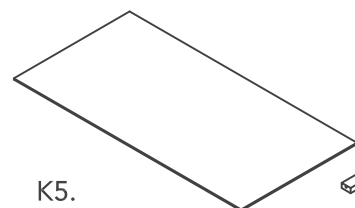

K5.
Drawer Bottom
1 pc.



K6.
Drawer Support
2 pcs.

Drawer (L)

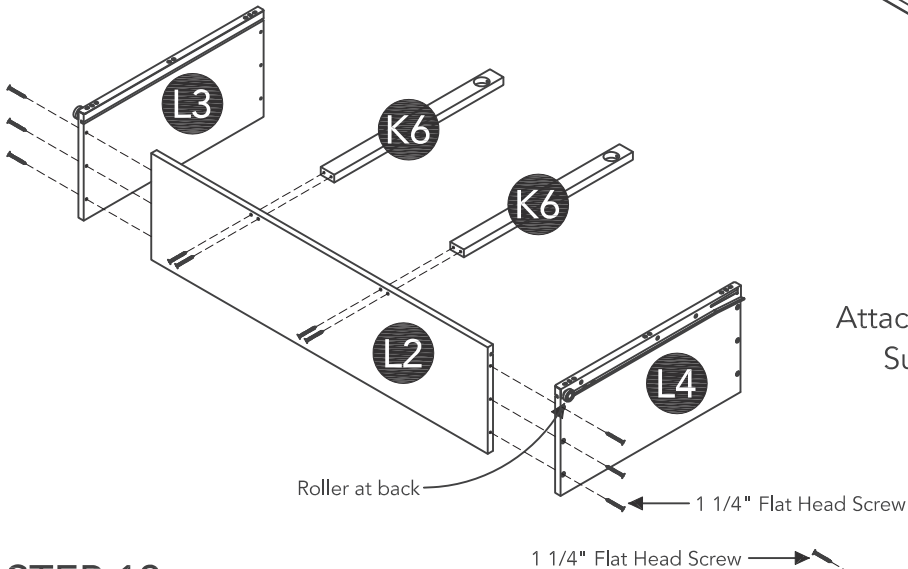

STEP 12

Attach Drawer Sides (L3), (L4) and Drawer Supports (K6) to Drawer Back (L2) with 1 1/4" Flat Head Screws.

STEP 13

Insert Drawer Bottom (L5) into the groove.

Attach Drawer Front (L1) to unit with 1 1/4" Flat Head Screws.

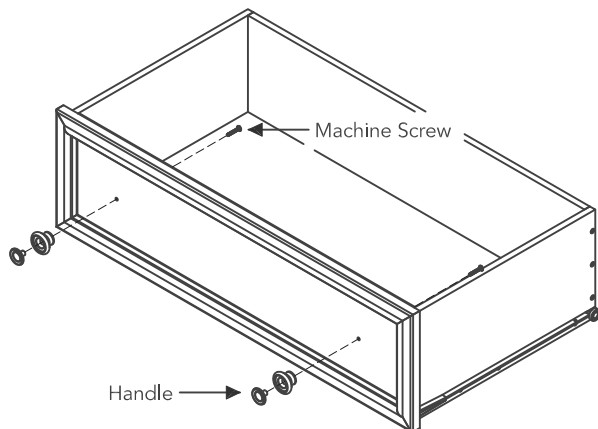
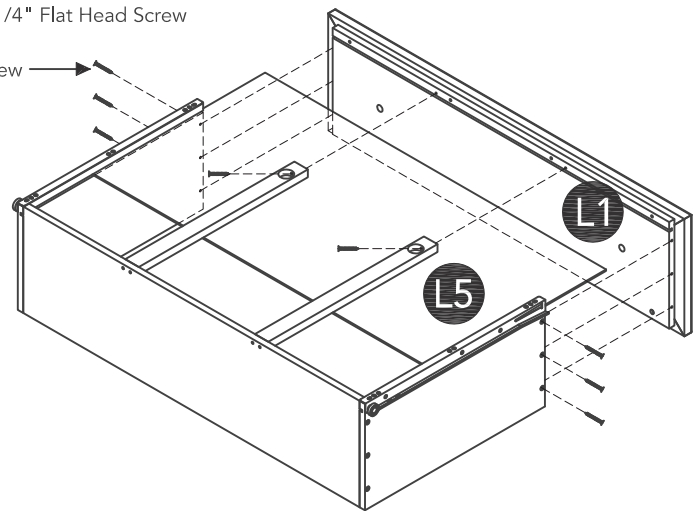

STEP 14

Attach Handles with Machine Screws.

Note: Drawer assembly is not complete until 3/4" Flat Head Screws are used in a later step.

Part List

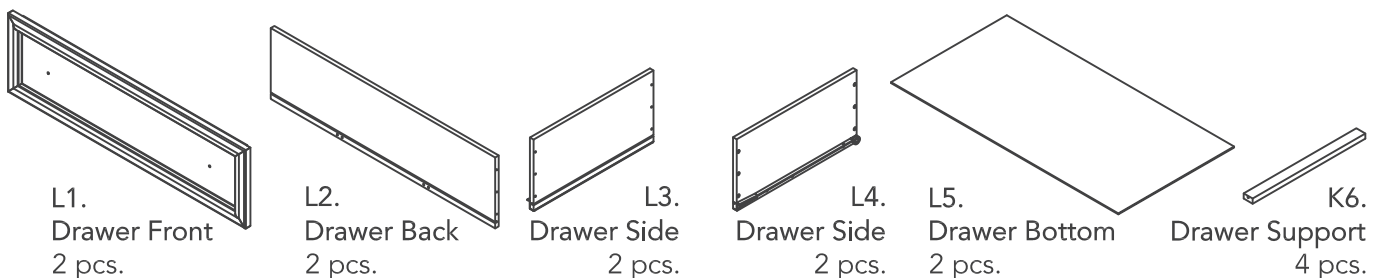

Assembly Instructions 8/9

STEP 15

Loosen slightly the screws pre-installed on the back of the drawer fronts.

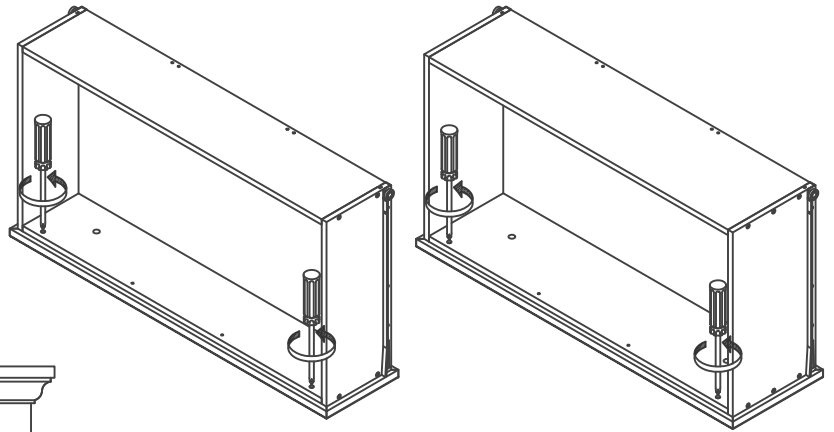
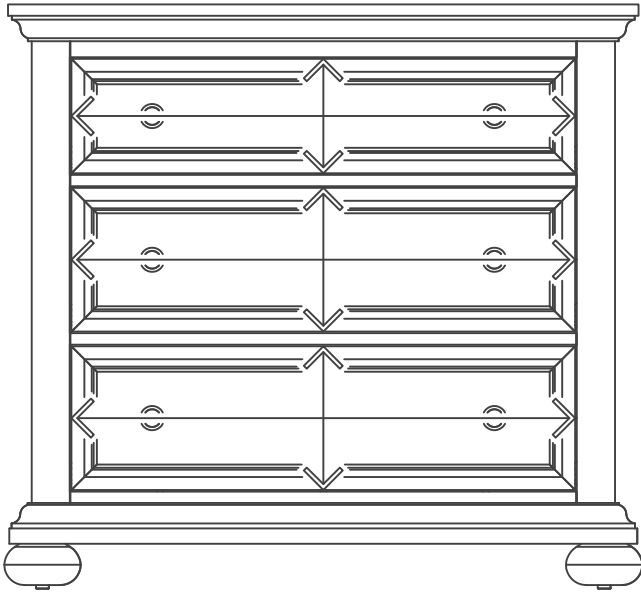

STEP 16

Insert the drawers into the unit, then adjust the drawer front panels left or right and up or down until the drawer gaps look proportional.

STEP 17

Pull each drawer open slowly and re-tighten the screws from Step 15.

Make sure the front panel does not move and lock the drawer front panel into position with 3/4" Flat Head Screws.

Note: These 3/4" Flat Head Screws must be installed to complete the drawer assembly.

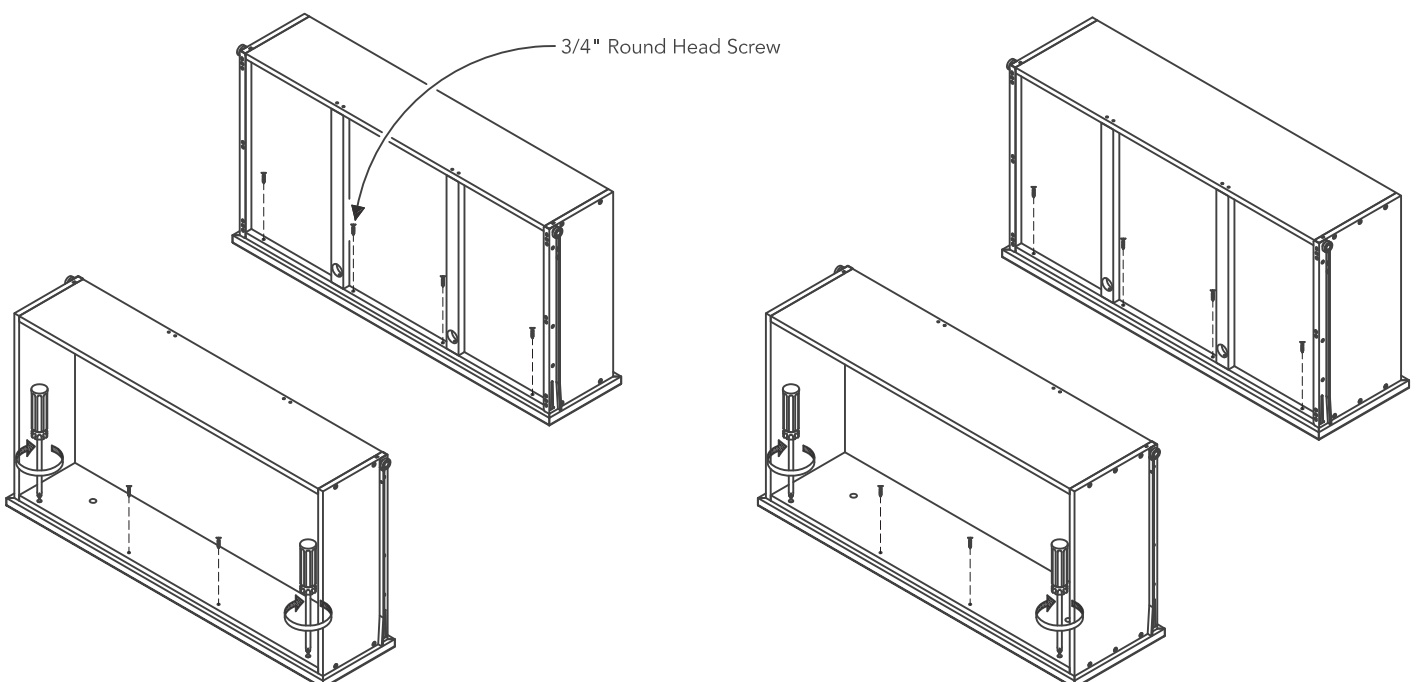

STEP 18

Slide Drawers (K) and (L) into place.

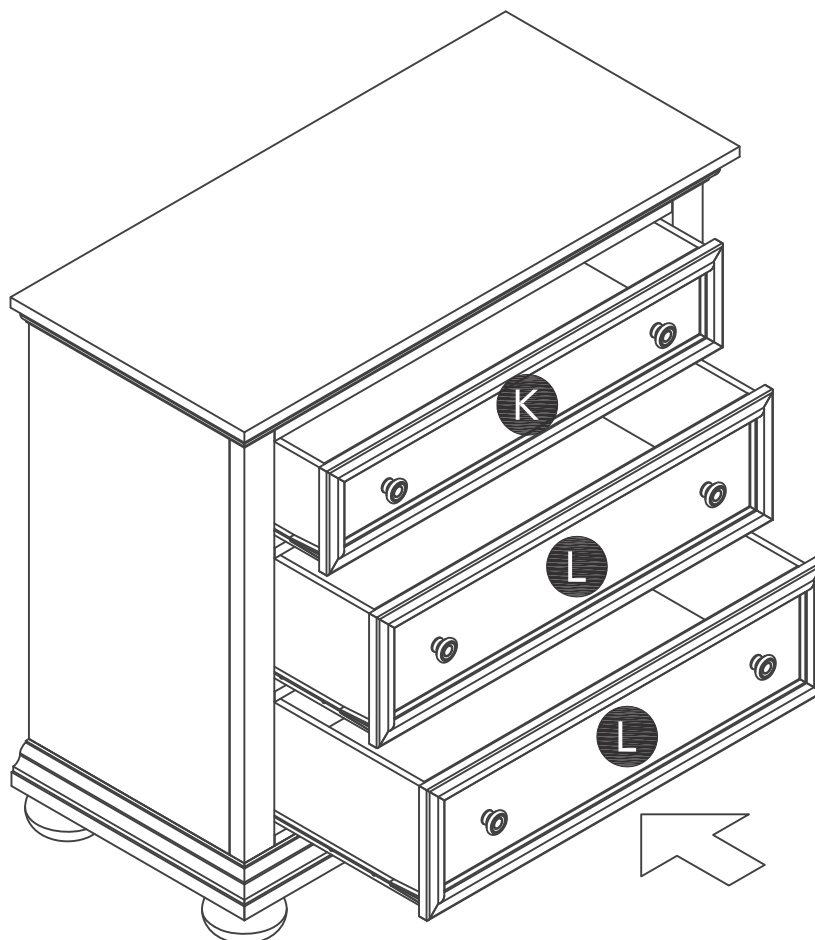

CARE INSTRUCTIONS

NEVER

allow liquids to remain on furniture.
Absorption causes parts to warp
and split and finishes to delaminate.

NEVER

use glass cleaners on
finished furniture. Ammonia
chemically attacks the finish.



Do not use power tools
above 8 volts to assemble.

**PREVENT
CRACKING**



Do not place
in direct sunlight.

**PREVENT
FADING**



Do not write
directly on surface.

**PREVENT
MARKING**



Do not place hot
objects on surface.

**PREVENT
FINISH DAMAGE**



Do not use rubber
based placemats.

**PREVENT
DISCOLORING**



Do not use commercial
waxes and polishes.

**PREVENT
YELLOWING**

CLEAN

with a soft cloth moistened
in lukewarm soap and water.
Buff with a dry clean cloth.



Home Styles will provide replacements free of charge for missing or damaged hardware or parts within 30 days of purchase. Digital images of the defective parts may be required. If the product was not purchased from an authorized retail affiliate, Home Styles is under no obligation to provide replacement parts. Parts are not available for fully assembled items nor are parts available for sale. Replacements for missing or damaged hardware or parts may be requested at:

www.homestyles-furniture.com/customer-service/replacement-parts

Home Styles Customer Service: www.homestyles-furniture.com,
servicedesk@homestyles-furniture.com, 888-680-7460, 877-831-0319