

Clutch Swivel

SCHOOLHOUSE

NOTES:

- Clutch Swivel can be completely disassembled if Threaded Pin is unscrewed from Knob.

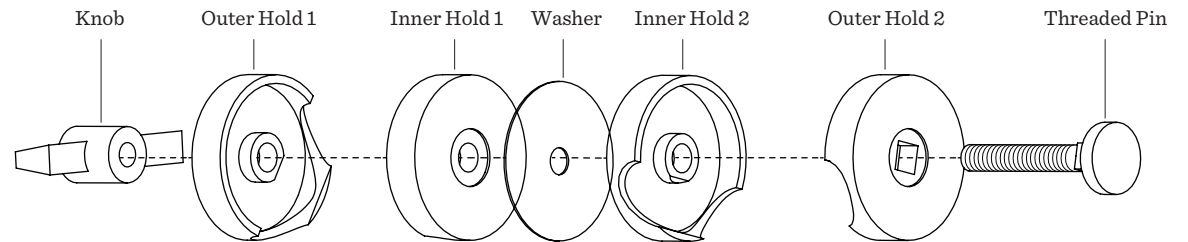

INSTALLATION INSTRUCTIONS

1. Loosen the Clutch Swivel by turning the knob counter clockwise.
2. Slide Arm 1 and Swivel down onto Arm 2. Turn the knob clockwise to set the desired Arm position.

