



# WINDING SHOWERS TABLETOP FOUNTAIN WITH LED LIGHT DW-662

Review all assembly and care information before using this product.  
Save this manual for future reference.

**Select a smooth, level surface to place the fountain.**

**Assemble components of this fountain on a soft, clean surface  
to avoid scratching or damaging the finish.**



**NOTE:** As a result of the manufacturing process, there may be loose pieces of casting materials inside the fountain.



Inspect packaging to ensure all parts are accounted for before disposing of packing materials.  
Save the packing slip.

• • • • SunnydazeDecor.com • • • •

Thank you for choosing Sunnydaze Decor. We stand behind our brand and the quality of the items we sell. Replacement parts or products can be requested within the 1-year warranty period. Proof of purchase must be provided. This includes the date of the purchase as well as photos of the product defect. Photos are used to determine the cause of the defect and to provide future quality control. The request will be reviewed, and replacement pieces will be sent at our discretion. For warranty information, visit <https://tiny.cc/SunnydazeWarranty>

If you have any questions, comments or concerns, feel free to contact us by phone at 833-982-1977, by email: [customerservice@sunnydazedecor.com](mailto:customerservice@sunnydazedecor.com), or via our contact us page at <https://tiny.cc/SunnydazeContact>

Purchase Date: \_\_\_\_ / \_\_\_\_ / \_\_\_\_ Order/Customer Reference Number: \_\_\_\_\_

*Write down the purchase date and order information to help expedite customer service inquiries.*

## **PREPARATION:**

Before beginning assembly, read all warnings and safety precautions.

## **⚠ WARNINGS & CAUTIONS:**

### **WARNINGS:**

To reduce the risk of electric shock, only connect the pump to a Ground Fault Circuit Interrupter (GFCI) outlet.

Do not exceed the voltage shown on the pump.

Always disconnect the pump from the power source before performing any maintenance or work on the pump, light(s), or any fountain fittings.

Inspect the pump and power cord for damage before installation and maintenance. If damage is found, the pump should be replaced.

### **CAUTIONS:**

Use a proper power source as indicated on the pump label. Keep the cords away from high temperatures and heat sources.

Do not lift the pump by its power cord.

Keep the fountain out of reach of children and pets.

Do not let the pump run dry. The pump must be completely submerged for proper operation and cooling.

Do not pump heated liquids.

Operate with freshwater only. Avoid heavily chlorinated water and water with high PH levels.

Do not use harsh chemicals such as bleach to clean the fountain or pump.

## ASSEMBLY:

Assemble components of this fountain on a soft, clean surface to avoid scratching or damaging the finish.

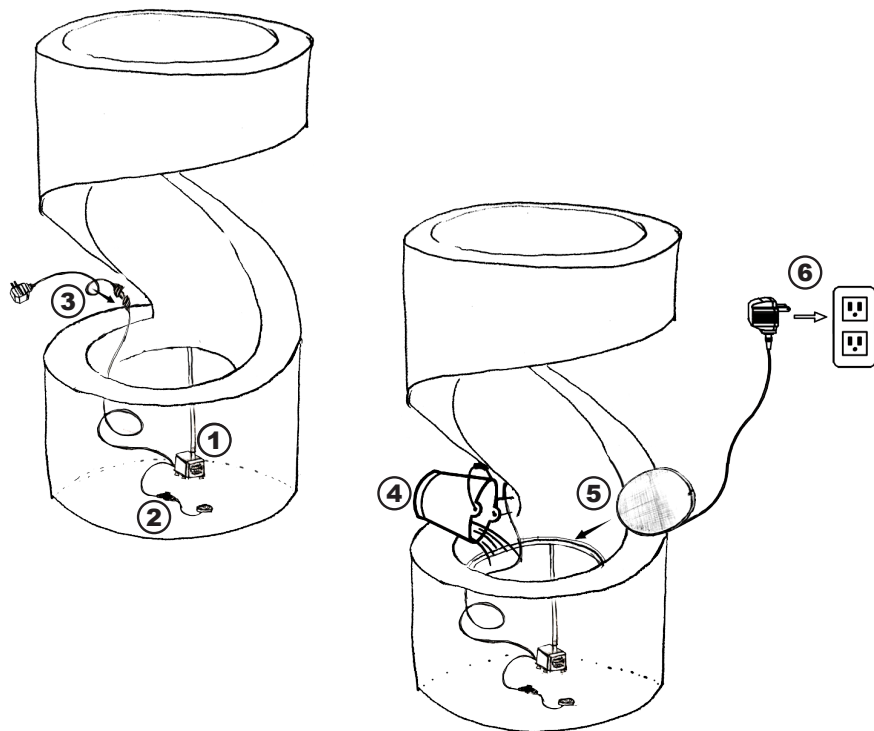

1. Connect the electric submersible pump to the tubing that is inside the fountain.
2. Connect the shorter pump cable to the LED light and place the light in the basin of the fountain.
3. Connect the longer pump cable to the AC adapter.
4. Fill the fountain with enough water to keep the pump fully submerged during operation, approximately 6 cups.
5. Place the splash screen onto the fountain basin.
6. Plug the power cord into a properly grounded GFCI outlet.

**Note:** When first used, there may be air in the pump.

It may take several minutes for the air to escape and water begins to flow.

## ! IMPORTANT INFORMATION !

### USE & CARE

- For indoor use only.
- Keep fountain out of reach of children and pets.
- Keep power cord away from all heat sources. Do not place electrical cords in areas with high temperatures.
- Check the water level frequently to ensure the pump remains fully submerged; never allow the pump to run dry as it will burn out the motor.
- Only use water in this fountain; distilled water is recommended to prevent mineral buildup.
- Periodically change the water to keep the water, fountain and pump clean. Remove scale and buildup regularly.  
DO NOT use harmful additives such as bleach, chlorine, etc.  
DO NOT use anything abrasive to scrub the fountain.
- Always shut off the power supply before cleaning and maintaining the fountain and the recirculating pump.
- Take care when handling the pump; only pick it up by the body of the pump, never the power cord.

### TROUBLESHOOTING

- Ensure the pump is fully submerged under water. Add water to the basin as necessary.
- Check to make sure the power outlet is working; consult a certified electrician if in doubt about electrical connections.
- Check the pump and tubing for obstructions.
- Check the flow control on the body of the pump as it may need to be adjusted to achieve the desired flow rate.
- If the lights are not working, ensure the cables are fully connected and the seals are adequately tightened (do not over-tighten).
- If water is not flowing within several moments of the fountain being plugged in, unplug the power supply for a few moments and plug it back in. The pump may have air bubbles in the filter, which can prevent water from circulating properly and cause excess pump noise.

**Any modification to the product or failure to follow recommended care will void the product warranty.**