

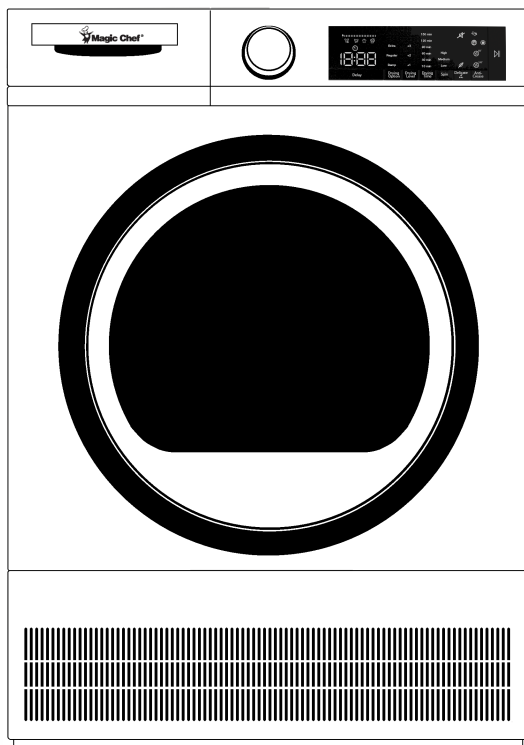

24" Front Load Dryer

User's Manual



Models: MCSDRY24W1

**PLEASE READ THIS MANUAL CAREFULLY BEFORE USING
YOUR DRYER AND KEEP IT FOR FUTURE REFERENCE.**



PRODUCT REGISTRATION

Thank you for purchasing a Magic Chef® product. The first step to protect your new product is to complete the product registration on our website: www.mcappliance.com/register.

The benefits of registering your product include the following:

1. Registering your product will allow us to contact you regarding a safety notification or product update.
2. Registering your product will allow for more efficient warranty service processing when warranty service is required.
3. Registering your product could act as your proof of purchase in the event of insurance loss.

Once again, thank you for purchasing a Magic Chef® product.

CONTENTS

PRODUCT REGISTRATION 2

PRECAUTIONS 4

IMPORTANT SAFETY INSTRUCTIONS 5

SPECIFICATIONS 8

PARTS AND FEATURES..... 8

INSTALLATION INSTRUCTIONS..... 9

OPERATION INSTRUCTIONS 13

CARE AND MAINTENANCE..... 17

TROUBLESHOOTING..... 19

WARRANTY..... 21

PRECAUTIONS

1. This appliance can be used by children aged from 8 years and above and persons with reduced physical, sensory, or mental capabilities or lack of experience and knowledge if they have been given supervision and instruction concerning use of the appliance in a safe way and understand the hazards involved. Children must not play with the appliance. Cleaning and user maintenance must not be made by children without supervision. Children of less than 3 years should be kept away unless continuously supervised.
2. This dryer is intended only for household and indoor use. The warranty will be void in case of commercial use.
3. Use this product only for items with a label that indicates they are suitable for drying.
4. The manufacturer is not responsible for damages resulting from incorrect use or transport.
5. DO NOT allow floor coverings to obstruct the ventilation openings.
6. Installation and repair of the machine should only be made by an authorized repair agent. The manufacturer cannot be held responsible for damages resulting from unauthorized repairs.
7. **▲WARNING:** Never spray or pour water onto the dryer to wash it! There is risk of electric shock!
8. **ALWAYS** leave at least 1.25" (3 cm) of space between the side, top, and rear walls of the dryer.
9. Assembly / disassembly for under-counter installation, if necessary, must be done by an authorized service agent.
10. Before installation, check the product for visible damage. Never install or operate a damaged product.
11. Keep pets away from the dryer.
12. Fabric softeners, or similar products, should be used in accordance with the manufacturer's instructions.
13. Remove all objects from pockets such as lighters and matches.
14. The appliance must not be installed behind a lockable door, a sliding door or a door with a hinge on the opposite side to that of the tumble dryer, if it prevents the door from being fully opened.

▲ WARNING:

- DO NOT put any living thing in the appliance for any purpose.
- Condensation water, which accumulates in the water tank, may contain external particles such as detergent residue, thread, and lint. For this reason, the water accumulated in the water tank should not be used for any purpose.
- Opening the door before the cooling process is finished may cause exposure to steam or hot air.
- Do not take the laundry out of the machine before the program ends.
- Blocking the airflow can reduce the machine's performance.

IMPORTANT SAFETY INSTRUCTIONS

▲WARNING - To reduce the risk of fire, electric shock, or injury to persons when using your appliance, follow basic precautions, including the following:

1. Read all instructions before using the appliance.
2. DO NOT dry articles that have been previously washed in, soaked in, or spotted with gasoline, dry-cleaning solvents, or other flammable or explosive substances, as they give off vapors that could ignite or explode.
3. DO NOT allow children to play on or in the appliance. Close supervision of children is necessary when the appliance is used near children.
4. Before the appliance is removed from service or discarded, the door must be removed.
5. DO NOT reach into the appliance if the drum is moving.
6. DO NOT install or store this appliance where it will be exposed to the weather.
7. DO NOT tamper with or modify the control panel.
8. DO NOT repair or replace any part of the appliance or attempt any servicing unless specifically recommended in the user-maintenance instructions or in published user-repair instructions that you understand and have the skills to carry out.
9. DO NOT use fabric softeners or products to eliminate static unless recommended by the manufacturer of the fabric softener or product.
10. DO NOT use heat to dry articles containing foam rubber or similarly textured rubber-like materials.
11. Clean lint screen before or after each load.
12. ALWAYS keep area around the exhaust opening and adjacent surrounding areas free from the accumulation of lint, dust, and dirt.
13. The interior of the dryer and exhaust duct should be cleaned periodically by qualified service personnel.
14. DO NOT place items exposed to cooking oils in your dryer. Items contaminated with cooking oils may contribute to a chemical reaction that could cause a load to catch fire. To reduce the risk of fire due to contaminated loads, the final part of a tumble dryer cycle occurs without heat (cool down period). Avoid stopping a tumble dryer before the end of the drying cycle unless all items are quickly removed and spread out so that the heat is dissipated.

ELECTRICAL SAFETY

1. The appliance must not be supplied through an external switching device, such as a timer, or connected to a circuit that is regularly switched on and off by a utility.
2. DO NOT touch the plug with wet hands. To reduce the risk of electric shock, ALWAYS pull the plug to unplug the product. DO NOT pull on the cord to unplug.
3. ALWAYS connect the dryer to a grounded socket with fuse protection. Have the ground connection installed by a qualified electrician. Our company cannot be held responsible for damages/losses resulting from using the dryer without a proper ground connection as required by local regulations.
4. The voltage and the allowable fuse protection are indicated on the rating plate on the unit.
5. Voltage and frequency values indicated on the rating plate must be equal to the mains voltage and frequency value in your house.
6. To reduce the risk of shock or damage to the appliance, ALWAYS unplug the dryer when it is not in use for an extended period, and before installation, maintenance, cleaning and repair.
7. The plug socket must be freely accessible at all times after installation.
8. A damaged power cord/plug can cause fire or give you an electric shock. When damaged it must be replaced, this should only be done by qualified personnel.
9. To avoid the risk of fire or electric shock, DO NOT use extension cords or adapters to connect the dryer to mains power.

▲ CALIFORNIA WARNING: This product can expose you to chemicals including Diisononyl phthalate (DINP) which is known to the State of California to cause cancer. For more information go to www.P65Warnings.ca.gov

GROUNDING INSTRUCTIONS

1. This appliance must be grounded. In the event of malfunction or breakdown, grounding will reduce the risk of electric shock by providing a path of least resistance for electric current. This appliance is equipped with a cord having an equipment-grounding conductor and a grounding plug. The plug must be plugged into an appropriate outlet that is properly installed and grounded in accordance with all local codes and ordinances.
2. **▲ WARNING:** Improper connection of the equipment-grounding conductor can result in a risk of electric shock. Check with a qualified electrician or service representative if you are unsure that the appliance is properly grounded.
3. DO NOT modify the plug provided with the appliance: if it will not fit the outlet, have a proper outlet installed by a qualified electrician.

CHILDREN'S SAFETY

1. This appliance is not intended for use by persons (including children) with reduced physical, sensory or mental capabilities, or lack of experience and knowledge, unless they have been given supervision or instruction concerning use of the appliance by a person responsible for their safety.
2. This appliance can be used by children aged from 8 years and above and persons with reduced physical, sensory or mental capabilities or lack of experience and knowledge if they have been given supervision or instruction concerning use of the appliance in a safe way and understand the hazards involved. Children must not play with the appliance. Cleaning and user maintenance must not be made by children without supervision.
3. DO NOT leave children unattended near the machine.
4. Children might lock themselves in the machine resulting in risk of death.
5. DO NOT allow children to touch the door during operation. The surface may become extremely hot and may cause skin damage.
6. Keep packaging material away from children.
7. Poisoning and irritation may occur if detergent and cleaning materials are consumed or come into contact with the skin and eyes.
8. Keep cleaning materials out of the reach of children.
9. Electrical products may be dangerous for children.
10. Keep children away from the product while it is running.
11. To prevent children from interrupting the dryer cycle, you can use the child lock to avoid any changes in the running program.
12. DO NOT allow children to sit on or climb inside the product.

PRODUCT SAFETY

 **Due to risk of fire, the following laundry items and products should NEVER be dried in the dryer:**

1. DO NOT dry unwashed items in the dryer.
2. Items that have been soiled with substances such as cooking oil, acetone, alcohol, petrol, kerosene, spot removers, turpentine, waxes and wax removers should be washed in hot water with an extra amount of detergent before being dried in the tumble dryer.

3. Cleaning cloths and mats that have residues of flammable cleaning agents or acetone, gas, petrol, stain remover, turpentine, candle, wax, wax remover or chemicals.
4. Laundry that has residues of hair sprays, nail polish remover and similar substances.
5. Laundry on which industrial chemicals have been used for cleaning (such as chemical cleaning).
6. Laundry that has any kind of foam, sponge, rubber or rubber-like parts or accessories. These include latex foam sponge, shower caps, waterproof fabrics, fitted clothes and foam pillows.
7. Items with filling and damaged items (pillows or jackets). Foam protruding from these items may catch fire during the drying process.
8. Operating the dryer in environments that contain flour or coal dust may cause explosion.

⚠ ATTENTION: Underwear that contains metal reinforcements should not be put in the dryer. The dryer may be damaged if metal reinforcements come loose and break off while drying.

CORRECT USE

⚠ ATTENTION: Never stop a tumble dryer before the end of the drying cycle unless all items are quickly removed and spread out so that the heat is dissipated.

⚠ ATTENTION: Make sure that pets do not enter the dryer. Check the inside of the dryer before using it.

⚠ ATTENTION: Super heating of clothes inside of the dryer can occur if you cancel the program or in the event of a power failure whilst the dryer is running. This concentration of heat can cause self-combustion so always activate the Refresh program to cool down or quickly remove all laundry from the dryer in order to hang them up and dissipate the heat.

1. Use the dryer only for household drying and to dry fabrics with a label that indicates they are suitable for drying. All other uses are out of the scope of intended use and are prohibited.
2. The warranty will be void in case of any commercial use.
3. This appliance is designed to be used inside domestic residences only, and should be placed on a straight and stable surface.
4. DO NOT lean against or sit on the door of the dryer.
5. To maintain a temperature that will not harm the laundry (e.g. to prevent the laundry from catching fire), a cooling process starts after the heating process. After this, the program ends. At the end of the program, always remove the laundry promptly.
6. When the heating cycle ends, the dryer uses a cooling cycle to lower the temperature of the items in it. ALWAYS be sure to remove items promptly when drying cycle is complete.

⚠ ATTENTION: NEVER use the dryer without a lint filter or with a damaged lint filter.

7. Lint filters must be cleaned after each use. See "Cleaning the Lint Filter" instructions on page 19.
8. To prevent malfunctions during the drying process, lint filters must be dried if wet from cleaning.
9. DO NOT allow lint to accumulate around or in the dryer.

⚠ IMPORTANT: Use dryer on a smooth, flat surface that will not reduce the clearance at the bottom of the unit to ensure sufficient air intake.

10. DO NOT install the dryer in rooms where there is risk of freezing. Freezing temperatures negatively affect the dryer's performance. Condensation that freezes in the pump and hose may cause damage.

**READ AND FOLLOW THIS
SAFETY INFORMATION CAREFULLY
SAVE THESE INSTRUCTIONS**

SPECIFICATIONS

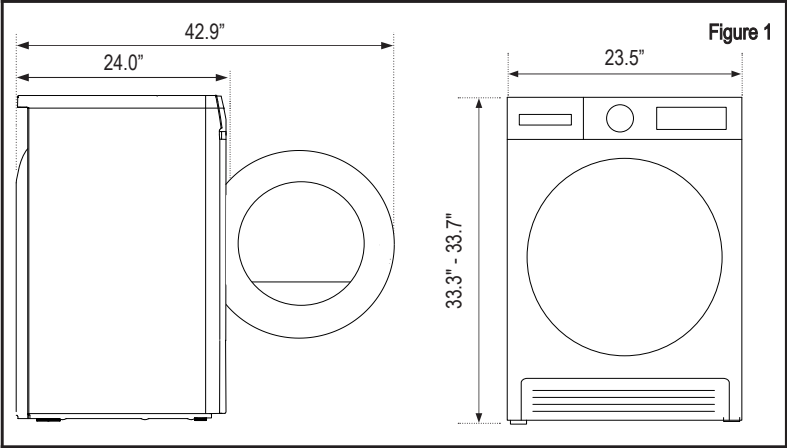

Model	MCSDRY24W1
Width	23.46" (596 mm)
Height	33.27" ~ 33.66" (845mm ~ 855 mm*)
Depth	23.98" (609 mm)
Net Weight	80.5 lbs (36.5 kg)
Voltage	208-240 V
Power	2700 W

PARTS AND FEATURES

- a. Control Knob
- b. Tray
- c. Lint Filter
- d. Control Panel
- e. Door
- f. Ventilation Grill
- g. Adjustable Feet

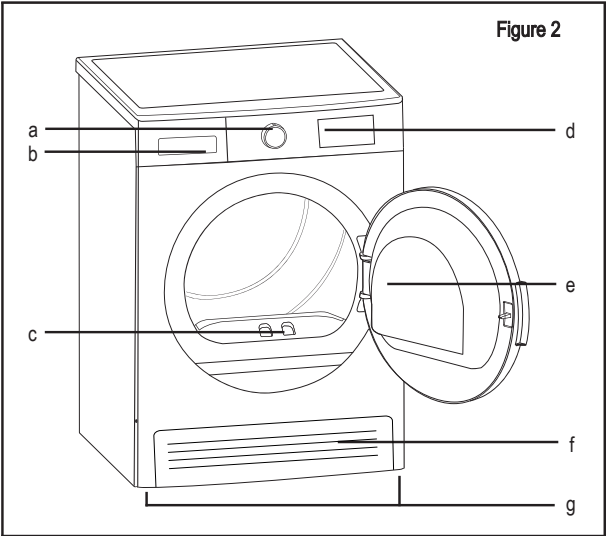

INSTALLATION INSTRUCTIONS

Install the clothes dryer according to the manufacturer's instructions and local codes. The dryer must be installed by a qualified installer or service person.

▲ WARNING: Risk of Fire

DO NOT install a clothes dryer with flexible plastic venting materials. If flexible metal (foil type) duct is installed, it must be of a specific type identified by the manufacturer as suitable for use with clothes dryers. Flexible venting materials are known to collapse, be easily crushed, and trap lint. These conditions will obstruct clothes dryer airflow and increase the risk of fire.

To reduce the risk of severe injury or death, follow all installation instructions.

- Save these instructions.
- Before contacting a local Authorized Service Provider for the installation of the dryer, check the information in the user manual to make sure that the electrical installation and water outlet is suitable. If they are not, call a qualified electrician and/or plumber to have the necessary adjustments made.
- It is the customer's responsibility to prepare the dryer's installation place, as well as the electricity and waste water installation. Before installation, check the dryer for damage. If damaged, do not have it installed. Damaged products may endanger your health.
- Install the dryer on a stable and flat surface.
- Install the dryer in a dust-free environment where the air ventilation is good.
- The clearance between the dryer and the floor should not be reduced with objects such as carpets, wood or tape.
- DO NOT block the ventilation grills found on the bottom front of the tumble dryer.
- The appliance must not be installed behind a lockable door, a sliding door or a door with a hinge on the opposite side of the tumble dryer, in such a way that blocks the full opening of the tumble dryer door.
- Once the dryer has been installed, the connections must remain stable. When installing the dryer, make sure that the rear surface is not leaning on or pushing anything (e.g., water tap, electric socket).
- The operating temperature of the dryer is 40°F~ 95°F (5°C ~ 5°C). If operated out of this temperature range, the performance of the dryer may be affected negatively and the product could be damaged.
- Be careful when moving the product and have someone assist you due to the weight of the product. ALWAYS wear safety gloves.
- The dryer should be installed against a wall where it will not be a trip hazard.
- When the product is placed on a stable surface, use a water level to check if it is fully stable. If not, adjust the feet until it becomes steady. Repeat this process every time you relocate the product.
- The dryer should be placed on a stable surface and leveled using the adjustable feet and a bubble level. Be sure that the unit is level and steady when installing or after moving the unit.
- DO NOT place the dryer on the power cable.
- Install the clothes dryer according to the manufacturer's instructions and local codes.

CONNECTION TO WATER OUTLET (WITH OPTIONAL DRAIN HOSE)

In products with a condenser unit, water accumulated in the water tank during the drying process. The water tank must be emptied after each drying process. Alternatively, you can use the included water drain hose to drain the water directly into a sink or floor drain.

CONNECTING THE WATER DISCHARGE HOSE

1. Pull out the end of the hose at the back of the dryer. Do not use any tools or sharp objects to take out the hose. (a)
2. Fit one end of the included water discharge hose into the slot from which you have removed the hose. (b)
3. Fix the other end of the water discharge hose directly to floor drain or sink. (c)

⚠ ATTENTION: The hose must be connected in a manner that it cannot easily fall out or be removed. If the hose comes out during water discharge, flooding may occur.

⚠ IMPORTANT: The water discharge hose must be installed at a maximum height of 31.5" (80 cm).

⚠ IMPORTANT: The water discharge hose must not be bent, folded or crimped between the outlet and the product.

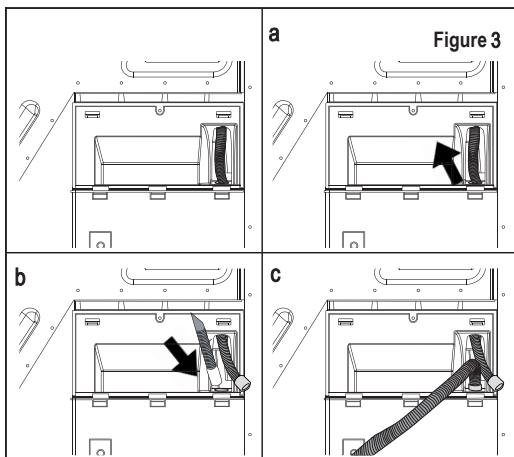

ELECTRICAL CONNECTION

⚠ ATTENTION: Risk of fire and electric shock.

- Your dryer is set to 208-240 V and 60 Hz.
- The mains cable of the dryer is equipped with a NEMA 14-30P / 30A, 125V/250V plug. This plug must be connected to an properly grounded socket protected by a fuse of 16 Amperes as indicated on the type plate. The fuse current rating of the power line where the outlet is connected must also be 16 amperes. Consult a qualified electrician if you do not have such an outlet or fuse.
- Our company cannot be held responsible for damages resulting from usage without earthing.

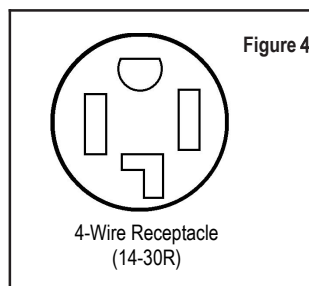

⚠ IMPORTANT: Operating your machine at low voltage values will shorten the service life and decrease the performance of your dryer.

ELECTRIC INSTALLATION

- The clothes dryer installation must be performed by a qualified installer.
- Install the appliance according to the manufacturer's instructions and local codes.
- To reduce the risk of severe injury or death, follow all installation instructions.
- Do not use an extension cord.

UNDER COUNTER INSTALLATION

- Leave at least 3 cm of space between the side and rear walls of the product and the underside of the worktop when installing your product under a counter.
- Assembly / disassembly under the counter if necessary must be done by authorized service.

LEVELING THE DRYER

The dryer must be positioned on a flat surface. It should not be placed on sloping, angled floors.

- In order for the dryer to operate more quietly and without vibration, it must stand on its feet properly and in balance. Make this balance by adjusting the feet.
- Adjust by turning the feet to the right OR left until the dryer stands level and balanced.
- Product should not be placed on sloping, uneven and crooked floors.
- Use a bubble level to make sure the dryer is level front to back and side to side.

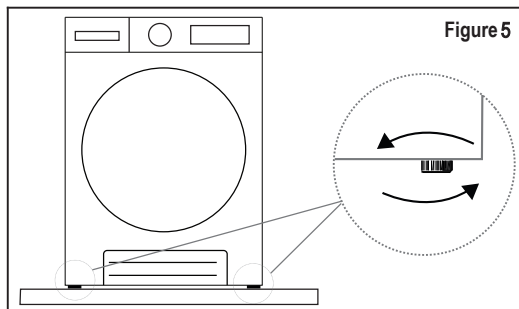

INSTALLING ON TOP OF A WASHING MACHINE

⚠ ATTENTION: A washing machine cannot be placed on top of the dryer. Take note to the warnings below when installing the dryer on a washing machine.

⚠ ATTENTION: The dryer can only be placed on washing machines that have same capacity and above.

- To use the dryer on the washing machine, a connecting piece must be used between the two products. The fixing part must be attached by an Authorized Service Provider.
- When the dryer is placed on the washing machine, the total weight of these products may reach almost 330 lbs (when loaded). Place the products on a solid floor that has a load bearing capacity.

In order to put the dryer machine onto the washing machine, a special stacking kit is required as an optional accessory. Please contact customer service if this accessory is needed. The assembly instruction will be included with the stacking kit.

Dryer Depth	Installation Table for Washing Machine and Tumble Dryer				
	Washing Machine				
	14.5-16.1" (37-41 cm)	16.5-17.7" (42-45 cm)	18.1-19.2" (46-49 cm)	19.6-22.0" (50-56 cm)	22.4-24.8" (57-63 cm)
20.6" (52.5 cm)	X	✓	✓	✓	✓
22.0" (56.0 cm)	X	X	✓	✓	✓
24.0" (61.0 cm)	X	X	X	✓	✓
25.1" (64.0 cm)	X	X	X	X	✓



The symbol on the product or its packaging indicates that this product may not be treated as household waste. Instead it shall be handed over to the applicable collection point for the recycling of electrical and electronic equipment. By ensuring this product is disposed of correctly, you will help prevent potential negative consequences for the environment and human health, which could otherwise be caused by inappropriate waste handling of this product. For more detailed information about recycling of this product, please contact your local city office, your household waste disposal service or the shop where you purchased the product.

OPERATION INSTRUCTIONS

CONTROL PANEL OPERATION

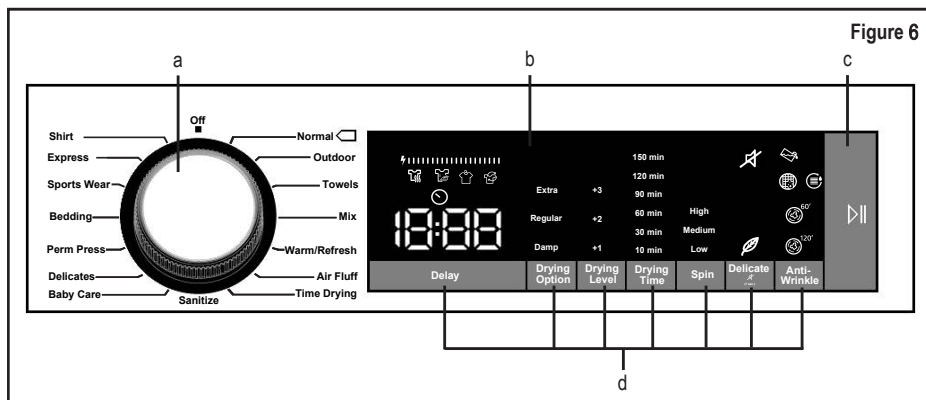

⚠ WARNING: To reduce the risk of fire, electric shock, or injury to persons, read the IMPORTANT SAFETY INSTRUCTIONS before operating this appliance.

- a. Program Selection Knob: Use to select desired drying program.
- b. Display Panel: Displays selected programs and options; indicates remaining time.
- c. Start / Pause Button: Starts or pauses the drying program.
- d. Options Buttons: Use to select desired program options.

PROGRAM SELECTION

Turn the program selection knob to select the dry programs that best meets your needs:

Normal: This program dries cotton laundry including bedsheets, pillowcases, pajamas, underwear, tablecloths etc.

Outdoor: This program is suitable for outdoor clothing, waterproof jackets, jackets with inner insulation, etc.

Towels: This program dries thick cotton laundry such as towels, bathrobes, etc.

Mix: This program dries cotton-synthetic mixed garments that do not discolor to make them ready to wear.

Warm Refresh: Warm refresh helps wool textiles to remove excess water after washing by applying low temperature and gentle movements of drum.

Air Fluff: Time drying option is selected from 10 minutes to 150 minutes without providing hot air to refresh and eliminate odors.

Time Drying: To reach the required drying level at a low temperature, you can use the time programs of 10 min. to 150 min. Regardless of the drying level, the program stops at the desired time.

Sanitize: This program is suitable for the fabrics which need hygiene requirements.

Baby Care: This program provides hygienic drying for delicate infant clothes at a low temperature.

Delicates: This program dries thin clothes like shirts, blouses and silk garments at a low temperature to make them ready to wear.

Perm Press: This program dries synthetics, such as shirts, t-shirts, blouses, at a lower temperature compared to the cottons program.

Bulky: This program is used to dry single duvet with feather, down or synthetic fillings.

Sports Wear: Sport program is used for synthetic sport items like shorts, t-shirts at low temperature.

Express 29': 4.4 lbs. (2 kg) of cotton shirts spun at a high speed in the washing machine are dried in 29 minutes.

Shirts 12': 2 to 3 shirts are ready to be ironed in 12 minutes.

DRYING PROGRAM PARAMETERS

Program	Load (lb/kg)	Washing machine spin speed	Approximate humidity	Duration (minutes)
Normal + Regular Dry	19.8/9	1000	60%	158
Outdoor	4.4/2	800	40%	43
Towels	6.6/3	1000	60%	71
Mix	8.8/4	1000	60%	81
Warm Refresh	-	-	-	-
Air Fluff	-	-	-	-
Time Drying	-	-	-	-
Sanitize	6.6/3	1000	60%	59
Baby Care	6.6/3	1000	60%	68
Delicates	4.4/2	600	50%	41
Perm Press+Regular Dry	9.9/4.5	800	40%	61
Bulky	5.5/2.5	800	60%	127
Sports Wear	8.8/4	800	40%	53
Express 29'	4.4/2	1200	50%	29
Shirts 12'	1.1/0.5	1200	50%	12

Normal cycle was used to rate the dryer for energy efficiency. The normal cycle defaults to regular drying level and high temperature setting. Cycles with the low heat setting save the most energy. Use the low heat setting for auto dry cycles without any level adjust to save on energy and prevent over drying your clothing.

DISPLAY PANEL INDICATOR LIGHTS



Water tank full light: Indicates that the water tank is full and needs to be empty.



Lint filter light: Indicates that the lint filter needs to be cleaned.



Condenser cleaning light: Indicates that the condenser needs to be cleaned.



Delicate dry cycle light: Lit when the dryer is using the delicate drying setting.

 Delay Timer: Indicates the dryer is set for a delayed start.

 Anti-Wrinkle 60': Indicates a 60 minute Anti-wrinkle cycle.

 Anti-Wrinkle 120': Indicates a 60 minute Anti-wrinkle cycle.

 Mute: Audible tones have been silenced.

Drying Step Display: The display shows the current drying steps throughout the program. Every time a program step starts, the relevant drying step light turns on. Once the drying step is complete, the relevant drying step light turns off.

 Drying

 Air Dry

 Anti-Wrinkle

 End

Energy Consumption Display



The energy consumption display shows the energy consumption of the selected program. The more bars lit up on the display, the higher the energy consumption. The energy consumption level increases or decreases depending on the fabric type, duration of the selected program, the drying level and the spinning speed.

ADDITIONAL FUNCTIONS

Delay Start: Select the drying program and press the Delay button to set the dryer to start at a later time. The delay can be set between 1-23 hours by pressing the Delay button until the time display shows the number of hours you wish to delay the start of the program. Once the time is set, press the Start/Pause button. After the set time has passed, the drying program will begin. Program options compatible with the set program can be set and changed while the program start is delayed.

Drying Option: Select the drying target suitable for your laundry to be dried. Choose Extra Dry for thick and multilayer laundry that takes time to dry, Regular Dry for regular, single-layer laundry and Damp Dry for laundry that you wish to leave slightly damp for ironing.

Level Adjust: Choose the level of drying desired beyond the standard setting, +1 (low), +2 (medium), +3 (high). When selected, the indicator will be lit.

Drying Time: When the program knob is set to Time Drying, press the Drying Time button to select the length of time for the drying cycle, then press Start/Pause to start the program.

Spin: Select a spin speed of Low, Medium, or High

Anti-Wrinkle: If you do not open the door of the machine at the end of the program, the anti-wrinkle option will be active for 60 minutes except when using the normal program. When the option is selected, anti-wrinkle will be active for 120 minutes.

Delicate: Delicate fabrics are dried in a longer time at low temperatures.

Mute: The dryer will give an audio warning when the buttons are pressed, when the program selection knob is turned and when the program ends. To cancel audio warnings, press and hold the "Anti-Wrinkle Option" for 3 seconds. When you press this button, you will hear an audible warning that indicates that the option has been activated and the audible warnings will be muted.

Child Lock: Prevents changes to the program when keys are pressed during operation. To activate the child lock feature, press the "Drying Option" and "Anti-wrinkle" buttons simultaneously for 3 sec. When the child lock is set, all keys will be deactivated. Child lock does not automatically turn off at the end of the program. To deactivate child lock at end of the program, set the program selection knob to "Off" position and press "Options" and "Anti-wrinkle" buttons simultaneously for 3 sec.
When activating /deactivating the child lock, "CL" will show on display for 2 sec and an audible warning will be heard.

⚠ ATTENTION: When the product is running and the child lock is active, if you turn the program selection knob you will hear an audible warning and "CL" will show on display for 2 sec. and the current program will continue running. To select a new program, deactivate the child lock and then set the program selection knob.

Temperature Level: Use to adjust the temperature level to low, medium and high depending on the items being dried.

Available Options by Program

Program	OPTIONS								
	Drying Level	Delay Start	Buzzer Cancel	Child Lock	Delicate	Time Drying	Level Adjust	Anti-wrinkle	Temp. Level
Normal	✓	✓	✓	✓	✓	X	✓	✓	✓
Outdoor	✓	✓	✓	✓	✓	X	✓	✓	✓
Towels	✓	✓	✓	✓	✓	X	✓	✓	✓
Mix	✓	✓	✓	✓	✓	X	✓	✓	✓
Warm Refresh	X	✓	✓	✓	X	X	X	✓	X
Air Fluff	X	✓	✓	✓	X	X	X	✓	X
Time Drying	X	✓	✓	✓	X	✓	X	✓	✓
Sanitize	✓	✓	✓	✓	X	X	✓	✓	X
Baby Care	✓	✓	✓	✓	✓	X	✓	✓	✓
Delicates	✓	✓	✓	✓	✓	X	X	✓	X
Perm Press	✓	✓	✓	✓	✓	X	✓	✓	✓
Bulky	X	✓	✓	✓	✓	X	X	✓	X
Sports Wear	X	✓	✓	✓	✓	X	✓	✓	✓
Express	✓	✓	✓	✓	X	X	X	✓	X
Shirts	✓	✓	✓	✓	X	X	X	✓	X
✓ =Selectable X = Not selectable									

CARE AND MAINTENANCE

⚠ IMPORTANT: Do not use industrial chemicals to clean your dryer. Do not use a dryer that has been cleaned with industrial chemicals.

Cleaning the Lint Filter

The lint filter should be cleaned after each use of the dryer, or when the lint filter clean indicator light '  ' comes on.

To clean the lint filter:

1. Open the loading door.
2. Pull the lint filter up to remove it.
3. Pull the top of the filter apart to open it up.
4. Use your hands or a soft cloth to remove any lint.
5. Close and refit the lint filter into it's correct position.

NOTE: If necessary, gently rinse the filter with warm water and allow to completely dry before placing back into the dryer.

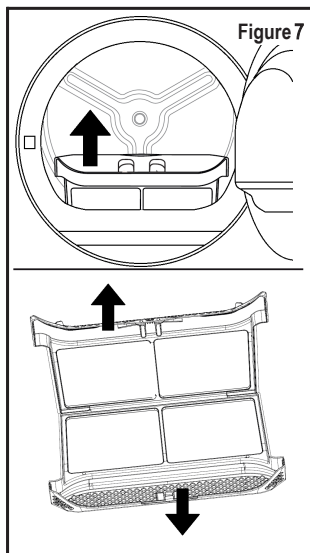

Emptying the Water Tank

1. Pull the drawer cover and carefully take out the tank.
2. Empty the water in the tank.
3. If there is lint accumulated on the discharge cap in the tank, clean it with water.
4. Replace the water tank in the dryer.

⚠ IMPORTANT: NEVER remove the water tank when the program is running.

⚠ CAUTION: The water condensed in the water tank is not suitable for human consumption.

NOTE: DO NOT forget to empty the water tank after each use or whenever the indicator '  ' is lit.

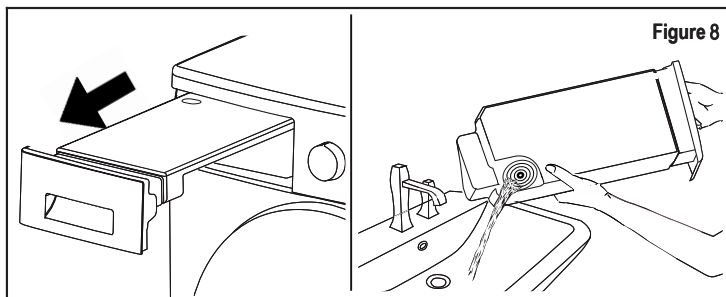

Cleaning the Humidity Sensor

There are humidity sensors in the dryer that detect whether the laundry is dry or not, and they should be cleaned regularly to ensure they continue working properly.

1. To clean the sensors:
2. Open the dryer door.
3. If the unit is still hot from the drying process, allow it to cool down.
4. Wipe the metal surfaces of the sensor using a soft cloth soaked in vinegar and carefully wipe them dry.

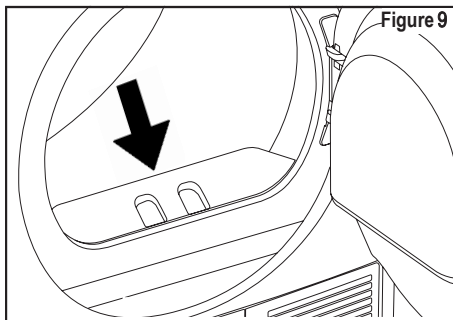

⚠ WARNING: Due to the risk of fire and explosion, do not use solution agents, cleaning agents or similar products when cleaning the sensors.

⚠ IMPORTANT: DO NOT use metal tools to clean the metal surfaces of the sensor.

⚠ IMPORTANT: Clean the humidity sensor 4 times a year.

Cleaning the Condenser

⚠ IMPORTANT: Clean the condenser after every 30 uses, once a month, or when the Condenser Cleaning icon '🧼' is lit.

1. Open the access door on the bottom left corner of the dryer.
2. Push the locking tabs and pull out the condenser.
3. Thoroughly rinse with water and allow to drain.
4. Reverse steps 1 and 2 to reinsert the condenser.

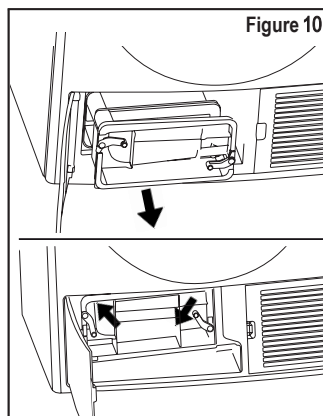

TROUBLESHOOTING

Your dryer is fitted with systems that continuously perform checks during the drying process to take the necessary measures and warn you in case of any malfunction.

⚠ WARNING: If the problem persists even if you have applied the steps in this section, please contact the your dealer or an Authorised Service Provider. Never try to repair a nonfunctional product.

PROBLEM	POSSIBLE CAUSE	SOLUTION
The drying process takes a long time.	The surface of the lint filter might be clogged.	Wash the filter with lukewarm water.
	The condenser might be clogged.	Clean the condenser.
	The ventilation grills in front of the machine might be closed.	Open the doors/windows to prevent the room temperature from rising too much.
	Limescale may be built up on the humidity sensor.	Clean the humidity sensor.
	The dryer might be overloaded.	Do not overload the dryer.
	The laundry might be insufficiently spun.	Select higher spin speed while washing.
Laundry comes out damp at the end of the drying process.	⚠ The laundry that comes out hot at the end of the drying process generally feels more humid.	
	The program used might not be suitable for the type of laundry.	Check the care labels on the items, select a suitable program for the type of laundry and use the time programs.
	The lint filter might be clogged.	Wash the filter with lukewarm water.
	The condenser might be clogged.	Clean the condenser.
	The dryer might be overloaded.	Do not overload the dryer.
	The laundry might be insufficiently spun.	Select a higher spin speed while washing.
The dryer cannot be opened or the program cannot be started. The dryer does not get activated when adjusted.	The dryer might not be plugged in.	Make sure that the unit is plugged in.
	The door might be open.	Make sure the door is properly closed.
	Program not set or Start not pressed.	Make sure that the program has been set and the dryer is not in the Standby (Pause) mode.
	Child lock might be active.	Deactivate the child lock.
The program has been interrupted for no reason.	The door might not be closed properly.	Make sure that the door is properly closed.
	There might have been a power failure.	Press the Start/Pause key to restart .
	The water tank might be full.	Empty the water tank.
Clothes have shrunk, felted or deteriorated.	The program used might not be suitable for the type of laundry.	Check the care labels on the laundry items, select a suitable program for the type of laundry.

PROBLEM	POSSIBLE CAUSE	SOLUTION
Water leaking from the door.	There might be lint accumulated on the inner surfaces of the door and on the surfaces of the gasket of the door.	Clean the inner surfaces of the loading door and the surfaces of the gasket of the door.
The door opens on its own.	The door might not be closed properly.	Push the loading door until you hear the closing sound.
The water tank warning symbol is on/flashing.	The water tank might be full.	Empty the water tank.
	The water discharge hose might be bent.	If connected directly to the water outlet, check the water discharge hose.
The condenser cleaning warning symbol is on.	The condenser needs cleaning.	Clean the condenser.
The filter cleaning warning symbol is on.	The lint filter needs cleaning.	Clean the filter.
	The filter seat might be clogged by lint.	Clean the filter seat.
The program won't start and the filter warning light is blinking	The filter seat might be clogged by lint.	Clean the filter seat.
	There might be a layer that causes obstruction on the surface of the lint filter.	Wash the filter with lukewarm water.
	The condenser may not be correctly placed.	Place the condenser correctly.
The program can not be started and both condenser and filter warning leds are blinking	The condenser and filter may not be placed correctly.	Clean the filter seat.
	The filter and condenser warning leds are blinking even though the filter and condenser are placed.	Contact customer service.

ERROR CODES	SOLUTION
E00	Contact customer service.
E03 / 	Empty the water tank. if problem persists, contact customer service.
E04	Contact customer service.
E05	Contact customer service.
E06	Contact customer service.
E08	There may be voltage fluctuation in mains.Wait until voltage is appropriate for working range.



LIMITED WARRANTY

MC Appliance Corporation warrants each new Dryer to be free from defects in material and workmanship, and agrees to remedy any such defect or to furnish a new part(s), at the company's option, for any part(s) of the unit that has failed during the warranty period. Parts and labor expenses are covered on this unit for a period of one year from the date of purchase. A copy of the dated sales receipt or invoice is required to receive warranty service, replacement or refund. In the event the unit requires replacement or refund under the terms of this warranty, the consumer is responsible for all transportation expenses to return the unit to our factory prior to receiving a replacement unit or refund. A copy of the dated sales receipt/invoice is required to receive warranty service, replacement or refund.

This warranty covers appliances in use within the contiguous United States. This warranty does not cover the following:

- Damages due to shipping damage or improper installation.
- Damages due to misuse or abuse.
- Content losses due to failure of the unit.
- Inside components such as door panels, shelves, racks, light bulbs, etc.
- Repairs performed by unauthorized service agents.
- Service calls that do not involve defects in material and workmanship such as instructions on proper use of the product or improper installation.
- Replacement or resetting of house fuses or circuit breakers.
- Failure of this product if used for other purposes than its intended purpose.
- Disposal costs for any failed unit not returned to our factory.
- Any delivery/installation costs incurred as the result of a unit that fails to perform as specified.
- Expenses for travel and transportation for product service if your appliance is located in a remote area where service by an authorized service technician is not available.
- The removal and re-installation of your appliance if it is installed in an inaccessible location or is not installed in accordance with published installation instructions.
- Refunds for non repairable products are limited to the price paid for the unit per the sales receipt.
- This warranty is non transferable. This warranty applies only to the original purchaser and does not extend to any subsequent owner(s).

LIMITATIONS OF REMEDIES AND EXCLUSIONS

Product repair in accordance with the terms herein, is your sole and exclusive remedy under this limited warranty. Any and all implied warranties including merchantability and fitness for a particular purpose are hereby limited to one year or the shortest period allowed by law. MC Appliance Corporation is not liable for incidental or consequential damages and no representative or person is authorized to assume for us any other liability in connection with the sale of this product. Under no circumstances is the consumer permitted to return this unit to the factory without the prior written consent of MC Appliance Corporation.

Some states prohibit the exclusion or limitation of incidental or consequential damages, or limitations on implied warranties. This warranty gives you specific legal rights, and you may also have other rights which vary from state to state.

Model
MCSRY24W1

Parts & Labor
One-Year

Type of Service
In Home

For Service or Assistance please call 888-775-0202 or visit us on the web at www.mcappliance.com to request warranty service or to order parts.

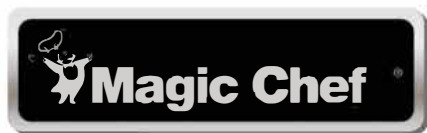

CNA International, Inc. d/b/a MC Appliance Corporation. All rights reserved. Magic Chef® is a registered trademark of CNA International, Inc.
www.mcappliance.com

Printed in Turkey