

PIVOTAL™

**Models/Modelos/Modèles
9693-DST & 9693T-DST**

RP92603▲
Spout Assembly with Sprayer
Conjunto de piezas del surtidor con rociador
Bec avec douchette

RP91784
Aerator & Wrench
Aereador y Llave
Aérateur et Clé

RP93285
Retainer
Funda
Douille

RP91902
Cartridge Assembly
Ensamble del la Válvula
Soupape

RP100680
Contact Spring
(9693T Only)
Resorte de Contacto
(9693T Solamente)
Ressort de contact
(9693T Seulement)

RP74776
Bonnet Nut
Tuerca
Écrou

RP93282▲
Handle, Set Screw & Button
Manija, tornillo de presión y Botón
Poignée, vis de calage et bouton

RP93280▲
Base & Gasket
Base y empaque
Base et joint

RP92605
Indicator Base Assembly
(9693T Only)
Ensamble de la base con indicador
(9693T Solamente)
Base à voyant indicateur
(9693T Seulement)

RP13938
O-Rings (2)
Anillos "O" (2)
Joints torique (2)

RP90781
O-Ring
Anillo O
Joint toriques

RP93283▲
Cap & O-Ring
Bonete y Anillo O
Chapeau et Joint toriques

RP93281▲
Set Screw & Button
Tornillo de Ajuste y botón
Vis de calage et bouton

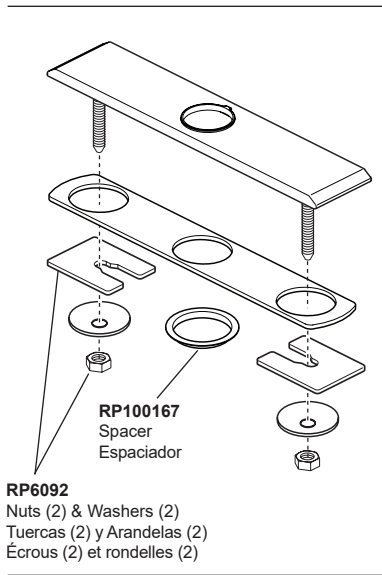

RP92233▲
Escutcheon, Mounting Screws (2), Gasket, Nuts (2) & Washers (2) (not included)
Chapa, tornillos de montaje (2), empaque, tuercas (2) y arandelas (2) (no se incluyen)
Plaque de finition, vis de montage (2), joint, écrous (2) et rondelles (2) (non inclus)

RP60911
Clip
Presilla
Agrafe

RP51243
Inlet Gaskets
Empaques para el tubo de entrada
Joints côté alimentation

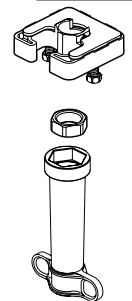

EP92546

Solenoid Assembly
Ensamble de Solenoide
Électrovanne

For PC, PN, SS, AR & KS finishes, order **EP92546**
For PL, MW, RB & SP finishes, order **EP92546**

Para acabados PC, PN, SS, AR y KS, ordene **EP92546**
Para acabados PL, MW, RB y SP, ordene **EP92546**

Pour les finis PC, PN, SS, AR et KS, commandez **EP92546**
Pour les finis PL, MW, RB et SP, commandez **EP92546**

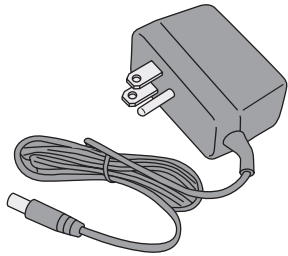
**EP102157**

9 Volt Power Supply
(Accessory Order Only)
Fuente de alimentación de 9 voltios
(Orden de accesorios solamente)
Alimentation électrique 9 volts
(L'accessoire seulement)

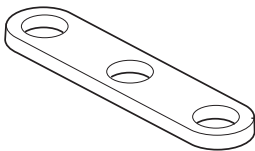
**RP37490**

Thin Deck Aid (Not Included)
Soporte para encimera delgada
(No incluido)
Plaque de renfort (non incluse)

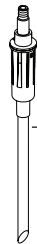
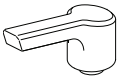
**RP47888**

Bottle & Pump
Botella y Bomba
Bouteille et pompe

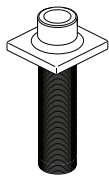
**RP21945**

Nut
Tuerca
Ecrou

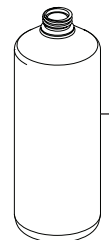
**RP91950▲**

Dispenser Assembly
Ensamble del Dispensador
Distributeur

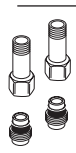
**RP53468**

Check Valves
Válvulas Checadoras
Clapets de non-retour

**RP93410**

Filter
Filtro
Filtre

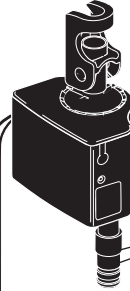
**RP13938**

O-Ring (2)
Anillo "O" (2)
Joint torique (2)

**RP60911**

Clip
Presilla
Agrafe

**RP78389**

Battery Box
Caja de la Batería
Boîtier de piles

Other useful accessories that may be purchased separately.
Otros accesorios útiles que se pueden comprar por separado.
Autres accessoires utiles pouvant être achetés séparément.

RP63263

Adapters
3/8"-24 UNEF to 1/2"-20 UN &
3/8"-24 UNEF to 1/2"-14 NPSM

Adaptadors
3/8"-24 UNEF a 1/2"-20 UN &
3/8"-24 UNEF a 1/2"-14 NPSM

Adaptateurs
3/8 po-24 UNEF à 1/2 po-20 UN et
3/8 po-24 UNEF à 1/2 po-14 NPSM

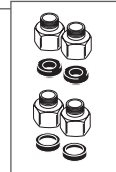
**RP63264**

Adapters (10) 3/8"-24 UNEF to 1/2"-20 UN
Adaptadors (10) 3/8"-24 UNEF a 1/2"-20 UN
Adaptateurs (10) 3/8 po-24 UNEF à 1/2 po-20 UN

**RP63265**

Adapters (10) 3/8"-24 UNEF to 1/2"-14 NPSM
Adaptadors (10) 3/8"-24 UNEF a 1/2"-14 NPSM
Adaptateurs (10) 3/8 po-24 UNEF à 1/2 po-14 NPSM

