



## **LiteMax DLX™**

**Rear-facing Child  
Restraint System**

**Infant Car Seat  
Owner's Manual**

**Keep for future use**

### **Rear-facing**

1.8 to 15.8 kg  
(4 to 35 lbs)

---

43 to 81 cm  
(17 to 32 in.)

**\*See page 6 for complete  
requirements.**

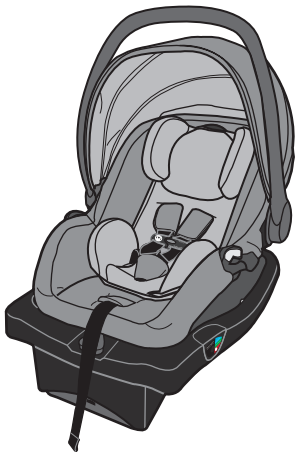

## **⚠️ WARNING**

To reduce the risk of serious injury or death, read this owner's manual prior to installing and using this child restraint.

**More children are killed every year as passengers in car crashes than by any other type of injury.**

To reduce the risk of **SERIOUS INJURY** or **DEATH**, read this owner's manual and your vehicle owner's manual before installing and using this child restraint.

Using a child restraint makes a big difference. By properly using this child restraint and following these instructions (and the instructions that accompany your vehicle), you will greatly reduce the risk of serious injury or death to your child from a crash.

Do not be misled by the commonly used term "safety seat"; no restraint system can prevent all injuries in all crashes. Many properly restrained adults and children are injured in motor vehicle crashes, including relatively minor crashes.

A properly used child restraint is the best way to minimize injuries to your child and to increase the chances for your child's survival in most crashes.

## **U.S. Regulatory Notice**

This child restraint meets all the requirements of Federal Motor Vehicle Safety Standard 213.

### **For Canadian Models**

## **CANADIAN REGULATORY NOTICE (MODEL NUMBERS ENDING IN "C")**

This child restraint meets all the applicable requirements of Canadian Motor Vehicle Safety Standard 213 and 213.1.

## ***Symbol Legend***

---



***Airbag Symbol*** – Alerts you to important information about airbag safety.



***LATCH Symbol*** – Alerts you to important information about LATCH safety.



***Aircraft Symbol*** – Alerts you to important information about aircraft safety.

## ***Table of Contents (TOC)***

Child Requirements .....	6
Premature Infant Use .....	8
Warnings .....	10
LATCH/UAS Warnings .....	22
Usage Warnings.....	26
Safe Practices.....	28
Recall Information for U.S. Customers.....	29
Public Notice for Canadian Customers.....	30
Motor Vehicle/Aircraft Usage .....	31
Base Features .....	32
Child Seat Features .....	34
Using the Handle.....	36
SafeZone Load Leg .....	39
Proper Installation WITH the Convenience Base ...	44
Installation Checklist .....	45
Installing the Convenience Base with the Lower Anchor Connector Assembly .....	48
Installing the Convenience Base with the Vehicle Lap/Shoulder Belt .....	56
Placing the Carrier in the Base .....	62
Releasing the Carrier from the Base .....	65



Proper Installation WITHOUT the Convenience Base.....	66
Installation Checklist.....	67
Installing the Carrier WITHOUT the Convenience Base.....	69
Securing the Child in the Carrier .....	75
Removing the Child from the Carrier .....	79
Changing the Crotch Strap Position.....	80
Changing the Waist Strap Position.....	84
Removing the Lower Anchor Connector Assembly	91
Using as an Infant Carrier.....	95
Securing Your Child Restraint in Aircraft.....	97
Installing Carrier WITHOUT Convenience Base in Aircraft .....	98
Installing the Canopy.....	103
Installing the Accessories.....	104
Removing the Seat Pad.....	106
Replacement Parts .....	110
Care and Cleaning.....	112
Proper Disposal of this Child Restraint.....	113
Limited Warranty .....	114
Storing Your Instructions.....	116

### CHILD REQUIREMENTS

**Warning:** Failure to follow these Child Requirements could result in serious injury or death.

This child restraint is designed for use by children in **rear-facing** orientation only. To use this child restraint properly, children **MUST** meet the size and age requirements below. In addition, Evenflo recommends consulting with your child's physician before allowing your child to transition from a **rear-facing** to **forward-facing** child restraint.

The American Academy of Pediatrics (AAP) recommends keeping children **rear-facing** until they reach the maximum height or weight for their child restraint in **rear-facing** orientation. Additionally, some states' laws require children to be **rear-facing** until age 2. Accordingly, you will see this guidance reflected in the Child Requirements. Please review any applicable local, state or provincial laws related to child passenger safety before installing and using this child restraint.

## **Rear-facing Use**

- 1.8 to 15.8 kg (4 to 35 lbs)
- 43 to 81 cm (17 to 32 in.) and top of child's head is at least 2.5 cm (1 in.) below the top of the child restraint seat back.

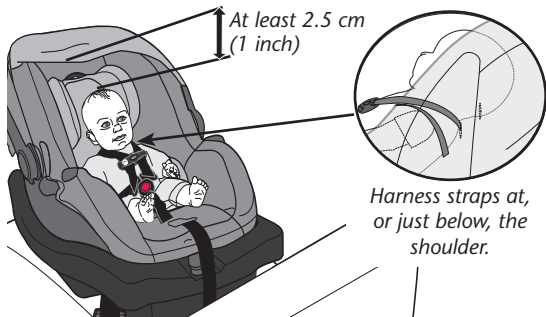

**IMPORTANT:** Once your child **exceeds** any of the size requirements above, they **MUST** discontinue use of this child restraint.

## Premature Infants

- **DO NOT** use this or any other child restraint with a premature infant until after consulting your doctor. Premature infants may have difficulty breathing when in a sitting position.

### **PREMATURE INFANT USE**

*Before using this child restraint for preterm or low birth weight infants, ensure the Child Requirements are met and follow the guidelines in this section.*

According to the U.S. National Highway Traffic Safety Administration, a properly installed child restraint reduces the risk of death by over 70% for infants involved in crashes. Federal Motor Vehicle Safety Standard (FMVSS) 213 establishes design and dynamic performance requirements for child restraint systems. However, the standard has no minimum weight limit and does not address the special medical needs of preterm or low birth weight infants. To ensure that preterm and low birth weight infants are transported safely, the guidelines published by the American Academy of Pediatrics (AAP) in Pediatrics 2009;123:1424–1429 must be followed. All children should ride rear-facing in the vehicle as long as possible. Preterm and low birth weight infants are at additional risk of breathing difficulties and heart problems when placed in a child restraint. Evenflo requires that the

evaluation recommended by the AAP be conducted for all infants born earlier than 37 weeks and all newborn infants who weigh less than 5 lb at birth before their first car trip to check for breathing difficulties or heart rate problems when traveling in a rear-facing child restraint.

The AAP recommends that appropriate hospital staff observe your infant in the child restraint for a period of 90 to 120 minutes or the duration of travel, whichever is longer. This period of observation must be performed with the infant properly positioned as described in these instructions and with the child restraint placed at an angle that is approved for use in the vehicle. The hospital staff will check for any breathing difficulties or heart rate problems. Your child's pediatrician will let you know if there are any special considerations for travel. The number of trips and the duration of time the infant is seated in the child restraint should be minimized. A caregiver should ride in the back seat to monitor the infant during travel.

You can learn more about the AAP's recommendations for observation of newborns and the guidelines for safe transportation of preterm and low birth weight infants, as well as other resources for parents and medical professionals, at [\*\*https://www.healthychildren.org/english/safety-prevention/on-the-go/Pages/default.aspx\*\*](https://www.healthychildren.org/english/safety-prevention/on-the-go/Pages/default.aspx)

# **WARNING!** *DEATH or SERIOUS INJURY can occur.*

## **General Warnings**

- Child restraints should be used only for travel. Potential adverse health effects from excessive use of infant child restraints have been documented. You should limit the time spent each day in a child restraint as much as possible. You must **NEVER** use your child restraint as a sleeping environment in the home. **NEVER** leave your infant unattended in a child restraint in or out of the vehicle.
- Failure to follow these installation instructions and the instructions and warnings on the product can result in your child striking the vehicle's interior during a sudden stop or crash. Serious injury or death may result. These instructions and the instructions in your vehicle owner's manual must be followed carefully. If there is a conflict between the two, the vehicle owner's manual regarding child restraint installation must be followed.
- This child restraint **MUST ALWAYS** face the **rear of the vehicle**. Serious injury or death can occur if used forward-facing.

# **WARNING!** *DEATH or SERIOUS INJURY can occur.*

- **NEVER** leave child unattended.
- **DO NOT** use child restraint if it is damaged, broken, or missing parts.
- **DO NOT** use this restraint if it has been involved in a crash. It must be replaced.
- **DO NOT** attach additional padding, toys or other devices not made by Evenflo or described in these instructions, to the child restraint. Items not tested with the child restraint could injure the child.
- Be sure that the handle is firmly locked in *Position 1 (Carry)* before lifting the child restraint (p. 36-37).
- This child restraint must be securely belted to the vehicle at all times, even when unoccupied. An unsecured child restraint may injure someone if a crash occurs.
- **FOR LOW BIRTH-WEIGHT INFANT**, you must always use the infant body support. The infant body support must be used for infants who weigh less than 2.7 kg (6 lbs).

**! WARNING!** ***DEATH or SERIOUS INJURY can occur.***



**DO NOT** place rear-facing child seat on front seat with air bag. **DEATH OR SERIOUS INJURY** can occur. The back seat is the safest place for children 12 and under.



# **! WARNING!** *DEATH or SERIOUS INJURY can occur.*



## **Air Bag Warnings**

***To help prevent serious injury or death:***

- **DO NOT** use this restraint in the front seat of a vehicle equipped with an air bag. Interaction between a rear-facing restraint and air bags may cause serious injury or death. If your vehicle has an air bag, refer to the vehicle owner's manual for child restraint installation. If the rear seat of your vehicle is equipped with side air bags, refer to the following information for proper usage.

### **Vehicles built prior to the 2002 model year:**

**DO NOT** use this restraint in a vehicle seating position equipped with a side air bag unless authorized by the vehicle manufacturer.

### **Model year 2002 and newer vehicles:**

Refer to your vehicle owner's manual before placing this restraint in a seating position equipped with a side air bag.

- **DO NOT** place any objects between the restraint and the side air bag, as an expanding air bag may cause the items to strike your child.

***The forward-facing back seat is the safest place for children 12 and under.***



# **! WARNING!** *DEATH or SERIOUS INJURY can occur.*

## **Location Warnings**

**To help prevent serious injury or death:**

- **ALWAYS** read and follow exactly the instructions that accompany your vehicle and child restraint.
- According to accident statistics, children are safer when properly restrained in a rear seating position than in a front seating position. Generally, the center rear is safest and should be used if available. Children 12 and under should ride in the back seat of the vehicle.
- If you are unable to use the center rear seating position and have to install this child restraint directly behind a front vehicle seat, ensure that there is at least 38 mm (1.5 inches) of space between any part of the child restraint and the vehicle seat that is closest to the child's head. This space may be necessary for the child restraint to properly perform in certain types of crashes.
- **ONLY** use this child restraint on forward-facing vehicle seats. **DO NOT** use on vehicle seats which face the rear or side.



# **! WARNING! *DEATH or SERIOUS INJURY can occur.***

- **ONLY** use this child restraint on vehicle seats with backs that lock into place.
- Some child restraints do not fit all vehicles or all seating locations. There are thousands of combinations of vehicle makes, models, child restraint configurations, seat belt designs, and seat cushion shapes. The easiest way to determine whether your child restraint is suitable for a particular seating position is to check for a tight installation. If the child restraint cannot be properly installed, **DO NOT** use this child restraint. Consult vehicle owner's manual, try a different seating location or call Evenflo at 1-800-233-5921 (U.S), or 1-937-773-3971 (Canada).

## **VEHICLE TYPES IN WHICH THE RESTRAINT SYSTEM CANNOT BE USED:**

This child restraint is not to be used in vehicles that do not have vehicle seat belts or Latch/UAS lower anchorages.

# **! WARNING!** *DEATH or SERIOUS INJURY can occur.*

## **Vehicle Seat Belt Warnings**

- **ALWAYS** read your vehicle owner's manual to determine what vehicle belts and retractors are used in your vehicle belt. The vehicle belt **MUST** lock and **MUST NOT** loosen after the seat belt is tightened.
- **DO NOT** use this child restraint if it moves more than 2.5 cm (1 in.) side-to-side or front-to-back at either the rear-facing or forward-facing belt path on the child restraint. Serious injury or death may result from poor installation. If you cannot tightly secure the child restraint, try again or move it to another location.
- **DO NOT** loosen the vehicle seat belt to provide more leg room as this will prevent the child restraint from protecting your child.
- **DO NOT** use this child restraint in a seating position with door-mounted seat belts.

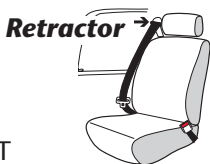

# **! WARNING!** *DEATH or SERIOUS INJURY can occur.*

- **DO NOT** use this child restraint in a vehicle with seat belts that automatically move along the vehicle frame when the door is opened.
- **DO NOT** use this child restraint in a vehicle equipped with lap belts that only lock during a sudden stop or crash (emergency locking retractor – ELR). You must use a seating location with a locking seat belt. Check your vehicle owner's manual to see if you have lap belts with ELRs.
- **DO NOT** use on vehicle seats when both portions of the vehicle belts are positioned forward of the seat crease.



# **! WARNING!** *DEATH or SERIOUS INJURY can occur.*

## **Vehicle Seat Belt Warnings (cont.)**

- **DO NOT** use with lap/shoulder belts with two retractors. If the vehicle seat belts are not routed and fastened correctly, the child restraint may not protect the child in a crash.
- **DO NOT** use with inflatable seat belts.
- Check your vehicle owner's manual to determine how to lock your seat belt for child restraint installation. The seat belt must be locked to properly secure the child restraint.
- **DO NOT** allow the vehicle seat belt release button to touch the child restraint. Accidental contact may cause the seat belt to release. If necessary, turn the seat belt release button away from the child restraint or move the child restraint to a different location.
- Failure to adjust the harness or vehicle seat belts snugly around the child may result in the child striking the vehicle's interior during a sudden stop or crash. Serious injury or death may occur.



# **WARNING!** *DEATH or SERIOUS INJURY can occur.*

- This child restraint must be securely belted to the vehicle, **even when it is unoccupied**, since in a crash an unsecured child restraint system may injure other occupants.
- Fold-down armrests could pose a hazard to a rear-facing child in certain types of collisions. Consult your vehicle owner's manual before installing any rear-facing child restraint in front of a fold-down armrest.
- The headrest on the vehicle seat that the child faces should be placed in the lowest position. The vehicle seat back that the child faces must be fully padded and free of any hard objects.

# **! WARNING!** *DEATH or SERIOUS INJURY can occur.*

## **Vehicle Seat Belt Warnings (cont.)**

If you have any of these types of vehicle belt systems listed, these are **SAFE** to use to install your child restraint in the vehicle. Review vehicle owner's manual for specific instructions on child restraint installation. **LATCH** can be used **IN PLACE OF** these vehicle belt types. Refer to your vehicle owner's manual for **LATCH** locations.

### **Lap Belt with Locking Latch Plate**

Once buckled, the vehicle belt is tightened by pulling on the free end of the strap until the belt is tight.



### **Lap Belt with Automatic Locking Retractor (ALR)**

The automatic locking retractor does not allow the lap belt to get longer once it is buckled. The vehicle belt is tightened by feeding seat belt webbing into retractor.

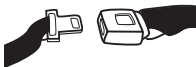



# **! WARNING! *DEATH or SERIOUS INJURY can occur.***

## ***Lap/Shoulder Belt with Locking Latch Plate***

---

The lap portion of this belt does not loosen once the belt is buckled.

The vehicle belt is tightened by pulling up hard on shoulder belt and feeding the extra webbing into the retractor.

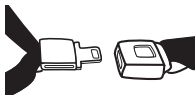

## ***Lap/Shoulder Belt with Sliding Latch Plate with Locking Retractor***

---

The latch plate slides freely along the lap/shoulder belt. Vehicle belts with sliding latch plates are typically locked at the shoulder belt retractor by buckling the belt and pulling all of the webbing out slowly to switch the retractor.

Check vehicle owner's manual for specific instructions. The vehicle belt is tightened after switching the retractor by pulling up on shoulder belt and feeding the webbing into the retractor.

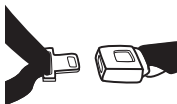

# **! WARNING!** *DEATH or SERIOUS INJURY can occur.*

## **LATCH /UAS Warnings**

What is **LATCH**?

**LATCH** is an acronym for (**L**ower **A**nchors and **T**ethers for **C**hildren) and refers to a pair of fixed Lower Anchors (or bars) and a Top Tether anchor that are built into your vehicle, in vehicles built after September 1, 2002.

The lower **LATCH** anchors are located in the crease, or bight, between the vehicle seat back and seat cushion, and if not visible, will typically be indicated by  symbols. Top tether anchors are located in various places behind the rear vehicle seat.

**Vehicle Top Tether Anchor Points (Forward-Facing Only)**

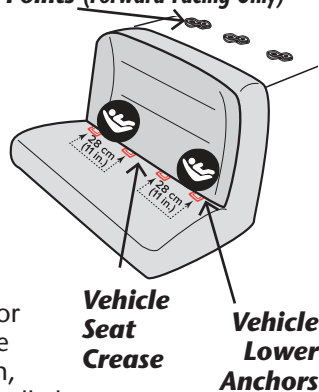

# **WARNING!** *DEATH or SERIOUS INJURY can occur.*

## **Center installation in a non-standard LATCH position:**

Center installation of this child restraint is permitted using inner Lower Anchor Bars from the outside seating positions if (1) your vehicle manual allows such installation; and (2) the inner Lower Anchor Bars from the outside seating positions are 28-51 cm (11-20 in.) apart.

**LATCH** typically offers an easier and more consistent installation. However, this child restraint can be safely installed using either **LATCH** or vehicle belts and meets the requirements of Federal Safety Standard FMVSS 213 with either installation method. Either method is safe for your child when installed correctly.

**DO NOT** install this child restraint with **LATCH** and the vehicle's seat belts at the same time. Your vehicle owner's manual may refer to this system as **ISOFIX**, **Universal Anchorage System (UAS)**, or **Lower Universal Anchorage System**.

# **WARNING!** *DEATH or SERIOUS INJURY can occur.*

## **LATCH /UAS Warnings**

- The LATCH system is intended to be used **ONLY** as described in these instructions. Serious injury or death may result from misuse. Refer to your vehicle Owner's Manual for lower anchor bar positions in your vehicle.
- In addition to these instructions, read and follow your vehicle owner's manual regarding installation of the child restraint and LATCH. If there is a discrepancy, follow your vehicle owner's manual.
- **ONLY** use for securing convenience base to vehicle lower anchor bars.
- **NEVER** attach two lower anchor assembly connectors to one vehicle lower anchor bar.
- **NEVER** use the vehicle seat belts when using the lower anchor connector assembly. Using both together can cause slack in a sudden stop or crash.

# **WARNING!** *DEATH or SERIOUS INJURY can occur.*

## **LATCH /UAS Warnings - continued**

- When not in use, the lower anchor connector assembly should be securely stored in the storage area located under the convenience base. Keep out of reach of children.
- **ALWAYS** be sure that the lower anchor connectors are fully engaged onto the vehicle anchor bars by pulling hard on the lower anchor connector assembly harness. If they are not totally engaged, the lower anchor connector assembly will not secure your child restraint. Serious injury or death may result.
- **DO NOT** use this child restraint if it moves more than 2.5 cm (1 in.) side-to-side or front-to-back at the vehicle belt path. Serious injury or death may result from poor installation. If you can not tightly secure the child restraint, try again or move it to another location.

# **⚠ WARNING!** *DEATH or SERIOUS INJURY can occur.*

## Usage Warnings

### **⚠ WARNING**

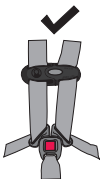
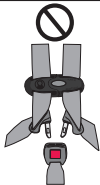

Children have **STRANGLED** in loose or partially buckled harness straps. Fully restrain the child even when carrier is used outside the vehicle.

- Use **ONLY** the LiteMax convenience base with the LiteMax carrier. The LiteMax carrier **WILL NOT LOCK** safely into any other convenience base and serious injury or death may result.
- **ALWAYS** check the restraint and buckle for hot surfaces before putting a child into the restraint. Your child could be burned.
- In cold weather, **DO NOT** dress the child in bulky clothing, like snowsuits, if the child is riding in a child restraint. This clothing makes it difficult to properly tighten the harness to the child, which may allow the child to be ejected from the restraint during a crash.

# **WARNING!** *DEATH or SERIOUS INJURY can occur.*

## **Usage Warnings - continued**

- **ALWAYS** place the handle in *Position 1* or *3* (U.S. models) or *Position 1* (Canadian models) when using this child restraint in a vehicle (p. 36-38).
- When using this restraint in *Position 4* (Stand) (p. 38), **ONLY** use on level ground and **NEVER** prop the restraint up with any object.
- **NEVER** place this child restraint on beds, sofas, or other soft surfaces. The child restraint can roll over on soft surfaces and suffocate the child.
- **NEVER** place this child restraint near the edges of counter tops, tables, other high surfaces, or in shopping carts. The child's movements can cause the child restraint to slide and fall.
- The canopy is not intended to provide UV protection.

## Safe Practices

- **Everyone rides buckled up or the vehicle does not go.** Make no exceptions for adults or children. If someone unbuckles, stop the vehicle. Being firm and consistent right from the start will mean fewer discipline problems as children get older. An unrestrained child or adult can be thrown into and injure other passengers.
- **NEVER** try to tend to a crying baby's needs while driving. **NEVER** take a baby out of a child restraint for comforting while the vehicle is moving.
- Always place the handle in *Position 3 or 4* before removing infant from carrier (p. 38).
- **DO NOT** allow a child to have objects such as lollipops or ice cream on a stick. The object can injure the child if the vehicle swerves or hits a bump.
- **DO NOT** feed an infant who is riding in a child restraint.
- Anything loose can be deadly in a crash. Put sharp or heavy items in the trunk.
- **DO NOT** dress the child in blanket sleepers or other clothing that would prevent the crotch strap from fitting snugly up against the child.



## ***Recall Information for U.S. Customers***

- Child restraints could be recalled for safety reasons. You must register this restraint to be reached in a recall. Send your name, address, e-mail address if available, and the restraint's model number and manufacturing date to:

**Evenflo Company, Inc.**

**1801 Commerce Dr.**

**Piqua, OH 45356**

**or call 1-800-233-5921.**

or register online at

**[www.evenflo.com/registercarseat](http://www.evenflo.com/registercarseat)**

<i>Tear off and mail this part</i>		
<small>Consumer: Just fill in your name and address and e-mail address.</small>		
<small>Your Name</small>		
<small>Your Street Address</small>		
<small>City</small>	<small>State</small>	<small>Zip Code</small>
<small>E-mail Address</small>		
<b>CHILD RESTRAINT REGISTRATION CARD</b>		

- For recall information call the U.S. Government's Vehicle Safety Hotline at 1-888-327-4236 (TTY:1-800-424-9153), or go to: **<http://www.NHTSA.gov>**

## Public Notice for Canadian Customers

- Child restraints could be recalled for safety reasons. You must register this restraint to be reached in a public notice. Send your name, address, e-mail address, and the restraint's model number, and manufacturing date to:

**Evenflo Company, Inc.**

**1801 Commerce Dr.**

**Piqua, OH 45356**

**or call 1-937-773-3971**

or register on-line at

**[www.evenflo.com/  
registercarseatcanada](http://www.evenflo.com/registercarseatcanada)**

CANADIAN RESIDENTS ONLY DOMICILIES DU CANADA SEULEMENT		26000187 8/15
<b>PRODUCT REGISTRATION CARD CARTE D'ENREGISTREMENT DU PRODUIT</b>		
1. Name Nom _____		
2. Street Address Adresse _____		
3. City Ville _____		4. Prov. Prov. _____
5. Postal Code Code postal _____		
6. Telephone Number (with Area Code) Num. de téléphone (et indicatif régional) ( ) _____		
7. Email Address Adresse électronique _____		
8. Date of Purchase Date d'achat _____		
<small>ATTENTION: This card may be important to the safety of your child. Please complete using blue or black ink and mail this card so that you can be contacted in the event of a safety defect notice on this product. <b>The information you provide must be complete.</b> Or register online at <a href="http://www.evenflo.com/registercarseatcanada">www.evenflo.com/registercarseatcanada</a>.</small>		
<small>ATTENTION : Cette carte pourrait être importante à la sécurité de votre enfant. Veuillez remplir cette carte à l'encre bleue ou noire et la poster afin de pouvoir être contacté en cas d'un avis de défaut lié à la sécurité de ce produit. <b>Les informations fournies doivent être complètes.</b> Ou enregistrez-vous en ligne à <a href="http://www.evenflo.com/registercarseatcanada">www.evenflo.com/registercarseatcanada</a>.</small>		
PLACE DATE/MODEL # LABEL HERE. AFFIXER L'ÉTIQUETTE DE LA DATE ET DU NUMÉRO DE MODÈLE ICI.		

- For public notice information, call Transport Canada at 1-800-333-0510 or go to **[www.tc.gc.ca](http://www.tc.gc.ca)**

**When used with the internal harness and properly installed pursuant to these instructions,**



this restraint is certified for use only in passenger and multi-purpose passenger motor vehicles, buses and trucks equipped with either lap belts only or lap/shoulder belt systems, and aircraft.

**Tip!**

*Check with your airline before departure to make sure this restraint meets their requirements.*

Refer to pages 97 to 102 for complete instructions on installing your child restraint in aircraft.

## Base Features

- 1. Level Adjustment Knob**  
(Not available on all models)
- 2. Angle Indicator**
- 3. Leveling Foot**
- 4. LATCH connector**
- 5. Vehicle Seat Belt/Lower Anchor Connector Assembly Belt Path**
- 6. One Step Lock-Off**
- 7. SafeZone™ Load Leg**  
(Available on all models)
- 8. Load Leg adjustment buttons**

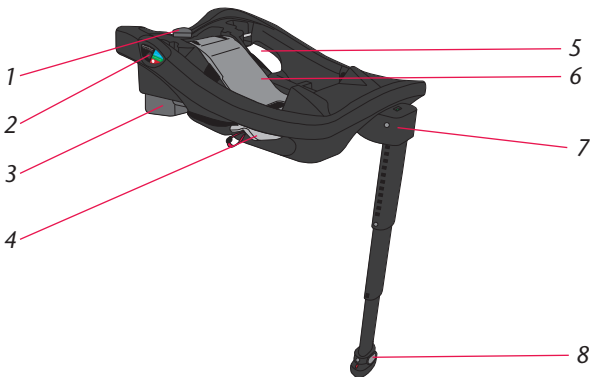

**9.** Load Leg storage

**10.** LATCH storage

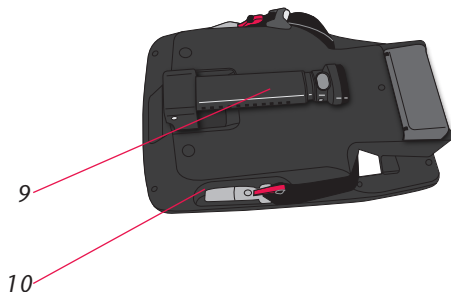

## Child Seat Features

- |                                  |                                      |
|----------------------------------|--------------------------------------|
| <b>1.</b> Handle                 | <b>9.</b> Headrest adjustment button |
| <b>2.</b> Canopy*                | <b>10.</b> Chest Clip                |
| <b>3.</b> Seat Pad               | <b>11.</b> Harness Straps            |
| <b>4.</b> Harness Covers*        | <b>12.</b> Carrier                   |
| <b>5.</b> Crotch Buckle          | <b>13.</b> Level Indicator           |
| <b>6.</b> Crotch Buckle Cover*   | <b>14.</b> Convenience Base          |
| <b>7.</b> Harness Release Button | <b>15.</b> Infant Body Support       |
| <b>8.</b> Harness Adjuster Strap |                                      |

### Front

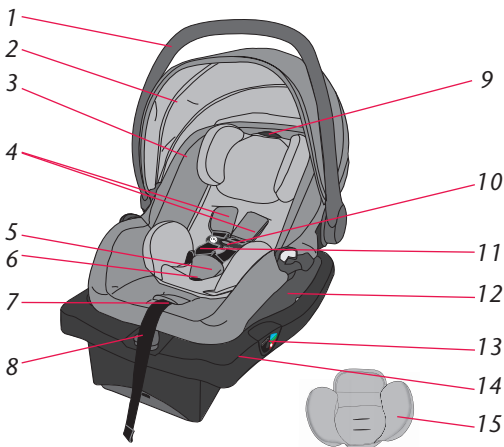

**16.** Handle adjustment button

**17.** Harness Straps

**18.** Splitter Plate

**19.** Carrier Release Handle

**20.** Waist strap slots

**21.** Waist strap

**22.** Crotch Strap Anchor

*\* Not all features are available on all models. Styles may vary.*

### Back

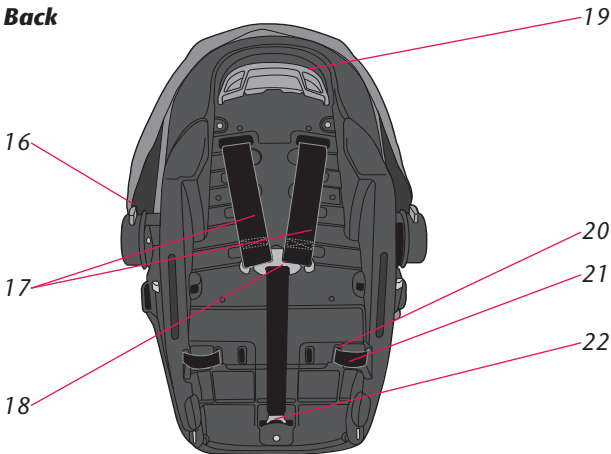

## Using the Handle

**To change handle positions,** squeeze **both Handle Releases** and rotate the handle to the desired position until it locks into place.

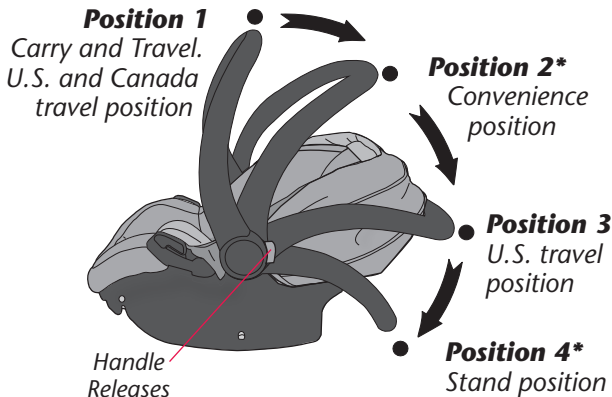

**\*IMPORTANT: NEVER** use **Positions 2** or **4** when traveling in a vehicle. U.S. and Canadian models differ in acceptable handle positions for travel (see illustrations on p. 37-38).



**IMPORTANT:** *Always* secure the child in the carrier. Refer to “Securing your Child in the Carrier” on p. 75- 78.

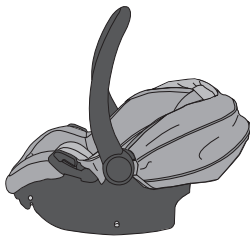

### **Position 1 (Carry and Travel – U.S. and Canada)**

This position is to be used to carry your child. For Canadian models, you **MUST** place the handle in this position when traveling in a vehicle.



### **Position 2 (Convenience)**

**NEVER** use this position to carry your child in the carrier. **NEVER** use this position in the vehicle.

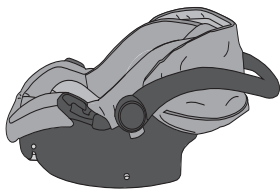

### **Position 3 (Travel – U.S.)**

For U.S. models, you may place the handle in this position while traveling in a vehicle.

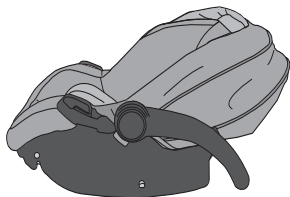

### **Position 4 (Stand)**

Place the handle in this position when you set the carrier on the floor. **NEVER** use this position in a vehicle.

# ⚠️ WARNING

The load leg helps minimize crash forces on a baby in a frontal crash. It allows the child restraint's safety system to absorb crash energy efficiently and transfer forces more effectively by directing them to the vehicle floor.



**NEVER USE** if the leg lifts the base off the vehicle seat.

**NEVER** install the load leg in a seating position that will not allow the leg to be extended in a **LOCKED** position with firm contact with the vehicle floor.



**NEVER** place load leg on a storage door compartment or the vehicle floor if the vehicle manufacturer warns against it. Some vehicle manufacturers do not allow the use of load legs in all seating positions. Please refer to your vehicle's owner's manual before installing the base with the load leg.

**NEVER** allow children to play with the belt tightener or the load leg.

# ⚠ WARNING

The load leg **MUST** be locked in a locked position and the foot **MUST** be in contact with the vehicle floor.

**NEVER** place load leg on an uneven floor in the rear of the vehicle. It must always be placed flat on the vehicle floor.

**NEVER** use the load leg to recline the seat. The **recline adjustment foot** on the base is intended to recline the seat.

**ALWAYS CHECK** to make sure the load leg is locked into the storage compartment in the base when it is not in use.



**1** Turn the base over as shown.

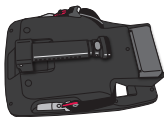

**2** Pull the load leg out as shown. You should hear a **CLICK**. Load leg indicator will change from red to green when the leg has been rotated into the use position.

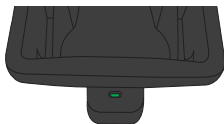
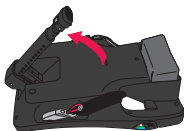

4

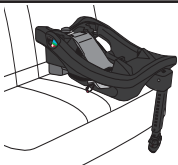

Turn base over and place base on the seat as shown.

5

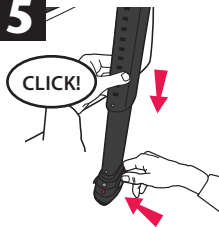

To extend load leg, pull leg down until it reaches the floor and the indicator turns green.

If it does not rest flat on the floor, push button and lower leg to floor to extend further. Indicator should turn green.

6



**ALWAYS CHECK** to make sure when the leg rests on the vehicle floor that it does not lift the base off the seat.

Leg must always lock into one of the open positions before using. If leg does not lie flat on the floor, move to another seating location or do not use the load leg in your vehicle.

**1**



**Although we recommend using the base with the load leg, in some cases it may not be possible, if it is not possible you should store load leg. To store load leg, follow steps below.**

To store load leg when you are not using it, push the button on the lower portion of the load leg, slide the lower portion back up until it locks into place, then rotate back into the stored location. The tab on the load leg foot is pressed into a slot in the storage location on the base. And it locks into position.

To store under base, reverse steps on p. 41.

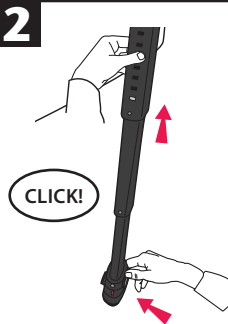

## Proper Installation *WITH* the Convenience Base

### Child Requirements

- **Weight:** 1.8 – 15.8 kg (4 – 35 lbs)
- **Height:** 43 – 81 cm (17 – 32 in.) and top of child's head is at least 2.5 cm (1 in.) below the top of the child restraint seat back.

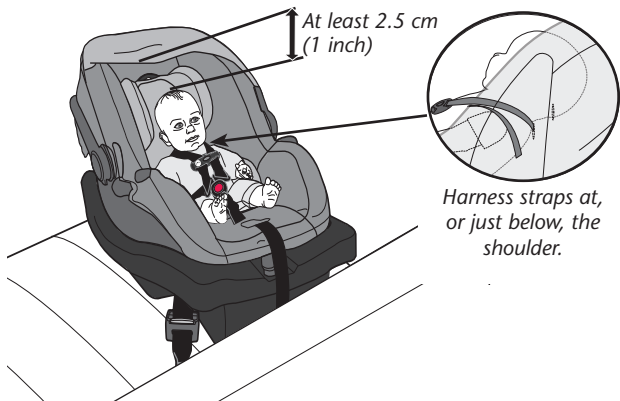

**IMPORTANT:** Once your child **exceeds** any of the size requirements above, they **MUST** discontinue use of this child restraint.



## Installation Checklist

### 1. **Secure convenience base to the vehicle seat.**

- ✓ Convenience base is securely installed with lower anchor connector assembly (shown) (p. 48-55).

**OR**

- ✓ Convenience base is securely installed with vehicle seat belt (p. 56-61).

**IMPORTANT:** *A properly secured convenience base does **NOT** move more than 2.5 cm (1 in.) from side-to-side or from front-to-back **at the lower anchor connector assembly/vehicle belt path.***

- ✓ Convenience base is adjusted so that level indicator is in correct color zone for your child (p. 56 - 57).
- ✓ If necessary, a towel/small blanket is rolled up and placed beneath the front edge of the base for additional leveling (p. 63).

## ***Installation Checklist (cont.)***

### **2. Secure child in the carrier.** Refer to p. 75.

- ✓ Harness straps are at, or below shoulder level (p. 44).
- ✓ Both buckle tongues are fastened (p. 77).
- ✓ Chest clip is connected and positioned at armpit level (p. 77).
- ✓ Harness straps are snug against the child and you should not be able to pinch the harness (p. 77).
- ✓ Crotch strap is snug against the child but **NOT** under the child's bottom (p. 83).
- ✓ Waist straps are snug against the child but **NOT** under the child's legs (p. 86).

### **3. Check your work.**

- ✓ The convenience base does **NOT** move more than 2.5 cm (1 in.) from side-to-side or from front-to-back **at the lower anchor connector assembly/vehicle belt path.**
- ✓ The base is level when level indicator is in the correct color zone for your child (p. 49 and 50).
- ✓ The handle is in *Position 1* or 3 (U.S. models **ONLY**), or *Position 1* (Canadian models **ONLY**) (p. 36).



**! WARNING! DEATH or SERIOUS INJURY can occur.**

- This lower anchor connector assembly is intended to be used **ONLY** as described in these instructions. Serious injury or death may result from misuse.
- In addition to these instructions, read and follow your vehicle owner's manual regarding installation of the child restraint and LATCH. If there is a discrepancy, follow your vehicle owner's manual.
- **ONLY** use LATCH connectors for securing base to vehicle lower anchor bars.
- **NEVER** attach two LATCH connectors to one vehicle lower anchor bar.
- **NEVER** use the vehicle seat belt and LATCH anchors at the same time; using both together can cause slack in a sudden stop or crash.
- When not in use, the lower anchor connector assembly should be securely stored in the storage area located under the convenience base or on the side of the base (p. 94). Keep out of reach of children.



## Installing the Convenience Base with the Lower Anchor Connector Assembly (cont.)

# **! WARNING! DEATH or SERIOUS INJURY can occur.**

- **ALWAYS** be sure that the lower anchor connectors are fully engaged onto the vehicle lower anchor bars by pulling hard on the lower anchor connector assembly harness. If they are not totally engaged, the lower anchor connector assembly system will not secure your child restraint. Serious injury or death may result.
- **DO NOT** use this child restraint if it moves more than 2.5 cm (1 in.) side-to-side or front-to-back at the vehicle belt path. Serious injury or death may result from loose installation. If you cannot tightly secure the child restraint, try again or move it to another location.
- The carrier **MUST** be locked firmly into the base. Check by lifting up on the carrier.
- **NEVER** use this child restraint in the forward-facing position.

## Installing the Convenience Base with the Lower Anchor Connector Assembly (cont.)



- 1** Before you begin, be sure the vehicle is on level ground. Remove lower anchor connectors, see p. 91-94. Place base rear-facing on an approved vehicle seat location.

Before installing the base, if you are using the load leg, you will need to unfold the leg, install the base, then extend the load leg. Please follow steps on p. 40-43.

Using your full weight, push the base into the vehicle seat and check the level indicator.

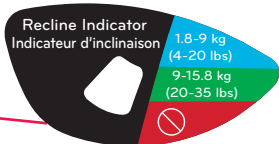
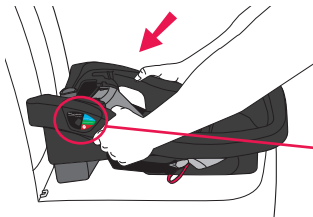

**Blue: 1.8 - 9 kg  
(4 - 20 lbs)**

**Green: 9 - 15.8 kg  
(20 - 35 lbs)**

White indicator line **MUST** be in the correct color zone for your child.

**Note: NEVER** allow white indicator line to appear in red zones.



## Installing the Convenience Base with the Lower Anchor Connector Assembly (cont.)

2

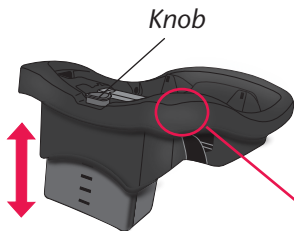

Recline base until white indicator line is in the correct color zone for your child.

Turn adjustment knob to raise or lower the adjustment foot.

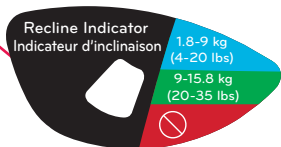

**Note:** **NEVER** allow white indicator line to appear in red zones.



Base shown with leveling foot in stored position.

- 
- 3** Turn the convenience base upside down. The Lower Anchorage Storage will be on the sides of the base. Remove both lower anchor connector, see p. 91-94.





## Installing the Convenience Base with the Lower Anchor Connector Assembly (cont.)

### **4** *Open One Step Lock-Off*

Turn the convenience base right side up. Push down on Lock-Off while pushing back on Lock-Off Release Tab. Lift the Lock-Off up to reveal the belt path.

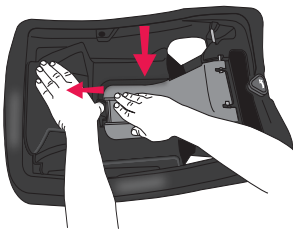





**5**

## **Know Your Lower Anchor Connector Assembly**

*The lower anchor connector assembly that comes with your child restraint will be below.*

### **Quick Connector**

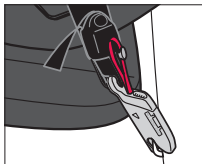
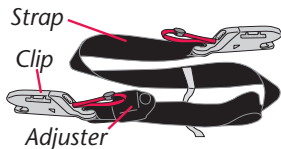

Refer to your vehicle owner's manual to locate the lower anchor bars on your vehicle seat. Attach the right connector to the right anchor bar and the left connector to the left anchor bar. **DOUBLE CHECK** that the lower anchor connector is fully engaged by pulling hard on the lower anchor connector strap.



## Installing the Convenience Base with the Lower Anchor Connector Assembly (cont.)

6

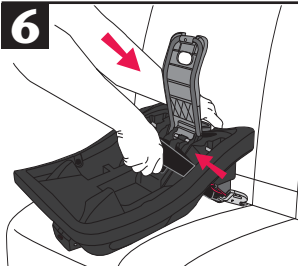

Using your full weight, push the base into the vehicle seat while pulling up on the strap to remove all slack from the lower anchor connector assembly.

7

### Close One Step Lock-Off

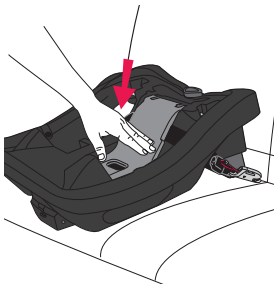

Place any excess lower anchor connector webbing to the side of the base. **Do Not** route it back under the Lock-off. Close the Lock-Off until it clicks into place.

**Note:** If unable to close the Lock-Off, loosen the lower anchor connector assembly and try again.



# **! WARNING!** *DEATH or SERIOUS INJURY can occur.*

**8**

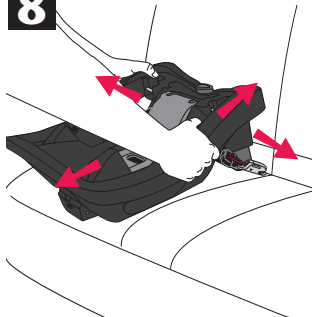

*Make sure the lower anchor connector assembly harness is tight. Grab the base at the areas as shown. If you can move the base more than 2.5 cm (1 in.) side-to-side or front-to-back, the harness is not tight enough. You will need to try again or find another location for your convenience base.*

Place carrier on base, re-check level,  
see p. 62-63.

To remove lower anchor connector, see p. 91.



## Installing the Convenience Base with the Vehicle Lap/Shoulder Belt

*Before you begin, be sure the vehicle is on level ground. Store the lower anchor connectors, see p. 91-94.*

**1**

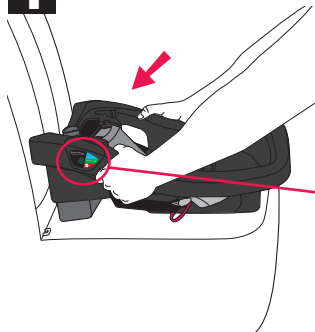

Using your full weight, push the base into the vehicle seat and check the level indicator.

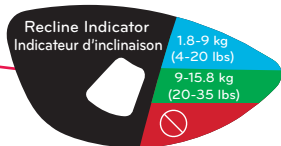

**Blue: 1.8 - 9 kg  
(4 - 20 lbs)**

**Green: 9 - 15.8 kg  
(20 - 35 lbs)**

White indicator line **MUST** be in the correct color zone for your child.

**Note: NEVER** allow white indicator line to appear in red zones.



**2**

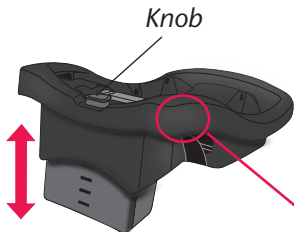

Recline base until white indicator line is in the correct color zone for your child.

Turn adjustment knob to raise or lower the adjustment foot.

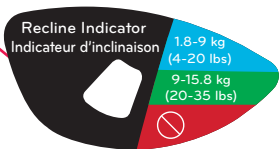

**Note:** **NEVER** allow white indicator line to appear in red zones.



## Installing the Convenience Base with the Vehicle Lap/Shoulder Belt (cont.)

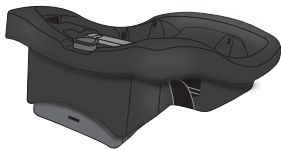

Base shown with leveling foot in stored position.

- 
- 3** *The Lock-Off provides a way to lock the child restraint without needing to lock your vehicle seat belt. (Refer to Vehicle's Owners Manual for vehicle seat belt use.)*

### **Open One Step Lock-Off**

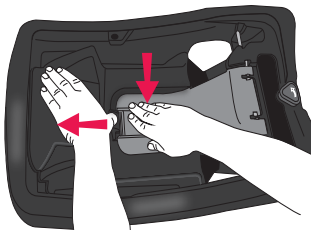

Turn the convenience base right side up. Push down on Lock-Off while pushing back on Lock-Off Release Tab. Lift the Lock-Off up to reveal the belt path.



**4**

Secure the base to your vehicle seat by routing the **lap/shoulder belt** through the belt path openings on the sides of the base and through the vehicle belt clip. **Fasten the buckle.**



### **LAP / SHOULDER BELT**

Pull the shoulder belt tightly to remove all slack from the lap portion of the belt, at the same time use your full weight to push down on the base.

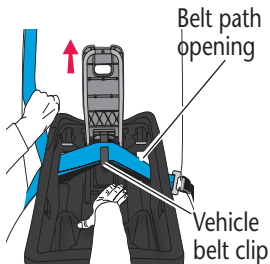

**Note:** If seat belt Stop Button interferes with the Lock-Off, shift base to the left or right in order to prevent interference.

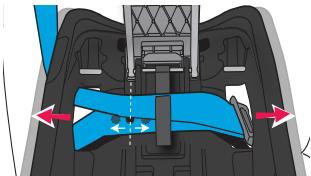



## Installing the Convenience Base with the Vehicle Lap/Shoulder Belt (cont.)

**5**

Secure the base to your vehicle seat by routing the **lap belt** through the belt path openings on the sides of the base and through the vehicle belt clip. **Fasten the buckle.**



### **LAP BELT**

Pull the seat belt tightly to remove all slack from the lap portion of the belt, at the same time use your full weight to push down on the base.

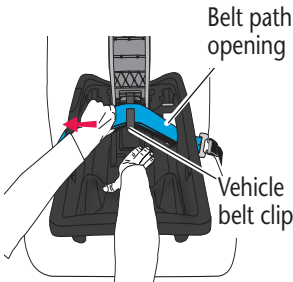





**6**

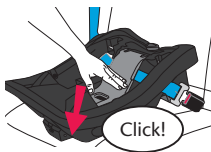

Close the Lock-Off until it clicks into place.

**! WARNING!** *DEATH or SERIOUS INJURY can occur.*

**7**

Make sure the vehicle belt is tight. Grab the base at the areas, as shown. If you can move the base more than 2.5 cm (1 in.) side-to-side or front-to-back the vehicle belt is not tight enough. You will need to try again, or find another location for your convenience base.

**LAP/SHOULDER BELT**

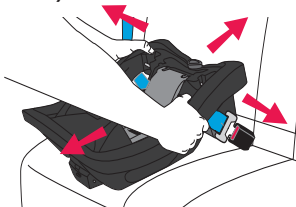

**LAP BELT**

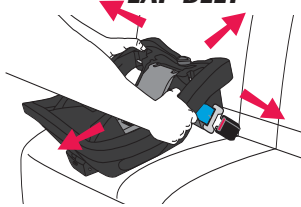

## Placing the Carrier in the Base

**! WARNING!** *DEATH or SERIOUS INJURY can occur.*

- 1** • **NEVER** use this child restraint in the forward-facing position.

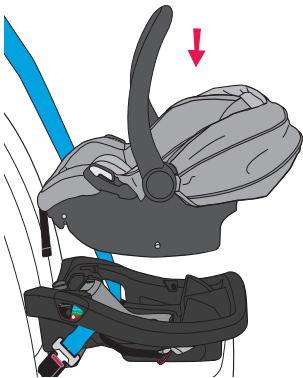

Secure the carrier to the base by placing it into the base and pressing down on the front and back.

**The carrier *MUST* be locked firmly into the base.** Check by lifting up on the carrier handle to make sure carrier is locked to base.

## Placing the Carrier in the Base (cont.)

2

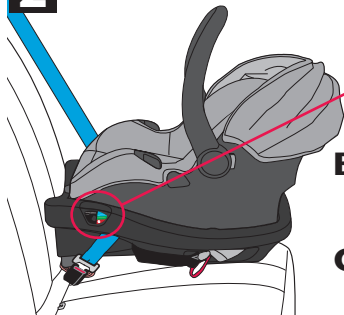

Recline Indicator  
Indicateur d'inclinaison

1.8-9 kg  
(4-20 lbs)

9-15.8 kg  
(20-35 lbs)

**Blue: 1.8 - 9 kg  
(4 - 20 lbs)**

**Green: 9 - 15.8 kg  
(20 - 35 lbs)**

The level indicator must be in the correct color zone for your child. If you have fully adjusted the convenience base and the level indicator is still not level, use a tightly rolled towel or small blanket beneath the front edge of the base.

**IMPORTANT:** *Infants may have difficulty breathing when in a sitting position. Make sure they recline enough for their head to lie back comfortably and safely. Failure to properly recline the child restraint could increase the child's risk of serious injury or death.*

## Placing the Carrier in the Base (cont.)

### **3** **U.S. Models ONLY** **Position 1 or 3**

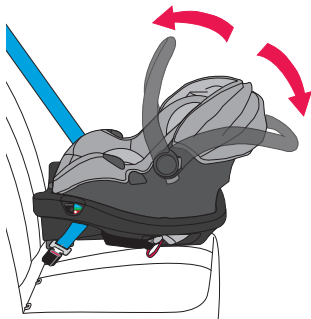

### **Canadian Models ONLY** **Position 1**

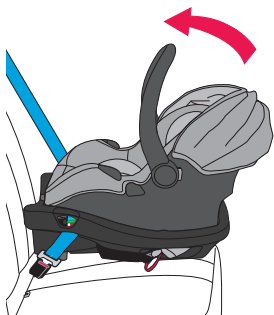

*Squeeze both handle releases and move the handle to the travel position:*

**Position 1 or 3 (U.S. models ONLY)**  
*until it locks in place.*

**OR**

**Position 1 (Canadian models ONLY)**  
*until it locks in place.*

## *Releasing the Carrier from the Base*

Move the handle to **Position 1 (Carry)** by squeezing in on both handle releases and rotating the handle until it locks into place above the carrier.

Squeeze the carrier release handle while lifting up the carrier.

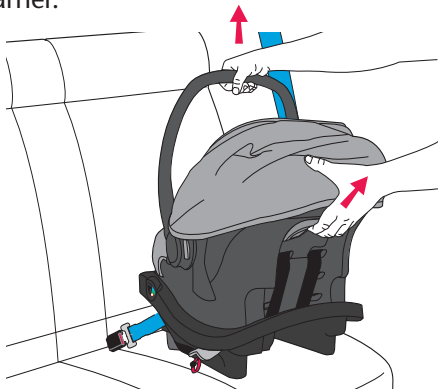

**To remove the base from vehicle,** push down on the Lock-Off while pushing back on Lock-Off release tab and lift it up (see Step 3 and 4 on page 58) then unbuckle the vehicle belt and remove it from the belt path.

## Proper Installation *WITHOUT* the Convenience Base

### Child Requirements

- **Weight:** 1.8 – 15.8 kg (4 – 35 lbs)
- **Height:** 43 – 81 cm (17 – 32 in.) and top of child's head is at least 2.5 cm (1 in.) below the top of the child restraint seat back.

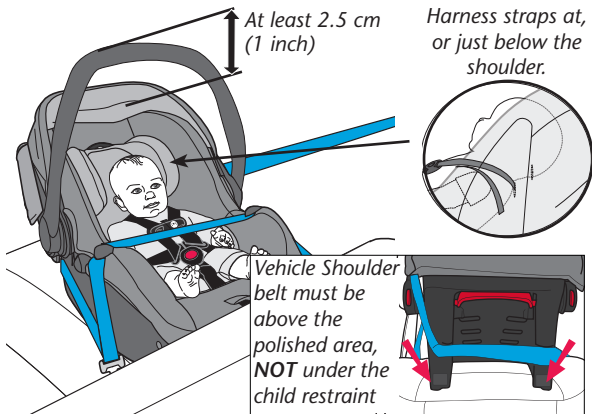

**IMPORTANT:** Once your child **exceeds** any of the size requirements above, they **MUST** discontinue use of this child restraint.

## ***Installation Checklist***

### ***1. Place the child in the carrier.***

- ✓ The child's back and bottom are flat against the back and bottom surfaces of the carrier.
- ✓ Top of child's head is at least 2.5 cm (1 in.) below the top of the child restraint seat back.

### ***2. Secure child in the carrier.*** Refer to p. 75.

- ✓ Harness straps are at, or just below shoulder level (p. 66).
- ✓ Both buckle tongues are fastened (p. 77).
- ✓ Chest clip is connected and positioned at armpit level (p. 77).
- ✓ Harness straps are snug against the child and you should not be able to pinch the harness (p. 77).
- ✓ Crotch strap is snug against the child, but **NOT** under the child's bottom (p. 82).
- ✓ Waist straps are snug against the child, but **NOT** under the child's legs (p. 86).

### 3. **Secure child restraint to the vehicle seat.**

- ✓ Carrier is securely installed with vehicle seat belt (p. 69-74).
- ✓ The vehicle shoulder strap portion of the seat belt is above the polished area on rear of child restraint (p. 66).
- ✓ Locking clip is installed, if necessary (p. 74).
- ✓ The level line is level with ground (p. 73).
- ✓ The handle is in *Position 1* or 3 (U.S. models **ONLY**), or *Position 1* (Canadian models **ONLY**) (p. 36)
- ✓ If necessary, a towel/small blanket is rolled up and placed beneath the front edge of the carrier so the child's head lies back comfortably (p. 73).

### 4. **Check your work.**

- ✓ To properly protect your child, the carrier **MUST NOT** move more than 2.5 cm (1 in.) from side-to-side or from front-to-back **at the vehicle belt path.**



## Installing the Carrier WITHOUT the Convenience Base



1

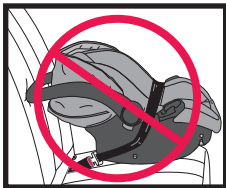
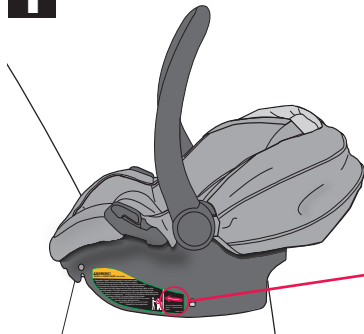

After securing your infant in the carrier, place the carrier into your vehicle. Adjust the child carrier so that the level line is level with the ground.

**Note:** Generally, the center rear seating position is the safest. ***This infant restraint **MUST** face the rear of the vehicle.***



## Installing the Carrier WITHOUT the Convenience Base (cont.)

# 2

### LAP BELT



Route **ONLY** the **lap** portion of the vehicle seat belt through the vehicle belt slots on the carrier, **then fasten buckle.**

### LAP/ SHOULDER BELT



In vehicles with a **lap/shoulder belt**, **DO NOT** route the shoulder belt through the belt slots.

Instead, put the lap belt through the belt guides, then wrap the shoulder belt around the back as shown, **then fasten buckle.**

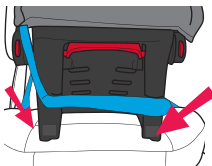

Vehicle Shoulder belt must be above the polished area, **NOT** under the child restraint.

**IMPORTANT:** Some ELR vehicle belts can be switched so that they lock when tightened. It may not be necessary to use a locking clip in these situations. To obtain and install a locking clip, refer to p. 76. Refer to the vehicle owner's manual to determine which type of belt retractor is in the vehicle.



## **! WARNING!** *DEATH or SERIOUS INJURY can occur.*

- 3**
- **NEVER** use this child restraint in forward-facing position.
  - **DO NOT** use this carrier if it moves more than 2.5 cm (1 in.) side-to-side or front-to-back at the vehicle belt path. Serious injury or death may occur. Move the child restraint to another seating location, or try to tighten the vehicle belt again.

### ***TIP!***

*Push down on the bottom of the seat using your full weight.*

*Shoulder belt routes above the handle on the opposite side of seat.*

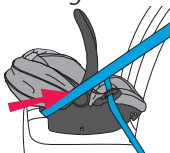
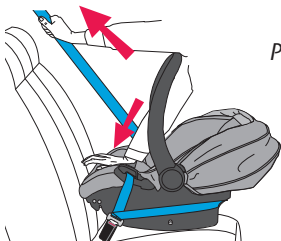

The vehicle belt must be as tight as possible. Put your full weight into the seat as you tighten the vehicle belt. If you can move the child restraint more than 2.5 cm (1 in.) side-to-side or front-to-back at the vehicle belt path, the vehicle belt is not tight enough, and you need to try again.



## Installing the Carrier WITHOUT the Convenience Base (cont.)

**4**

**U.S. Models ONLY**

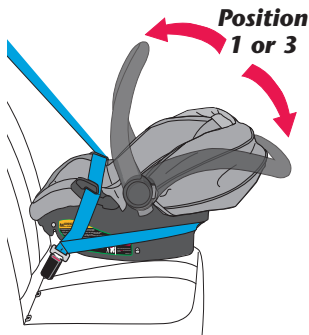

**Canadian Models ONLY**

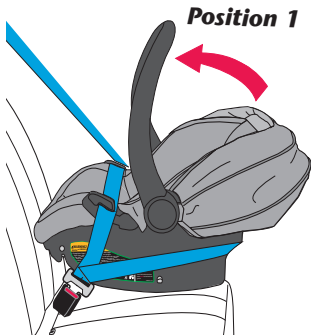

Squeeze both handle releases and move the handle to the travel position:

**Position 1 or 3 (U.S. models ONLY)**  
until it locks in place.

**OR**

**Position 1 (Canadian models ONLY)**  
until it locks in place.



5

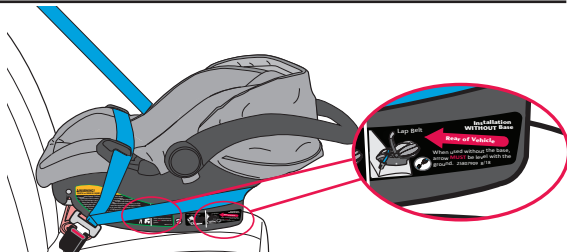

If the level line is not level with the ground, use a tightly rolled towel or small blanket beneath the front edge of the child restraint to provide enough recline for an infant's head to lie back comfortably.

**IMPORTANT:** *Infants may have difficulty breathing when in a sitting position. Make sure they recline enough for their head to lie back comfortably and safely. Failure to properly recline the child restraint could increase the child's risk of serious injury or death.*

To remove, unfasten the vehicle belt.



## Installing the Carrier WITHOUT the Convenience Base (cont.)

6

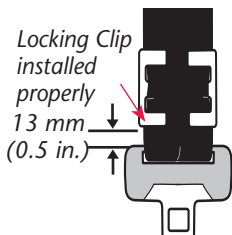

### Install Locking Clip (not included), if necessary.

If your vehicle was built **prior to model year 1996**, and has a lap/shoulder belt that is equipped with an emergency locking retractor (ELR) AND sliding latch plate, you **MUST** use a Locking Clip.

Check your vehicle owner's manual to identify which vehicle belt system is in your vehicle. If your vehicle is **model year 1996 or newer**, it likely has a vehicle belt system that can be locked when tightened, and will not require use of a Locking Clip.

**Consult your vehicle owner's manual before installing a locking clip.**

If your vehicle requires a Locking Clip, please call ParentLink at 1-800-233-5921 (U.S.) or 1-937-773-3971 (Canada), or 01-800-706-12-00 (Mexico) to obtain a Locking Clip and instructions on how to install and use it.

**! WARNING! DEATH or SERIOUS INJURY can occur.**

- Remove Locking Clip from vehicle seat belt when not used with a child restraint, or the vehicle seat belt will not properly restrain an adult or child. Serious injury could occur.

## Securing the Child in the Carrier



*Place the baby into the carrier. Baby's bottom and back should be flat against the seat. If there is a gap, baby will not be comfortable.*

**1**

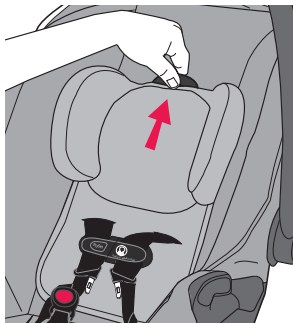

Squeeze headrest adjustment button and lower headrest to the closest position **AT** or **JUST BELOW** the child's shoulders. **CHECK** to make sure headrest is in a locked position by pushing down.

## Securing the Child in the Carrier (cont.)

2

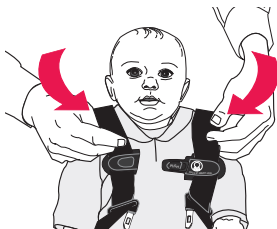

Slide each harness strap over the child's shoulders.

3



Insert the buckle tongues into the buckle. Pull up on the harness straps to ensure the buckle tongues are engaged.

**IMPORTANT:** The crotch strap should **ALWAYS** be as close as possible to, but **NEVER** under, the child's bottom. Adjust the crotch strap if necessary (p. 82). The waist straps should **ALWAYS** be as close as possible to, but **NEVER** under, the child's legs. Adjust the waist straps if necessary (p. 84).



4

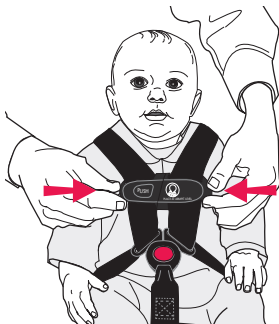

Align the two sides of the chest clip and snap them together. The chest clip must be positioned at armpit level.



The harness straps must be snug against the child. A snug strap should not allow any slack. It lies in a relatively straight line without sagging. It does not press on the child's flesh or push the child's body into an unnatural position. Check the harness straps near the shoulders for slack. You should **NOT** be able to pinch the harness (see illustration). Adjust as needed.

## Securing the Child in the Carrier (cont.)

5

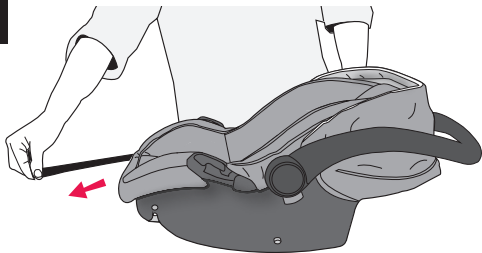

To tighten the harness straps, pull the harness adjuster strap on front of the restraint, as shown.

### **! WARNING!**

- For low birth-weight infant, you **MUST** always use the infant body support. The infant body support **MUST BE USED** for infants who weigh less than 2.7 kg (6 lbs).
- Discontinue using the infant body support when it presses the child's legs uncomfortably against the buckle.

## *Removing the Child from the Carrier*

**1**



Press the red buckle release, and remove the buckle tongues.

**2**

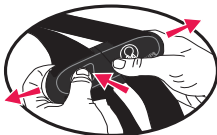

Push the release button and pull the chest clip apart.

**3**

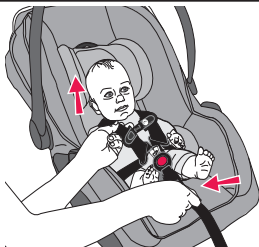

To loosen the harness straps, press the harness release button while pulling upward on the harness straps.

## Changing the Crotch Strap Position

As your child grows, you will need to change the crotch strap position so that it is in the slot closest to your child. The crotch strap should **ALWAYS** be as close as possible to, but **NEVER** under, the child's bottom.

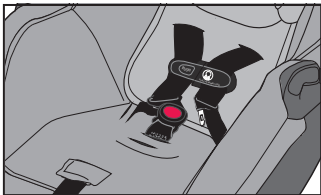
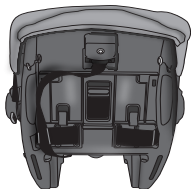

### **Crotch Strap in the Newborn Position**

**NEVER** use this position for children weighing more than 3.6 kg (8 lbs).

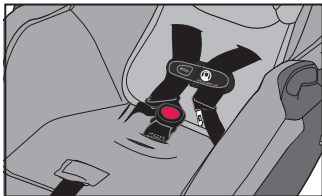
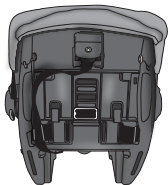

### **Crotch Strap in the Rear Slot**

## ***Changing the Crotch Strap Position (cont.)***

### ***Crotch Strap in the Middle Slot***

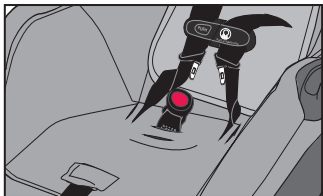
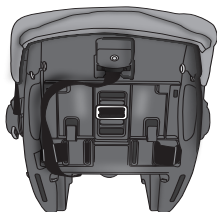

---

### ***Crotch Strap in the Front Slot***

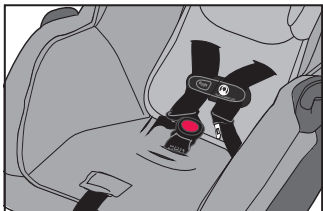
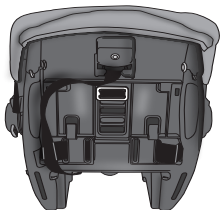

## Changing the Crotch Strap Position (cont.)

1

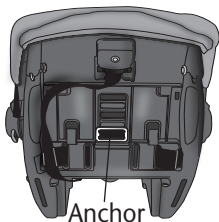

To reposition crotch strap, loosen the harness straps (p. 81) and move the strap out of the way.

Remove the crotch strap anchor from its position on the bottom of the carrier, and push the anchor up through the slot to the top of the seat.

2

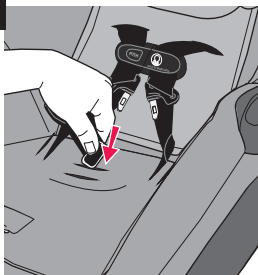

Insert the crotch strap anchor into the slot that is the closest to the child, but **NEVER** under the child's bottom.



Make sure the anchor is completely through and is laying flat against the bottom of the seat. Pull up on the crotch strap to make sure it is securely fastened.

## Changing the Crotch Strap Position (cont.)

3

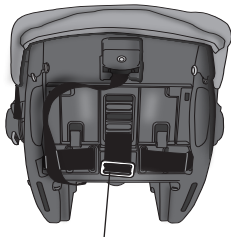

Anchor

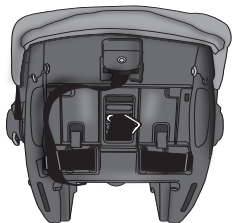

For newborn position, push the anchor down through the rear slot, then feed it back up through the middle slot.

Make sure the anchor is completely through the middle or front slot and is lying flat against the bottom of the seat.

**NEVER** use this position for children weighing more than 3.6 kg (8 lbs).



Rear to Middle



Rear to Front

## Changing the Waist Strap Position

As your child grows, you will need to change the waist strap position so that it is in the slot closest to your child. The waist strap should **ALWAYS** be as close as possible to, but **NEVER** under, the child's legs.

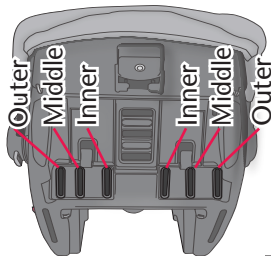

Approximate  
Child Size:

Waist Strap  
Position:

Small	1.8 - 2.7 kg (4 - 6 lbs)	Inner
Medium	2.7 - 9 kg (6 - 20 lbs)	Middle
Large	9 - 15.8 kg (20 - 35 lbs)	Outer



## Changing the Waist Strap Position (cont.)

1

To reposition waist straps, loosen the harness straps by pressing the harness release button while pulling on the harness straps.

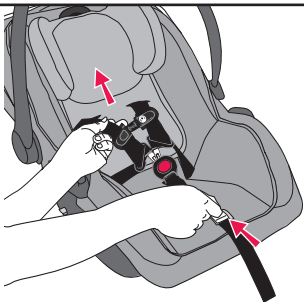

2

Push the crotch strap anchor through the slot in the seat pad and shell.

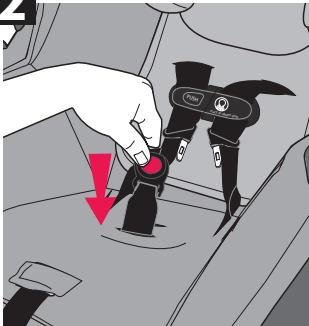

**Anchor**



Bottom View of Shell

## Changing the Waist Strap Position (cont.)

**3**

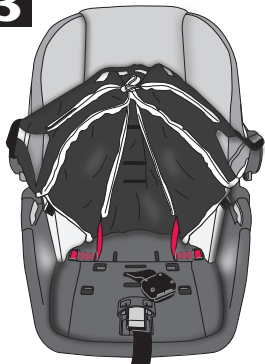

Unhook the front of the child restraint's seat pad and move it out of the way to expose the waist strap slots and anchors.

Remove the waist strap anchor from its position on top of the seat, and push the anchor down through the slot to the bottom of the seat. Then push anchor up through the slot to the top of the seat pad. Repeat on other side.

**Anchor**

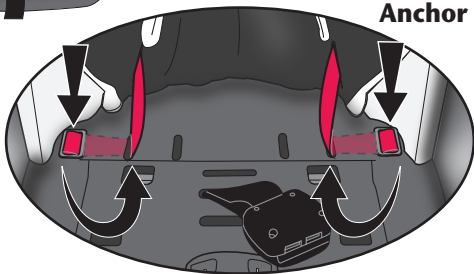

4

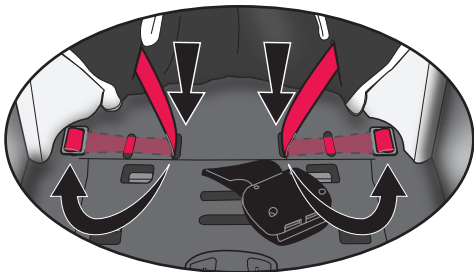

Push the anchor down through the appropriate slot to the bottom of the seat. Then push anchor up through the appropriate slot to the top of the seat.

Re-hook front of the child restraint's seat pad. Make sure the anchor is completely through and is laying flat against the bottom of the seat. Pull up on the crotch strap to make sure it is securely fastened.

**Note:** See images (p. 84 - 90) to find the appropriate waist strap slots for your child's size.

## ***Changing the Waist Strap Position (cont.)***

***Small size baby***

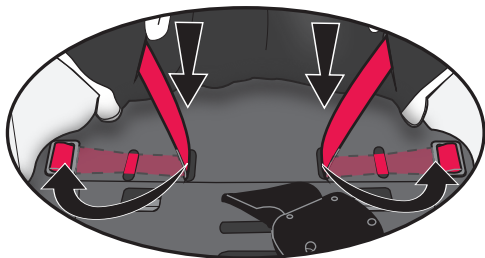

***Small size baby***

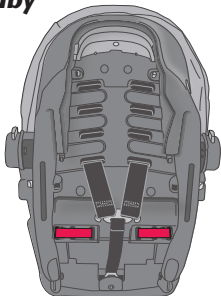
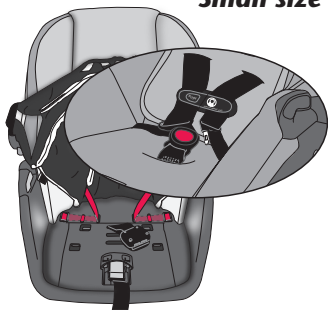

## ***Changing the Waist Strap Position (cont.)***

### ***Medium size baby***

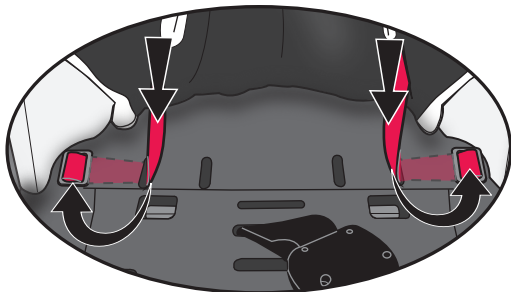

### ***Medium size baby***

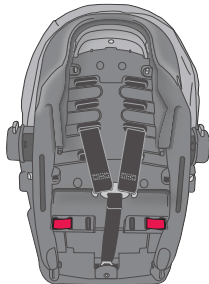
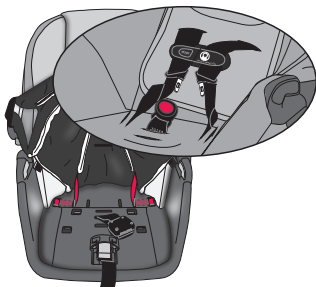

## Changing the Waist Strap Position (cont.)

**Large size baby**

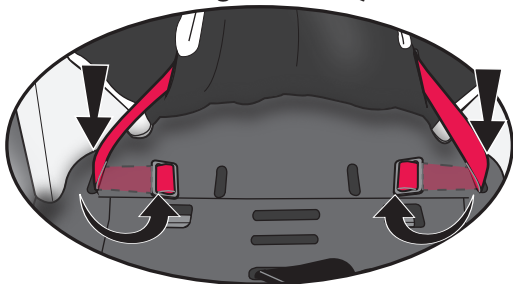

**Large size baby**

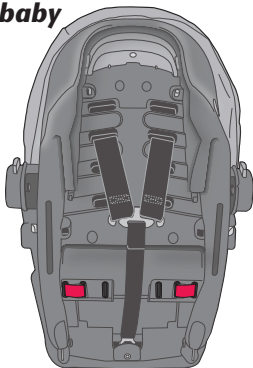
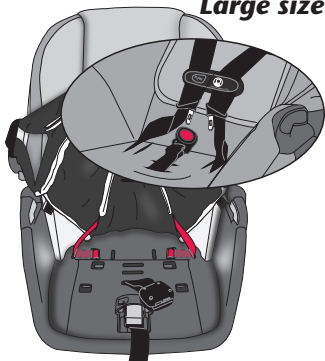



## Removing the Lower Anchor Connector Assembly

- 1 To remove the clip, pull the red release strap and remove clip from anchor.

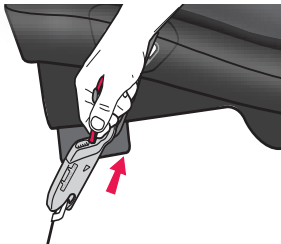



- 2** The lower anchor connector that comes with your child restraint will be below:

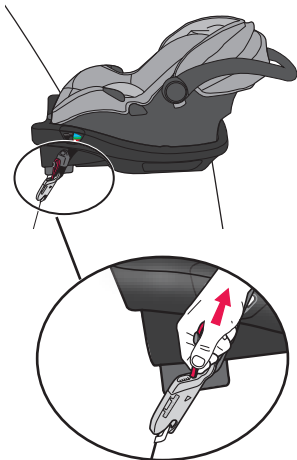

To remove the clip, pull the red release strap and remove clip from anchor.





## Removing the Lower Anchor Connector Assembly (cont.)

- 3** When the lower anchor connector assembly is not in use, you **MUST** securely store it in the area provided on the bottom or side of the base depending on which style base you have. Make sure the lower anchor connector assembly strap is routed through the belt path on top of the base.



## ***Removing the Lower Anchor Connector Assembly (cont.)***



Attach the connector to the posts located on each side of the base or on the bottom of the base.

A loose lower anchor assembly connector harness and hook may injure your child.



## Using as an Infant Carrier

Secure the child in the carrier by following “Securing the Child in the Carrier” p. 75.

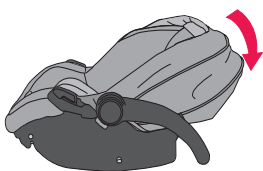

### **Position 4**

**To use as a stand:** Squeeze both handle releases and rotate the handle to **Position 4 (Stand)** until it locks into place and the carrier rests on a level surface.

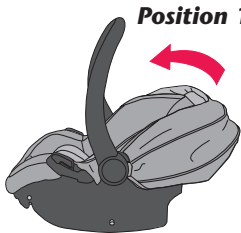

### **Position 1**

**To use as a carrier:** Squeeze both handle releases and rotate the handle to **Position 1 (Carry)** until it locks into place. Carry at your side, using the handle as shown.

## **IMPORTANT**

To avoid serious injury or death, the harness **MUST** be securely buckled **at all times**.



# **! WARNING!** *DEATH or SERIOUS INJURY can occur.*

- **NEVER** place this carrier near the edges of counter tops, tables, or other high surfaces. The child's movements can cause the carrier to slide and fall.
- **NEVER** leave the child in this carrier when the harness straps are loose or undone. Children have **STRANGLED** in loose or partially buckled harness straps. Fully restrain the child even when carrier is outside the vehicle.
- **Fall Hazard:** The carrier can fall from the shopping cart. Do not use on shopping cart.



- 
- **DO NOT** carry on your hip.





The Federal Aviation Administration (FAA) recommends that you secure your child for air travel in an appropriate child restraint based on your child's weight and size. Turbulence can happen with little or no warning. When turbulence occurs, **the safest place for your child is in a properly installed child restraint, not in an adult's lap or on the aircraft seat with its seat belt.** Keeping your child in a child restraint during the flight will help ensure your family arrives safely at your destination.

The FAA recommends that a child weighing:

- more than 18 kg (40 lbs) use an aircraft seat belt;
- less than 9 kg (20 lbs) use a rear-facing child restraint; and
- from 9 to 18 kg (20 to 40 lbs) use a forward-facing child restraint.

**Please note that these FAA recommendations may vary from those applicable to the use of your child restraint in a motor vehicle.**

### **IMPORTANT**

*You must use the internal harness when installing the child restraint in aircraft.*

*Before installing the child restraint, make sure the **aircraft seat is in a fully upright position.***

**DO NOT** use the convenience base when installing child restraint in aircraft.



## Installing Carrier **WITHOUT** Convenience Base in Aircraft

1

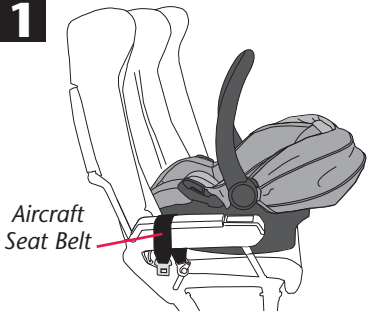

Place the child restraint on the aircraft seat **rear-facing**, as shown above.

2

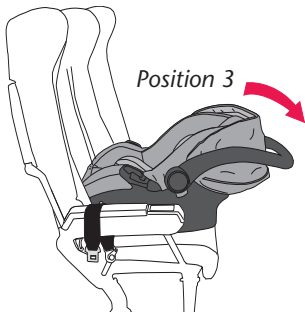

Squeeze both handle releases and move the handle to *Position 3*.



**3**



Route the aircraft seat belt through the belt slots on the carrier, as shown above.



## Installing Carrier **WITHOUT** Convenience Base in Aircraft (cont.)

**4**

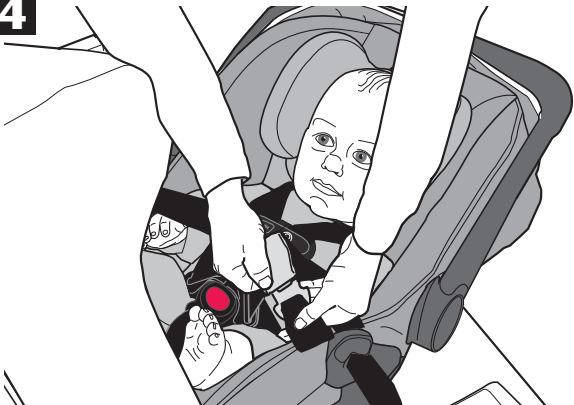

Fasten the aircraft seat belt.





**5**

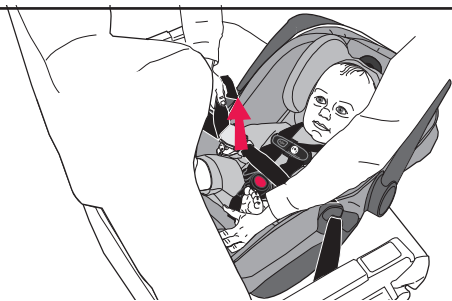

The aircraft seat belt must be as tight as possible. Route the excess seat belt strap back through the belt slots, as shown above. Using your full weight, push the child restraint firmly onto the aircraft seat while pulling on the excess seat belt strap to tighten.

**Check your work.** Try to move the child restraint in all directions. If you can move the child restraint more than 2.5 cm (1 in.) side-to-side or front-to-back at the belt path, the aircraft seat belt is not tight enough, and you **MUST** install again until the seat belt is tight.



## Installing Carrier without Convenience Base in Aircraft (cont.)

6

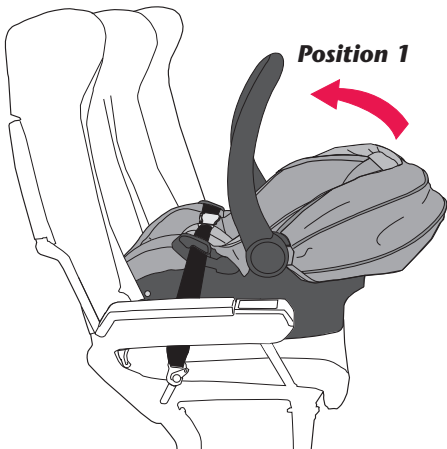

Squeeze both handle releases and move the handle to **Position 1**.

## *Installing the Canopy*

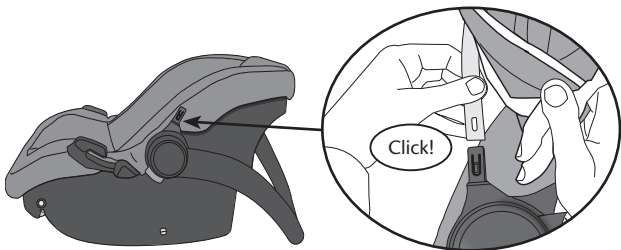

Insert front canopy end into the holder until it clicks into place. Repeat on the other side.

1

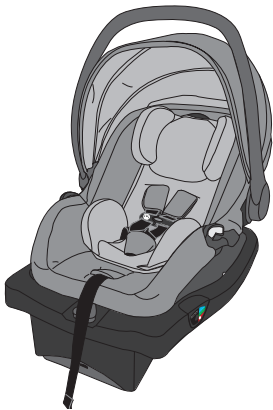

To remove the harness covers. Loosen the harness straps by pressing the harness release button while pulling on the straps. Slide the harness strap off of the splitter plate. Pull both harness straps through the front of the child restraint. Then slide harness covers off harness straps. Reattach the harness strap onto the splitter plate.

To reattach harness covers, follow steps above.

**IMPORTANT:** The shoulder harness straps should **ALWAYS** be as close as possible to, but **NEVER** above the child's shoulders.

### 2

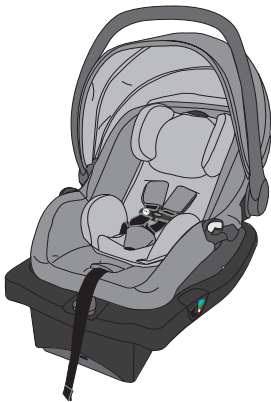

To remove the buckle cover, press the red buckle release under the buckle cover and remove buckle tongues. Pull buckle cover off the buckle.

To reattach the buckle cover press the red buckle release and remove buckle tongues. Push the buckle cover onto the buckle.

**IMPORTANT:** The crotch strap should **ALWAYS** be as close as possible to, but **NEVER** under the child's bottom. Adjust the crotch strap if necessary (p. 83).

## Removing the Seat Pad

- Move handle to *Position 4* (p. 36).
- Unfasten chest clip and crotch buckle (p. 79).
- Remove crotch buckle cover (p. 105).
- Remove harness straps from splitter plate on back of child restraint (p. 109).
- Pull harness straps to front of child restraint (p. 87).
- Remove harness covers (p. 104).

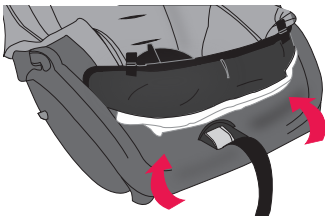

Remove two J-clips from front of child restraint and pull bottom of seat pad off front of child restraint.

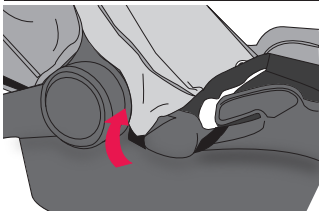

Remove J-clips from both sides of child restraint.



## *Removing the Seat Pad*

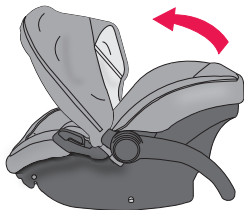

Unfasten Velcro® on back of canopy and pull canopy forward.

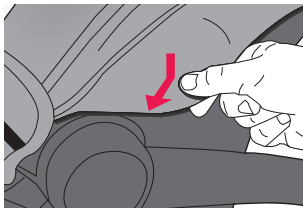

Slide J-clips down and out of slots on both sides of child restraint.

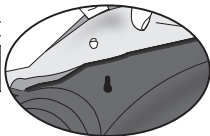

## ***Removing the Seat Pad (cont.)***

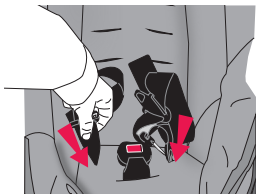

Push both harness straps through seat pad.

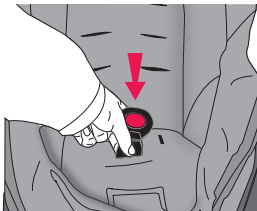

Push crotch buckle through seat pad.

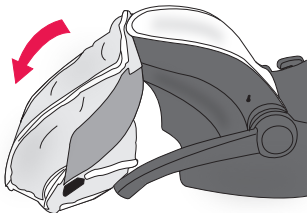

Push seat pad up and over child restraint.



## Removing the Seat Pad (cont.)

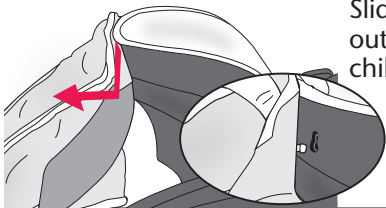

Slide J-clips down and out of slots on top of child restraint.

To replace seat pad, reverse these steps.

**Note:** Make sure to place harness strap in the same harness and waist slots as before. Make sure to place the crotch buckle in the same slot as before.

**! WARNING! DEATH or SERIOUS INJURY can occur.**

*Make sure both harness straps are installed **completely** on the splitter plate, as shown. Failure to properly attach the harness straps to the splitter plate may result in a loose harness and serious injury or death to your child.*

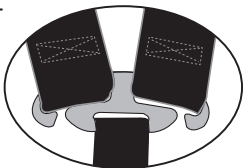

## Replacement Parts

Not available on all models. Styles may vary.

To order replacement parts you can order online at **[www.evenflo.com](http://www.evenflo.com)** or contact Evenflo. When you contact us, please have the product model number and date of manufacture (found on the back of the child restraint).



Buckle Cover



Infant Pillow

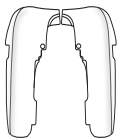

EPS Foam



Harness Cover

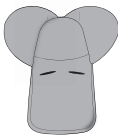

HeadRest Pillow



Chest Clip

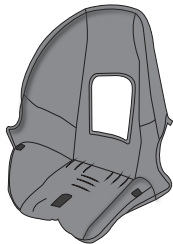

Seat pad

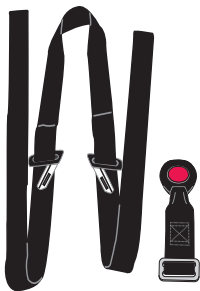

*Harness System*



*Canopy*



*Lower Anchor  
Connector Assembly with  
Quick Connectors™*



*Accessory Base*

## Care and Cleaning

- **DO NOT** lubricate or immerse in water the LATCH connectors, the buckle, or any other part of this child restraint, unless rinsing is permitted, as stated on the back of the buckle for your restraint.
- Plastic and metal parts may be wiped clean with mild soap and water and dried with a soft cloth. Do not use abrasive cleaners or solvents.
- Take care not to damage any labels.
- The harness can be wiped clean with mild soap and water. Allow harness to air dry.
- Machine wash the seat pad separately in cold water, delicate cycle. Tumble dry 10 to 15 minutes on low heat.
- **NEVER** use child restraint without the seat pad.
- To protect the child restraint from damage caused by weather, rodents, and other elements common to garages, the outdoors, and other storage locations, remove the seat pad and thoroughly clean the restraint and pad prior to storage. Take care to clean in the areas where crumbs and other debris tend to accumulate.

**TIP!**

*To help protect the vehicle upholstery, place a towel beneath and behind the child restraint.*

## Proper Disposal of this Child Restraint

When this child restraint reaches the expiration date found on the date of manufacture label, Evenflo encourages you to dispose of it properly. Most components of this child restraint are recyclable.

1. Remove all fabric and padding.
  2. Remove all screws and disassemble the restraint.
  3. Recycle all fabric, padding, plastic, foam and metal parts, if accepted by your local recycling center.
- Responsibly discard the rest.

If your local recycling center won't accept the padding, you may dispose of it in the landfill.

*To prevent injury due to hidden damage, lost instructions, outdated technology, etc., discontinue use of this restraint after the expiration date on the label or if it has been involved in a crash.*

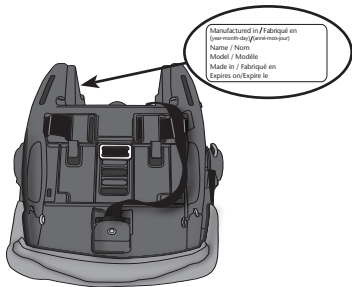

## ***Limited Warranty***

For a period of 90 days from the original purchase of this Product, Evenflo warrants to the original end user ("Purchaser") this Product (including any accessories) against defects in material or workmanship. Evenflo's sole obligation under this express limited warranty shall be, at Evenflo's option, to repair or replace any Product that is determined to be defective by Evenflo and determined to be covered by this warranty.

Repair or replacement as provided under this warranty is the exclusive remedy of the Purchaser. Proof of purchase in the form of a receipted invoice or bill of sale evidencing that the Product is within the warranty period must be presented to obtain warranty service. This express limited warranty is extended by Evenflo **ONLY** to the original Purchaser of the Product and is not assignable or transferable to subsequent purchasers or end users of the Product. For warranty service, contact Evenflo's ParentLink Consumer Resource Center.

EXCEPT TO THE EXTENT PROHIBITED BY APPLICABLE LAW, ANY IMPLIED WARRANTY OF MERCHANTABILITY OR FITNESS FOR A PARTICULAR PURPOSE ON THIS PRODUCT IS HEREBY DISCLAIMED. EVENFLO SHALL NOT BE LIABLE FOR ANY INCIDENTAL, CONSEQUENTIAL, SPECIAL OR PUNITIVE DAMAGES OF ANY KIND FOR BREACH OF THE EXPRESS LIMITED WARRANTY ON THIS PRODUCT, OR ANY WARRANTY IMPLIED BY OPERATION OF LAW. OTHER THAN THE EXPRESS LIMITED WARRANTY SET FORTH ABOVE, THERE ARE NO OTHER WARRANTIES THAT ACCOMPANY THIS PRODUCT AND ANY ORAL, WRITTEN OR ANY OTHER EXPRESS REPRESENTATION OF ANY KIND IS HEREBY DISCLAIMED.

**ParentLink®**

answers. advice. affirmation.

**[www.evenflo.com](http://www.evenflo.com)**

*USA: 1-800-233-5921, 8 AM – 5 PM E.T.*

*Canada: 1-937-773-3971*

*México: 01-800-706-12-00*

## Storing Your Instructions

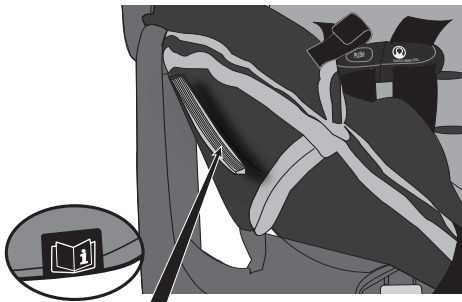

*After thoroughly reading and following these instructions, store instructions look for the logo on front of seat pad. Then store under the seat pad inside a pocket of the seat pad as shown.*

*For future reference, record the model number of your child restraint AND the date of manufacture below.*

**Model Number:** \_\_\_\_\_

**Date of Manufacture:** \_\_\_\_\_