

SIDES	BOTTOM
Material:Steel-0.0394"-65Mn spring steel	

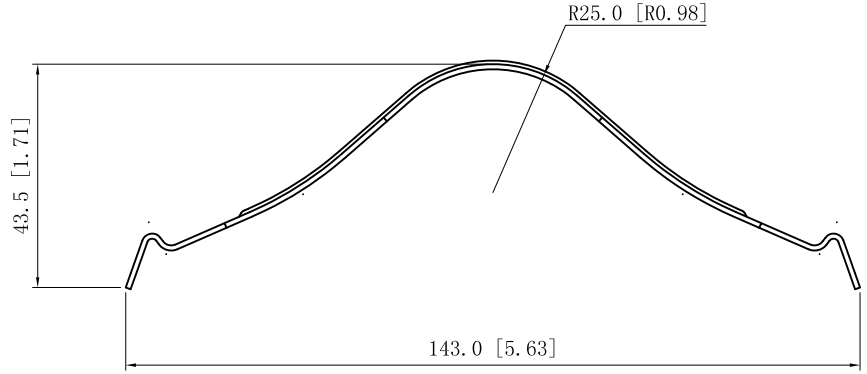
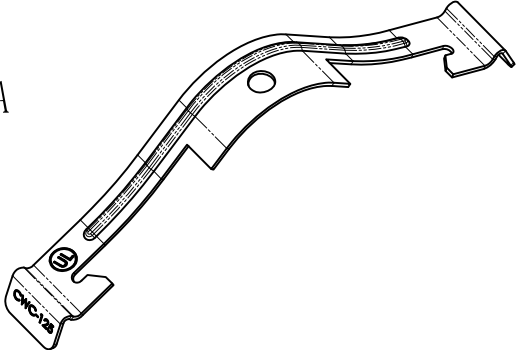
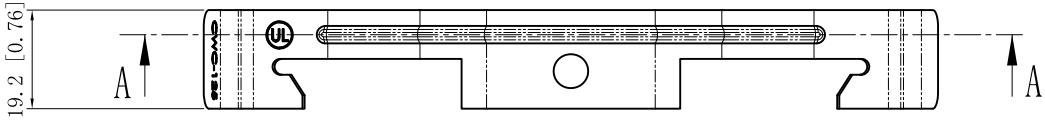
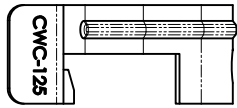
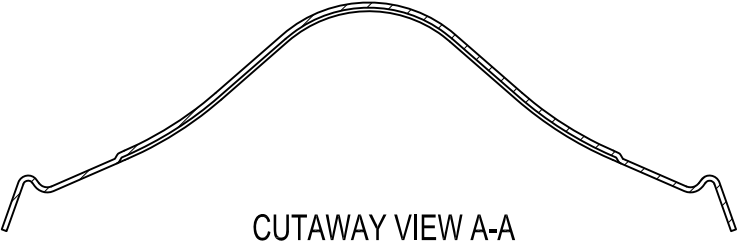

This data sheet is for reference only .GARVIN INDUSTRIES reserves the right to make changes to the design without prior notice.

DESCRIPTION
TRADE REFERENCE TERMS

STANDARD PACKING
100 PCS

GARVIN INDUSTRIES		
TITLE CONDUIT HANGER		
SIZE A4	DWG NO. CWC-125	REV A
DATA SHEET		