

FLEXSTEEL®

W1488-33/ W1488-34

ROUND COFFEE TABLE

IMPORTANT

Carefully remove all the parts from the carton and put them individually on a soft cloth to prevent damage to the parts.

We have taken great care in the design of this product and request that you carefully and accurately follow our assembly instructions to ensure proper set-up.

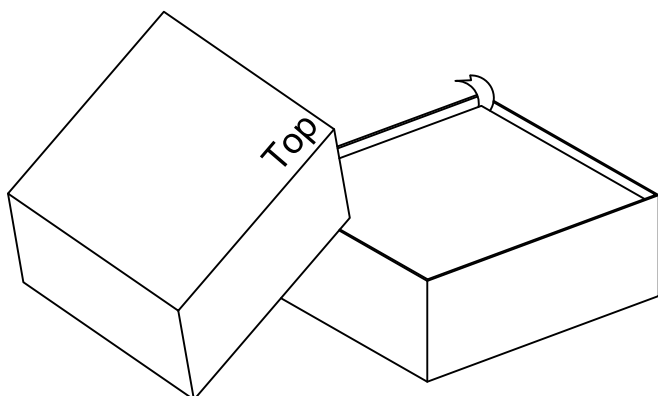
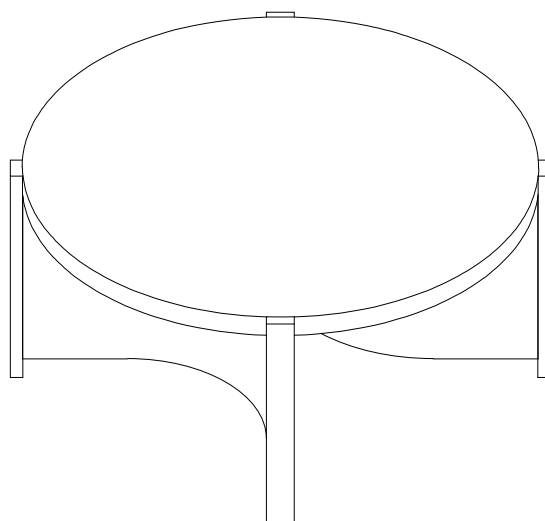

Hardware pack

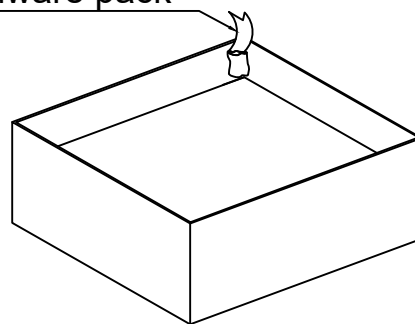

Part List

Assembly Instruction 1/2

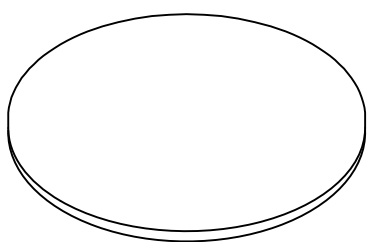

A. Table Top
1 piece

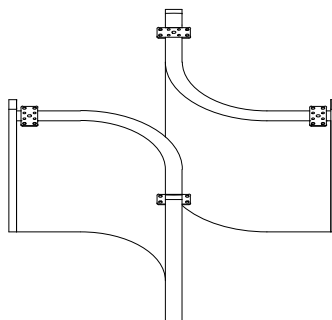

B. Leg frame
2 pieces

Hardware List



Bolt
16+1 pieces
Ø1/4"-20 UNC x 3/4"



Flat Washer
16+1 pieces
Ø1/4*16mm



Spring Washer
16+1 pieces
Ø1/4



Hex Key
1 piece
30*100*4mm

IMPORTANT NOTES

- Do not tighten up all the bolts until each part is properly assembled.
- Keep the Hex Key in a safe place as you may need to tighten up the bolts in the future.
- Use a soft cloth between these parts and the floor.
- We recommend this product be assembled by at least two adults.

STEP 1

Attach two Leg Frames (B) to Table Top (A) with Bolt, Spring Washer and Flat Washer.

Note: Do not fully tighten the bolts at this stage.

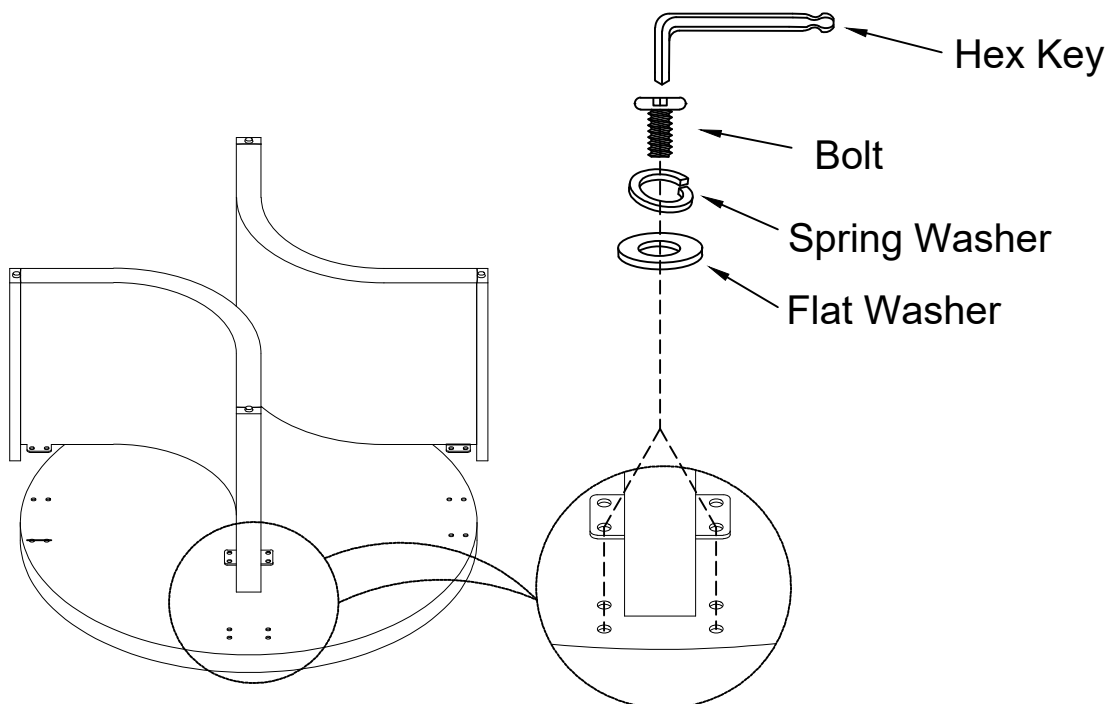

STEP 2

Fully tighten all the bolts with Hex Key.

CARE INSTRUCTIONS

To avoid scratches, do not place sharp or jagged objects directly on the table top.

Do not place hot items directly on the table top.

Use placemats or trivets under hot items and coasters under beverages to prevent marks and stains.

Avoid the use of harsh chemicals or abrasive cleaning materials.

Wipe the table clean with a soft, dry cloth after each use.

Wipe up spills quickly with a soft, dry cloth.

Flexsteel Industries, Inc.

For Parts or Customer Service call

toll-free:

1-888-415-3979

Monday-Friday

8:00-5:00pm

(Central Time)

Email:

customersolutions@flexsteel.com

www.flexsteel.com