

NOTES:

1. MATERIAL:

CLIP RING: BERYLLIUM COPPER PER, ASTM B194.
CENTER CONTACT: BERYLLIUM COPPER PER, ASTM B196.
FERRULE, OUTER CONTACT & WEDGE: BRASS PER, ASTM B16.
INSULATOR: TEFLON PER, ASTM D1710.

2. FINISH:

OUTER CONTACT & CENTER CONTACT: .000030 MIN. GOLD PER
MIL-G-45204 OVER .000050 MIN, NICKEL PER QQ-N-290.
FERRULE: .0000050 GOLD OVER NICKEL PER QQ-N-290
CLIP RING: NICKEL PER QQ-N-290.

3. ELECTRICAL:

DIELECTRIC WITHSTANDING VOLTAGE: 800 VRMS
RECOMMENDED FREQUENCY RANGE: 0 - 3.0 GHz.

4. FOR USE WITH RG-316 OR EQUIVALENT CABLE.

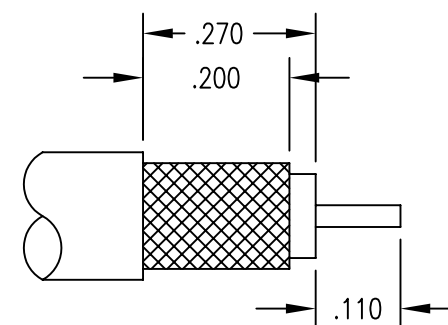
STRIPPING DIMENSIONS

REV.	DESCRIPTION OF CHANGE	DATE	DRN	APPR
D	ECR 8576	06/15/05	PSM	DCam
C	ECN 2055	7/3/98	JMC	
B	ECN 1832	9/3/97	JED	JMC
A	ECN 1734	4/21/97	KJT	JMC
-	GENERATED PER NPR #277	04/02/97	CHRIS	AT

REVISIONS

UNLESS OTHERWISE SPECIFIED
TOLERANCES: 3 PLACE DECIMALS $\pm.005$ 2 PLACE DECIMALS $\pm.010$
FRACTIONS $\pm 1/64$ ANGLE $\pm 2^\circ$
ALL DIMENSIONS PRIOR TO PLATING
CHAMFER 1ST THREAD 45° TO ROOT DIAMETER
REMOVE ALL BURRS AND SHARP EDGES
ALL DIAMETERS TO BE CONCENTRIC WITHIN .003 TIR
SURFACE FINISH SHALL BE 63 MICROINCHES MAXIMUM
DIMENSIONS IN INCHES DO NOT SCALE PRINT

MATERIAL

FINISH

SALES DRAWING



RETCONN

A SUBSIDIARY OF SPM
199 W. PEARL ROAD TORRINGTON, CT. 06790
TEL. (860) 489-1220 FAX (860) 496-7307

TITLE

STRAIGHT CABLE PLUG

DRAWN CHRIS	DATE 04/02/97	CHECKED JMC	SCALE 6:1	FSCM ODWJ4
APPR. AT	DWG. NO. 310-910-0630G	REV. D		