

Required: Recessed Extrusion Light Body . P/N: L-F
12VDC Class 2 or LPS Power Supply, Maximum Wattage 60W

Optional: Jumper Cord (various lengths) . . P/N: L-LED-TPELNK

See other Accessories below.

INFINE~~X~~ Installation Instructions

Extrusion LEDs - Flush Recessed

12VDC Dimmable

READ ALL INSTRUCTIONS BEFORE INSTALLING SYSTEM.
Follow all OSHA safety regulations when operating machinery.

Tresco® Extrusion Lights come with (3) output options:

| | Tresco® 60W Class 2 12V DC Power Supply powers up to (total length) | To prevent Voltage Drop Maximum continuous run should not exceed |
|--|---|--|
| • SO 4.9W/m (1.5W/ft.) | 12.2m (40') | 6.1m (20') |
| • HO 9.8W/m (3.0W/ft.) | 6.1m (20') | 4.9m (16') |
| • VHO 14.4W/m (4.4W/ft.) | 4.0m (13') | 4.0m (13') |

Before beginning installation, be sure power is turned OFF to light system.

To begin installation, roughly lay out lighting system to help verify final positioning of all components and cord lengths.

1. Install **Power Supply** concealed from view.

Do not plug/wire Power Supply into 120V power source yet (*see fig. #1*).

2. Determine final position of Light Fixture(s). If needed, mark position on mounting surface/shelf using bottom edge of light fixture as a template.

3. Cut groove (or dado) on flat mounting surface 19mm (3/4") wide.
- Minimum 11mm (7/16") deep. (*see #2a*)

4. Drill a hole (concealed from view) at end of routed channel for Starter Cord wires to exit. Starter Cord only requires 5mm (3/16") hole *before* optional AMP® Connector is attached. (*See "Connecting Starter Cords" information below †*).

5. When mounting Light, it is easier to first place one edge into channel, then rock in other edge (*see fig. #3*). The Recessed Extrusion has raised ribbing on its sides to "friction fit" into the routed channel.

6. After mounting light, connect starter cord to power supply output (*see fig. #4*). If using optional AMP connector attach according to *figure #5*. If spacing from light to power supply is farther than the supplied 2m (79") a L-LED-LINKD extension may be used. **NOTE:** Maximum length of Starter Cords from Power Supply to light should not exceed 5m (16'). Longer cords could result in poor light quality.

7. Finally, plug/wire power supply into 120V power source. A licensed electrician should be consulted for all hardwire installations.

Accessories: 12VDC Extension Cords (P/N: L-LED-LINKD) (*used to lengthen Starter Cords only*) available in 15cm (6"), 25cm (10"), 60cm (24"), 120cm (48"), or 180cm (72") lengths.

Tresco® offers other accessories including: Switches and Dimmers.
Other Power Supply options available.

Save these instructions for future reference.
For technical assistance: 1-800-227-1171

Place one edge into channel,
then rock in other edge.

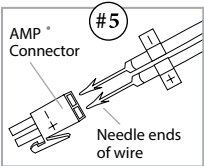
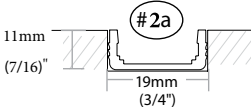
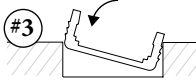

For Starter Cord - Push needle ends completely into AMP Connector. Match polarity (+) and (-).

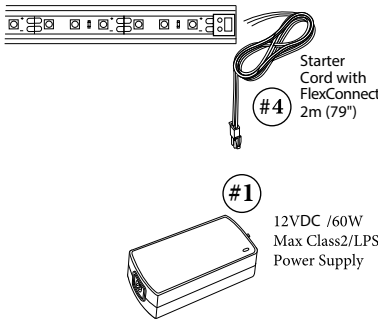

IMPORTANT SAFETY INSTRUCTIONS

CAUTION: To reduce the risk of fire, electric shock, or injury to persons:

- 60W Class 2/LPS 12V DC Power Supply powers up to:
12.2m (40') of Extrusion SO; max. single continuous run should not exceed 6.1m (20').
6.1m (20') of Extrusion HO; max. single continuous run should not exceed 4.9m (16').
4.0m (13') of Extrusion VHO; max. single continuous run should not exceed 4.0m (13').
- Tape LED strip is replaceable. Single LEDs are not replaceable.
- LED lights are bright. Do not look directly at lights.
- Not intended to be used in damp locations or outdoor areas.
- Not intended for recessed installation in ceilings or soffits.
- Do not conceal 120V Power Cord or Power Supply inside a wall, ceiling, soffit, or similar permanent structure, unless consulting a licensed electrician.
- Use only insulated staples or plastic ties to secure ALL loose cords.
- Route and secure cords so that they will not be pinched or damaged when the cabinet is pushed to the wall.
- A licensed electrician should be consulted for wiring through ceilings, soffits, or walls. All wiring must follow NEC regulations.

• This light is suitable for use within closet storage spaces.

This light is intended to be used as a cabinet light on wood, particle board or other structurally sound, heat resistant surface. Care should be taken during and after installation to avoid contact of light with wiring, cord, or any combustible material.



Tresco Lighting by Rev-A-Shelf
12400 Earl Jones Way
Louisville, KY 40299

Tel: 800-227-1171
Fax: 502-491-2215

Email: cservice@trescolighting.com
Web: www.trescolighting.com