

4358-6849 (10.30.15)



Apt 40, Apt 40 LX

Convertible Car Seat

rear-facing child restraint 2.3-18 kg (5-40 lbs.) 48-91 cm (19-36 in.)

forward-facing child restraint 10-18 kg (22-40 lbs.) 74-102 cm (29-40 in.)



Read all instructions **BEFORE USING**
this child restraint.

KEEP INSTRUCTIONS FOR FUTURE USE.

WARNING:

Failure to read, understand and follow the instructions and warnings in this instruction manual and the warnings on the system could result in serious injury or death to the child.

A. Before You Begin.....Pages 3-8

- A-1 Thank You...
- A-2 DJG Consumer Relations Contact Information
- A-3 Registration and Safety Notices
- A-4 Understanding Your Child Restraint

B. Safety Information..... Pages 9-11

- B-1 Vehicle Seating Position
- B-2 Installation in Vehicle
- B-3 Child Restraint Use
- B-4 Transport Canada Regulations

C. Basic UsePages 12-26

- C-1 Choose Position for Your Child
- C-2 Preparing Child Restraint to Fit Your Child
- C-3 Securing Child in Child Restraint
- C-4 Removing Child From Child Restraint
- C-5 Accessories on Select Models
- C-6 Removing Seat Pad for Cleaning
- C-7 Install Harness System

D. General Vehicle Installation Pages 27-31

- D-1 Understanding Your Vehicle
- D-2 Vehicle Seating Position
- D-3 Choosing UAS or Vehicle Belts
- D-4 Knowing Your Vehicle Belts

E. Aircraft Installation.....Page 32

F. Install Rear-Facing..... Pages 33-42

F-1 Prepare to Install Rear-Facing

F-2 Prepare UAS for Rear-Facing Use

F-3 Install Rear-Facing with UAS



F-4 Install Rear-Facing with Vehicle Belts



G. Install Forward-Facing Pages 43-51

G-1 Prepare to Install Forward-Facing

G-2 Adjusting the Tether Strap

G-3 Prepare UAS for Forward-Facing Use

G-4 Install Forward-Facing With UAS



G-5 Install Forward-Facing with Vehicle Belts



H. Using the Locking Clip..... Page 52-54

Important Information..... Pages 55-58

Warranty
Replacement Parts Order Form

A-1 Thank You...

Thank you for choosing this car seat, referred to throughout this manual as a child restraint. Dorel Juvenile Group, (DJG) is committed to creating convenient, comfortable, and dependable products for children.

No one can predict if use of a child restraint will prevent injury or death in a particular crash. However, combined with careful driving, proper use of a child restraint can lower a child's risk of injury or death in most crashes.

Your child's safety is worth the time it will take to read, understand and follow the instructions and warnings.

After reading if you still have questions or concerns with the child restraint please contact our Consumer Relations Department.

On the back of the shell there is an expiry date for use of this child restraint. Do not use this seat after the expiry date.

A-2 Dorel Juvenile Group Consumer Relations Contact Information

Dorel Juvenile Group, Inc.

Website: www.djgusa.com
Fax: 1-800-207-8182
Mailing Address: Dorel Juvenile Group, Inc.
P.O. Box 2609
Columbus, IN 47202-2609
Telephone: 1-800-544-1108
8 A.M. to 6 P.M. EST M-TH
8 A.M. to 4:30 P.M. EST FRI

A-3 Registration and Safety Notices

Although child restraints are tested, evaluated and certified by the manufacturer and tested by Transport Canada, it is possible that a safety-related problem may be found. If there is ever a safety issue with your child restraint, we use registration information to reach owners.

Tear Off and Mail This Part or Register Online / Détachez et postez cette partie ou enregistrez en ligne 4359-41170

Consumer: Just fill in your name, address and email. Please print.
Client: Simplement inscrire votre nom, adresse et courriel. S.V.P. imprimez.

Your Name/Votre nom: _____

Your Street Address/Votre adresse: _____

Province: _____

Model Number: **22163C - SGT**

Line Code: **COSCO ALPHA OMEGA**

Manufacture Date: **2008/12/08**

Date of Purchase/Date d'achat: _____

L#3 B 119348

Barcode: [Barcode]

If you don't have the card or if your address changes, you will find the model number and manufactured date on the label located on the side of shell. There are three additional ways to register your information:



Online: www.djgusa.com/registration/carseat/can
Telephone: 1-800-544-1108
Mail: Send your name, address and your child restraint's model number, manufactured date, and date of purchase to:
Dorel Juvenile Canada
2855 Argentia Road, Unit 4
Mississauga, ON L5N 8G6
Attn: Consumer Relations

Please do not send in your registration card if you have registered your child restraint online.

For information on safety-related problems, you can also call Transport Canada's Road Safety Dept. at: 1-800-333-0371.

A-4 Understanding Your Child Restraint

Front View

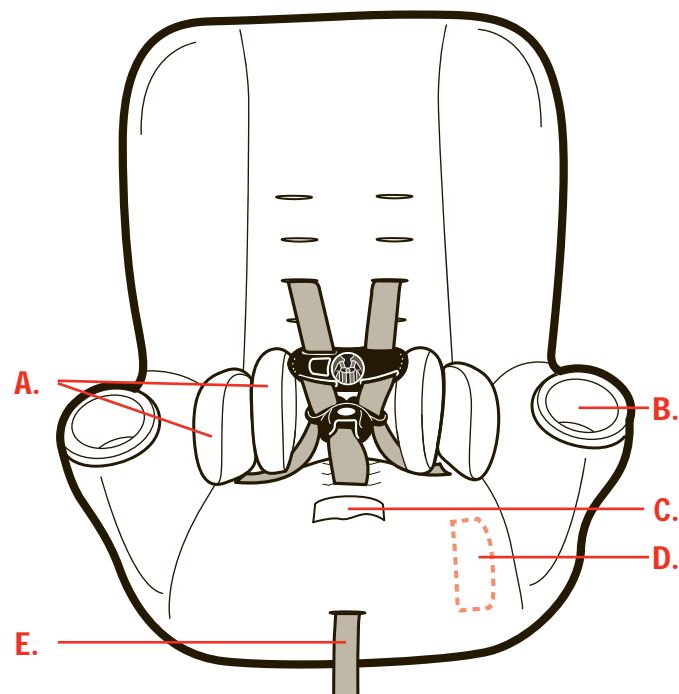

- A. Body Pillows**
(on select models)
- B. Cup Holder**
- C. Harness Adjustment Lever** (under flap)
- D. Instruction Manual Storage** (under pad)
- E. Harness Adjustment Strap**

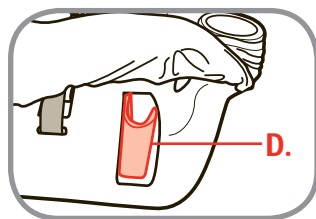

Pad layout may not be the same as shown. See section C-5 for other possible accessory options.

Harness System Detail

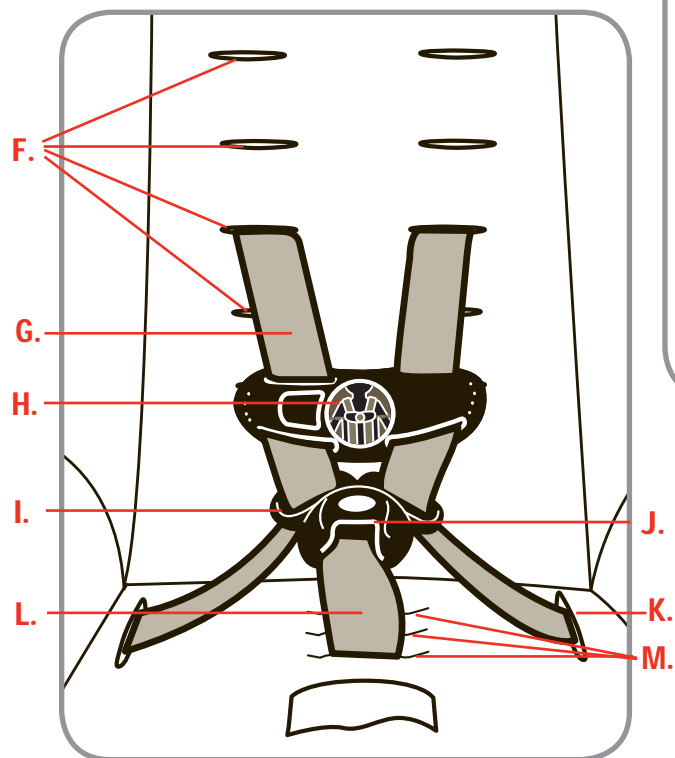

- F. Upper Harness Slots**
- G. Harness Straps**
- H. Chest Clip**
- I. Buckle Tongue**
- J. Buckle**
- K. Lower Harness Slots**
- L. Buckle Strap**
- M. Buckle Strap Slots**

- N. Harness Strap's Metal Retainers**

Bottom of Child Restraint

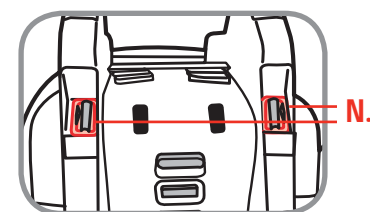

A. Before You Begin

Back View

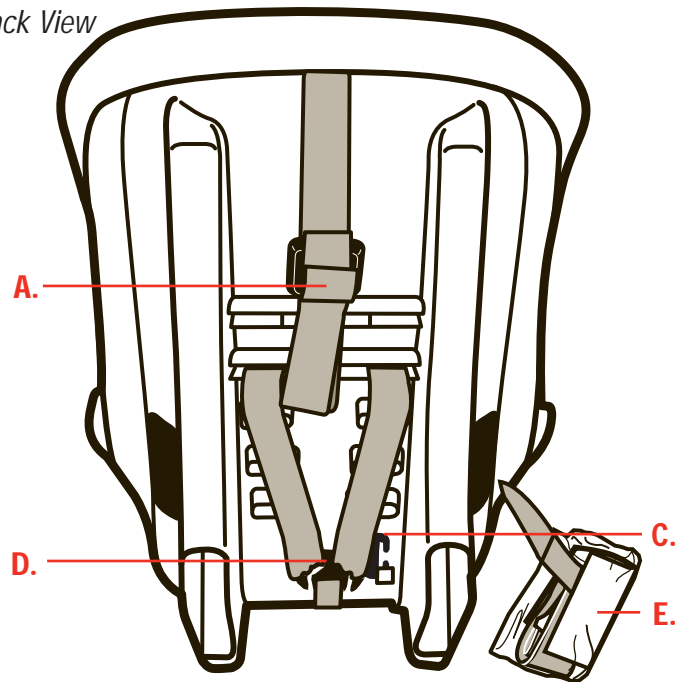

A. Tether Strap with Adjuster and Hook



B. Tether Attachment for Storage

C. Locking Clip (behind harness)

D. Splitter Plate

E. UAS* Belt

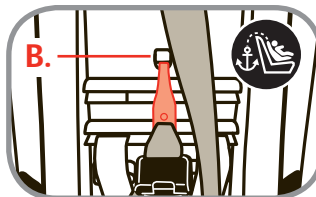
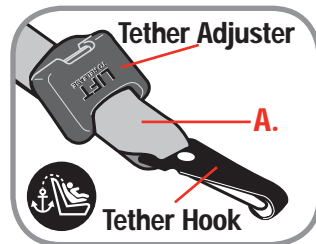

*Universal Anchorage System (UAS)

Side View

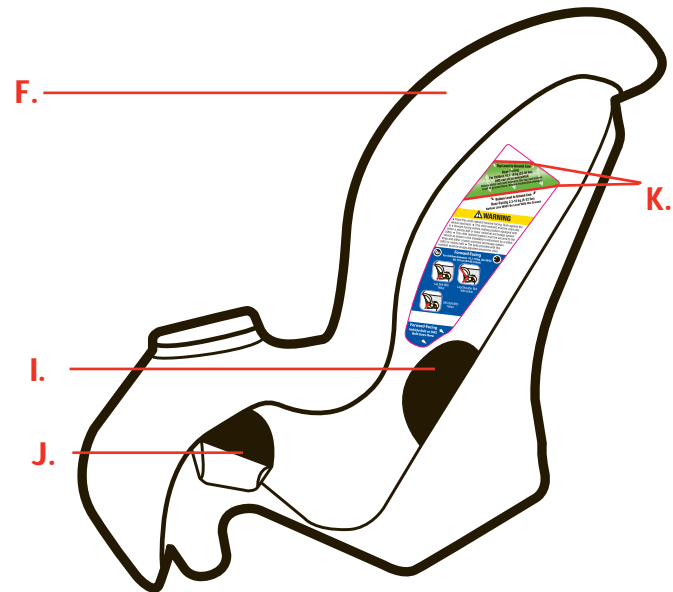

A. Before You Begin

F. UAS* Attachment for Storage (behind pad)



G. UAS* Adjuster

H. UAS* Hook

I. Forward-Facing Belt Path

J. Rear-Facing Belt Path

K. Rear-Facing Level To Ground Lines (on side of shell)

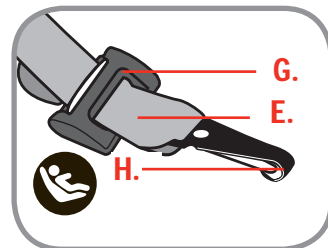
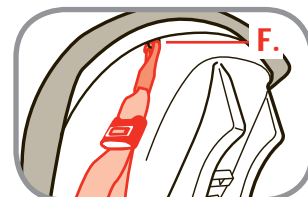

⚠ WARNING:

Failure to read, understand and follow the instructions and warnings in this instruction manual and the warnings on the system could result in serious injury or death to the child.

B-1 Vehicle Seating Position



⚠ Never install a rear-facing child restraint in the front seat of a vehicle equipped with an active passenger side frontal airbag.

⚠ Always check vehicle owner's manual for child restraint use with side air bags.

⚠ For vehicles with no rear seats, check the vehicle owner's manual for location and installation of a child restraint.

B-2 Installation in Vehicle

⚠ Check the vehicle belt or UAS belt before each use. Use only if the belt is tightened properly and securely.

⚠ When unoccupied the rear-facing child restraint must be firmly secured to the vehicle with a lower universal anchorage system if available or with a vehicle seat belt. The tether strap must be stored as described in the instruction manual.

⚠ When unoccupied, the forward-facing child restraint must be firmly secured to the vehicle with a lower universal anchorage system if available or with a vehicle seat belt and the tether strap.

⚠ In a crash or sudden stop, an unsecured child restraint could injure the driver or other occupants in the vehicle.

⚠ Always check vehicle owner's manual for proper use of vehicle seat belts and the universal anchorage system (UAS) with your child restraint.

⚠ In very few vehicles, the child restraint cannot be properly installed because of the type of seat belt system, airbag system and/or lack of location to anchor the tether strap. Always read and follow the vehicle owner's manual instructions for child restraint use.

B-3 Child Restraint Use

⚠ Do not use a child restraint that has been in a crash or a collision. The system must be replaced.

⚠ Do not use a child restraint if you do not know the history of the restraint.

⚠ Never take your child out of the child restraint or attend to the child's needs while the vehicle is moving.

⚠ Never leave a child unattended in the child restraint.

⚠ To avoid the child being seriously burned, always check for hot seat and buckles before using this child restraint.

⚠ Do not use a child restraint with missing or damaged parts.

▲ **Do not lubricate the buckles, harness system or fasteners for any reason.**

▲ **DJG does not recommend the use of accessories or add-ons that have not been certified with this child restraint at original purchase date.**

▲ **Never allow any child to play with this child restraint; it is not a toy.**

▲ **Do not remove the warning labels.**

▲ **This child restraint has been certified for use in passenger vehicles and aircraft. Do not use in a boat, on a motorcycle or in a cargo van or bus where there are no seat belts or tether anchors. Do not modify for use as a crib or a swing. Do not leave on stove top or any other hot surface.**

▲ **Read all instructions and warning labels for additional warnings.**

B-4 Transport Canada Regulations

Transport Canada Road Safety Directorate regulates children's restraint systems under the Motor Vehicle Restraint Systems Safety Regulations (RSSR). The regulations require the manufacturer and/or importer to certify the child restraint to the applicable safety standards and place specified warnings and information on the labels fastened to each child restraint and in this instruction manual.

C-1 Choose Position for Your Child

Your child's height, weight, and age determine how your child restraint should be placed in the vehicle and which restraint should be used.

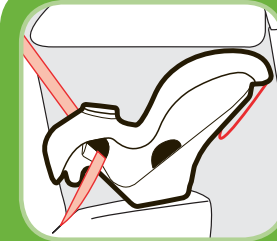

**2.3-18 kg (5-40 lb.)
48-91 cm (19-36 in.)**

**Rear-Facing using
5-point harness**

Infant and infant restraint are placed in the back seat and face the rear of the vehicle.

NOTE: Infants **MUST** be rear-facing until they are at least 1 year of age, weigh 10 kg (22 lbs) AND are able to walk unassisted.

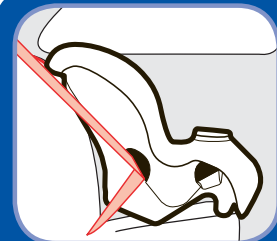

**10-18 kg (22-40 lb.)
74-102 cm (29-40 in.)
Over 1 Year Old**

**Forward-Facing using
5-point harness**

Child and child restraint are placed in the back seat and face the front of the vehicle.

NOTE: Children **must** be 1 year old or older for forward-facing position.

▲ **WARNING:**

Verify your child's weight and height (do not guess) before choosing the child restraint's position.

C-2 Preparing Child Restraint to Fit Your Child

You **MUST** make these adjustments with your child before you install the child restraint in the vehicle.

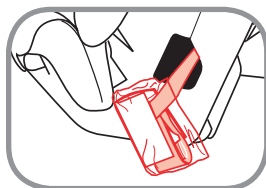

1. Pull UAS Belt Out from the Shell

Remove UAS from any packaging. Discard the packaging.

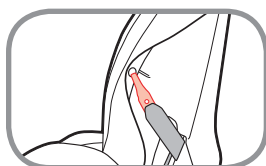

2. Secure UAS

You **MUST** attach the UAS hooks to the UAS attachments as shown when not in use.

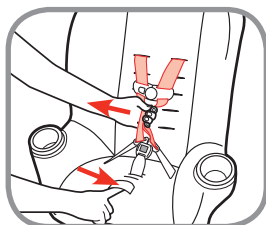

3. Loosen Harness Straps

Push in on the harness adjustment lever under the flap. Pull out on harness straps just above buckle tongues.

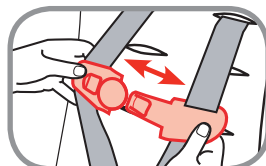

4. Release Chest Clip

Press on chest clip release button and pull apart.

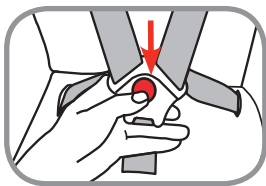

5. Unbuckle Harness

Press down on the red buckle release button to release the buckle tongues. Place harness straps over sides of child restraint.

13



6. Place Child in Child Restraint

Place the child's bottom and back flat against the child restraint. This will increase comfort and allow the harness straps to be properly tightened.

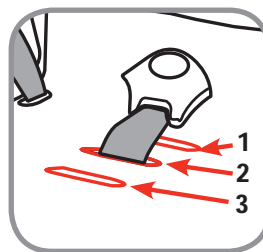

7. Check Buckle Position

Determine which of the three buckle strap slots that is both comfortable and snug to use.

NOTE: Thread buckle strap through the slot closest to child.

You **MUST** use the 1st or 2nd buckle strap slots when rear-facing. Any slot can be used for forward-facing.

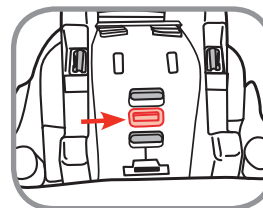

a. To Change Buckle Position

Remove child from child restraint.

Turn the child restraint over and locate buckle strap's metal retainer.

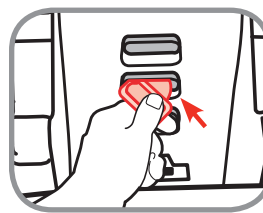

b. Rotate the metal retainer, then insert retainer up through the shell and pad.

C. Basic Use

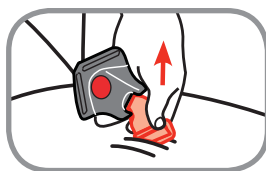

- c. From the front, pull buckle strap free from shell and pad.

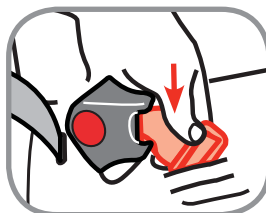

- d. Choose one of the three buckle slots that is closest to child. From the front of child restraint, push the metal retainer through pad and shell. Make sure that the buckle is **facing out**.

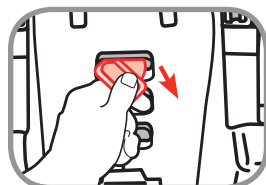

- e. From the bottom of child restraint pull metal retainer **completely** through pad and shell.

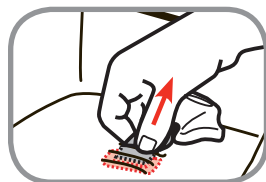

- f. Pull up on buckle strap to make sure it is secured.
The buckle must not pull out.

⚠ WARNING:

Failure to place buckle strap's metal retainer completely through pad and shell can result in serious injury or death.

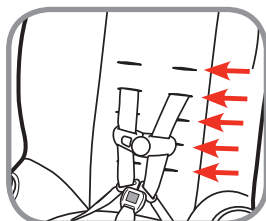

8. Check Harness Height

With child in the child restraint, check the location of the upper harness slots.

Follow the guidelines on the next page to determine the correct harness height.



Rear-Facing Position

Upper harness slots must be **even with or just below** the shoulders.

If the lowest upper harness slots are above the infant's shoulders, **do not** use this child restraint. Children have a tendency to want to slouch. Make sure the child's bottom and back are flat against the child restraint. If harness height is still incorrect, call Consumer Relations for more detailed help.



Forward-Facing Position

Upper harness slots must be **even with or just above** the shoulders.

If the highest upper harness slots are below the child's shoulders, **do not** use this child restraint.

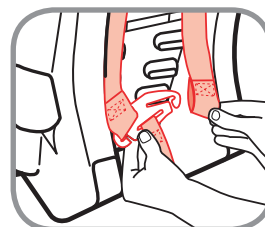

9. To Change Harness Strap Location

With harness system loosened, from the back, unhook harness strap loops from the splitter plate.

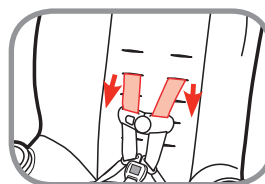

- a. From the front of child restraint, pull harness straps out of the upper harness slots.

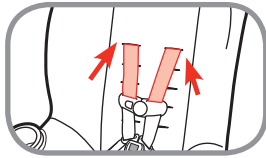

- b. Rethread harness straps into new upper harness slot location.

NOTE: DO NOT twist the harness straps.

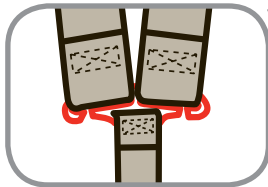

10. Attach Harness Straps to Splitter Plate

From the back of the child restraint, fit the harness strap loops onto the splitter plate.

NOTE: Make sure sewn end of the harness strap loops faces towards you. DO NOT twist harness straps or harness adjustment strap and make sure the harness straps are COMPLETELY ON the splitter plate.

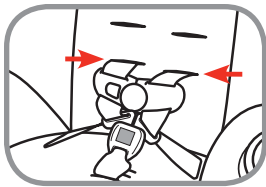

To Use the Lowest Harness Slots

When using the lowest harness slots in the seat back, you **MUST** move the harness's metal retainer to the inside position on the bottom of the seat. This will allow a proper fit for the lowest upper harness slot use.

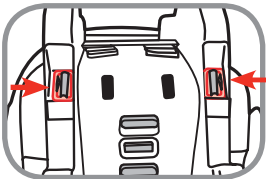

- a. Rotate the child restraint over and locate both metal retainers.

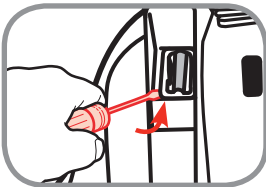

- b. Use a flathead screwdriver and lift metal retainer off plastic tab.

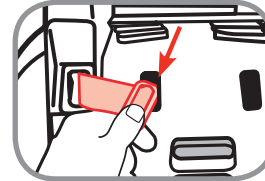

- c. Insert the harness strap's metal retainer into the slot as shown.

Repeat for other side.

Do not twist harness straps.

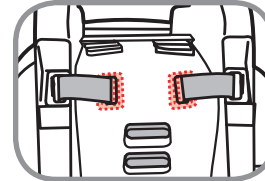

From the front of the seat, pull on the harness straps to make sure they do not pull out.

⚠ WARNING:



Do not use this child restraint rear-facing if the top of your child's head is above the top of the child restraint.



Do not use this child restraint forward-facing if the midpoint of your child's ears are above the top of the child restraint.

Make sure the harness height is correct for your child's size.

Incorrect use of the harness system is the most common mistake people make. Verify frequently that the harness height is correct for your child's size. It is very important to read, understand and follow all instructions and warnings.

Failure to follow these steps can result in serious injury or death.

C-3 Securing Child in Child Restraint



1. *Position Harness Straps Over the Child's Shoulders*

Place the child's bottom and back flat against the child restraint. This will increase comfort and allow the harness straps to be properly tightened.



2. *Buckle Harness*

Push each buckle tongue into buckle until you hear a "click". Remember to always pull up on harness straps to make sure buckle is locked.

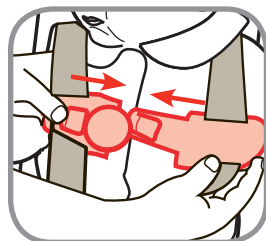

3. *Close Chest Clip*

Insert right half of chest clip into left half and snap together.

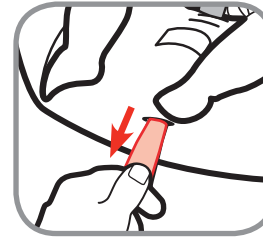

4. *Tighten Harness Straps*

Pull on harness adjustment strap to tighten harness snugly.

NOTE: A snug harness is not loose and lies flat against the child without sagging. It does not press on the child's flesh or push the child's body into an unnatural position.



5. *Check Harness Tightness*

Try to pinch the harness straps at the shoulders. If you can pinch the harness strap, tighten more. If your fingers slip off, the harness is tight enough.



6. *Position Chest Clip*

Slide chest clip up or down so that it is at mid-chest (even with armpits) and away from the child's neck.

C. Basic Use

⚠ WARNING:

Failure to fasten and tighten the harness system correctly may allow the child to be ejected from the child restraint in a crash or sudden stop causing serious injury or death.

Do not mistake comfort for safety. Harness system must be snugly adjusted.

C-4 Removing Child From Child Restraint

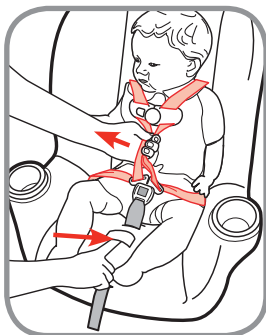

1. *Loosen Harness Straps*

Push in on the harness adjustment lever under the flap. Pull out on harness straps just above buckle tongues.

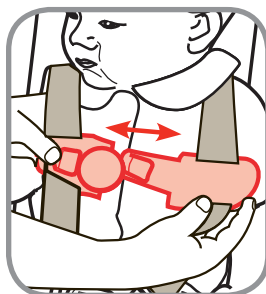

2. *Release Chest Clip*

Push in the release button and pull apart.

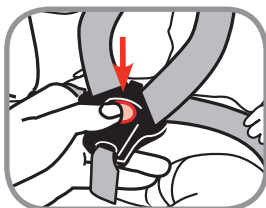

3. *Unbuckle Harness*

Press down on the red buckle release button to release the buckle tongues. Place harness straps over sides of child restraint and remove the child.

C-5 Accessories on Select Models

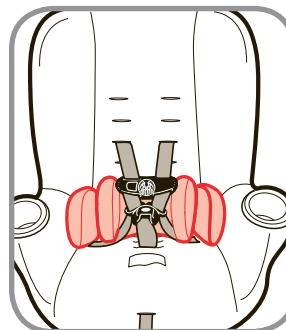

Body Pillows

The body pillows provide extra comfort for your child.

To remove the body pillow, slide out from behind the harness straps.

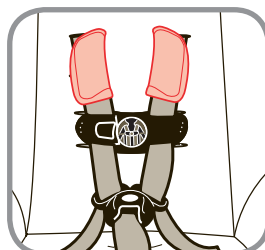

Harness Covers

The harness covers help to provide comfort to the infant's neck. For harness covers to fit correctly you may have to push the ends of the covers through the upper harness slots.

There are different harness cover styles, depending on your model.

To remove the harness covers with fastening strips, you will have to undo the fastening strips and remove harness covers.

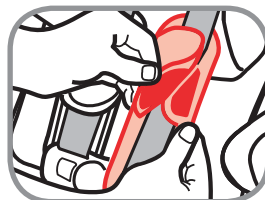

To remove harness covers without fastening strips, you will have to unhook the harness straps from splitter plate, pull harness straps out of the upper harness guides and remove harness covers. Rethread harness straps and re-hook the harness strap loops onto the splitter plate (see section C-7).

C-6 Removing Pad for Cleaning

Only remove the harness system to clean the seat pad.

NOTE: For easier removal, leave the harness system buckled.

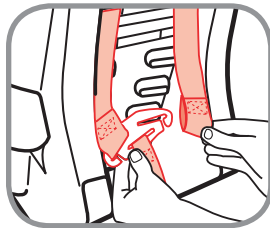

1. Unhook Harness Straps from Splitter Plate

Fully loosen harness straps. Starting in the back of the child restraint, unhook harness strap loops from splitter plate.

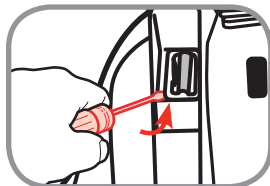

2. Remove Harness Strap's Metal Retainer From Shell

Turn the child restraint over. Use a flathead screwdriver and lift harness strap's metal retainer off plastic tab.

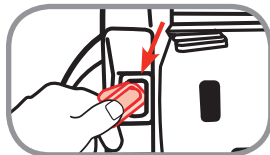

Insert the metal retainer through shell and pad. Repeat for other side.

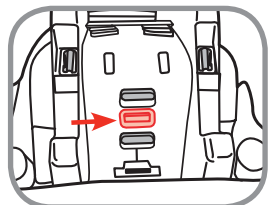

3. Locate Buckle Strap's Metal Retainer

Turn the child restraint over and locate buckle strap's metal retainer.



4. Insert Metal Retainer Through Shell and Pad

Rotate buckle strap's metal retainer, then insert retainer up through the shell and pad.

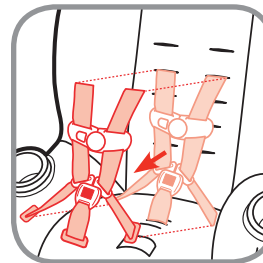

5. Lift Harness System Out of Shell and Pad

Pull harness system completely out of the shell and pad.

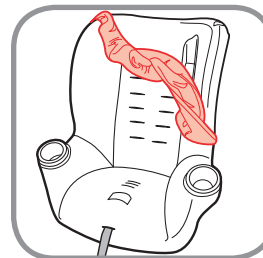

6. Remove Pad

Pull pad off the top of child restraint and remove pad.

Cleaning Pad

Machine wash separately with cold water on a gentle cycle. Do not use bleach. Tumble dry separately for 10-12 minutes on low heat. Remove immediately.

Harness Straps: Spot clean only. Do not machine or hand wash.

⚠ WARNING:

Do not use this child restraint without the seat pad. Failure to do this can result in serious injury.

Install Pad

Replace seat pad by reversing order for your particular model. Slip pad on shell. Pull harness adjustment strap and each harness strap through pad. Wrap pad around the top of shell. Pull pad around each cup holder and slip pad over the sides of the child restraint. Install harness (see section C-7).

C-7 Install Harness System

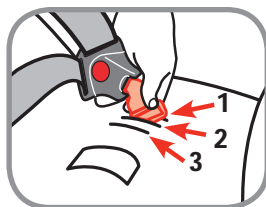

1. Install Buckle Strap

Choose one of the three slots that is closest to child. From the front of child restraint, push buckle strap's metal retainer through pad and shell. Make sure that buckle is **facing out**.

You MUST use the 1st or 2nd buckle strap slots when rear-facing. Any slot can be used for forward-facing.

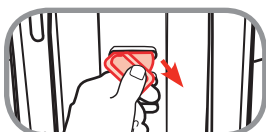

2. From bottom of child restraint, pull buckle strap's metal retainer **completely through** pad and shell.

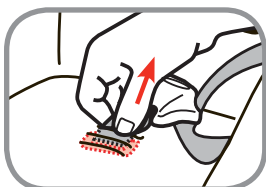

3. Check Buckle

Pull up on buckle strap to make sure it is secured.

The buckle must not pull out.

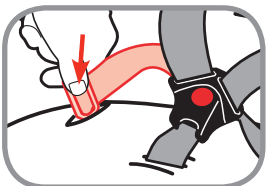

4. Thread Harness Straps's Metal Retainer Into Shell

Push the harness's metal retainer into the lower harness slot making sure it goes completely through the pad and shell. **Do not twist harness straps.**

⚠ WARNING:

Failure to place buckle strap's metal retainer completely through pad and shell can result in serious injury or death.

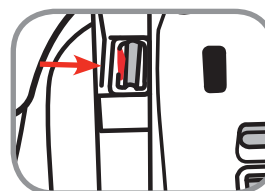

5. Lock Harness's Metal Retainer

Turn over child restraint. From the front, pull on the harness straps to lock the metal retainer into place.

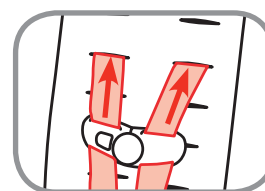

6. Push left harness strap through left upper harness slot and right harness strap through right upper harness slot at the same height so they are even.

Do not twist harness straps.

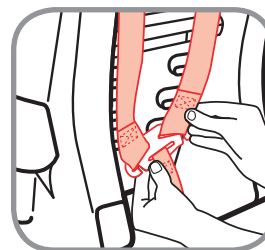

7. Attach Harness Straps to Splitter Plate

From the back of the child restraint, fit the harness strap loops onto the splitter plate.

NOTE: Make sure sewn end of the harness strap

loops faces towards you. **DO NOT** twist harness straps or harness adjustment strap and make sure the harness straps are **COMPLETELY ON** the splitter plate.

⚠ WARNING:

You must install the harness system properly. Failure to follow these warnings can result in serious injury or death.

D-1 Understanding Your Vehicle

Your vehicle's features may be considerably different than those pictured here. Consult your vehicle owner's manual to help identify your vehicle's specific features and locations.

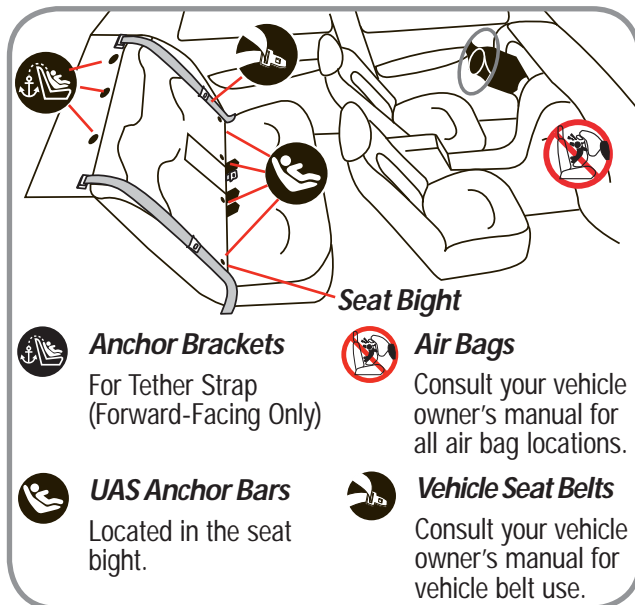

Safety Tip:

To help protect your vehicle seat's upholstery from damage, use a car seat mat or a single layered towel underneath and behind child restraint.

To avoid your child being seriously burned, take the following precautions:

1. Park in the shade or where sun does not directly hit the child restraint.
2. Cover the child restraint with a sheet or blanket when not in use.
3. Check for hot seat and buckles before placing child in child restraint seat.

D-2 Vehicle Seating Position

⚠ WARNING:



Never install a rear-facing child restraint in the front seat of a vehicle equipped with an active passenger side frontal airbag.

In very few vehicles, the child restraint cannot be properly installed because of the type of seat belt system, airbag system and/or lack of location to anchor the tether strap. Always read and follow the vehicle owner's manual instructions for child restraint use.

⚠ WARNING:



Use the child restraint only on vehicle seats that face forward. Do not use on seats that face the sides or rear of the vehicle. For vehicles with an airbag, but without a back seat, refer to your vehicle owner's manual.

Safety Tip:



Children are safer when properly restrained in a rear seating position than in the front seating position.

According to accident statistics, children in rear seating positions are statistically safer, whether you have airbags, advanced airbags, or no airbags at all.

D-3 Choosing UAS or Vehicle Belts

When installed properly, either the UAS or Vehicle Belts will secure the child restraint equally.

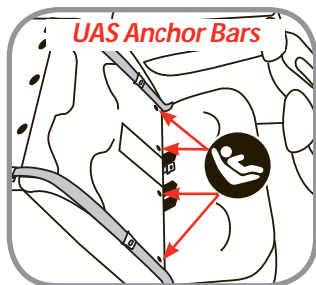

The UAS

The Universal Anchorage System (UAS) is for installing child restraints without using vehicle seat belts.

The UAS can ONLY be used in vehicles that have the UAS anchor bars

installed and designated UAS seating positions. Most vehicles manufactured after September 2002 are equipped with UAS.

Check your vehicle owner's manual to see which seating positions may be equipped with UAS.

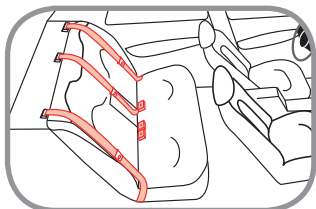

Vehicle Belts

If UAS is not an option, you must use the vehicle seat belt system to install the child restraint. There are some vehicle belts

that will not work with a child restraint or will require special attention.

See next page and check your vehicle's owner's manual for specific instructions.

WARNING:

Do not use both the UAS belt and vehicle belt at the same time.

D-4 Knowing Your Vehicle Belts

Review your vehicle's owner manual for vehicle seat belt use with child restraints. This is your best source for information concerning your vehicle.

Not all vehicle belts will work with this child restraint. This child restraint must be tightly locked in place at all times, during travel. You must determine if your vehicle's belts are compatible with this child restraint.

Vehicle Belts

• Automatic/Passive vehicle seat belts

You MUST have a lap belt to install any child restraint. An automatic (passive) shoulder belt may or may not have a separate lap belt. Consult your vehicle owner's manual.



• Vehicle belts in center of the door or side panel

You must move the child restraint to another seating location. Consult your vehicle owner's manual.

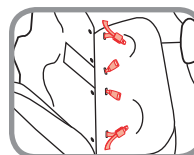

• Vehicle belts that are in front of the seat bight

You may need to move the child restraint to another seating location. Consult your vehicle owner's manual.

• Do Not Use with inflatable seat belts

You may need to move the child restraint to another seating location or use UAS belts only.

• ELR (Emergency Locking Retractor) vehicle belts

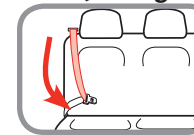

These lap and shoulder belts only lock in a sudden stop or crash, and do not properly secure a child restraint alone. Consult your vehicle owner's manual.

To learn if you have this type of belt, gently pull the belt all the way out of the retractor (spool), let it return several inches, then pull on it again.

If it moves freely, it is an ELR belt. If it is locked and will not allow any more belt to come out, it is a switchable retractor. If you have an ELR lap and shoulder belt, review the "Vehicle Latch Plate" section to see if you need a locking clip.

⚠ WARNING:

ELR lap-only belts MUST NOT be used with this child restraint.

• **Switchable retractor**

These belts switch from ELR to ALR (Automatic Locking Retractor). You must have the vehicle belts in the locking mode to use them. Follow the instructions in the installation sections.

• **ALR (Automatic Locking Retractor)**

These belts lock after pulling the webbing out and letting the belt go back into the retractor an inch or two. Follow the instructions in the installation sections.

Vehicle Latch Plates

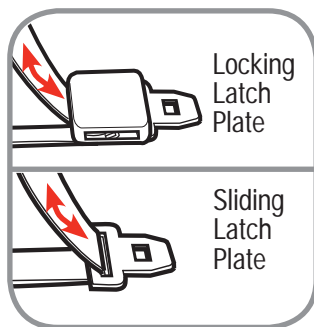

• **Check the Latch Plates**

Buckle the lap/shoulder belt. Pull on the lap belt portion. If the vehicle belt does not loosen or slip, you have a locking latch plate. You should not need to use a locking clip. Consult your vehicle owner's manual.

If the belt loosens or slips, you have a sliding latch plate. If you have an ELR retractor and a sliding latch plate, you **MUST** use a locking clip to install the child restraint or move to another seating location. You may not need to use the locking clip with a switchable or ALR retractor. Consult your vehicle owner's manual.

E. Aircraft Installation



This child restraint is certified for aircraft use. Use only on forward-facing seats and in a position where the seat belt can be tightened securely. The installation is the same

as in your vehicle. Use only with F.A.A. certified equipment. Contact the airline before taking the child restraint on an aircraft in order to comply with their regulations.

⚠ WARNING:

Secure UAS belts and tether strap when using the aircraft belts.

NOTE: Install the child restraint in a window seat to avoid blocking the aisle. If the aircraft lap belt is too short, ask the flight attendant for a belt extender.

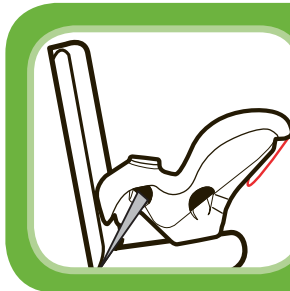

Rear-Facing Aircraft Installation

For rear-facing installation, follow section F-4 Install Rear-Facing with Vehicle Belts.



Forward-Facing Aircraft Installation

For forward-facing installation follow, section G-5 Install Forward Facing with Vehicle Belts.

F-1 Prepare to Install Rear-Facing

2.3-18 kg (5-40 lbs) and 48-91 cm (19-36 in.)
Rear-Facing using 5-point harness



 UAS Belt



 Lap/Shoulder Belt



 Lap Belt

WARNING:



Never install a rear-facing child restraint in the front seat of a vehicle equipped with an active passenger side frontal airbag.

This child restraint must always face the rear of the vehicle and be in the reclined position until the child is at least 1 year old, weighs 10 kg (22 lbs) AND is able to walk unassisted.



F-2 Prepare UAS for Rear-Facing Use

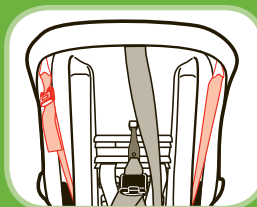

1. Unhook UAS

Remove the UAS from the forward-facing belt path, so both UAS hooks are on one side of the child restraint.



2. Routing UAS

Insert the UAS hook with adjuster through the rear-facing belt path.

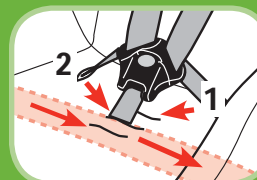

3. Pull UAS Hook Across to Opposite Side

Reach under pad and pull the UAS hook across the shell and out the rear-facing belt path on opposite side. UAS belt **MUST** be under pad and in front of buckle strap as shown.

Do not place belt over child's legs.

NOTE: You must use the 1st or 2nd buckle strap slots when rear-facing.

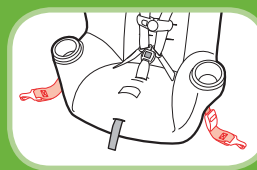

4. Finished UAS Routing

Make sure the UAS belt is not twisted.



F-3 Install Rear-Facing with UAS

NOTE: Review your vehicle's owner manual for UAS belt use.

⚠ WARNING:

Do not use the vehicle lap or lap/shoulder belt when using the Universal Anchorage System (UAS).

Check UAS belt before each use. Use only if the belt can be tightened properly and securely.

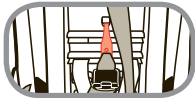

Secure the tether hook to the tether attachment when used rear-facing.

Do not fasten both UAS hooks on the same UAS anchor bar in the vehicle.

Recline the child restraint and rotate the child restraint to the correct recline angle that matches the weight of your child. Do not use the upright position when rear-facing. Do not rotate the child restraint beyond the bottom or top level to ground lines.

Failure to follow these warnings can result in serious injury or death.



1. Place Child Restraint in Vehicle Rear-Facing in the Back Seat

Move the front seats forward to give you room to install the child restraint.

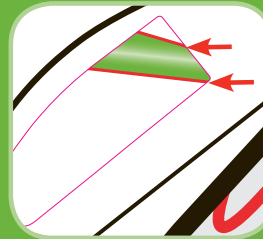

2. Rotate Child Restraint to Correct Recline Angle

For children between 2.3-10 kg (5-22 lb), the bottom level to ground line must be level with the ground.

For children between 10-18 kg (22-40 lbs) and are able to sit up unassisted, rotate the child restraint between the top and bottom level to ground lines.

NOTE: Only if needed, you may use a rolled towel(s) or foam noodle(s) under the front of the child restraint where the vehicle's seat back meets the vehicle's bench seat to get the correct recline angle.

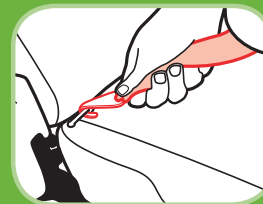
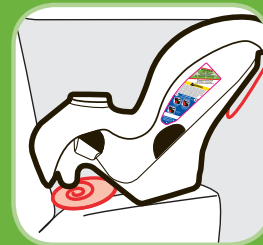

3. Connect UAS to Vehicle's UAS Anchor Bar

Fasten one UAS hook to the UAS anchor bar in the vehicle seat bight. Repeat for other side of child restraint.

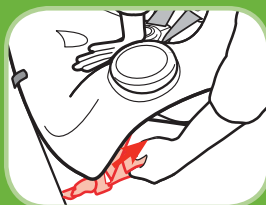

4. Tighten UAS Belt

Push down firmly on the child restraint and pull up on the free end of the UAS belt to tighten.

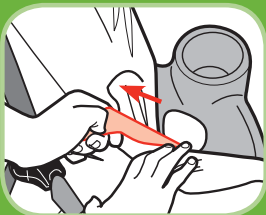

It may be easier to tighten the UAS belt through the belt path opening as shown.

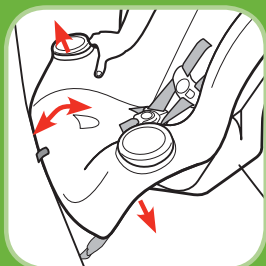

5. Check UAS Belt Tightness

Grasp the child restraint at the belt path with one hand. Push and pull the child restraint from side to side, forward and back. The child restraint should not move more than 2.5 cm (1 in) and the UAS belt should not loosen.

NOTE: If it moves more than 2.5 cm (1 in.) or if the UAS belt loosens, try reinstalling the child restraint or try another seating location.



6. Secure Child in Child Restraint

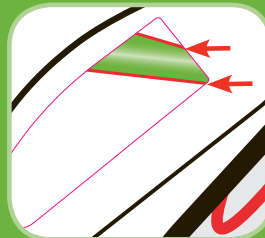

7. Recheck Recline Angle

Make sure the child restraint is properly reclined according to your child's weight. Repeat steps 1 through 6 if it is not reclined properly.



To Remove UAS Belt From Vehicle UAS Anchor Bar

Remove child from child restraint.

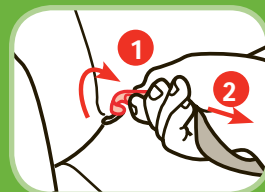

Press down firmly on UAS adjuster on side of child restraint and press the UAS adjuster release button to release the tension in the belt.

(1) Unhook the UAS hooks from vehicle anchor bar

by squeezing the spring lever, push UAS hook into the vehicle seat bight and twist hook off the anchor bar.
(2) Pull UAS hooks away from the UAS anchor bars.



F-4 Install Rear-Facing with Vehicle Belts

NOTE: Review section D-4 to determine what kind of vehicle belts you have. Review your vehicle's owner manual for seat belt use.

WARNING:

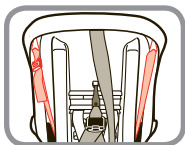

Do not use the UAS along with the vehicle lap or lap/shoulder belt. Secure UAS belts when using the vehicle belts.

Check the vehicle belt before each use. Use only if the belt can be tightened properly and securely.

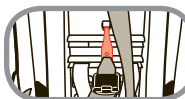

Secure the tether hook to the tether attachment when used rear-facing.

Recline the child restraint and rotate the child restraint to the correct recline angle that matches the weight of your child. Do not use the upright position when rear-facing. Do not rotate the child restraint beyond the bottom or top level to ground lines.

Failure to follow these warnings can result in serious injury or death.



1. *Place Child Restraint in Vehicle Rear-Facing in the Back Seat*

Move the front seats forward to give you room to install the child restraint.

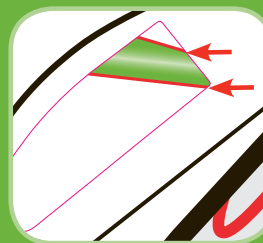

2. *Rotate Child Restraint to Correct Recline Angle*

For children between 2.3-10 kg (5-22 lb), the bottom level to ground line must be level with the ground.

For children between 10-18 kg (22-40 lbs) and are able to sit up unassisted, rotate the child restraint between the top and bottom level to ground lines.

NOTE: Only if needed, you may use a rolled towel(s) or foam noodle(s) under the front of the child restraint where the vehicle's seat back meets the vehicle's bench seat to get the correct recline angle.

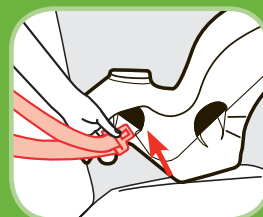

3. *Thread Vehicle Belt*

Thread the vehicle lap or lap/shoulder belt through the rear-facing belt path.

With an ALR belt, pull the belt all the way out before threading.

With a switchable retractor, pull the shoulder belt all the way out to switch the retractor into the ALR mode before tightening.

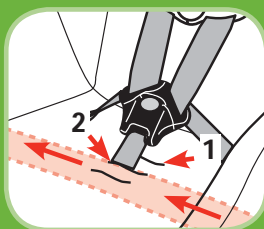

4. Pull Vehicle Latch Plate Across to Opposite Side

Reach under pad and pull the vehicle belt across the shell and out the rear-facing belt path on opposite side. Buckle vehicle belt. Vehicle belt **MUST** be under pad and **in front of buckle strap** as shown.

Do not place vehicle belt over child's legs.

NOTE: You must use the 1st or 2nd buckle strap slots when rear-facing.

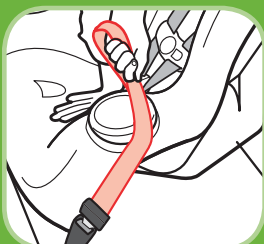

5. Tighten Vehicle Belt

Push down firmly on the child restraint and pull on the vehicle shoulder belt or lap belt to tighten.

With a switchable retractor, feed the shoulder belt back into the retractor while tightening.



It may be easier to tighten the belt through the belt path opening as shown.

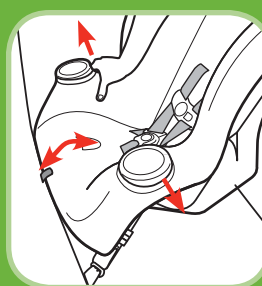

6. Check Vehicle Belt Tightness

Grasp the child restraint at the belt path with one hand. Push and pull the child restraint from side to side, forward and back. The child restraint should not move more than 2.5 cm (1 in) and the vehicle belt should not loosen.

NOTE: If it moves more than 2.5 cm (1 in.) or if the vehicle belt loosens, try reinstalling the child restraint or try another seating location.



7. Secure Your Child in the Child Restraint

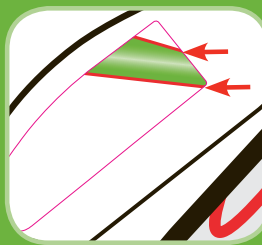

8. Recheck Recline Angle

Make sure the child restraint is properly reclined according to your child's weight. Repeat steps 1 through 7 if it is not reclined properly.

G-1 Prepare to Install Forward-Facing

10-18 kg (22-40 lbs) and 74-102 cm (29-40 in.) and at least 1 Year Old. Forward-Facing using 5-point harness



UAS Belt

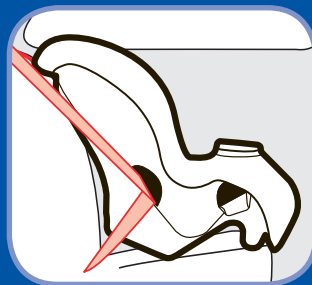

Lap/
Shoulder Belt



Lap Belt

⚠ WARNING:

Never place a child less than one-year old or weighing less than 10 kg (22 lb.) forward-facing.

Safety Tip:

Experts agree that children should remain rear-facing as long as possible. In this child restraint, your child can remain rear-facing up to 18 kg (40 lb.) and up to 102 cm (40 in.)



G-2 Adjusting the Tether Strap

The tether strap is used for the forward-facing position only. Vehicles manufactured today already have the tether anchor hardware installed in the vehicle. Refer to your owner's manual for locations. If your vehicle does not have a tether anchor bracket, please see your dealer or a qualified mechanic and have one installed.

⚠ WARNING:

Tether straps are required in Canada. Using this child restraint without the tether strap anchored as recommended by the manufacturer would be a misuse of the child restraint and, in a sudden stop or crash, could cause serious injury or death.

To Adjust Tether Strap:



To tighten: After the child restraint is locked into place with UAS or vehicle belt, put knee in child restraint, push down on the child restraint and attach the tether hook to the vehicle's anchor bracket. Pull on free end of the tether strap.



To loosen: Lift up on tether adjuster and push lock toward the tether hook.



G-3 Prepare UAS for Forward-Facing Use



NOTE: Pull the UAS belt out of the rear-facing belt path if you have used this child restraint rear-facing or remove from the storage location.

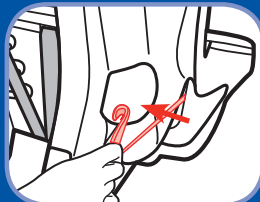

1. Routing UAS

Insert the UAS hook **with** the adjuster closest to it, through the forward-facing belt path.

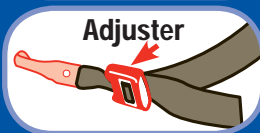

2. Pull UAS Hook Across to Opposite Side

Pull the UAS hook across the back and out the other side as shown. Do not twist the UAS belt.



G-4 Install Forward-Facing With UAS



NOTE: Review your vehicle's owner manual for UAS belt use.

⚠ WARNING:

Do not use the vehicle lap or lap/shoulder belt when using the Universal Anchorage System (UAS).

Check UAS belt before each use. Use only if the belt can be tightened properly and securely.

Do not fasten both UAS hooks on the same UAS anchor bar in the vehicle.

When used in the forward facing position, the child restraint must be used in the upright position. Vehicle seat back must be upright.

Failure to follow these warnings can result in serious injury or death.



1. Place Child Restraint in Vehicle Forward-Facing Flush Against Back Seat

When used in the forward facing position, the child restraint **MUST** be used in the **upright position**.

NOTE: Do not use the level to ground lines on the side of the child restraint in the forward-facing position.

G. Install Forward-Facing with UAS

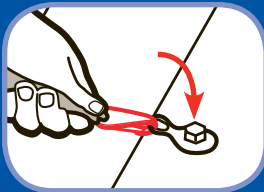

2. Loosely Attach Tether Hook to Vehicle's Tether Anchor

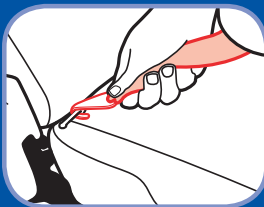

3. Connect UAS to Vehicle UAS Anchor Bar

Fasten one UAS hook to the UAS anchor bar in the vehicle seat bight. Repeat for other side of child restraint.

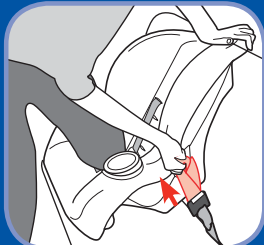

4. Tighten UAS Belt

Place knee in the child restraint. Push down firmly while pulling up on the free end of the UAS belt to tighten.

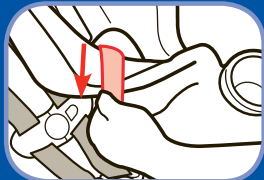

It may be easier to tighten the belt through the belt path opening as shown.

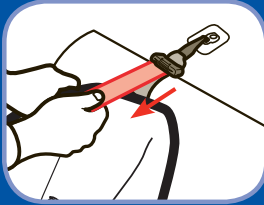

5. Tighten the Tether Strap

With knee still in child restraint, push down on the child restraint again and pull on free end of the tether strap to tighten.

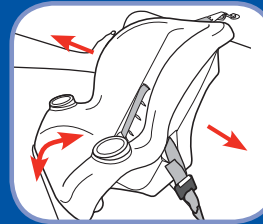

6. Check UAS Belt Tightness

Grasp the child restraint at the belt path with one hand. Push and pull the child restraint from side to side, forward and back.

The child restraint should not move more than 2.5 cm (1 in)

and the UAS belt should not loosen.

NOTE: If it moves more than an 2.5 cm (1 in.) or if the UAS belt loosens, try reinstalling the child restraint or try another seating location.



7. Secure Your Child in the Child Restraint

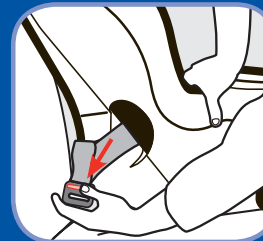

To Remove UAS Belt From Vehicle Anchor Bar

Remove child from child restraint.

Press down firmly on UAS adjuster on side of child restraint and press the UAS adjuster release button to release the tension in the belt.

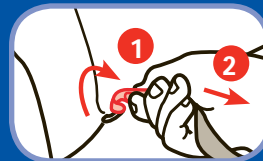

(1) Unhook the UAS hooks from vehicle anchor bar by squeezing the spring lever, push UAS hook into the vehicle seat bight and twist hook off the anchor bar. **(2)** Pull UAS hooks away from the UAS anchor bars.



G-5 Install Forward-Facing With Vehicle Belts



NOTE: Review section D-4 to determine what kind of vehicle belts you have. Review your vehicle's owner manual for vehicle seat belt use.

WARNING:

Do not use the UAS along with the vehicle lap or lap/shoulder belt.



Secure UAS belts when using the vehicle belts.

Check the vehicle belt before each use. Use only if the belt is tightened properly and securely.

When used in the forward facing position, the child restraint must be used in the upright position. Vehicle seat back must be upright.

Failure to follow these warnings can result in serious injury or death.



1. *Place Child Restraint in Vehicle Forward-Facing Flush Against Back Seat*

When used in the forward facing position, the child restraint **MUST** be used in the **upright position**.

NOTE: Do not use the level to ground lines on the side of the child restraint in the forward-facing position.

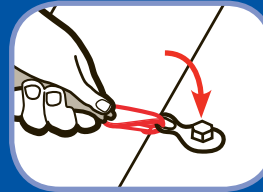

2. *Loosely Attach Tether Hook to Vehicle's Tether Anchor*

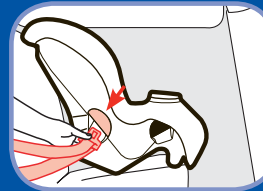

3. *Thread Vehicle Belt*

Thread the vehicle lap or lap/shoulder belt through the forward-facing belt path and out the other side.

With an ALR vehicle belt, pull

the vehicle belt all the way out before threading the child restraint.

With a switchable retractor, pull the shoulder belt all the way out to switch the retractor into the ALR mode before tightening.

Buckle vehicle belt.

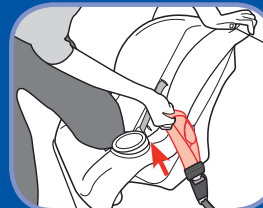

4. *Tighten Vehicle Belt*

Place knee in the child restraint. Push down firmly while pulling up on the vehicle shoulder belt or lap belt to tighten.

With a switchable retractor, feed the shoulder belt back into the retractor while tightening.

It may be easier to tighten the vehicle belt through the belt path opening as shown.

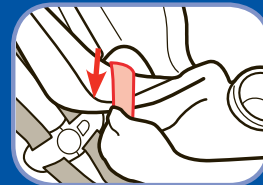

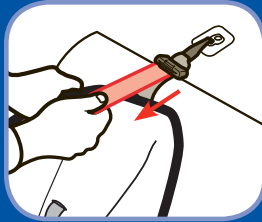

5. Tighten the Tether Strap

With knee still in child restraint, push down on the child restraint again and pull on free end of the tether strap to tighten.

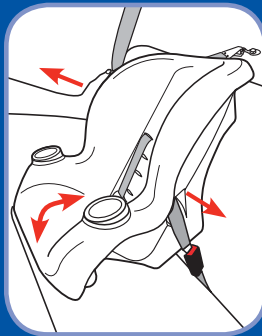

6. Check Vehicle Belt Tightness

Grasp the child restraint at the belt path with one hand. Push and pull the child restraint from side to side, forward and back. The child restraint should not move more than 2.5 cm (1 in) and the vehicle belt should not loosen.

NOTE: If it moves more than 2.5 cm (1 in.) or if the vehicle belt loosens, try reinstalling the child restraint or try another seating location.



7. Secure Your Child in the Child Restraint



H. Using the Locking Clip

You will rarely need to use a locking clip except in some older vehicles. Built-in child restraint locking systems have been required in vehicles since 1996, and many vehicles had these features even earlier. **Review section D-4 and your vehicle owner's manual to determine if your vehicle belts require a locking clip.**

If you need a locking clip immediately, they are likely available at an auto dealership, an auto store, or where you purchased this child restraint. You can call us at 1-800-544-1108 for one. **A locking clip will not fix all types of seat belt problems.**

You **MUST** have a lap and shoulder belt to use a locking clip.

For Rear-Facing installation, follow Section F-4 warnings and steps 1-5 before starting locking clip installation.

For Forward-Facing installation, follow Section G-5 warnings and Steps 1-3 before starting locking clip installation.

H. Using the Locking Clip

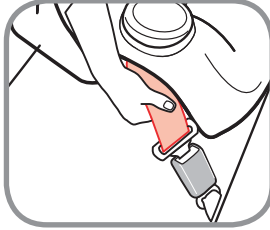

1. **Locate Locking Clip Location**

Grasp the vehicle lap/shoulder belts together tightly as close to the vehicle latch plate as possible. While holding the belts tightly, unbuckle.

NOTE: If the latch plate ends

up just at the belt path opening so you cannot grasp the vehicle belt at the latch plate, grasp the vehicle belts on the opposite side of the child restraint, as close to the latch plate as possible. Install the locking clip on the latch plate end, as close as possible.

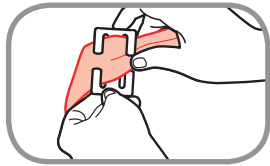

2. **Attach Locking Clip**

Thread both portions of the vehicle belt onto the locking clip, as close to the latch plate as possible.

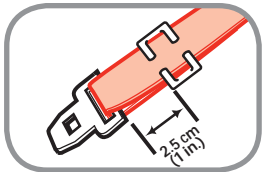

3. **Position Locking Clip**

Position locking clip about 2.5 cm (1 in.) from vehicle belt's buckle plate.

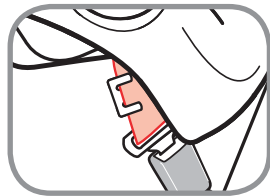

4. **Rebuckle Vehicle Belt**

53

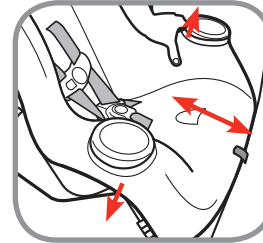

5. **Check Vehicle Belt Tightness**

Grasp the child restraint at the belt path with one hand. Push and pull the child restraint from side to side, forward and back. The child restraint should not move more than 2.5 cm (1 in.) and the vehicle belt should not loosen.

NOTE: If it moves more than 2.5 cm (1 in.) or if the vehicle belt loosens, try reinstalling the child restraint or try another seating location.

Secure your child in the child restraint.

When installed rear-facing, make sure the child restraint is properly reclined according to your child's weight.

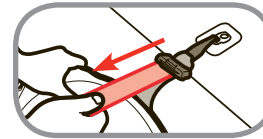
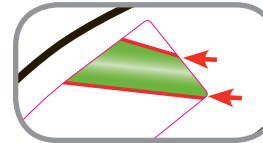

When installed forward-facing, make sure to tighten the tether strap.

If you still have questions after installing the locking clip please contact our Consumer Relations department.

Remove the locking clip when the vehicle seat belt is not being used with a child restraint.

54

Warranty

Dorel Juvenile Group, Inc. (DJG) warrants this product to the original retail purchaser as follows:

This product is warranted against defective materials or workmanship for **one year** from the date of original purchase.

An original receipt is required to validate your warranty.

DJG will, at its option, provide replacement parts or replace this product. DJG reserves the right to substitute if the part or model has been discontinued.

To make a claim under this warranty you may contact us at www.djgusa.com, fax us at 1-800-207-8182 24 hours a day, write to DJG, Consumer Relations Department, P.O. Box 2609, Columbus, IN 47202-2609, or call 1-800-544-1108 from 8:00 a.m. to 6:00 p.m. EST Monday through Thursday and from 8:00 a.m. to 4:30 p.m. on Friday. **Proof of purchase is required and shipping charges are the responsibility of the consumer.**

Warranty Limitations: This warranty does not include damages which arise from misuse or abuse of this product.

Limitation of Damages: The warranty and remedies as set forth are exclusive and in lieu of all others, oral or written, express or implied. In no event will DJG or the dealer selling this product be liable to you for any damages, including incidental or consequential damages, arising out of the use or inability to use this product.

PLEASE REGISTER ONLINE AT:

WWW.DJGUSA.COM/REGISTRATION/CARSEAT/CAN OR
COMPLETE AND MAIL THE PRE-PAID OWNER REGISTRATION CARD
WITHIN (30) DAYS OF PURCHASE.

If there is ever a safety issue with your child restraint, we use registration information to reach owners. Please do not send in your registration card if you have registered your child restraint online.

Replacement Parts Order Form

Complete the form. Your model number and manufacture date code **MUST** be included on the form to ensure proper replacement parts. The codes can be found on a label on side of child restraint. Payment in U.S. dollars must accompany your order. Choose parts needed from the list on the next page.

Return the form with payment to:

Dorel Juvenile Group, Inc.
Consumer Relations Department

P.O. Box 2609
Columbus, IN 47202-2609

Fax orders to: 1-800-207-8182

Please make money orders payable to Dorel Juvenile Group, Inc. Fill in the area on the next page to charge credit card. (Visa or MasterCard **only**). We do not accept cash, personal checks, or other credit cards. All outside of U.S. and Canada **MUST** use credit card.

Ship To: (Please Print)

Name: _____

Address: _____

City: _____

State/Province: _____ **Postal Code:** _____

Country: _____

Telephone: _____

Email Address: _____

We **MUST** have this information:

Model Number (8 to 9 characters): _____

Manufacture Date (yyyy/mm/dd): _____

Replacement Parts List

NOTE: If requested color is not available, similar color will be substituted.

Part	Cost	Quantity	Total Cost
Buckle Strap	\$6.99	X _____	= \$ _____
Harness Strap	\$2.99	X _____	= \$ _____
Seat Pad	\$19.99	X _____	= \$ _____
Chest Clip.....	\$1.50	X _____	= \$ _____
Locking Clip	\$2.50	X _____	= \$ _____
UAS Kit	\$17.99	X _____	= \$ _____
Instructions	\$0.00	X _____	= \$ _____

Merchandise Total: \$ _____

Shipping and handling: \$ _____

Up to \$25.00	\$5.95	\$100.01 to \$150.00	\$10.95
\$25.01 to \$50.00	\$6.95	\$150.01 to \$200.00	\$11.95
\$50.01 to \$75.00	\$8.95	\$200.01 and up	\$13.95
\$75.01 to \$100.00	\$9.95		

Outside Continental USA \$10.00

Sales Tax: \$ _____

Residents of Quebec, add 5% GST and 9.5% QST.

Residents of New Brunswick, Newfoundland and Labrador, add 13% HST.

Residents of Nova Scotia add 15% HST.

Residents of Saskatchewan add 5% GST and 5% PST.

Residents of Manitoba add 5% GST and 7% PST.

All other Provinces and Territories, add 5% GST.

Grand Total: \$ _____

No shipping and handling on instructions for quantities under 6. Add \$.50 for each instruction over 6, then add applicable shipping and handling.

Fill Out For Credit Card

☐ Visa ☐ Mastercard

Card Exp. Date: _____

Cardholder's Name: _____

Card Number: _____

Signature: _____

CUT ON DOTTED LINE