

FLEXSTEEL®

W1013-8311/ 8312

Rectangle Dining Table

IMPORTANT NOTES

Carefully remove all the parts from the carton and put them individually on a soft cloth to prevent damage to the parts.

We have taken great care in the design of this product and request that you carefully and accurately follow our assembly instructions to ensure proper set-up.

We recommend at least two adults assemble this product.

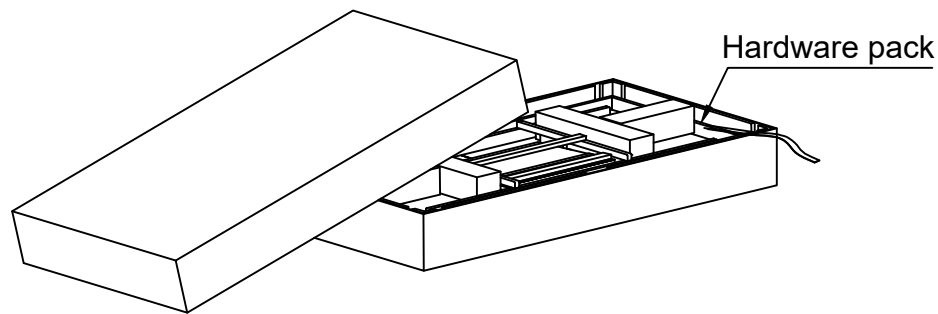
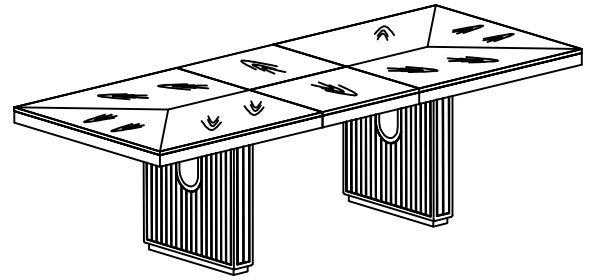

Part List

Assembly Instruction 1/5

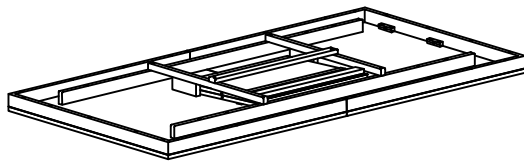

A. Table Top
1 piece

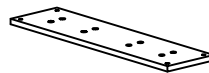

B. Assembly Panel
2 pieces

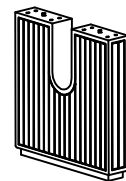

C. U Shape Leg
2 pieces

Hardware List

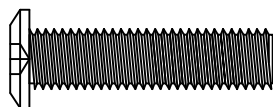

D. Small Bolt
Ø5/16" - 18 UNC x 1"
16 pieces

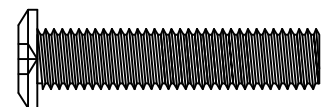

E. Large Bolt
Ø5/16" - 18 UNC x 1-3/8"
8 pieces



F. Spring Washer
Ø5/16" x 1.5mm
24 pieces



G. Flat Washer
Ø5/16 x Ø16mm x 2mm
24 pieces

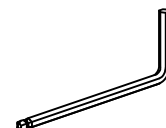

H. Hex Key 4mm
1 piece

IMPORTANT NOTES

- Do not tighten up all the screws until each part is properly assembled.
- Keep the Hex Key in a safe place as you may need to tighten up the bolts in the future.
- Use a soft cloth between these parts and the floor.
- We recommend this product be assembled by at least two adults.

STEP 1

Put the Assembly Panels (B) on the U Shape Legs (C), attach all Small Bolts (D), Spring Washer (F), and Flat Washer (G), level two Assembly Panels to two U Shape Legs then tighten with the Hex Key (H). (See Figure 1).

Figure 1

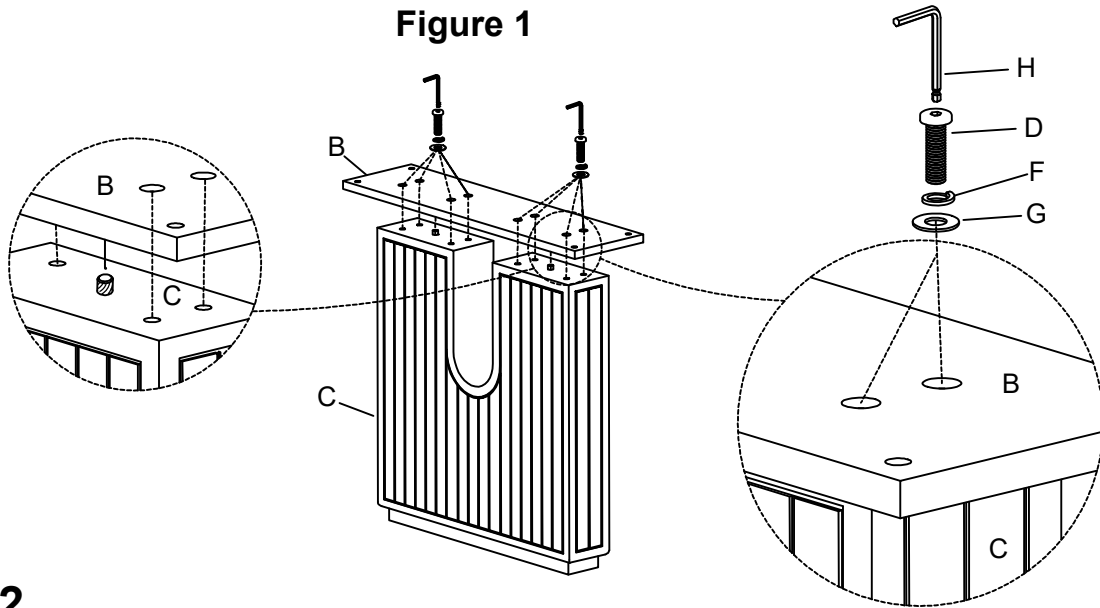

STEP 2

To assemble the base, attach the U Shape Legs (C) to the Table Top (A), attach all Large Bolts (E), Spring Washer (F), and Flat Washer (G), level two U Shape Legs to Table Top then tighten with the Hex Key (H). (See Figure 2).

Figure 2

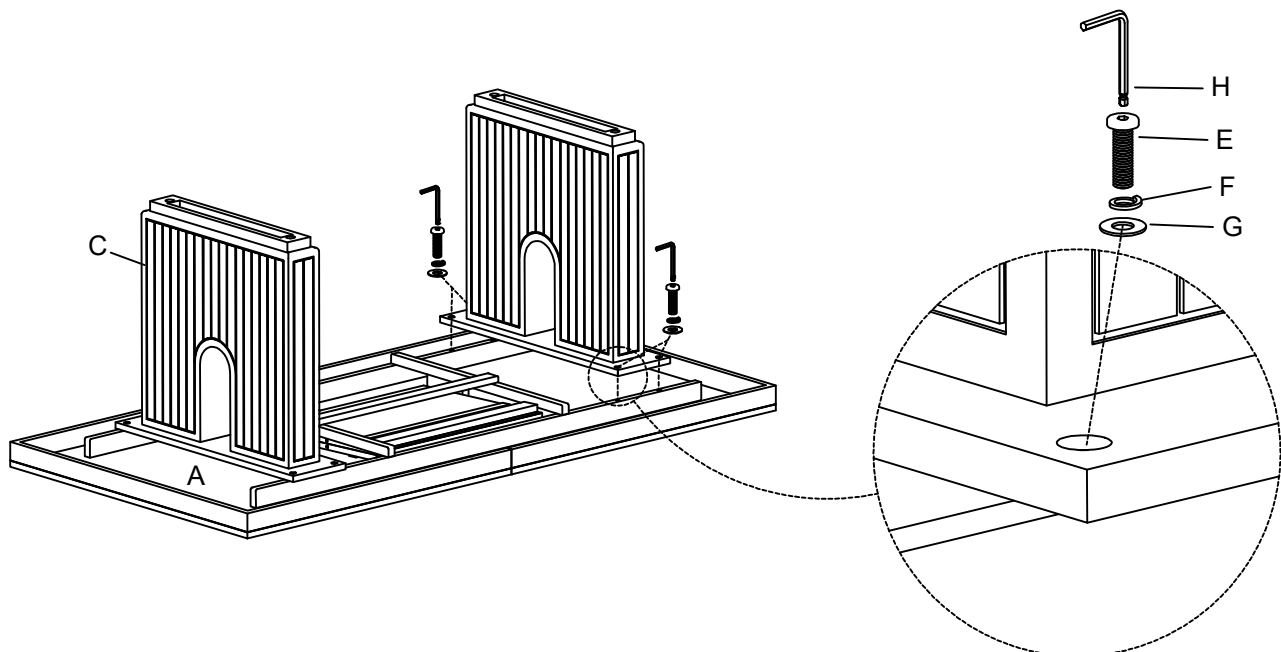

STEP 3

Ask for assistance to lift the unit upright and position it at the desired location. Adjust the levelers on the legs until the furniture is leveled. (See Figure 3).

Figure 3

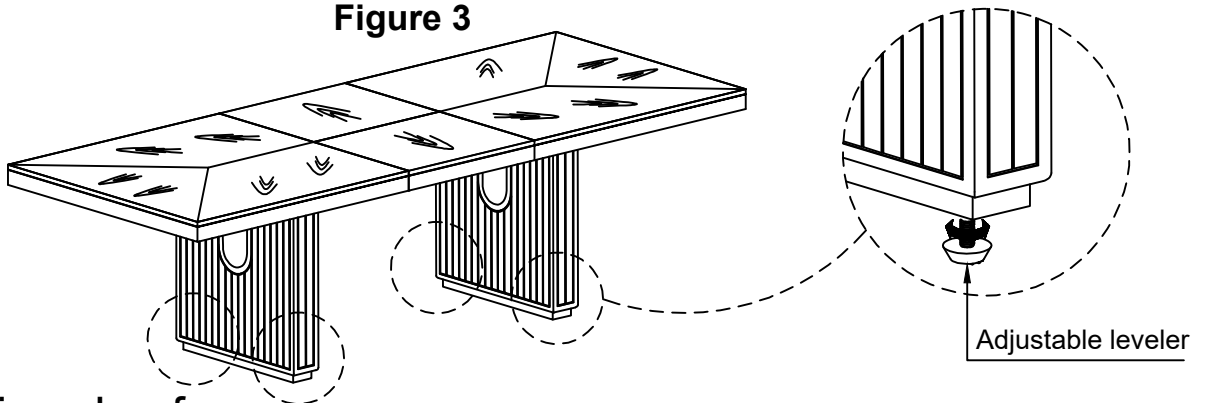

To Retrieve Leaf

1. Unlock the sash locks underneath the Table Top (A) and release the slide locks on both slide mechanisms to allow the slide to operate, then pull the Table Top wide open equally from both ends
2. Lift the Butterfly Leaf from the compartment of the Table Top (A) and flip up the Leaf. Unfold the leaf aprons and rest the leaf onto the top surface carefully.
3. Push the Table Top (A) from both ends to close and lock the sash locks underneath the Table Top. (See Figure 4).

Figure 4

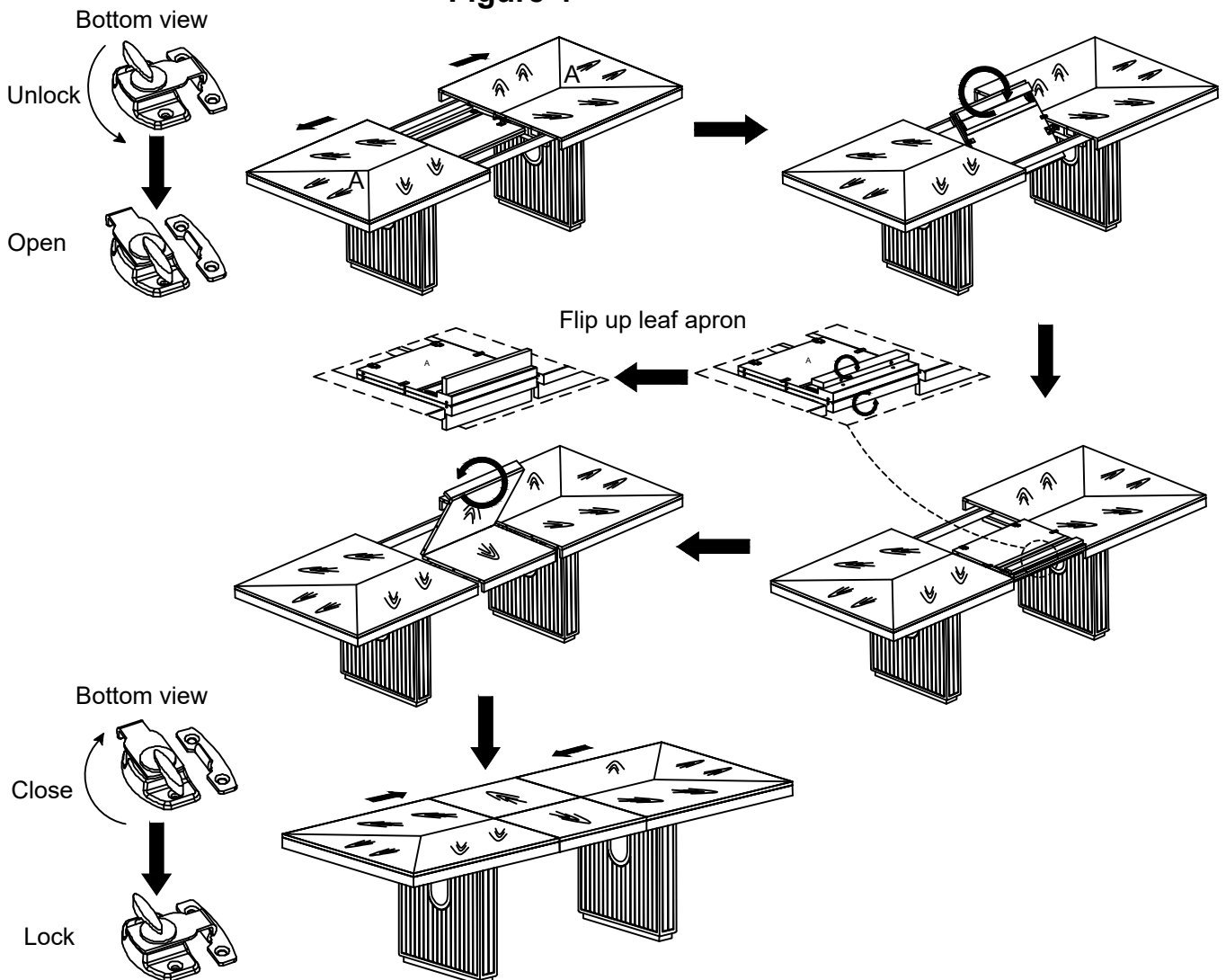

To Store Leaf

1. Unlock the sash locks underneath the Table Top (A) and release the slide locks on both slide mechanisms to allow the slide to operate, then pull the Table Top wide open equally from both ends
2. Fold the butterfly leaf and Flip down the leaf aprons to store within the compartment, as shown.
3. Push the Table Top (A) from both ends to close and lock the sash locks underneath the Table Top.
(See Figure 5).

Figure 5

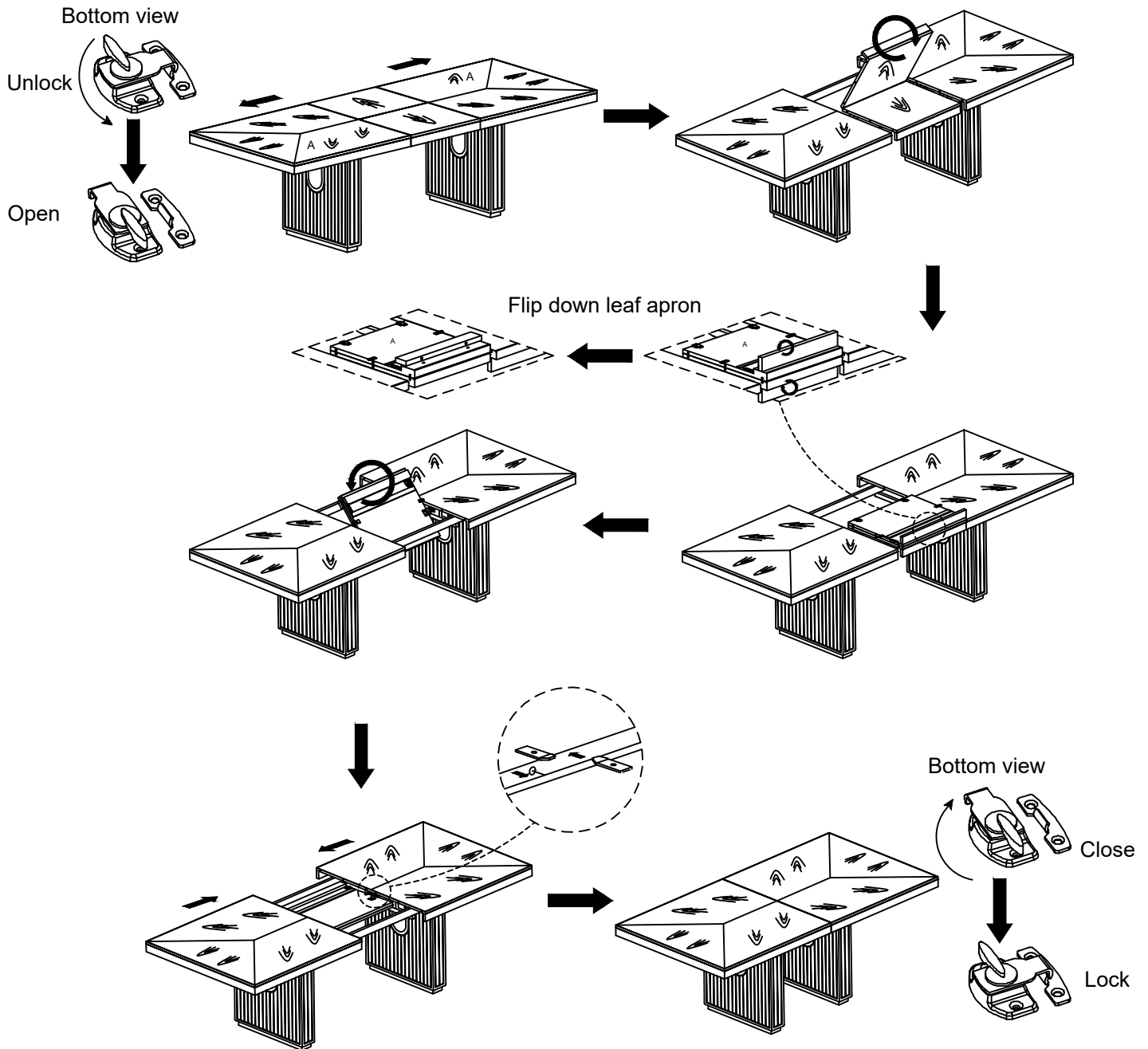

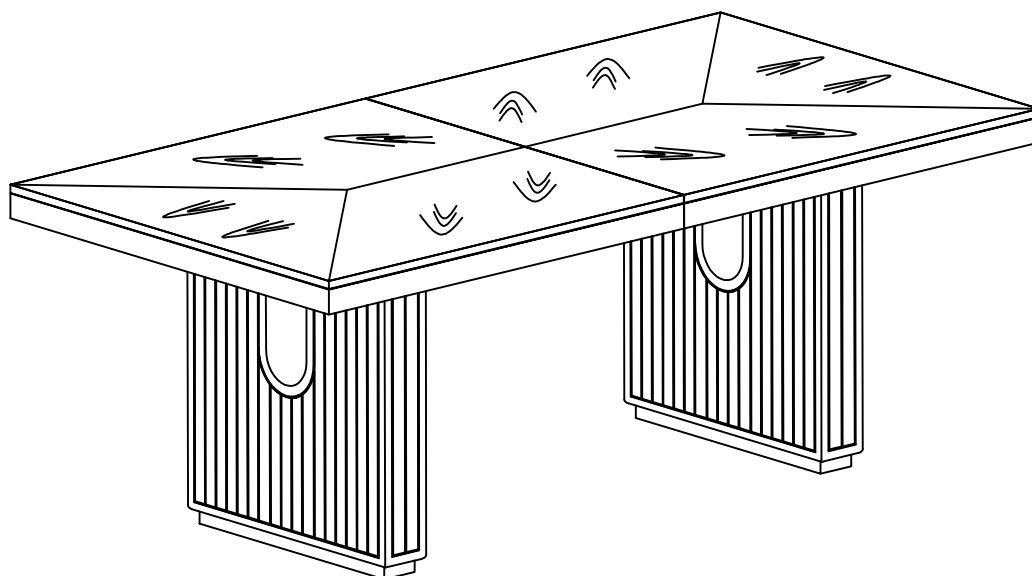

CARE INSTRUCTIONS

- To avoid scratches, do not place sharp or jagged objects directly on the table top.
- Do not place hot items directly on the table top.
- Use placemats or trivets under hot items and coasters under beverages to prevent marks and stains.
- Avoid the use of harsh chemicals or abrasive cleaning materials.
- Wipe the table clean with a soft, dry cloth after each use.
- Wipe up spills quickly with a soft, dry cloth.

Flexsteel Industries, Inc.

For Parts or Customer Service call
toll-free:

1-888-415-3979

Monday-Friday

8:00 a.m. -5:00 p.m.

(Central Time)

Email:

customersolutions@flexsteel.com

www.flexsteel.com