

Showtime!

Make up your own play.
Try using different voices for each of the characters.

Act out your favorite book, poem or nursery rhyme.

Put on some music and let your puppets dance and sing to your favorite song.

Use your puppets to put on a comedy show.

Q

What kind of photos do turtles take?

A

Shellfies!

Q

What did the ocean say to the mermaid?

A

Nothing, it just waved

The Hare and the Tortoise – Who will win the race?

A narrator can read the story while you act it out.

The Hare told all his animal friends he was the fastest, saying *“I have never been beaten, I challenge anyone to race with me!”*

Tortoise quietly said, *“I accept your challenge.”*

“That’s good joke,” said the Hare; *“I could dance around you all the way.”*

Tortoise simply said, *“Shall we race?”*

The racetrack was made and the starting line set. Hare ran out of sight, but soon stopped to have a nap where no one could see him, proudly saying, *“I can beat the tortoise no matter what!”*

Tortoise plodded on and plodded on, never stopping. When Hare woke up from his nap, he looked up and saw Tortoise inching towards the finish line.

Hare jumped up like lightning, running to beat Tortoise, but it was too late, Tortoise had already passed the finish line.

All the animals asked, *“Tortoise, how did you win?”* Tortoise smiled and said, *“Slow and steady wins the race.”*

Shadow Puppets Theater
#6171000
Faber-Castell USA, Inc.
Cleveland, OH 44125
www.fabercastell.com
Designed in USA
Made in China
Conforms to ASTM D-4236
Non-toxic Safe for Children

**CREATIVITY
counts™**

Creativity Can® develop the skills needed to achieve lifelong success.

Creativity develops children’s problem solving and critical thinking skills – it’s the catalyst for invention, innovation and ideas that influence the future.

www.creativitycan.com



SHADOW PUPPETS THEATER



6+ #6171000

LED Lamps come with (3) - L1154, 1.5v Button cell batteries. Batteries should only be replaced by an adult.

Battery box is secured by a screw.

A small Phillips screwdriver is needed.

Battery Warnings:

Discard button batteries carefully.

Do not allow children to play with button batteries.

Keep button batteries out of your child’s reach.

To avoid accidental swallowing, never put button batteries in your mouth for any reason.

If a button battery is ingested, immediately seek medical attention and call your local poison center.

Be sure the battery compartment is tightly screwed closed.

Do not mix old and new batteries

Do not mix alkaline, standard (carbon-zinc), or rechargeable (nickel-cadmium) batteries.



WARNING:
FUNCTIONAL SHARP POINT

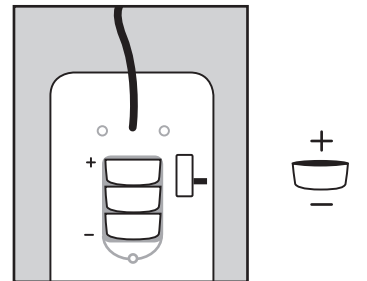

Set up your Theater

Avoid touching or putting pressure on the frosted window.

1.

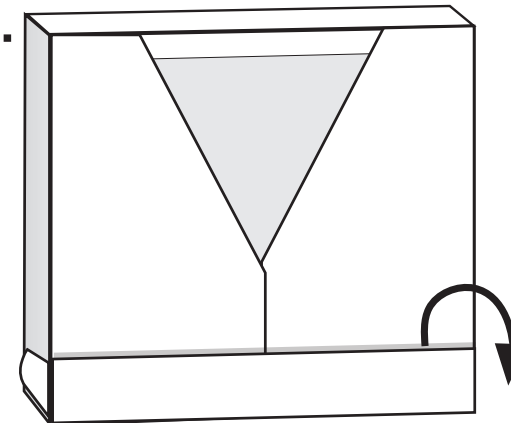

Fold bottom panel down, so it is flat on the table.

2.

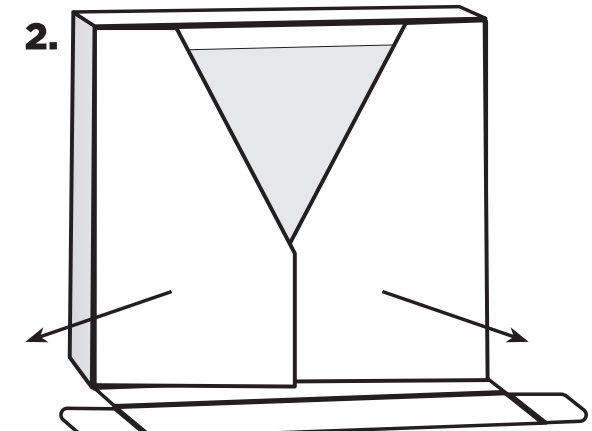

Carefully fold both sides outward

3.

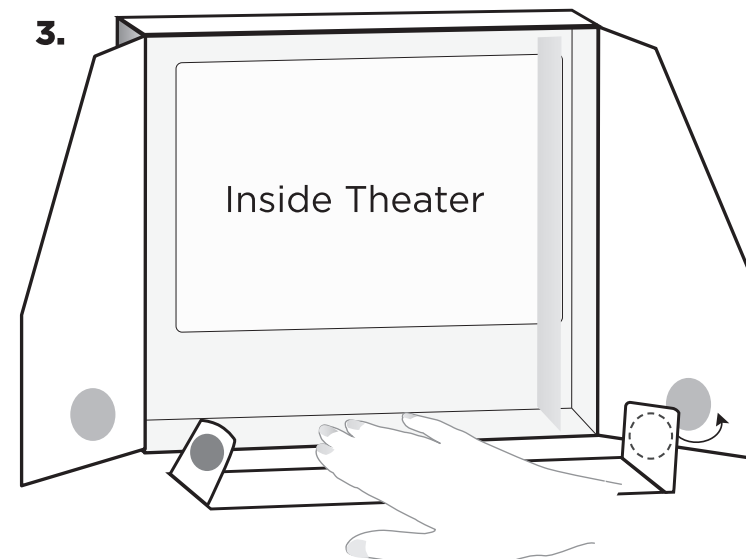

Hold the bottom flap flat against the table. Fold up small flaps. Press the hook and loop tape from small flaps to the theater sides as shown.

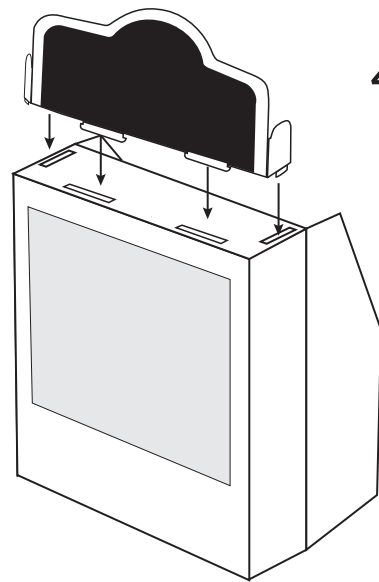

4. Adding Chalkboard Marquee

Match up the slots and push tabs into corresponding slots as shown.

Note: Remove the marquee to write on or to store. Use a damp cloth to clean the chalkboard.



Decorate

Personalize your theater with stickers & rhinestones.

Add them anywhere except the frosted window.

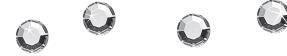

Puppet assembly

Choose how you want your puppets to look!

Tip: Ask an adult or older friend to help you.

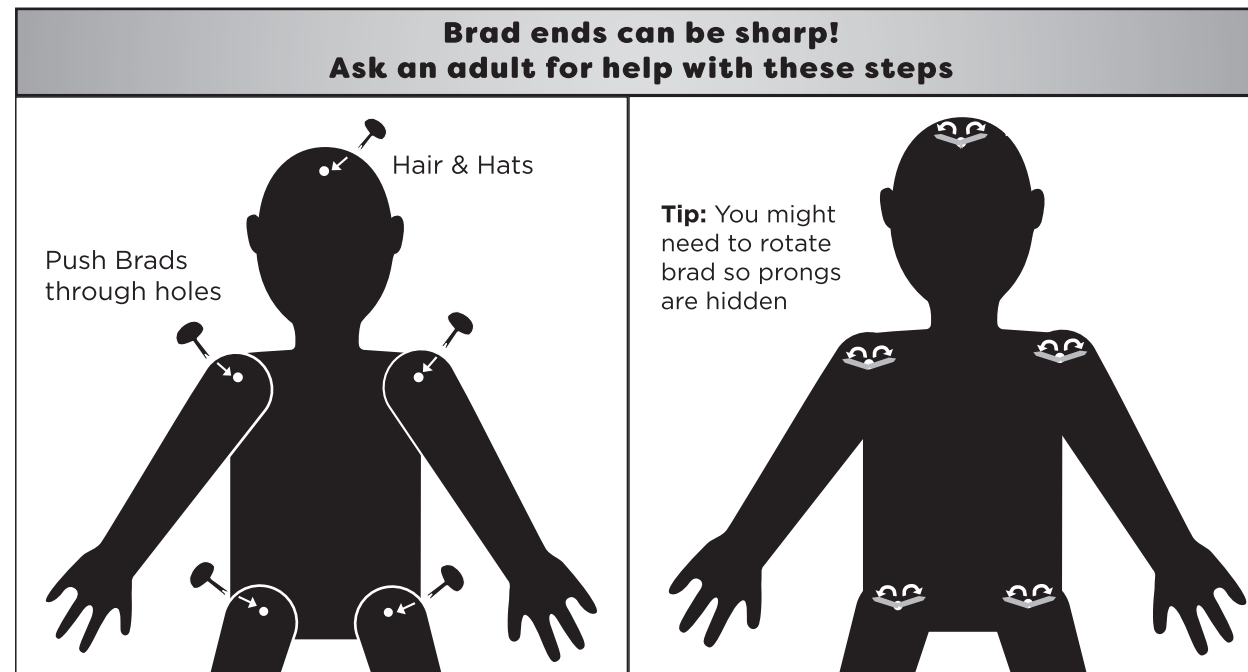
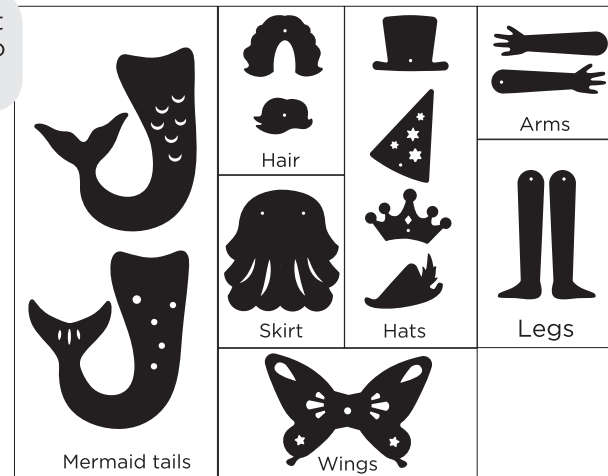
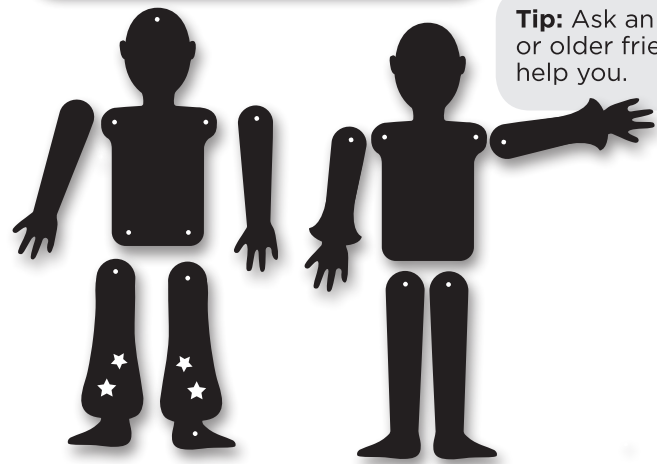

Line up holes on puppet pieces.

Flip over, and gently bend prongs outward, flat against puppet.

Adding Sticks to puppets

Tip: Make sure the arms and legs can move freely.

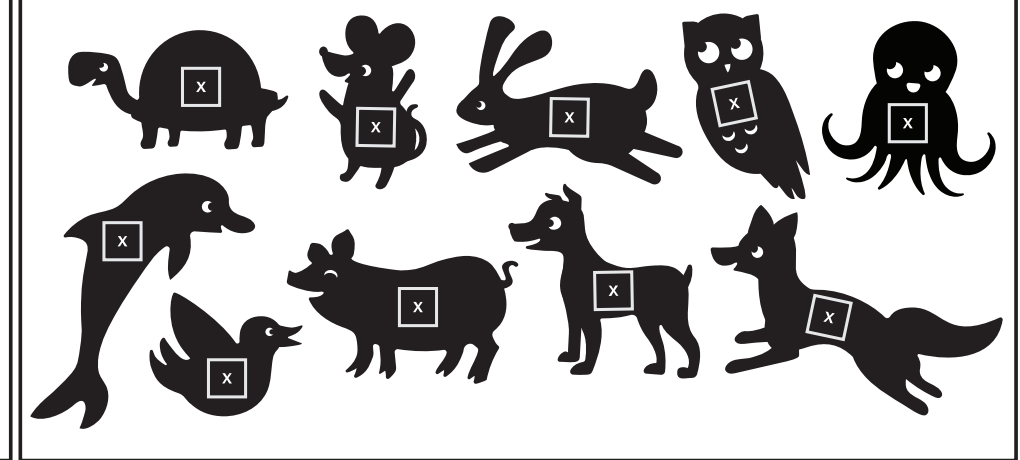
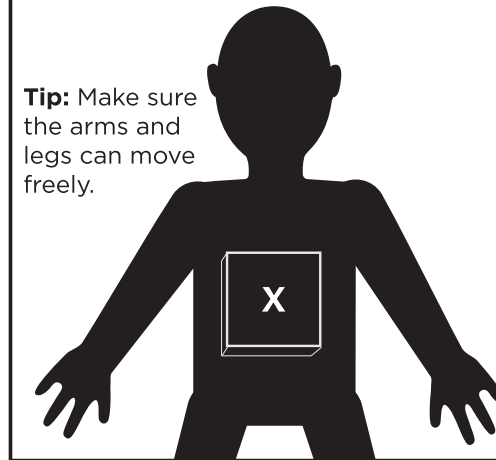

Take 1 foam square, and 1 felt shape. Peel off adhesive backing from the foam square and stick to felt, as shown.

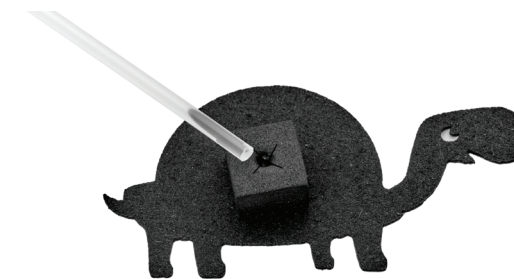

Press down on the foam square for a few seconds to make sure it sticks to the puppet.

Push and twist the stick into the center slits.

Swap sticks when you want to use a different puppet.

Theater lighting

It's showtime!

It helps to turn off or dim other lights in the room. Position the lights so the shadows show up the best.

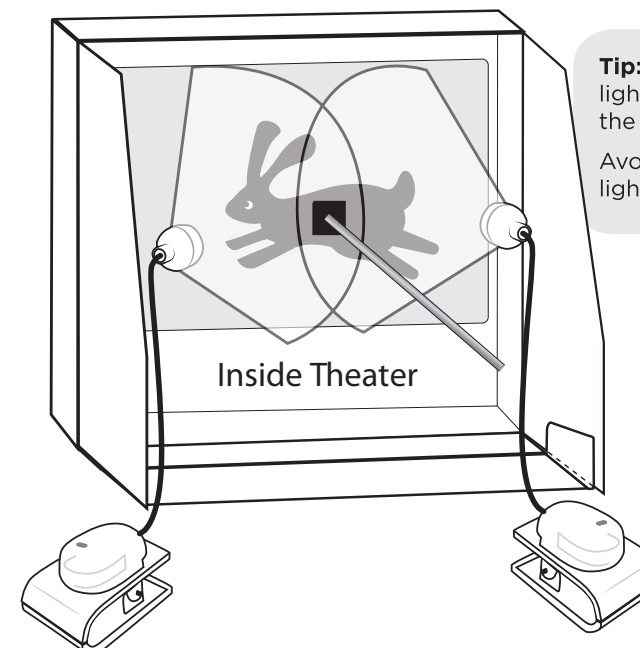

Tip: Make sure the lights are behind the puppet. Avoid blocking the light source.

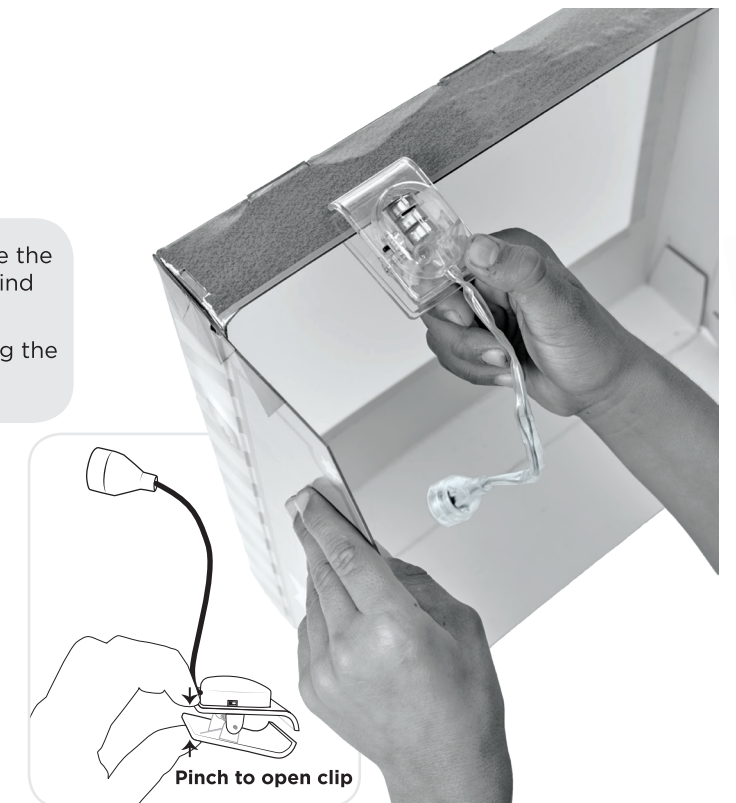

The theater works by casting a shadow of the puppet on the frosted window. Hold the puppets close to the window.

Clip lights on the theater, or place them on the table behind the theater.