

SHIMANO

SYNCOPATE

SC-4000FG

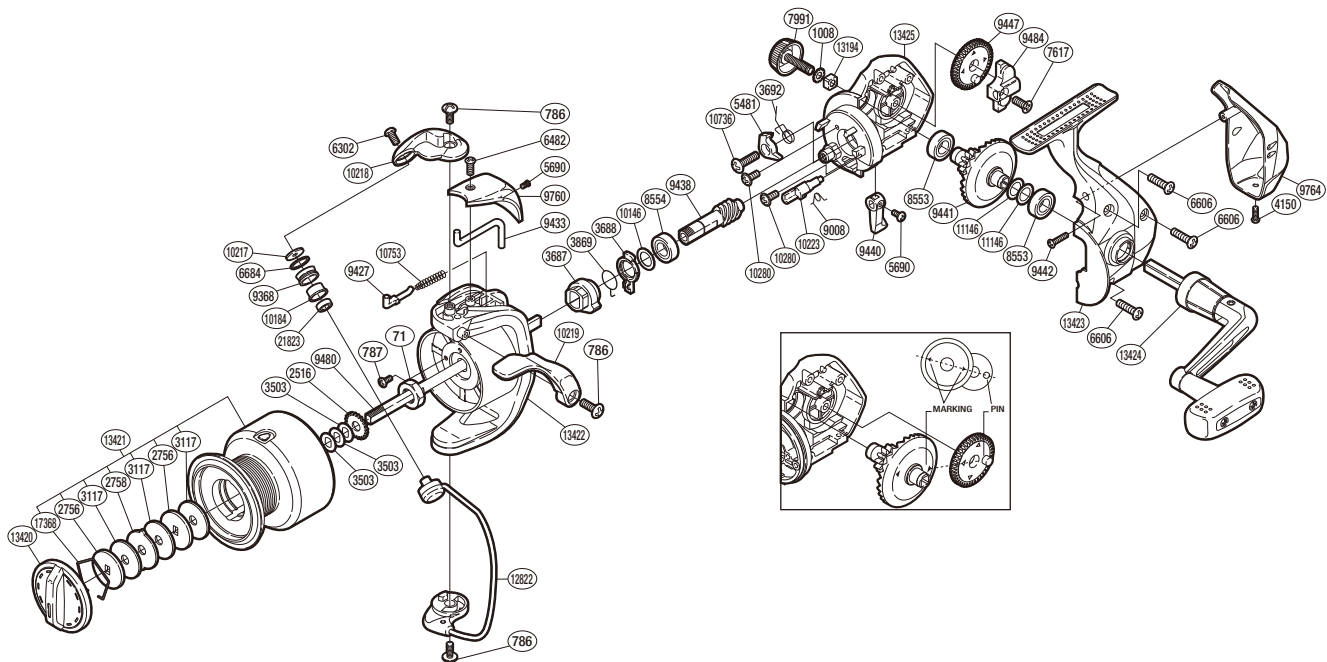

(51SE554006U)

#	Part No.	Description	#	Part No.	Description	#	Part No.	Description
71	10MSQ	Rotor Nut	6684	10KFD	Line Roller Spacer	10184	10PFH	Line Roller Bushing
786	103J1	Screw	7617	10LCC	Screw	10217	10PJG	Line Roller Washer
787	103L6	Screw	7991	10P4L	Handle Screw Cap	10218	10DF2	Bail Arm
1008	105N5	Handle Lock Washer	8553	107AT	Ball Bearing	10219	10FQW	Quick-fire Li Trigger
2516	103PA	Spool Support	8554	107FE	Ball Bearing	10223	10DAC	Anti-Reverse Cam
2756	10BBL	Key Washer	9008	10DCL	Anti-Reverse Cam Spring	10280	10L6C	Screw
2758	102XT	Eared Washer	9368	10JLF	Line Roller	10736	10LLS	Screw
3117	10343	Drag Washer	9427	105LT	Bail Spring Guide	10753	10FVD	Bail Spring
3503	10B XK	Spool Washer	9433	10F1C	Bail Trip Lever	11146	10JDB	Washer
3687	107ZJ	Anti-Reverse Ratchet	9438	10LRT	Pinion Gear	12822	108S2	Bail Assembly
3688	10JT2	Anti-Reverse Lock Out	9440	10JFY	Anti-Reverse Lever	13194	104NX	Handle Screw Lock
3692	10676	Anti-Reverse Pawl Spring	9441	10M4J	Drive Gear	13420	10MCL	Drag Knob
3869	10L5G	Anti-Reverse Lock Out Spring	9442	10L1X	Screw	13421	10JGK	Spool Assembly
4150	103KS	Screw	9447	104X0	Oscillating Gear	13422	10QFT	Rotor
5481	10DDN	Anti-Reverse Pawl	9480	10PLB	Main Shaft	13423	10N11	Side Cover
5690	10MPW	Screw	9484	104KX	Oscillating Slider	13424	103WR	Handle Assembly
6302	10PMQ	Screw	9760	10DEF	Bail Spring Cover	13425	10AXP	Body
6482	103KL	Screw	9764	10ANG	Rear Protector	17368	10MZM	Drag Washers Retainer
6606	10MBP	Screw	10146	10JVJ	Washer	21823	10K64	Ball Bearing

Please note that the number of adjusting washers may not be the same as shown in the exploded views.
(Adjustment will vary with each individual product.)

(230827)_004